

HYUNDAI
VOICE RECOGNITION TIPS (If equipped)

BLUETOOTH®
Command **Example**
 Dial <Phone #> — “Dial 7-1-4-9-6-5-3-0-0-0”
 Call <Name> — “Call John Smith”

Improving how you store your contacts can optimize your Bluetooth® Voice Recognition performance:
 • Use full names instead of short or single-syllable names (“John or Dad”)
 • Avoid using special characters/emojis or abbreviations (“Dr.”) when saving contacts

NAVIGATION
Command **Example**
 Find Address — “1-2-3-4-5 1st Street, <House #, Street, City, State>
 Find <POI Name> — “Find McDonald’s®”

Located on Overhead Console
DESTINATION SEARCH BY VOICE
Command **Example**
 Find <POI Name> — “Find Lowe’s® near me”
 <POI Name> — “Starbucks®”

BLUE LINK

- Assist with creating MyHyundai.com account
- Assist with Blue Link enrollment
- Show Blue Link User's Manual
- Encourage customer to download the MyHyundai with Blue Link app

WINDSHIELD WIPER / WASHER - page 08

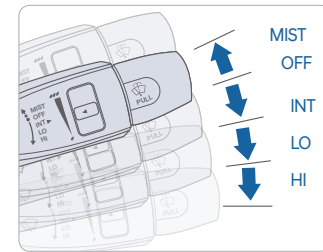

- To activate wipers move the switch down to one of the three positions (INT, LO, HI)
- To adjust "INT" speed move switch
- To spray washer fluid pull lever toward you
- Push lever up for a single wiper pass

OPENING THE TRUNK - page 05

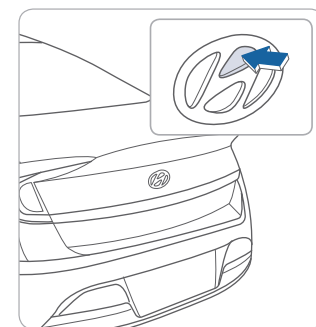

The trunk can be opened using the key FOB, or the Smart Key, or by pressing the trunk release button inside the vehicle.

To open the trunk, perform one of the following:

- Unlock all doors using the remote key FOB, then press the trunk emblem button
- Press and hold the trunk unlock button on the remote key FOB for about 1.5 seconds

- With the Smart Key in your possession, press the button on the trunk emblem (if equipped w/Smart Key)
- From inside the vehicle, press the trunk release button located on the driver side dash panel

- INTRODUCTION AND LOCATION OF THE SERVICE DEPARTMENT**
- SET FIRST SERVICE APPOINTMENT**
- REVIEW FACTORY RECOMMENDED MAINTENANCE SCHEDULE**
- WAS THE CONDITION OF YOUR VEHICLE (AT DELIVERY) TO YOUR SATISFACTION?**

Sales Consultant	Date	Sales Manager	Date
_____	_____	_____	_____
Customer	Date		
_____	_____		
Email	_____		

MAINTENANCE			
Scheduled Maintenance (Normal Usage)		Smartstream 2.5L GDI	Smartstream 1.6T GDI
Engine Oil and Filter	Replace	7,500 or 12 mos.	Replace 6,000 or 12 mos.
Fuel Additives	Add	7,500 or 12 mos.	Add 6,000 or 12 mos.
Tire Rotation	Perform	7,500	Perform 6,000
Vacuum Hose	Inspect	7,500 or 12 mos.	Inspect 6,000 or 12 mos.
Air Cleaner Filter	Inspect	7,500 or 12 mos.	Inspect 6,000 or 12 mos.
	Replace	22,500 or 36 mos.	Replace 18,000 or 36 mos.
Climate Control Air Filter (for Evaporator and Blower Unit)	Replace	Every 12 mos.	Replace Every 12 mos.
Air Conditioning Refrigerant			
Brake Hoses & Lines			
Drive Shafts & Boots			
Front Brake Disc/Pads, Calipers	Inspect	7,500 or 12 mos.	Inspect 6,000 or 12 mos.
Rear Brake Disc/Pads			
Steering Gear Box, Linkage & Boots / Lower Arm Ball Joint, Upper Arm Ball Joint			
Suspension Mounting Bolts			
Exhaust Pipe & Muffler			
Fuel Tank Air Filter			
Vapor Hose & Fuel Filler Cap, Fuel Tank	Inspect	15,000 or 24 mos.	Inspect 12,000 or 24 mos.
Brake Fluid			
Parking Brake			
Fuel Filter			
Fuel Lines, Fuel Hoses and Connections	Inspect	30,000 or 48 mos.	Inspect 24,000 or 48 mos.
Drive Belt	Inspect	First 60,000 or 72 mos.	First 60,000 or 72 mos.
		Subsequent, every 15,000 or 24 mos.	Subsequent, every 12,000 or 24 mos.
Spark Plugs	Replace	97,500	Replace 42,000
Coolant	Replace	First 120,000 or 120 mos.	First 120,000 or 120 mos.
		Subsequent, every 30,000 or 24 mos.	Subsequent, every 30,000 or 24 mos.
Valve Clearance	Inspect	60,000 or 72 mos.	Inspect 60,000 or 72 mos.
Automatic Transmission Fluid	No checks or services required for Normal Usage driving.		
*Check the engine oil regularly between recommended oil change intervals. We recommend Quaker State oil.			
*See Owner's Manual for details regarding Severe Usage maintenance recommendations.			

Looking For more detailed information? This Quick Reference Guide does not replace your vehicle's Owner's Manual. If you require additional information or are unsure of a specific issue, We recommend that you always refer to the vehicle's Owner's Manual or contact your authorized Hyundai dealer. The information contained in this Quick Reference Guide is correct at the time of printing; however, specifications and equipment can change without notice. No warranty or guarantee is being extended in this Quick Reference Guide, and Hyundai reserves the right to change product specifications and equipment at any time without incurring obligations. Some vehicles are shown with optional equipment.



The Hyundai SONATA

Quick Reference Guide

Roadside Assistance: 1-800-243-7766
 Consumer Affairs: 1-800-633-5151
 Sirius XM® Radio: 1-800-967-2346
 Blue Link: 1-855-2BLUELINK (1-855-225-8354)



NP150-D2020-Q
 (Rev 11/01/19)
 Printing 11/04/19

HYUNDAI VEHICLE OWNER PRIVACY POLICY

Your Hyundai vehicle may be equipped with technologies and services that use information collected, generated, recorded or stored by the vehicle. Hyundai has created a Vehicle Owner Privacy Policy to explain how these technologies and services collect, use, and share this information.

You may read our Vehicle Owner Privacy Policy on the Hyundaiusa.com website at <https://www.hyundaiusa.com/owner-privacy-policy.aspx>. If you would like to receive a hard copy of our Vehicle Owner Privacy Policy, please contact our Customer Connect Center at:

Hyundai Motor America
Hyundai Customer Connect Center
P.O. Box 20850
Fountain Valley, CA 92728-0850
800-633-5151 consumeraffairs@hmmausa.com

Hyundai's Customer Connect Center representatives are available Monday through Friday, between the hours of 5:00 AM and 7:00 PM PST and Saturday and Sunday between 6:30 AM and 3:00 PM PST (English). For Customer Connect Center assistance in Spanish or Korean, representatives are available Monday through Friday between 6:30 AM and 3:00 PM PST.

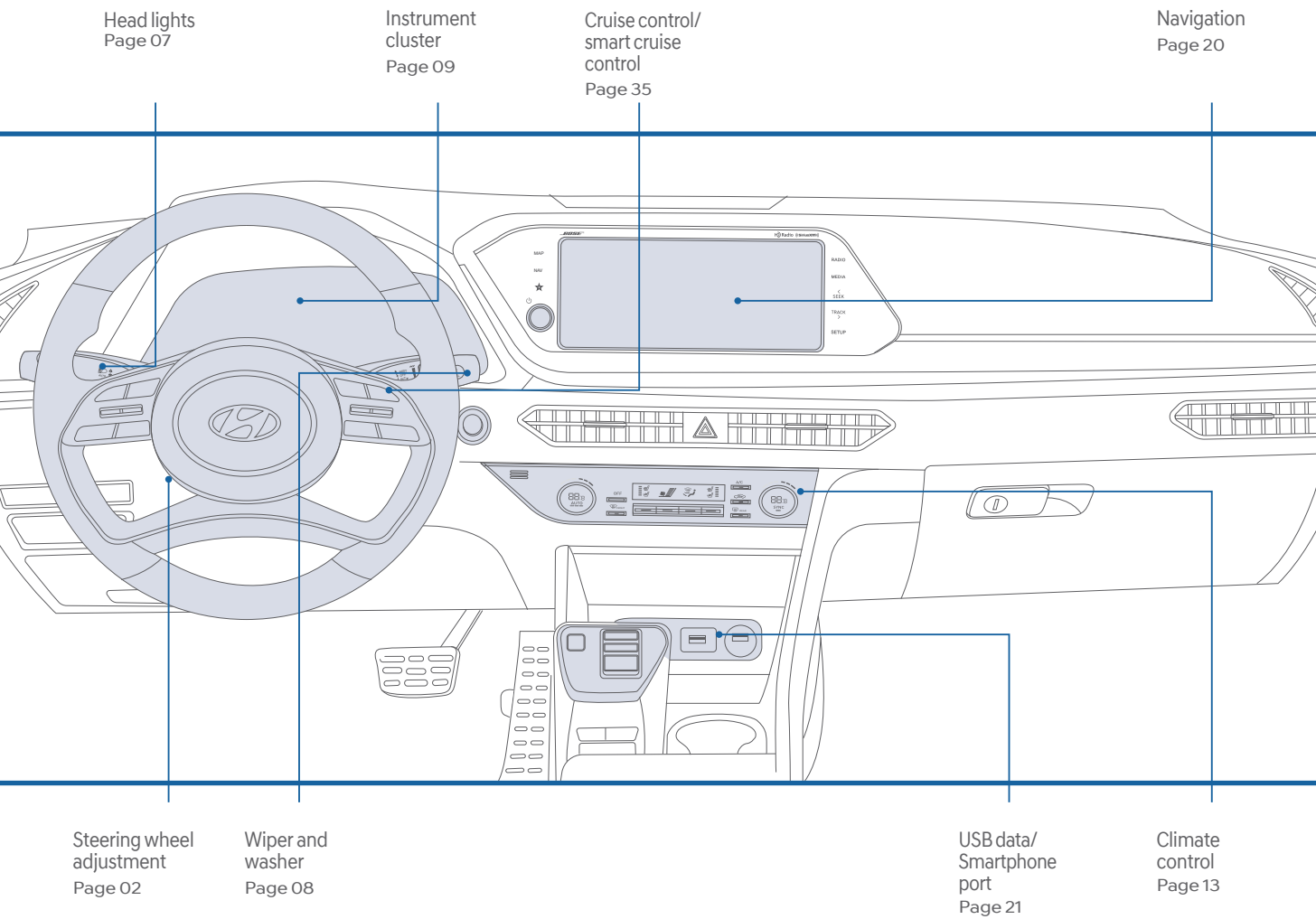

FEATURES AND CONTROLS

Climate control	13
Driver's main controls	02
Headlights	07
Instrument cluster	09
Instrument panel illumination	12
Interior lights	06
LCD display control	11
LCD display modes	11
Panoramic sunroof	06
Remote & Smart key	01
Seat-Front seat adjustment	03
Seat-Headrest adjustment	04
Seat-Seat belt adjustment	04
Seat-Seat warmer & ventilated seat	04
Steering wheel adjustment	02
Trunk-Smart trunk	05
Trunk-Trunk opening	05
Warnings and indicators	12
Wipers and washer	08

INFOTAINMENT

Android Auto™	23
Apple CarPlay™	25
Audio mode	19
Bluetooth operational tips	18
Bluetooth phone operation	17
Bluetooth phone pairing	17
Clock Adjustment	21
Homelink wireless control system	22
Navigation	20
Steering wheel audio control	19
USB data/Smartphone port	21
Wireless cellular phone charging system	21

DRIVING

Auto Hold	38
Blind Spot Collision Avoidance Assist (BCA)	30
Cruise control / Smart cruise control	35
Digital key pairing	39
Drive mode	33
Electric Parking Brake (EPB)	38
Forward Collision-Avoidance Assist (FCA)	30
Highway Driving Assist (HDA)	36
Idle Stop and Go (ISG)	32
Lane Following Assist (LFA)	29
Lane Keeping Assist System (LKAS)	29
Leading vehicle departure alert	36
Near field communication (NFC)	40
Push button drive selector	37
Rear Cross-traffic Collision-Avoidance Assist (RCCA)	37
Rear Occupant Alert (ROA)	31
Tire Pressure Monitoring System (TPMS)	34

WARNING!
 To reduce the risk of serious injury to yourself and others, read and understand the important SAFETY INFORMATION in your Owner's Manual.

Use this Quick Reference Guide to learn about the features that will enhance your enjoyment of your Hyundai. More detailed information about these features are available in your Owner's Manual.

* Some vehicles may not be equipped with all the listed features.

REMOTE & SMART KEY

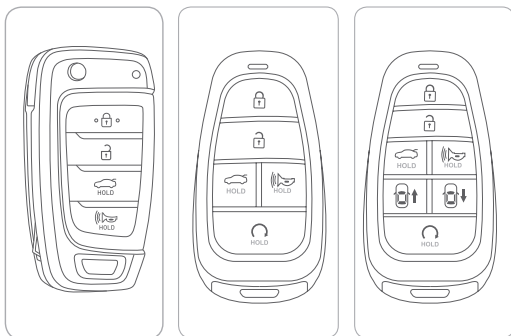

- Lock
- Unlock
- Engine remote start button
- Trunk Unlock
- Panic

NOTE: To start the vehicle remotely, press and hold the remote start button for over 2 seconds within 4 seconds after locking the doors.”

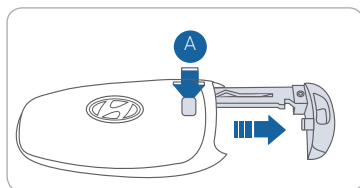

Removing the mechanical key
Slide and hold the release button **A** to remove the mechanical key.

NOTE: User selectable option : Please see section 5 from Owner's Manual for more details.

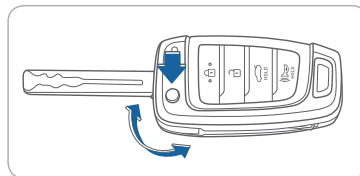

To unfold the mechanical key, press the release button on the remote.

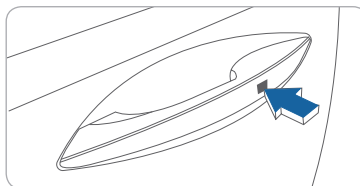

Driver's door Lock / Unlock
Smart key must be within 28~40in. from the outside door handle.
Press: One time - Unlock driver door
Two times - Unlock all doors
Three times - Lock all doors

STEERING WHEEL ADJUSTMENTS

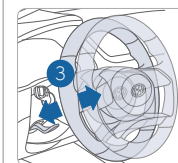
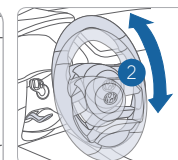
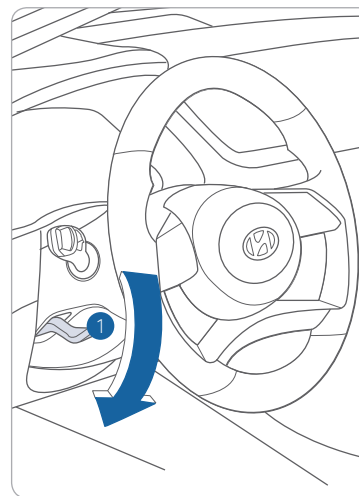

NOTE: Do not adjust while driving.

1. Pull the lever **1** down.
2. Set the angle **2** and distance **3**.
3. Pull the lever **1** up to lock position.

DRIVER'S MAIN CONTROLS

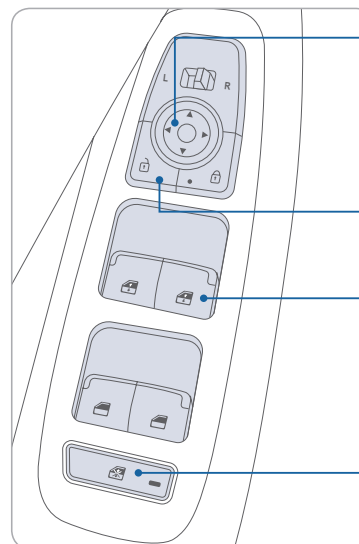

Outside Rearview Mirror
Move the lever towards L (left) or R (right) on the switch. Then adjust the mirror by using the mirror adjustment control switch.

Door Lock
Locks/unlocks all doors.

Window Auto down/up (if equipped)
Press past detent to fully open/close window.

Power window lock button
Disables the power window switches on the rear passenger doors.

FRONT SEAT ADJUSTMENT (Manual)

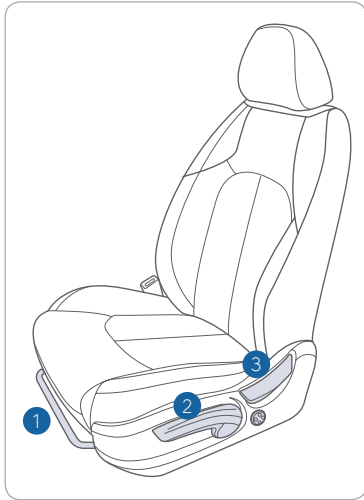

Forward and backward ①



Seat cushion height ②

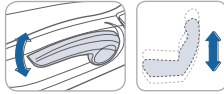

Seatback angle ③

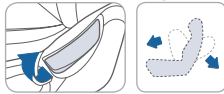

FRONT SEAT ADJUSTMENT (POWER)

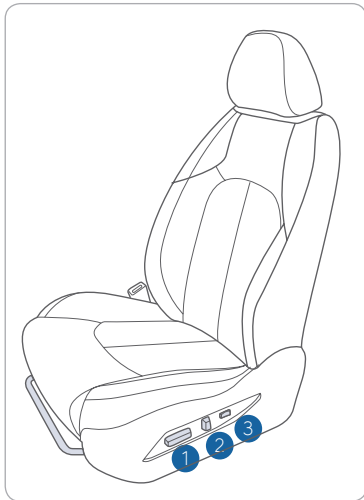

Forward and backward ①

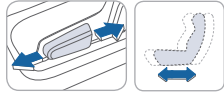

Seat cushion height

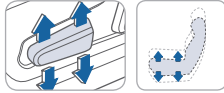

Seatback angle ②

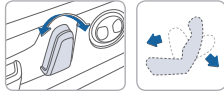

Lumbar support (for driver's seat) ③



HEADREST ADJUSTMENT

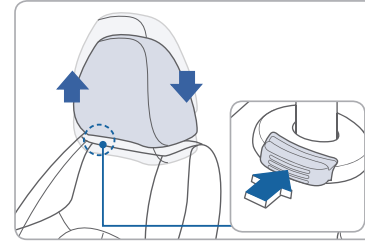

To Raise Headrest:
Pull headrest up.

To Lower Headrest:
Press lock button while pressing down on headrest.

SEAT BELT ADJUSTMENT (Front seat)

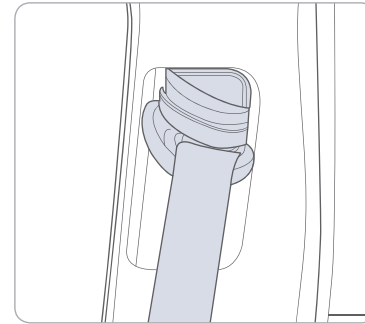

Pull up to raise.

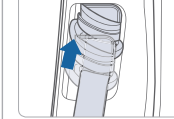

Press button and push down to lower.

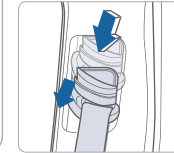

SEAT WARMER AND VENTILATED SEAT

Seat Warmer



Toggle the switch **A** upward to increase heat.

OFF → LOW (☐) → MED (☐) → HIGH (☐)

Seat Warmer and Ventilation



For vehicles equipped with both heated and ventilated seats, toggle the switch **A** downward to increase cooling.

OFF → LOW (☐) → MED (☐) → HIGH (☐)

TRUNK OPENING

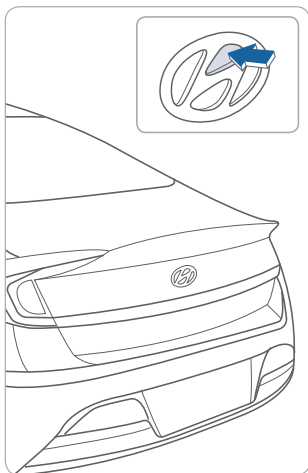

Opening the trunk

The trunk can be opened using the key FOB or Smart Key, by pressing the trunk emblem, or by pressing the trunk release button inside the vehicle.

Trunk Emblem Button

To open the trunk, perform one of the following:

- Unlock all doors using the remote key FOB or Smart Key, then press the trunk emblem button
- With the Smart Key in your possession, press the button on the trunk emblem



Key FOB / Smart Key

Press and hold the trunk unlock button on the remote key FOB or Smart Key for about 1.5 seconds

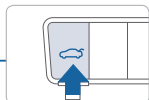

Trunk Release Button

From inside the vehicle, press the trunk release button located on the driver side dash panel

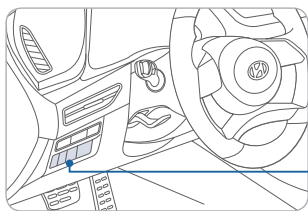

SMART TRUNK

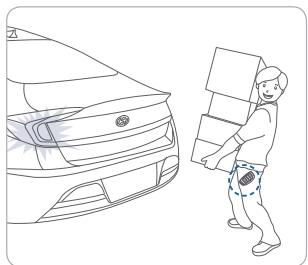

Smart Trunk

Trunk will slightly open automatically when detecting smart key within range near the trunk for more than 3 seconds.

To enable Smart Trunk function:

Vehicle must be in P (Park) to adjust settings in the User Setting mode.

1. Select "Door/Trunk" in the User Settings in the instrument cluster.
2. Check "Smart Trunk".

NOTE:

Function is active after 15 seconds when all doors are closed and locked and key is not detected. The vehicle will also provide an audible and visual alarm while activating. For more details, refer to Owner's Manual.

PANORAMIC SUNROOF

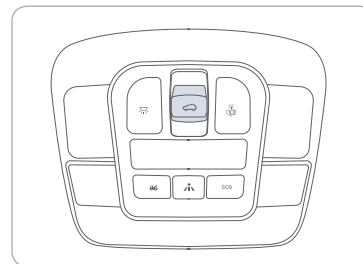

Sunshade



Push the lever rearward to open sunshade. Press the lever forward to close sunshade.

(This operation will also close Sunroof if open or vented position.)

Opening the sunroof



Push the sunroof lever rearward to open the sunroof. (This operation will also open the Sunshade, if it is not in the open position.)

Push the sunroof lever forward to close the sunroof.

Sunroof Tilt Open/Close

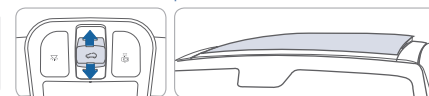

Push up on the lever to open the sunroof to the tilt position. (This operation will also open the Sunshade, if it is not in the open position.)

Push up again on the lever to close the sunroof from the tilt position.

INTERIOR LIGHTS

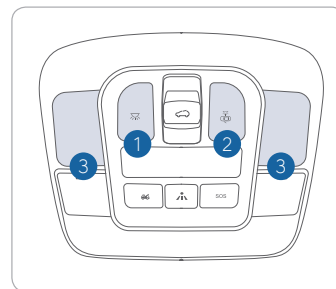

Front Map Lamp ①

Push the switch to turn the map lamp on or off.

Front Room Lamp (☀️ ☽️) ② (Type A)

Push the switch to turn the room lamp (overhead lamp) on or off.

Front Room Lamp (☀️) ② (Type B)

Push the switch to turn the room lamp (overhead lamp) on or off.

Front Door Lamp (🚪) ③

Lights will turn on when any door is open.

HEADLIGHTS

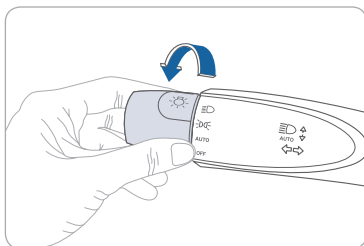

- ▶ | Headlight
- ▶ | Parking light
- ▶ | **AUTO** Auto light
- ▶ | **OFF** OFF

Headlight Delay

Headlights may stay on for 15 seconds after exiting and locking vehicle. Press remote lock button twice to turn headlights off.

Turn signals and lane change signals

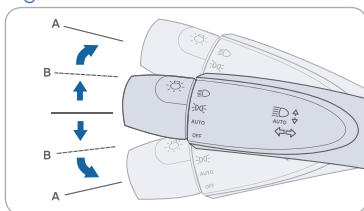

Flashing headlights

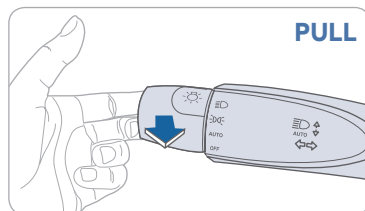

High beam

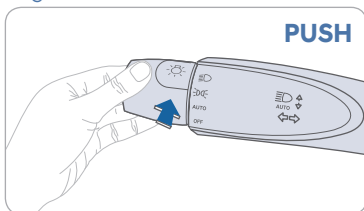

High Beam Assist

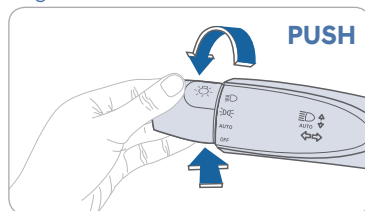

NOTE:

To turn off high beam, pull the lever towards you.

High Beam Assist

1. Select AUTO position on lever.
2. Turn on the high beam by pushing the lever away from you. High Beam Assist Indicator will illuminate
3. High Beam Assist system will turn on when vehicle speed is above 25 mph.
4. To turn off high beam assist, push the lever forward.

WIPERS AND WASHER

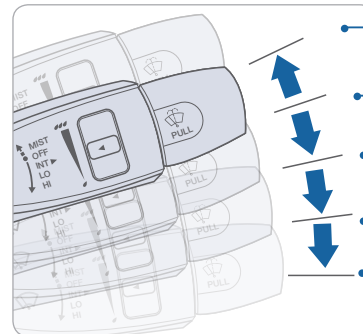

- **MIST** - Single wipe
- **OFF**
- **INT** - Intermittent wipe
- **LO** - Low wiper speed
- **HI** - High wiper speed

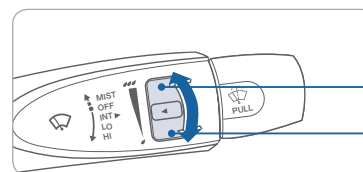

Intermittent Wipe Time Adjustment
Move the control switch.

- Fastest wiper speed
- Slowest wiper speed

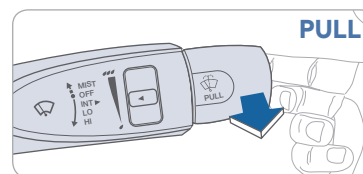

Windshield Washer

Pull the lever gently toward you to spray washer fluid on the windshield and to run the wipers 1-3 cycles.

INSTRUMENT CLUSTER

Type A



Type C (12.3 inch Hi-Resolution LCD Display)

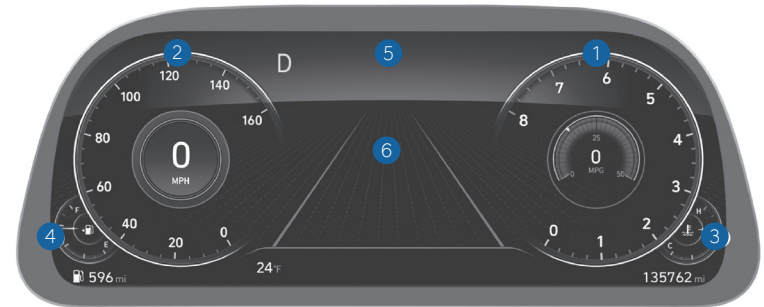

Type B (colored display)



- 1 Tachometer
- 2 Speedometer
- 3 Engine coolant temperature gauge
- 4 Fuel gauge
- 5 Warning and indicator lights
- 6 LCD display (including Trip computer)

LCD DISPLAY MODES

Modes	Symbol	Explanation
Trip Computer		This mode displays driving information like the tripmeter, fuel economy, and so on.
Turn By Turn (TBT) (if equipped)		This mode displays the state of the navigation.
Assist		- Smart Cruise Control (SCC) - Lane Keeping Assist (LKA) - Lane Following Assist (LFA) - Driver Attention Warning (DAW) - Tire pressure
Drive Assist (if equipped)		This mode displays the state of: - Smart Cruise Control system - Lane Keeping Assist - Lane Following Assist - Driver Attention Warning - Tire pressure
User Settings		Displays service interval and warning messages. Changes settings.
Warning		Displays service interval and warning messages.

LCD DISPLAY CONTROL

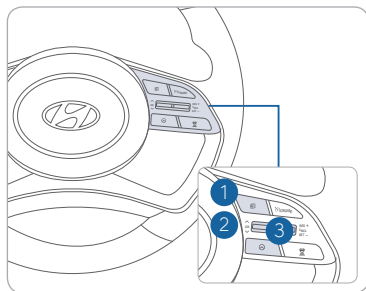

- : MODE button for changing modes
- : MOVE switch for changing items
- : SELECT/RESET button for setting or resetting the selected item

WARNINGS AND INDICATORS

Air bag warning light	Seat belt warning light	Parking brake & Brake fluid warning light
Anti-lock Brake System (ABS) warning light	Electronic Brake Force Distribution (EBD) system warning light	
Electric Power Steering (EPS) warning light	Malfunction Indicator Lamp (MIL)	Charging system warning light
Engine coolant temperature warning light	Engine oil pressure warning light	Low fuel level warning light
Low tire pressure warning indicator/TPMS malfunction lamp	Electric Parking Brake (EPB) warning light	Master warning light
Electronic Stability Control (ESC) indicator	Electronic Stability Control (ESC) OFF indicator	Immobilizer indicator
Turn signal indicator	Low beam indicator	High beam indicator
Light ON indicator	Smart high beam indicator	CRUISE Cruise indicator
AUTO HOLD indicator	SPORT mode indicator	Lane Keep Assist Indicator
Forward Collision-Avoidance Assist	Icy Road Warning Light	Headlamp Warning Light
Lane Follow Assist		

INSTRUMENT PANEL ILLUMINATION

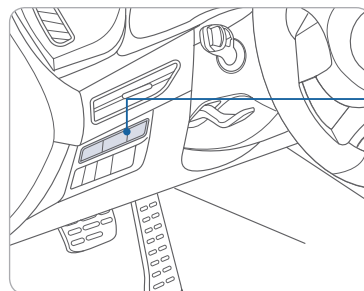

Press - or + to adjust instrument cluster illumination brightness.

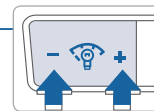

MANUAL CLIMATE CONTROL

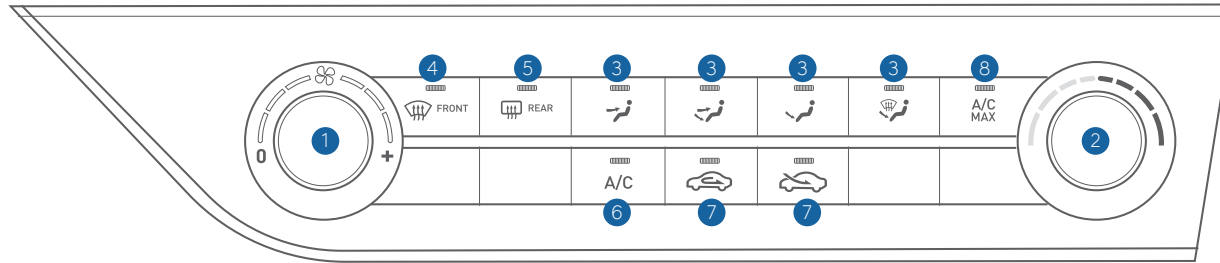

- 1 Fan speed control knob
- 2 Temperature control knob
- 3 Mode selection buttons
- 4 Front windshield defroster button

- 5 Rear window defroster button
- 6 A/C (Air Conditioning) button
- 7 Air intake control button
- 8 MAX A/C button

Defogging / Defrosting

1. Press the defrost button.
2. Select warmest temperature.
3. Set the fan speed to the highest speed.

Air intake control

- Recirculated air position
- Outside (fresh) air position

Mode selection

Changing the direction of the air flow as follow.

- Face-Level
- Bi-Level
- Floor-Level
- Floor & Defrost-Level
- Defrost-Level

Rear Window Defroster

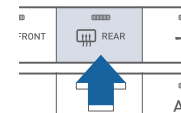

Press to activate/deactivate the rear defroster.

MAX A/C mode

MAX A/C Mode automatically engages Recirculated air position and air conditioning. Return to normal A/C mode after the vehicle interior has cooled sufficiently.

NOTE:

To reduce tendency of the glass fogging and also to improve visibility, keep the interior surface of the windshield clean by wiping it with a clean cloth and glass cleaner. In addition, select air intake control to the outside (fresh) air position whenever possible while operating the vehicle.

AUTOMATIC CLIMATE CONTROL

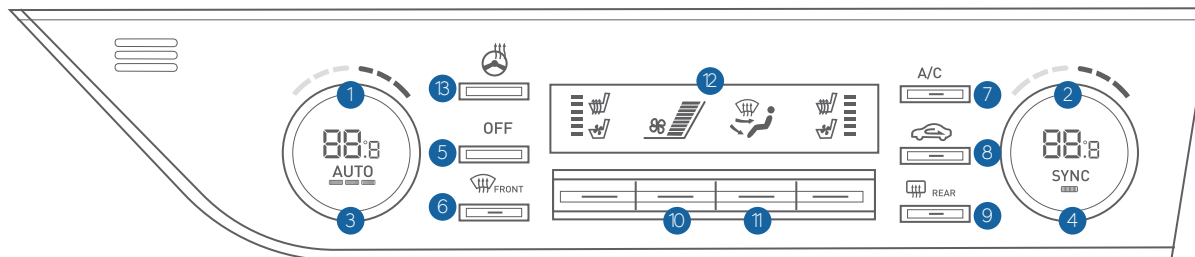

- 1 Driver's temperature control knob
- 2 Passenger's temperature control knob
- 3 AUTO (automatic control) button
- 4 SYNC button
- 5 OFF button
- 6 Front windshield defroster button
- 7 Air conditioning button
- 8 Air intake control button
- 9 Rear window defroster button
- 10 Fan speed control toggle switch
- 11 Mode selection toggle switch
- 12 Climate control information screen
- 13 Heated steering wheel button

Defogging / Defrosting

1. Press the defrost button.
2. Select warmest temperature.
3. Set the fan speed to the highest speed.

System off

- Pressing the OFF button will place the system in the OFF mode.
- Climate control fan will turn off.
 - Outside (fresh) air position will be selected.
 - Vented air will be at last set temperature.

NOTE:

To reduce tendency of the glass fogging and also to improve visibility, keep the interior surface of the windshield clean by wiping it with a clean cloth and glass cleaner. In addition, select air intake control to the outside (fresh) air position whenever possible while operating the vehicle.

Air intake control

- Recirculated air position (LED ON)
- Outside (fresh) air position (LED OFF)

Automatic heating / Air conditioning



Mode selection

- Changing the direction of the air flow as follow.
-

Auto fan speed control



1. The fan speed is controlled automatically in 3 available settings.
2. Pressing the AUTO button will activate the AUTO function and change the AUTO fan speed setting
3. Settings: HIGH → MEDIUM → LOW
4. If the temperature is set to either 'HI' or 'LO', the fan speed setting will be 'HIGH'.

* For detailed precautions and instructions, see the Owner's Manual.

BLUETOOTH PHONE PAIRING

Pairing tutorials, phone compatibility and operational tips can be found through the Smart QR code using the QR reader application on your Smartphone.



BLUETOOTH PHONE OPERATION

Phone setup (pairing phone)

1. Turn Bluetooth® on from your mobile phone. : All Menus > Setup > Device Connections > Bluetooth > Bluetooth Connections > Add New.

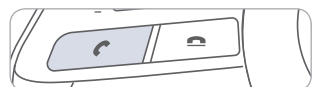

2. Select the car name shown on your mobile phone to pair.
3. Enter the passkey or accept the authorization popup on your phone. (The default passkey is 0000.)



4. Bluetooth is connected.

NOTE: Vehicle must be parked to complete pairing process.

BLUETOOTH® OPERATIONAL TIPS

In the following situations you or the other party may have difficulty hearing each other:

1. Keep the Bluetooth® volume to a low level. High level volume may result in distortion and echo.
2. When driving on a rough road, high speeds and/or with the window open.
3. When the air conditioning vents are facing the microphone and/or when the air conditioning fan is at the max speed.

Steering wheel bluetooth® control

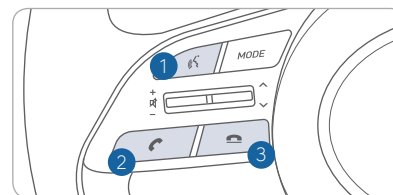

- 1 **TALK**
Activates voice recognition.
- 2 **CALL**
Places and transfers calls.
- 3 **END**
Ends calls or cancels functions.

To Answer a Call:

- Press button on the steering wheel.

To Reject a Call:

- Press button on the steering wheel.

To Adjust Ring Volume:

- Use the VOLUME buttons on the steering wheel.

To Transfer a Call to the Phone (Private call on handset – do not use while driving):

- Press and hold button on the steering wheel until the audio system transfers a call to the phone.

To Finish a Call:

- Press button on the steering wheel.

Making a call using voice recognition:

The menu tree identifies available voice recognition Bluetooth® functions.

Calling by Name:

1. Press button.
2. Say the following command:
 - “Call <John Smith>”: Connects the call to John.
 - “Call <John Smith> on <on Mobile/at Work/at Home>”: Connects the call to John’s Mobile, Home, or Work phone number.

Dialing by Number:

1. Press button.
2. Say “Dial Number”.
3. Say desired phone number.

For complete list of commands, refer to your Owner’s Manual.

AUDIO MODE

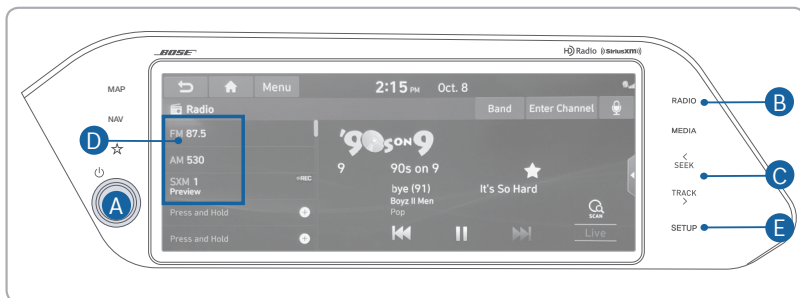

Press POWER button **A** to turn radio on.

• TUNING/LISTENING TO CHANNELS

1. Press the RADIO button **B**.
2. Press the search backward button SEEK **C** or the search forward button TRACK to desired channel.

NOTE: A clear view of the southern sky is recommended to ensure SXM® radio reception.

• SETTING PRESET MEMORY BUTTONS (FM/AM/SXM®)

Press and hold any preset button **D** until an audible beep is heard to store current channel.

• ADJUSTING THE SOUND CONTROL

1. Press SETUP button **E**.
2. Select Sound button on screen.
3. Touch on-screen arrows to adjust desired setting.



STEERING WHEEL AUDIO CONTROL

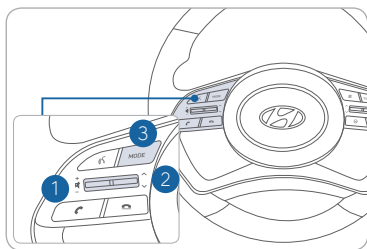

- 1 VOLUME**
Raises or lowers speaker volume.
- 2 SEEK/PRESET**
Change station.
- 3 MODE**
Change the audio source.

NAVIGATION

Basic features on the map screen

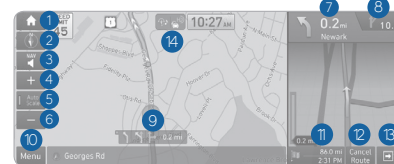

- 1 Displays the Home screen.
- 2 Used to change the map display mode.
- 3 You can adjust the volume of navigation or GPS warning sound.
- 4 Zoom in the map
- 5 The scale of the map automatically changes.
- 6 Zoom out the map
- 7 Guides the point to change the driving direction.
- 8 Guides the next point to change the driving direction.
- 9 Displays the lanes in different colors.
- 10 Displays quick menu items that can be used during a guidance.
- 11 Displays the remaining distance to the destination and the estimated time of arrival. For more details, touch the information item.
- 12 Pause route button to temporarily pause route guidance.
- NOTE:** Press and hold button to CANCEL route guidance.
- 13 Displays or hides the detailed guidance.
- 14 Displays system information on the map.

Destination search screen

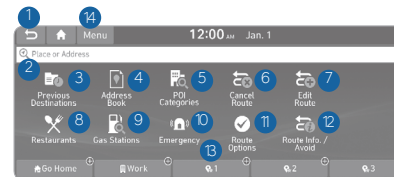

Press [NAV] button in the navigation head unit, and finds a destination by using the [Destination] menu.

- 1 Returns to the previous step.
- 2 Search for a location by entering various types of keywords such as place name and address.
- 3 Select any of previous destinations to set as a destination.
- 4 Register the location or use the address book for setting a destination.
- 5 Search for POIs by category to set as a destination.
- 6 You can cancel guidance to the destination.
- 7 You can edit the current route so that you can travel via waypoints on the way to the destination.
- 8 You can easily search for restaurants.
- 9 You can set a destination after searching for gas stations.
- 10 You can easily search for emergency services.
- 11 You can change the route search criteria to resume routing.
- 12 You can see the entire route information to the destination.
- 13 You can register your home, office, or other frequently visited place as a favorite for ease of search.
- 14 The list of menu items appears.

WIRELESS CELLULAR PHONE CHARGING SYSTEM

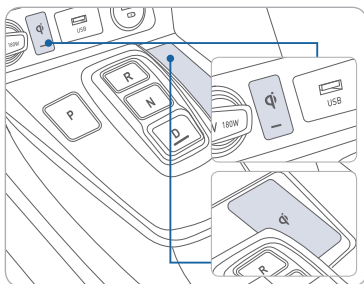

There is a wireless cellular phone charging system inside the front console. The system will operate when all doors are closed, and the ignition switch is in the ACC/ON position. The wireless charging pad is equipped with a cooling fan to help prevent overheating while charging.

NOTE:

The wireless cellular phone charging system supports only the Qi-enabled cellular phones (Qi).

NOTE:

Do not place any metallic items such as coins, keys on the charger. Avoid putting credit cards, etc. on the charger as they might get damaged by the magnetic field.

USB DATA/SMARTPHONE PORT

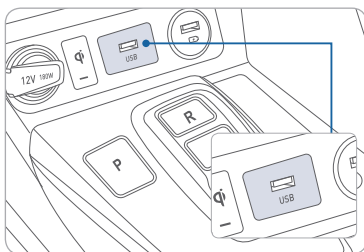

The USB data port can be used to connect an external audio device and listen to it through the audio system in your vehicle.

The USB data port can also be used to access Android Auto or Apple Car Play with your compatible phone.

CLOCK ADJUSTMENT



1. Press the SETUP button.
2. Touch the "Date/Time" button on screen.

HOMELINK WIRELESS CONTROL SYSTEM

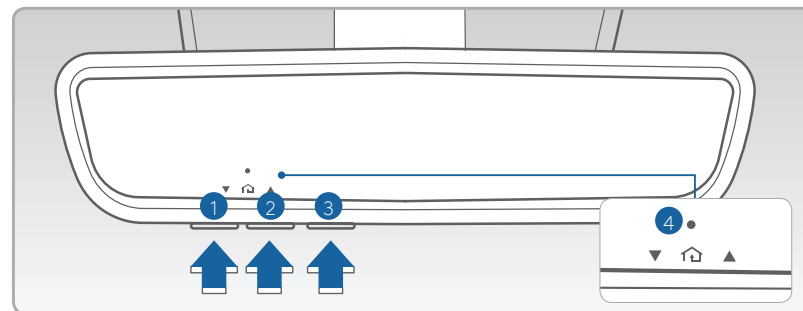

1. Press and release 1, 2 or 3 button.
 - If the indicator 4 is turned ON in Orange, go to Step 3
 - If the indicator 4 is continuously turned ON or flashes in Green rapidly several times, go to Step 2
2. Press and hold the button you wish to program for approximately 15- 25 seconds until the LED flashes in Orange for several times.
3. Hold the Garage Door Opener Original Transmitter near the HomeLink Mirror.
4. Press the Original Transmitter button until the indicator 4 is turned continuously ON or flashes in Green for approximately 10 seconds and it indicates the programming is completed.

NOTE: If the indicator 4 flashes in Green continuously, but if the garage door opener does not operate, please continue to follow Rolling Code Programming steps below.

Rolling Code Programming

1. Firmly press and release the "Learn," "Smart," or "Program" button while the indicator 4 flashes in Green. Once the button is pressed, you have approximately 30 seconds to initiate the next step.
2. Return to the vehicle and firmly press the HomeLink button, hold for two seconds and release the button up to three times. Do not press the HomeLink button rapidly. At this point programming is complete and your device should operate.

For more detailed information, please refer to your Owner's manual or visit www.homelink.com or call (800) 355-3515

ANDROID AUTO™

REQUIREMENTS:

- USB cable
- OS Android™ 5.0 or higher
- Compatible Android Phone
- Data and wireless plan for applicable features

BEFORE YOU BEGIN:

- Android Auto features may operate differently than on your phone.
- Message and data charges may apply when using Android Auto.
- Android Auto relies on the performance of your phone. If you experience performance issues:
 - Close all apps and then restart them
 - Disconnect and then reconnect your phone
- Using the USB cable that was provided with your phone is recommended.
- When Android Auto is active, your in-vehicle voice recognition system is disabled and you will be using talk to Google™ to make your requests.

ANDROID AUTO SUPPORT



<https://support.google.com/androidauto/>

PHONE SETUP

Turn on Bluetooth® on your phone and connect the micro USB cable to your phone and the USB port on the vehicle.

Phone will prompt you to download the Android Auto app and update other needed apps (e.g. Google Maps™, Google Play Music™, Google Now™).

NOTE: Vehicle must be parked.

- Location mode setting should be set to High accuracy.
- Car and phone setup should be completed in one sitting. If phone setup needs to be resumed, recommend to Force Stop the Android Auto app on the Phone then reopen the app and accept the Disclaimer notifications.

CAR SETUP

1. Press the SETUP button on the radio.
2. Touch the “Device Connections” icon on screen.
3. Select Android Auto
4. Select Enable Android Auto
5. Connect your Android phone to the vehicle USB port. Agree to the notification and disclaimers on your phone then the “Android Auto” icon will appear confirming the setup.

For more detailed information on how to operate Android Auto, please refer to your display audio or navigation manual.

For additional Android Auto support, please refer to the Android Auto Support Website
<https://support.google.com/androidauto/>

Android Auto, Google Play, Android, and other marks are trademarks of Google Inc.

APPLE CARPLAY™

REQUIREMENTS

- Apple Lightning® cable (Apple-certified cable)
- Latest iOS
- iPhone® 5 or above
- Data and wireless plan for applicable features

BEFORE YOU BEGIN

- Apple® CarPlay features may operate differently than on your phone.
- Message and data charges may apply when using Apple CarPlay.
- Apple CarPlay relies on the performance of your phone. If you experience performance issues:
 - Close all apps and then restart them
 - Disconnect and then reconnect your phone
- Using the Apple Lightning cable that was provided with your phone is recommended.
- When Apple CarPlay is active, your voice recognition system is disabled and you will be using Siri® to make your requests.

PHONE SETUP

On your phone, go to Settings > General > CarPlay to allow CarPlay access.

On your phone, go to Settings > Siri and ensure Siri is turned ON.

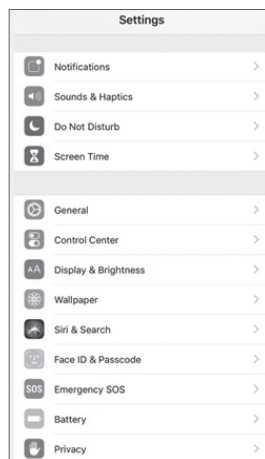

CAR SETUP

1. Press the SETUP button.
2. Touch the “Device Connections” icon on the screen.
3. Touch Apple CarPlay.
4. Touch Enable Apple CarPlay.
5. Connect your Apple iPhone to the vehicle USB port then touch ‘OK’ when the pop-up message appears. The Apple CarPlay icon will now appear on the vehicle Home screen confirming the setup.

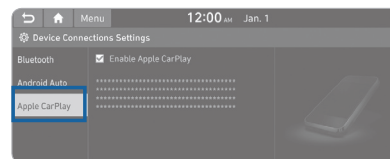

Apple CarPlay, Apple, and other marks are trademarks of Apple Inc.

CarPlay Home Screen

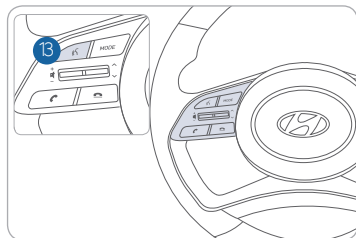

- | | |
|-------------------------|----------------------------------|
| 1 HOME ICON | 7 APPLE MAPS |
| 2 WIRELESS CONNECTIVITY | 8 MESSAGES |
| 3 CELLULAR SIGNAL | 9 3RD PARTY APPS |
| 4 PHONE TIME | 10 SCREEN PAGE INDICATOR |
| 5 PHONE | 11 EXIT TO HYUNDAI |
| 6 APPLE MUSIC™ | 12 CURRENT CARPLAY AUDIO PLAYING |
| | 13 VOICE RECOGNITION TIPS |

SIRI

Apple CarPlay uses Siri to perform many actions like sending messages, placing calls, and looking up/setting POI/Destinations. A Siri session can be initiated on any screen by:

1. Touch and holding the HOME icon 1 on the CarPlay screen or
2. Press the steering wheel VOICE RECOGNITION 13 button.

Note: Ensure Siri feature is set to ON in your phone (Go to Settings > General > Siri).

3. Say any of the following commands;
 - “Text <John Smith> ‘Call you later’” to send a text message.
 - “Read text messages” to read available text message.
 - “Call <John Smith>” to make a phone call.
 - “Find <POI/Destination>” to locate a POI/Destination.

PHONE

Touch the PHONE 5 icon to access the Phone screen. Siri will automatically ask ‘Who would you like to call’ when the PHONE 5 icon is selected.

NOTE: Phone call sound quality is dependent on the wired connection. Using the Lightning cable that came with the phone is recommended.

APPLE MUSIC

Touch the APPLE MUSIC 6 icon to access the Apple Music screen.

APPLE MAPS

Touch the APPLE MAPS 7 icon to access the Apple Map screen.

MESSAGES

Touch the MESSAGES 8 icon to access the Message screen. Siri will automatically ask ‘To hear unread messages or create a new one’ when the MESSAGE icon is selected.

3rd PARTY APPS

Supported CarPlay apps that are downloaded on your phone will appear on the CarPlay screen. Touch the apps icons to access those supported apps.

NOTE: A list of the supported CarPlay supported apps can be found at <http://www.apple.com/ios/carplay/>

Ensure phone has latest version of the 3rd Party Apps.

LANE KEEPING ASSIST SYSTEM (LKAS)

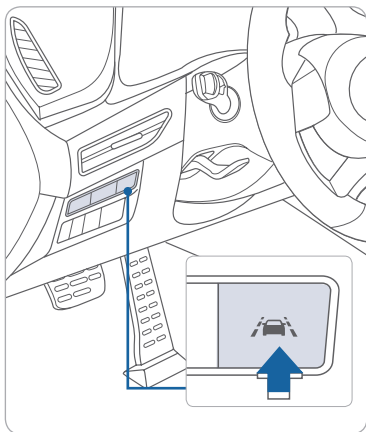

When the Lane Keeping Assist System detects the vehicle straying from its lane, it alerts the driver with a visual and audible warning, while applying a counter-steering torque to help prevent the vehicle from departing from its lane.

- To turn LKAS on, press the LKAS switch.
- To turn LKAS off, press the switch again.
- LKAS settings may be adjusted in the Vehicle Settings menu under Driver Assistance > Lane Safety

NOTE: LKAS Settings can be adjusted in the User Settings page of the instrument cluster under Driving Assist.

For LKAS to operate, vehicle speed must be at least approximately 40 mph to enable the LKA system. The indicator in the cluster display will illuminate green when all the conditions have been met. Refer to the Owner's Manual for more detailed information.

LANE FOLLOWING ASSIST (LFA)

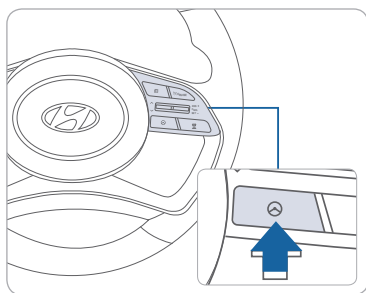

The Lane Following Assist (LFA) system detects lane markers on the road using a multi-function camera mounted on the front windshield. The system helps to assist the driver steering to help keep the vehicle centered in the lane.

To enable the LFA system while driving, press the LFA ON/OFF button on the steering wheel.

Operating conditions

When the system is activated, the indicator (Ⓢ) on the cluster will illuminate. The color of the indicator will change depending on the condition of LFA system.

- Green: Steering assist mode is ON
- White: Steering assist mode is OFF

FORWARD COLLISION-AVOIDANCE ASSIST (FCA)

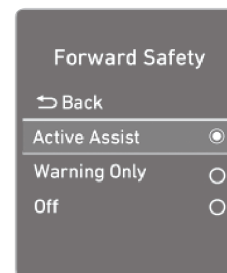

The Forward Collision Avoidance (FCA) system is designed to detect and monitor the vehicle ahead and warn the driver if a collision is imminent. This feature also allows pedestrian detection.

To operate the system, select the Forward Safety Active Assist sub menu in the LCD cluster display under User Settings.

Setup > Vehicle Settings > Driver Assistance > Forward Safety

Please refer to your Owner's Manual for further information.

BLIND-SPOT COLLISION-AVOIDANCE ASSIST (BCA)

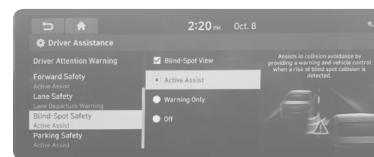

The Blind-Spot Collision-Avoidance Assist (BCA) system may apply braking power, when an approaching vehicle is detected within a certain distance next to or behind your vehicle. The instrument cluster will inform the driver of activation. If vehicle speed exceeds 40 mph the system will activate. Press the switch again to deactivate the system.

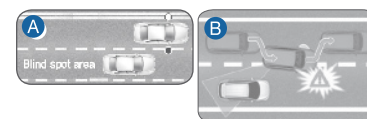

A Blind spot collision warning (BCW)

Warning range is dependent on your vehicle speed. Example, if your vehicle speed is 20 mph greater than other vehicles, the warning is not active.

B Blind spot collision avoidance (BCA)

When changing lanes, the system detects the front lane through the camera installed on the windshield and detects the side/rear areas through radar sensors.

REAR OCCUPANT ALERT (ROA)

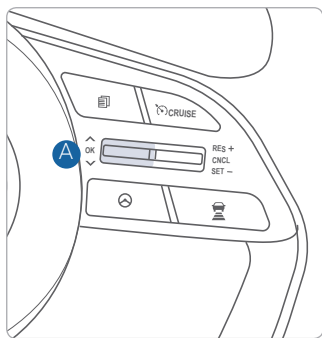

The Rear Occupant Alert system helps prevent exiting the vehicle with the rear passengers left in the vehicle.

1st Alert

When you open the front door after opening and closing the rear door and the engine is off, a “check rear seats” warning message appears.

2nd Alert

When any movement in the vehicle is detected after the driver’s door is closed and all doors are locked, the horn will activate for 25 seconds. To stop this alert, unlock the door with the remote key or smart key.

NOTE: After the first alert, press the OK (A) button on the steering wheel to deactivate the second alert. If the system continues to detect movement, the horn activates up to 8 times. The system detects movement in the vehicle for 24 hours after the doors are locked.

Activate/Deactivate

Select the following items on the instrument cluster in order:

1. Select User Settings on the cluster LCD display
2. Select Convenience
3. Select Rear Occupant Alert

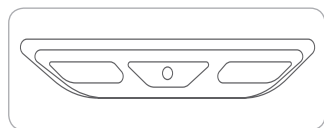

NOTE: The overhead sensor is located above the rear passenger seats.

IDLE STOP AND GO (ISG) (if equipped)

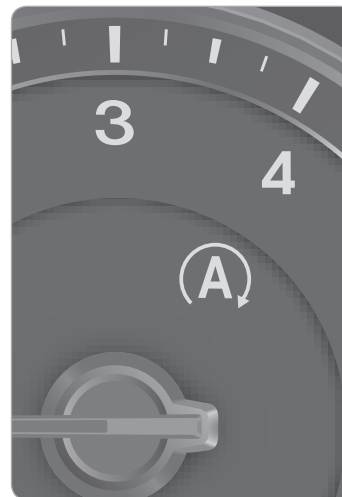

The ISG system will automatically shut off the engine when the vehicle is at a standstill (i.e. red stop light, stop sign, and traffic jam) to increase vehicle’s fuel economy and reduce exhaust gas emissions. The auto stop indicator will illuminate in green on the instrument cluster when activated. To restart the engine in auto stop mode, release the brake pedal (and depress the accelerator pedal when Auto Hold is activated).

The auto stop indicator goes OFF on the instrument cluster once the engine is restarted.

Prerequisite for activation:

- The driver’s seatbelt is fastened.
- The driver’s door and the hood are closed.
- The brake pressure is adequate.
- The battery is sufficiently charged.
- The outside temperature is between 14°F and 95°F (-10°C and 35°C).
- Engine is warmed up.
- The incline is gradual.
- Steering wheel is turned less than 180 degrees.
- Shift lever is in DRIVE or NEUTRAL.

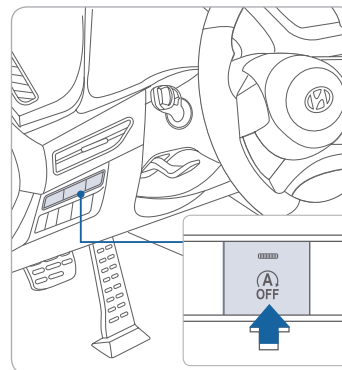

NOTE: The engine will not shut off if the prerequisites are not satisfied. In that case, the Auto Stop indicator will illuminate in yellow on the instrument cluster.

To deactivate

Press the ISG OFF button, indicator illuminates.

To activate

Press the ISG OFF button, indicator turns OFF.

DRIVE MODE

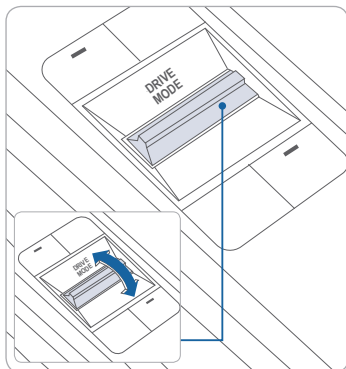

The mode changes, as below, whenever the DRIVE MODE selection switch is toggled up and down. An indicator will illuminate on the instrument cluster when the vehicle is in sport mode or smart mode. When the vehicle is in normal mode, it is not displayed on the instrument cluster.

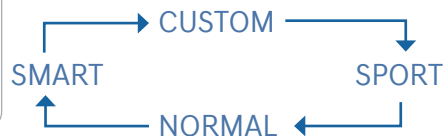

NORMAL mode:

In normal mode, the engine and transmission control logic work together to provide regular daily driving performance with fuel efficiency.

SPORT mode:

Sport mode manages the driving dynamics by automatically adjusting the steering effort, and the engine and transmission control logic for enhanced driving performance. When sport mode is activated, the engine RPM will be a little higher than normal.

SMART mode:

Smart mode selects the proper driving mode between normal and sport by judging the driver's driving habits.

NOTE: Whenever the engine is restarted, the drive mode will revert back to the default normal mode

CUSTOM mode:

In custom mode, the driver can select separate modes and combine them on the infotainment screen. When custom mode is selected, the custom mode indicator will illuminate.

TIRE PRESSURE MONITORING SYSTEM (TPMS)

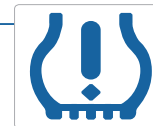
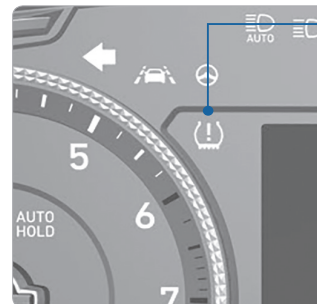

Low Tire Pressure Indicator / TPMS Malfunction Indicator



Low Tire Pressure / Tire Pressure Monitor / TPMS Malfunction Display (shown on the cluster LCD display)

LOW TIRE PRESSURE INDICATOR

Illuminates if one or more of your tires are significantly under-inflated.



TPMS MALFUNCTION INDICATOR

Blinks for approximately one minute, then remains illuminated when there is a malfunction with the TPMS. Inspect all tires and adjust the tire pressure to specification. If the lamp remains illuminated, it is recommended that the vehicle be checked by an authorized HYUNDAI dealer.

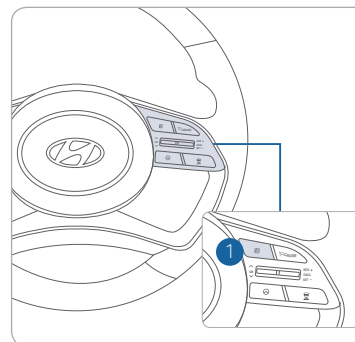
LOW TIRE PRESSURE / TIRE PRESSURE MONITOR / TPMS MALFUNCTION DISPLAY(LCD DISPLAY)



Select the Assist mode  by pressing the MODE **1** button on the steering wheel to display tire pressure.

Tire pressures will display after driving a short distance. If a tire pressure drops lower than predetermined specification, the Low Tire Pressure Indicator  will illuminate and the cluster  display will indicate which tire requires air.

NOTE: Environmental factors can affect the tire pressure. The two main environmental factors are ambient air temperature and elevation. Colder ambient air will reduce tire pressure, while hotter ambient air will increase tire pressure. High elevation may also increase tire pressure.

CRUISE CONTROL/SMART CRUISE CONTROL

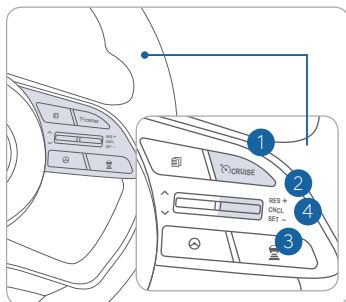

The Cruise Control system allows you to program the vehicle to maintain a constant speed without holding the accelerator pedal.

- 1 To turn On/Off cruise control.
- 2 Toggle switch UP to Resume or Increase the cruise control speed.
- 3 Toggle switch DOWN to Set or Decrease the cruise control speed.
- 4 To Cancel the Cruise Control.

Setting Vehicle Distance (Smart Cruise Control only)

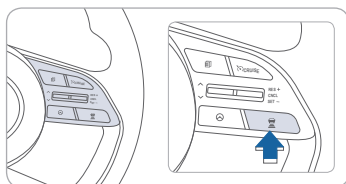

This system assist you in setting the distance from the vehicle ahead and will maintain the selected distance without you depressing the accelerator or the brake pedal.

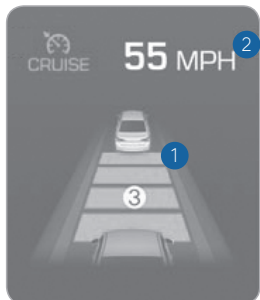

Press the button to set and maintain the vehicle-to-vehicle distance without pressing the accelerator or brake pedal.

The vehicle-to-vehicle distance 1 will automatically activate when you set the cruise speed 2.

Each time the button is pressed, the vehicle-to-vehicle distance changes as follows:



Setting Cruise Control

1. Press the "CRUISE" button 1 to turn on Cruise Control. The icon will illuminate in the instrument cluster.
2. Toggle "-SET" switch (3) DOWN to set cruising speed.

Adjusting the vehicle speed

1. Toggle "+RES" switch 2 UP to increase cruising speed.
2. Toggle "-SET" switch 3 DOWN to decrease cruising speed.

NOTE: Quick toggle up/down will change speed by 1 mph. Holding switch up/down will change speed by 5 mph.

To Cancel Cruise Control

Press the "CANCEL" button 4 or depress the brake pedal.

Please refer to your Owner's Manual for more information.

LEADING VEHICLE DEPARTURE ALERT

The Leading Vehicle Departure Alert system alerts the driver of the departure of the vehicle in front when the vehicle is stopped and the Smart Cruise Control (SCC) is in activation.

To activate

Select the following items on the instrument cluster in order:

1. Select User Settings on the cluster LCD display.
2. Select Driver Assistance
3. Select Driver Attention Warning
4. Select Leading Vehicle Departure Alert

The system stops operation when the setting is deactivated. However, if the engine is turned off then on again, the system maintains in the previous state.

HIGHWAY DRIVING ASSIST (HDA) (if equipped)

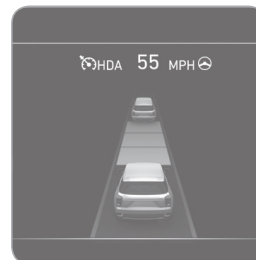

The Highway Driving Assist (HDA) system helps keep the vehicle between lanes, maintain a distance with the vehicle ahead, and automatically adjusts the vehicle speed to the speed limit while driving on the highway.

With the Engine Start/Stop button in the ON or START position, the Highway Driving Assist can be activated from the Settings menu in the infotainment system screen by selecting the following:
'Setup → Vehicle Settings → Driver Assistance → Highway Driving Assist' Deselect the setting to turn off the system.

NOTE: If the engine is turned off then on again, the system maintains the last setting.

Operating Conditions:

- Driving on the highway main line.
- Smart Cruise Control is operating.
- If the Smart Cruise Control is in the READY state the Highway Driving Assist will be in the READY state. The indicator on the cluster will illuminate white.
- Vehicle speed is under 95 mph (153 km/h).

If all the mentioned conditions are satisfied, the system is ENABLED and the indicator on the cluster will illuminate green.

PUSH BUTTON DRIVE SELECTOR

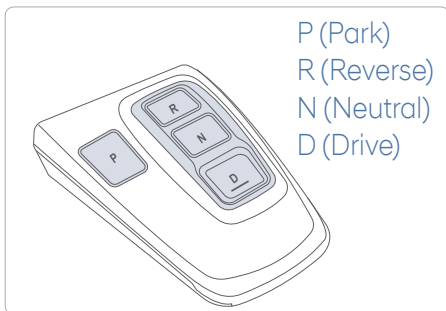

P (Park)
R (Reverse)
N (Neutral)
D (Drive)

P (Park)

Always come to a complete stop before shifting into P (Park). To shift from P (Park), you must depress firmly on the brake pedal and make sure your foot is off the accelerator pedal. The gear must be in P (Park) before turning the engine off.

Shift-lock system

For your safety, the automatic transmission has a shift-lock system which prevents shifting the gear from P (Park) or N (Neutral) to R (Reverse) or D (Drive) unless the brake pedal is depressed. To shift the gear from P (Park) or N (Neutral) to R (Reverse) or D (Drive):

1. Depress and hold the brake pedal.
2. Start the engine or place the ignition switch in the ON position.
3. Depress the brake pedal and push the R (Reverse) or D (Drive) button.

CAUTION: The surface of the drive selector can get very hot when exposed to direct sunlight, be cautious when shifting gears.

REAR CROSS-TRAFFIC COLLISION-AVOIDANCE ASSIST (RCCA)

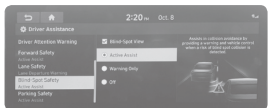

The RCCA system uses radar sensors to monitor approaching vehicles to the left and right while your vehicle is in reverse. If the risk of collision is detected while the RCCW is generated, brake is controlled. The instrument cluster will inform the driver of the brake control. If the rear view monitor system is in activation, a message will also appear on the audio or AVN screen.

Activate/Deactivate

Select the following items on the instrument cluster in order:

1. Select User Settings
2. Select Driver Assistance
3. Select Parking Safety
4. Select Rear Cross Traffic Safety

ELECTRIC PARKING BRAKE (EPB)

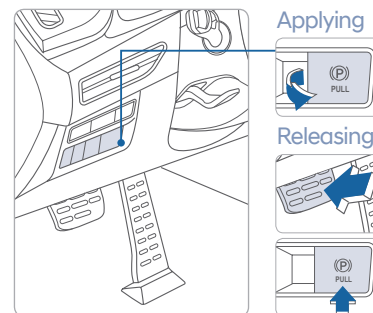

Applying



Stop the vehicle then pull the EPB switch.

Releasing



Press the EPB switch while depressing the brake pedal.

NOTE: If necessary, emergency braking is possible by pulling and holding the EPB switch.

AUTO HOLD

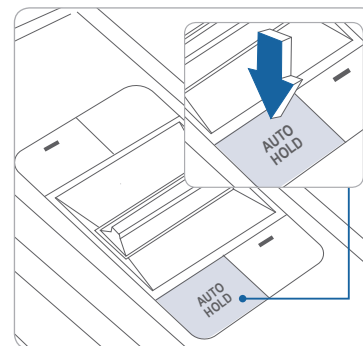

The Auto Hold feature assists in steep hill areas. It holds the brake until the accelerator pedal is pressed.



1. Press the AUTO HOLD switch.



2. Stop the vehicle by pressing the brake pedal. The brakes will remain engaged even if the brake pedal is released.



3. The brakes will release when the accelerator pedal is pressed with transmission in D, R or manual mode.

To cancel the AUTO HOLD operation, press the AUTO HOLD switch again.

DIGITAL KEY PAIRING (if equipped)

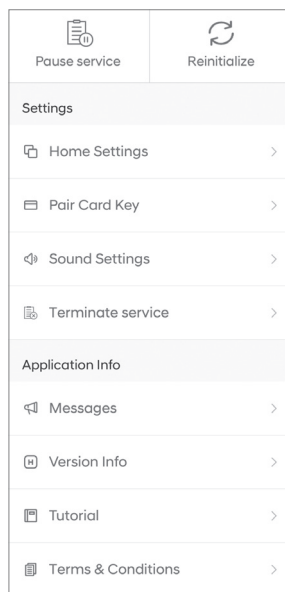
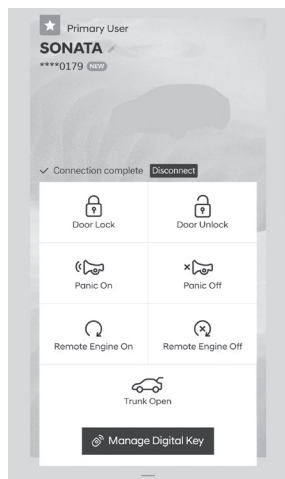

Hyundai Digital Key allows drivers to start the engine of their car using a smartphone app and Near-Field Communication (NFC). Hyundai Digital Key provides many of the same functions as your physical key. To pair your smartphone, complete the following steps:

1. Login to the Hyundai Digital Key Application using your MyHyundai username and password
2. Start the vehicle with the proximity key
3. Pair the phone to the vehicle as follows:
 - Navigation Vehicles: Settings → Vehicle → Digital Key → Smartphone Key → Save
 - Display Audio: Instrument Cluster User Settings Mode → Digital Key → Smartphone Key → Save
4. Open the Hyundai Digital Key Application on the primary user's smartphone. Select the + Icon on the main screen of the smartphone app.
5. Place the smartphone on the Wireless Phone Charger in the vehicle and the process will begin automatically
6. Once the screen in the vehicle says saved, your Digital Key is ready to use.

NOTE: This application is only available for Android users.

If the NFC card is lost or stolen, please contact your local Hyundai dealer for replacement.

NEAR FIELD COMMUNICATION (NFC)



Pair Card Key authentication

- Authenticate using NFC
- Authenticate using BLE

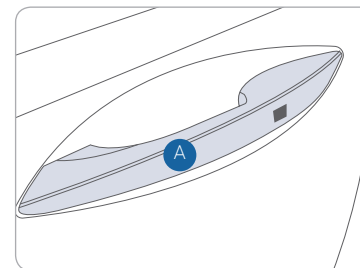

To lock/unlock your vehicle using the NFC key card, hold the key card up to the center of the door handle **A**.

If you try to lock your vehicle with the NFC card under the following conditions, it will not work:

- The Smart Key is in the vehicle.
- The POWER button is in ACC or ON position.
- Any of the doors, hood and trunk are open.

NOTE: If you overlap and use the key card with other NFC-enabled cards such as a transportation card or credit card, it will not work.

*For security reasons, the vehicle can only have one NFC key card paired to it at one time. Any time that a new Key card is paired to the car it will disable the previously paired Key Card .

SONATA CUSTOMER DELIVERY CHECK LIST

HYUNDAI OWNER	DEALERSHIP NAME
SALES CONSULTANT	DATE
VIN	PREVIOUS VEHICLE

BEFORE DELIVERY

- SET TIRE PRESURE LF___ RF ___ RR___ LR___
- VERIFY VEHICLE IS CLEAN, IN GOOD CONDITION, FREE OF CHIPS AND SCRATCHES · CLEAN WINDSHIELD AND BACK WINDOW
- ENSURE FLOORMATS ARE SNAPPED INTO PLACE

WALK THE CUSTOMER THROUGH EACH OF THE FOLLOWING KEY DELIVERY FEATURES

- REVIEW QUICK REFERENCE GUIDE
- PAIR CUSTOMER'S PHONE TO THE BLUETOOTH SYSTEM (if equipped) - page 17
- OPERATION OF THE NAVIAGATION SYSTEM (if equipped) - page 20
- REVIEW AND TEAR OFF VOICE COMMAND / QUICK TIP CARD
- OPERATION OF THE AUDIO SYSTEM
- HOW TO DEFROST - page 13
 - ① Press the front defrost button.
 - ② Set to warmest temperature setting.
 - ③ Set to highest fan speed.
- TIRE PRESSURE MONITORING SYSTEM (TPMS) - page 34



LOW TIRE PRESSURE INDICATOR /
TPMS MALFUNCTION INDICATOR

NOTE: Tire pressure may vary in colder temperatures causing the low tire pressure indicator  to illuminate. Inflate tires according to the Tire Pressure Label located on the driver's side door pillar.

CONNECTING YOUR PHONE

On the radio:

1. Push the **SETUP** button.
2. Select **Bluetooth**.
3. Select **Bluetooth Connection**.
4. Select **Add New**.

In your phone's Bluetooth settings:

5. Select the <Vehicle Name> on your phone.
6. Enter the passkey from the radio or accept the authorization pop-up on your phone.

SWITCHING BETWEEN PAIRED PHONES

Using Voice Command:
"Change Bluetooth device"

On the radio:

1. Push the **SETUP** button.
2. Select **Bluetooth**.
3. Select **Bluetooth Connection**.
4. Select **Connect** next to the desired phone.

For more information, visit
HyundaiBluetooth.com