

**VOICE RECOGNITION TIPS** (If equipped)

**BLUETOOTH®**

**Command** **Example**  
 Dial <Phone #> — “Dial 7-1-4-9-6-5-3-0-0-0”  
 Call <Name> — “Call John Smith”

Improving how you store your contacts can optimize your Bluetooth® Voice Recognition performance:  
 • Use full names instead of short or single-syllable names (“John or Dad”)  
 • Avoid using special characters/emojis or abbreviations (“Dr.”) when saving contacts

**NAVIGATION**

**Command** **Example**  
 Find Address — “1-2-3-4-5 1st Street, <House #, Street, City, State>”  
 Find <POI Name> — “Find McDonald’s”

Located on Rearview Mirror  
**LOCAL SEARCH**

**Command** **Example**  
 Find <POI Name> — “Find Lowe’s® near me”  
 <POI Name> — “Starbucks®”

HOW TO DEFROST - page 15

- 1 Press the front defrost button.
- 2 Set to warmest temperature setting.
- 3 Set to highest fan speed.

WINDSHIELD WIPER / WASHER - page 08

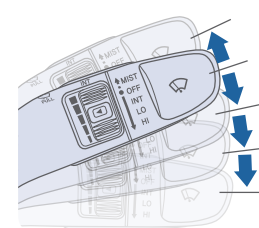

- MIST** • To activate wipers, move the switch down to one of the three positions (INT, LO, HI).
- OFF**
- INT** • To adjust "INT" speed, move switch.
- LO** • To spray washer fluid, pull lever toward you.
- HI** • Push lever up for a single wiper pass.

INTRODUCTION AND LOCATION OF THE SERVICE DEPARTMENT

SET FIRST SERVICE APPOINTMENT

REVIEW FACTORY RECOMMENDED MAINTENANCE SCHEDULE

WAS THE CONDITION OF YOUR VEHICLE (AT DELIVERY) TO YOUR SATISFACTION?

**MAINTENANCE**

Scheduled Maintenance	Normal Usage		Severe Usage*	
Engine Oil and Filter*	Replace	7,500 or 12 mos.	Replace	3,750 or 6 mos.
Fuel Additive	Add	7,500 or 12 mos.	Add	Same as Normal
Tire Rotation	Perform	7,500	Perform	7,500
Air Cleaner Filter	Inspect Replace	7,500 30,000	Inspect Replace	Same As Normal More Frequently
Vacuum Hose	Inspect	7,500	Inspect	Same As Normal
Climate Control Air Filter (for Evaporator and Blower Unit)	Replace	15,000	Replace	More Frequently
Air Conditioning Refrigerant	Inspect	15,000	Inspect	Same As Normal
Brake Hoses & Lines	Inspect	15,000	Inspect	Same As Normal
Drive Shafts & Boots	Inspect	15,000	Inspect	7,500
Exhaust Pipe & Muffler	Inspect	15,000	Inspect	Same As Normal
Front Disc Brake/Pads, Calipers & Rotors	Inspect	15,000	Inspect	More Frequently
Rear Brake Disc/Pads	Inspect	15,000	Inspect	More Frequently
Steering Gear Box, Linkage & Boots/ Lower Arm Ball Joint, Upper Arm Ball Joint	Inspect	15,000	Inspect	More Frequently
Suspension Mounting Bolts	Inspect	15,000	Inspect	Same As Normal
Brake Fluid	Inspect	30,000	Inspect	Same As Normal
Engine Clutch Actuator Fluid	Replace	22,500	Replace	Same As Normal
Crankcase Ventilation Hose	Inspect	30,000	Inspect	Same As Normal
Fuel Filter	Inspect	30,000	Inspect	Same As Normal
Fuel Lines, Fuel Hoses and Connections	Inspect	30,000	Inspect	Same As Normal
Fuel Tank Air Filter	Inspect	30,000	Inspect	Same As Normal
Parking Brake	Inspect	30,000	Replace	More Frequently
Vapor Hose, Fuel Tank & Fuel Filler Cap	Inspect	30,000	Replace	Same As Normal
Spark Plugs	Replace	105,000	Replace	More Frequently
HSG Belt	Inspect Replace	7,500 or 12 mos. 60,000 or 48 mos.	Inspect Replace	3,750 or 6 mos. 30,000 or 24 mos.
Coolant		1st Replace 120,000 or 120 mos. Add'l Replace 30,000 or 24 mos.	Replace	Same As Normal
Dual Clutch Transmission Fluid	Inspect	37,500	Replace	75,000

\*Check the engine oil regularly between recommended oil change. Hyundai recommends Quaker State oil.  
 \*See Owner's Manual for details.

Looking for more detailed information? This Quick Reference Guide does not replace your vehicle's Owner's Manual. If you require additional information or are unsure of a specific issue, we recommend that you always refer to the vehicle's Owner's Manual or contact your authorized Hyundai dealer. The information contained in this Quick Reference Guide is correct at the time of printing; however, specifications and equipment can change without notice. No warranty or guarantee is being extended in this Quick Reference Guide, and Hyundai reserves the right to change product specifications and equipment at any time without incurring obligations. Some vehicles are shown with optional equipment.



# HYUNDAI IONIQ PLUG-IN

Quick Reference Guide

Sales Consultant \_\_\_\_\_ Date \_\_\_\_\_ Sales Manager \_\_\_\_\_ Date \_\_\_\_\_

Customer \_\_\_\_\_ Date \_\_\_\_\_

Email \_\_\_\_\_

NP150AE193  
 (Rev 08/15/18)  
 Printing 08/18/18

Roadside Assistance: 1-800-243-7766  
 Consumer Affairs: 1-800-633-5151  
 Sirius XM® Radio: 1-800-967-2346  
 Blue Link: 1-855-2BLUELINK  
 (1-855-225-8354)



## **HYUNDAI VEHICLE OWNER PRIVACY POLICY**

Your Hyundai vehicle may be equipped with technologies and services that use information collected, generated, recorded or stored by the vehicle. Hyundai has created a Vehicle Owner Privacy Policy to explain how these technologies and services collect, use, and share this information.

You may read our Vehicle Owner Privacy Policy on the Hyundaiusa.com website at <https://www.hyundaiusa.com/owner-privacy-policy.aspx>. If you would like to receive a hard copy of our Vehicle Owner Privacy Policy, please contact our Customer Connect Center at:

Hyundai Motor America  
Hyundai Customer Connect Center  
P.O. Box 20850  
Fountain Valley, CA 92728-0850  
800-633-5151 [consumeraffairs@hmausa.com](mailto:consumeraffairs@hmausa.com)

Hyundai's Customer Connect Center representatives are available Monday through Friday, between the hours of 5:00 AM and 7:00 PM PST and Saturday and Sunday between 6:30 AM and 3:00 PM PST (English). For Customer Connect Center assistance in Spanish or Korean, representatives are available Monday through Friday between 6:30 AM and 3:00 PM PST.

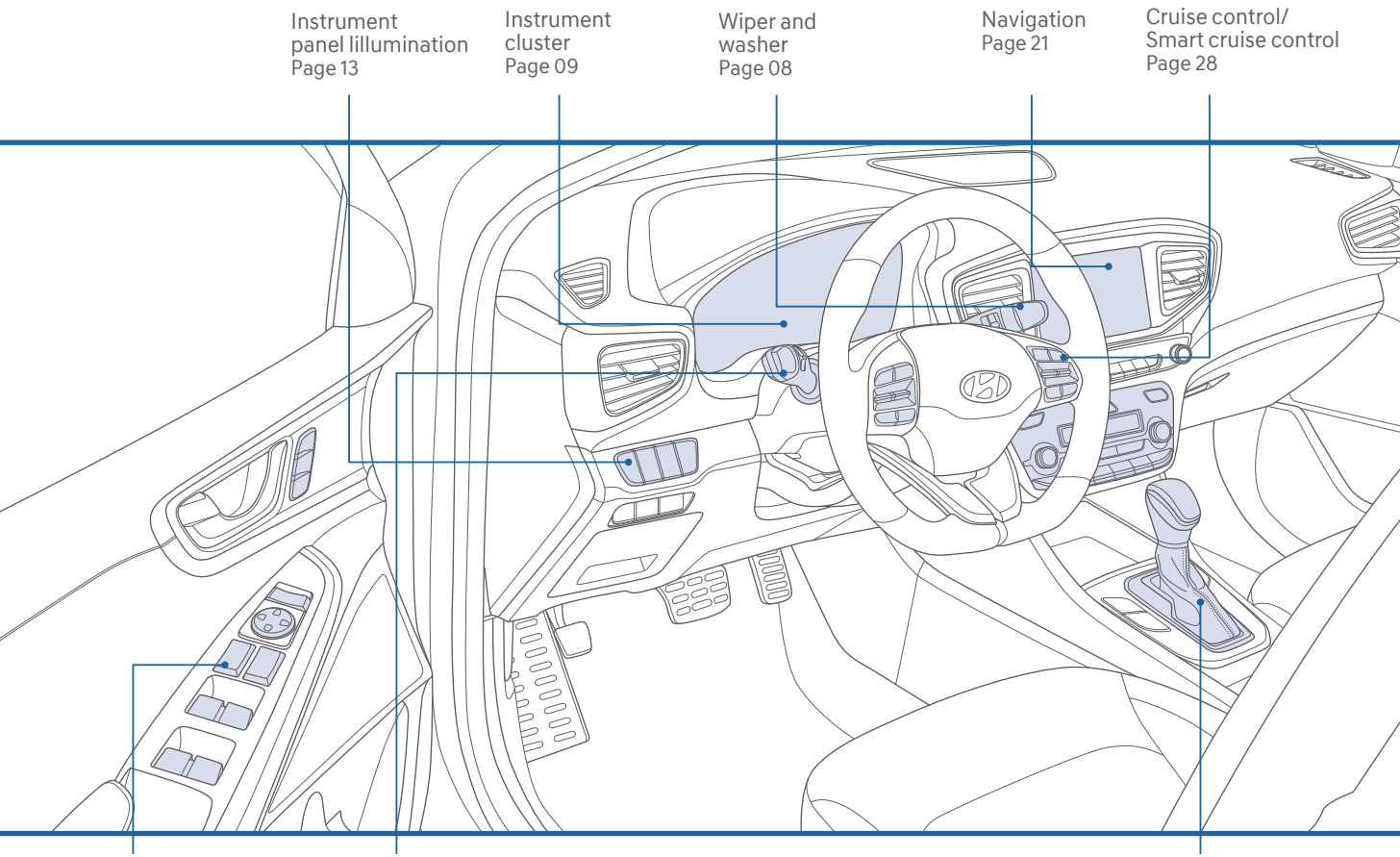

Instrument panel illumination  
Page 13

Instrument cluster  
Page 09

Wiper and washer  
Page 08

Navigation  
Page 21

Cruise control/  
Smart cruise control  
Page 28

Driver's main controls  
Page 02

Headlights  
Page 07

Dual clutch transmission  
Page 25

## FEATURES AND CONTROLS

Aux. Battery saver+	13
Charging the vehicle	03
Climate control	17
Driver's main controls	02
Dynamic bending light (DBL)	08
Fuel filler door	06
Headlights	07
Hybrid battery SOC(State Of Charge) gauge	12
Instrument cluster	09
Instrument panel illumination	13
LCD display control	15
LCD display modes	16
Liftgate opening	06
Plug-in Hybrid electric vehicle system modes	14
Plug-in hybrid mode	12
Seat-Front seat adjustment (manual)	01
Seat-Front seat adjustment (power)	01
Vehicle power gauge	12
Warning and indicators	11
Wiper and washer	08

## MULTIMEDIA

AUX, USB and iPod® port	22
Clock adjustment	23
Navigation	21
Radio mode	19

## DRIVING

Cruise control/smart cruise control	28
Dual clutch transmission	25
Paddle shifter	27

\* Some vehicles may not be equipped with all the listed features.

### WARNING!

To reduce the risk of serious injury to yourself and others, read and understand the important SAFETY INFORMATION in your Owner's Manual.

Use this Quick Reference Guide to learn about the features that will enhance your enjoyment of your Hyundai. More detailed information about these features are available in your Owner's Manual.

## FRONT SEAT ADJUSTMENT (Manual)

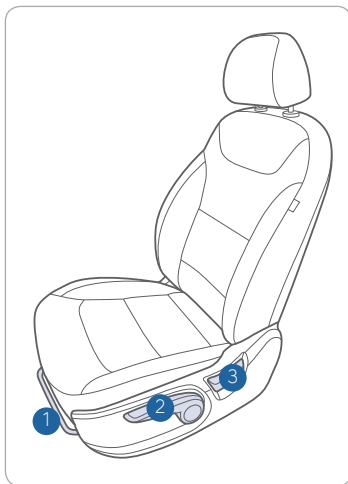

### Forward and backward ①



### Seat height ②



- Push down on the lever several times to lower the seat.
- Pull up the lever several times to raise it.

### Seatback angle ③



## DRIVER'S MAIN CONTROLS

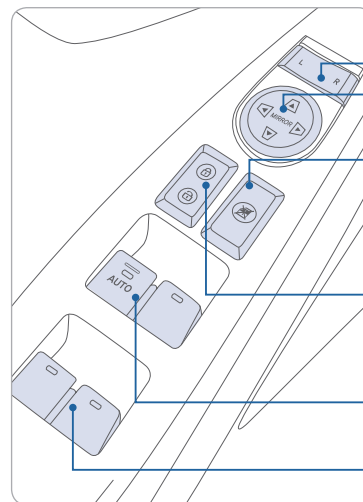

### Side view mirror

- Press the L or R button.
- Adjust the mirror by using the directional switch.

### Power window lock button

Disables the power window switches on the rear passenger doors.

### Door lock

Locks/unlocks all doors.

### Window switches

- Front doors power window switches.
- Rear doors power window switches.

## FRONT SEAT ADJUSTMENT (Power)



### Forward and backward ①

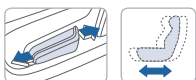

### Seat height ①

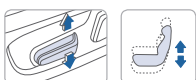

### Seatback angle ②



### Lumbar support ③



## CHARGING THE VEHICLE

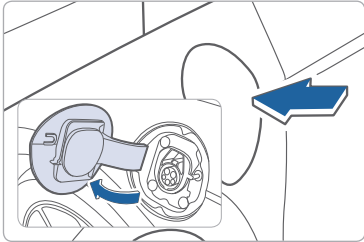

1. Move the shift lever to P (Park), turn off all switches, and turn OFF the vehicle.
2. Press center edge of the charging door to open the charging door. The charging door opens only when the vehicle door is unlocked.

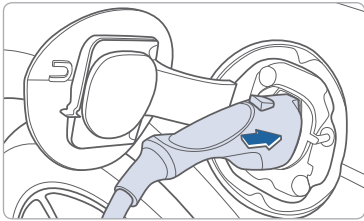

3. Insert the charging connector into the charging inlet until you hear a clicking sound.
4. Connect the charging plug to the electric outlet at a normal charging station to start charging.



5. Check if the charging cable indicator light of the high voltage battery on the instrument cluster is turned ON.

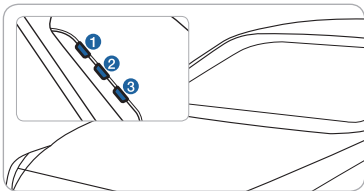

### Unlock Charging Connector in Emergency

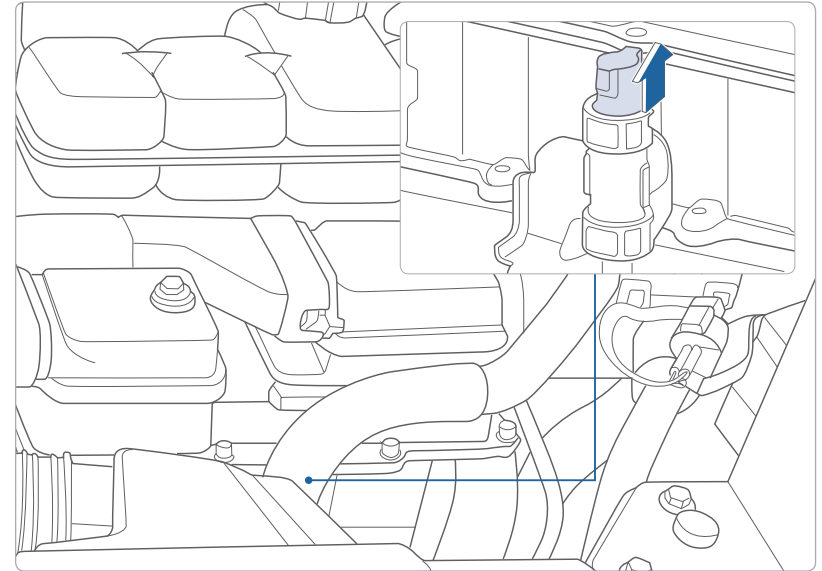

If the charging connector does not disconnect due to battery discharge and failure of the electric wires, open the hood and slightly pull the emergency cable. The charging connector will then disconnect.

## Level 1 Charger

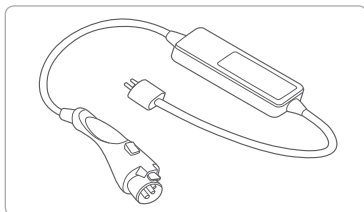

Level 1 charging can be used if a Level 2 charger is not available.

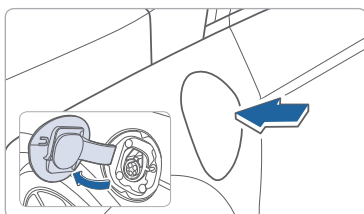

1. Move the shift lever to P (Park), turn off all switches, and turn OFF the vehicle.
2. Press center edge of the charging door to open the charging door. The charging door opens only when the vehicle door is unlocked.

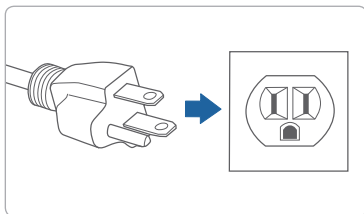

3. Connect the plug to a household electric outlet.
4. Check if the power lamp (green) illuminates on the control box.

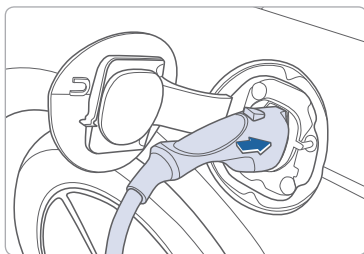

5. Insert the charging connector into the charging inlet until you hear a clicking sound.
6. Charging starts automatically (charging lamp on the control box blinks).

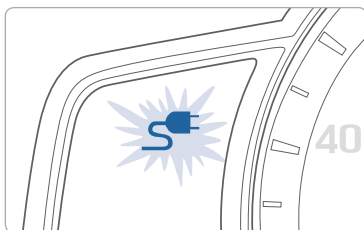

7. Check if the charging indicator light of the high voltage battery on the instrument cluster is turned ON.

## FUEL FILLER DOOR

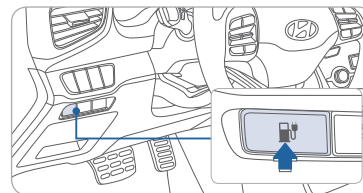

1. Push the fuel filler door opener button.



2. Wait until the fuel tank is depressurized. It may take up to 20 seconds to open the fuel filler door.

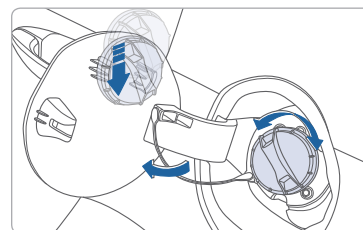

3. Remove the fuel tank cap.

**NOTE:** Tighten the fuel filler cap until one click is heard.

## LIFTGATE OPENING

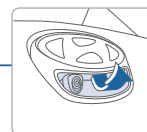
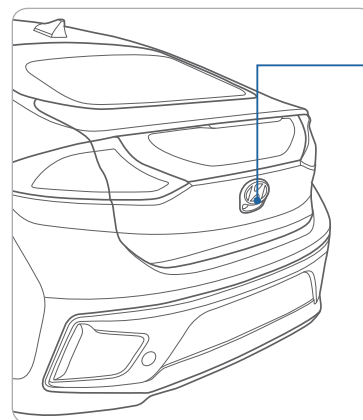

Press to open. Smart key needs to be within the range.

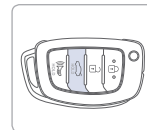

Press and hold button to unlock tailgate.

## HEADLIGHTS

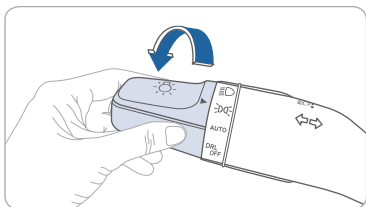

- ▶ | Headlights
- ▶ | Parking lights
- ▶ | **AUTO** Auto headlights
- ▶ | **DRL OFF** All Lights Off

### Headlight Delay

Headlights may stay on for 15 seconds after exiting and locking vehicle. Press the lock button on the smart key twice to turn the headlights off.

### Turn signals and lane change signals

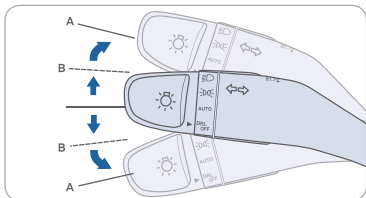

### Flashing headlights

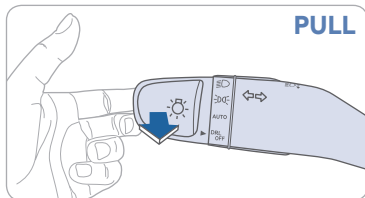

### High beam / Smart high beam

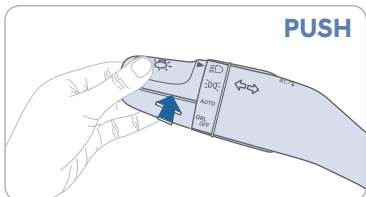

**NOTE:** To turn off the high beam, pull the lever towards you.

### Smart High Beam Function

1. Select auto position.
2. Push lever forward to engage Auto High Beam.
3. Push lever forward again to disengage.

## DYNAMIC BENDING LIGHT (DBL)

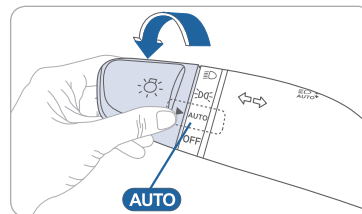

DBL uses the steering angle and vehicle speed to help keep your field of vision wide by swiveling and leveling the headlamp.

- To turn DBL on, turn the knob to the AUTO position when the vehicle is in the ready (🚗) mode.
- To turn DBL off, turn the knob back to the former position.

## WIPERS AND WASHER

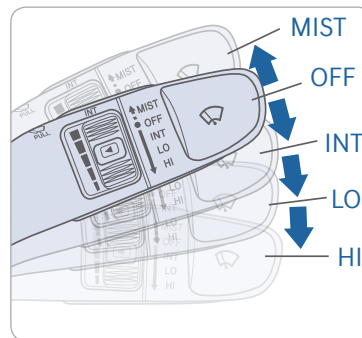

**MIST** - Single wipe

**OFF** - Off

**INT** - Intermittent wipe

**LO** - Low wiper speed

**HI** - High wiper speed

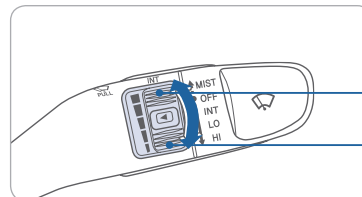

**Intermittent wipe time adjustment**  
Move the speed control switch

Fastest wiper speed

Slowest wiper speed

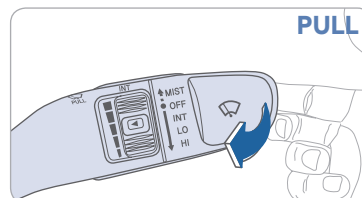

### Windshield Washer

Pull the lever gently towards you to spray washer fluid on the windshield and to run the wipers 1-3 cycles.

## INSTRUMENT CLUSTER

### Type A

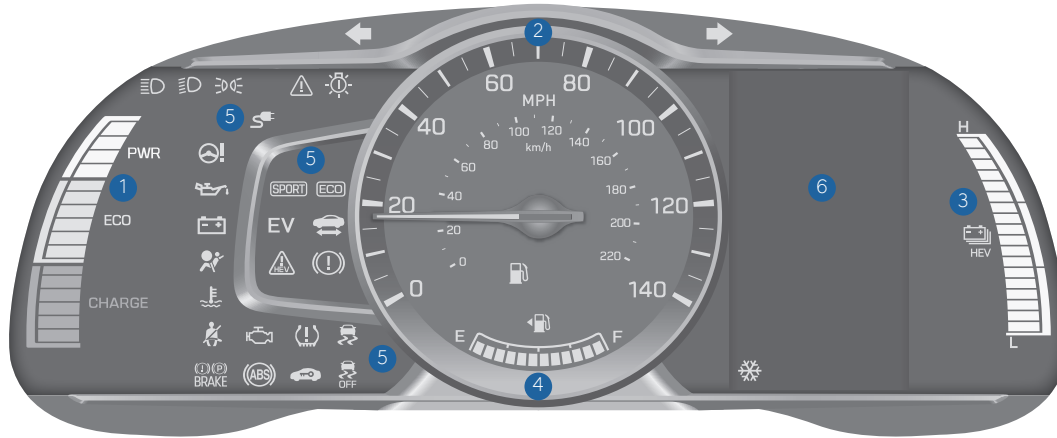

- ① Power gauge
- ② Speedometer
- ③ Battery SOC (State of Charge) gauge
- ④ Fuel gauge
- ⑤ Warning and indicator lights
- ⑥ LCD display (including Trip computer)

### Type B





**WARNINGS AND INDICATORS**

Ready indicator	Service warning light	EV EV mode indicator
Charging cable connection indicator*	Parking brake & brake fluid warning light	Regenerative brake warning light
Air bag warning light	Seat belt warning light	Electric Power Steering (EPS) warning light
Anti-lock Brake System (ABS) warning light	Electronic Brake force Distribution (EBD) System warning light	Engine oil pressure warning light
Malfunction Indicator Lamp (MIL)	Charging system warning light	Low tire pressure warning light / TPMS malfunction
Low fuel level warning light	Engine coolant temperature warning light	Electronic Stability Control (ESC) OFF indicator light
Master warning light	Electronic Stability Control (ESC) Indicator Light	High beam indicator light
Immobilizer indicator	Turn signal indicator light	CRUISE Cruise indicator
Light ON indicator light	LED Headlight warning light	Exterior light warning light
SET Cruise SET indicator	SPORT SPORT mode indicator	ECO ECO mode indicator
Autonomous Emergency Braking (AEB) warning light	Lane Keeping Assist System (LKAS) indicator	

\*: Plug-in hybrid

Main indicators in cluster for Hybrid Vehicle

- Ready indicator**  
 When the vehicle is ready to be driven, this indicator is illuminated. When the ready indicator goes off or blinks, we recommend the vehicle be checked by an authorized HYUNDAI dealer.
- EV mode indicator**  
 This indicator illuminates when the vehicle is driven by the electric motor.
- Service warning light**  
 If a problem with the hybrid vehicle control system occurs, the service warning light will illuminate. We recommend the vehicle be checked by an authorized HYUNDAI dealer.
- Charging cable connection indicator (Plug-in Hybrid)**  
 This indicator illuminates in red when the charging cable is connected.

**VEHICLE POWER GAUGE**

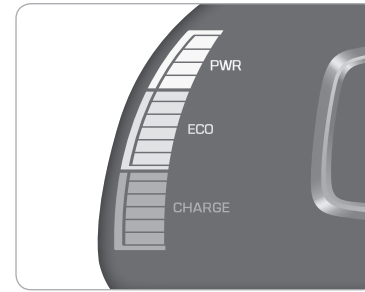

The vehicle power gauge indicates whether the current driving condition is fuel efficient or not.

**CHARGE**

Shows that the energy made by the vehicle is being converted to electrical energy. (Regenerated energy)

**ECO**

Shows that the vehicle is being driven in an Eco-friendly manner.

**POWER**

Shows that the vehicle is exceeding the Eco-friendly range.

**HYBRID BATTERY SOC (STATE OF CHARGE) GAUGE**

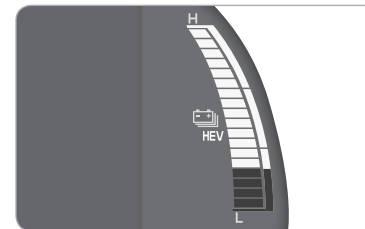

This gauge indicates the remaining hybrid battery power. If the SOC is near the "L (Low)" level, the vehicle automatically operates the engine to charge the battery.

**PLUG-IN HYBRID MODE**

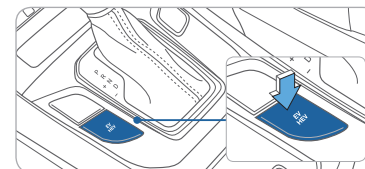

**EV/HEV Button**

Press the [EV/HEV] button to change the plug-in hybrid system modes, between Electric (CD) mode and Hybrid (CS) mode.



**CD (Charge Depleting, Electric) mode**

The high-voltage (hybrid) battery is used to drive the vehicle.



**CS (Charge Sustaining, Hybrid) mode**

The high-voltage (hybrid) battery and gasoline engine is used to drive the vehicle.

## INSTRUMENT PANEL ILLUMINATION

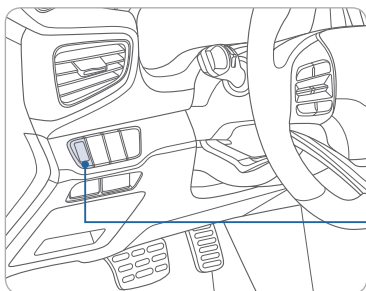

Press the illumination control button to adjust the instrument cluster illumination brightness.

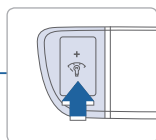

## AUX. BATTERY SAVER+

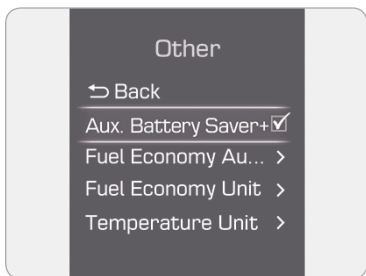

The Aux. Battery Saver+ function monitors the charging status of the 12 V auxiliary battery. If the auxiliary battery level is low, the main high voltage battery charges the auxiliary battery. The default setting for Aux. Battery Saver+ is ON. The driver may cancel the function. Go to 'User Settings → Other Features → Aux. Battery Saver+'.

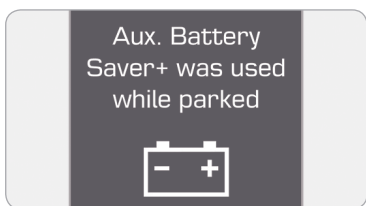

The message is displayed if the Aux. Battery Saver+ function was activated.

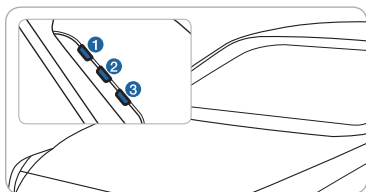

When the function is activating the third Charging Indicator Lamp will blink.

**NOTE:** Do not touch the high voltage electric wire (orange), connector, and all electric components and devices when the function is activating.

## PLUG-IN HYBRID ELECTRIC VEHICLE SYSTEM MODES

### Type A

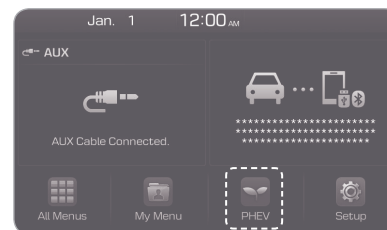

### Type B

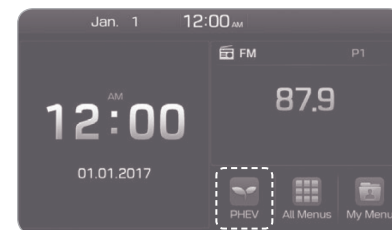

Select the PHEV menu on the home screen, or select the PHEV menu from the main menu.

### Type A

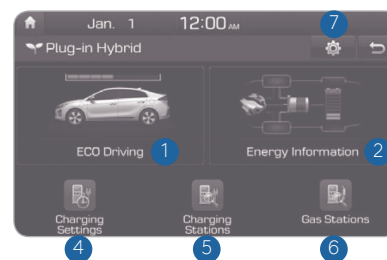

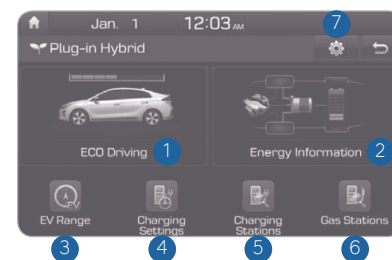

### Type B

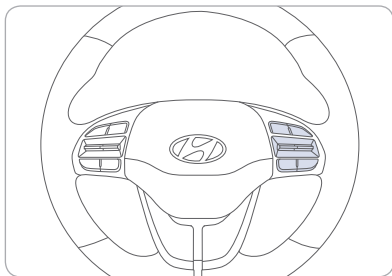

- 1 ECO driving : Displays a real-time image for fuel economy or ECO level based on the user's selection.
- 2 Energy information : Displays a real-time image showing information about the battery and the flow of energy based on the user's selection.
- 3 EV range : Displays the possible driving distance on a map (for type B).
- 4 Charging settings : Goes to the menu to set times for charging.
- 5 Charging stations : Displays a list of EV charging stations nearby.
- 6 Gas stations : Displays a list of gas stations nearby.
- 7 Settings : Goes to the settings menu to select the real-time information that will be displayed on the home screen.

## LCD DISPLAY CONTROL



- 1  : MODE button for changing modes
- 2  : MOVE switch for changing items
- 3 **OK** : SELECT / RESET button for setting or resetting the selected item

### Type A

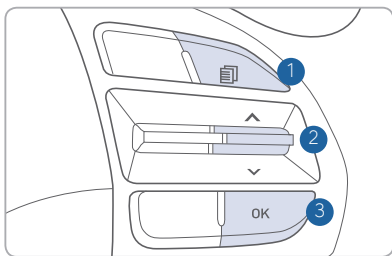

### Type B

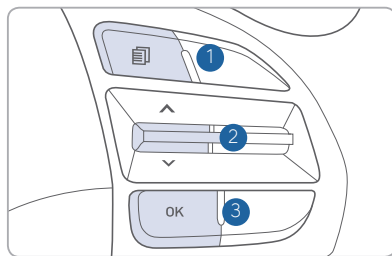



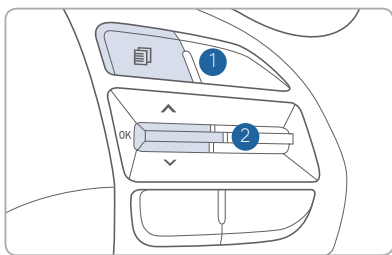





### Type C







## LCD DISPLAY MODES

### Type A

Modes	Symbol	Description
Trip Computer		This mode displays driving information like the tripmeter, fuel economy, etc.
Turn By Turn (TBT)		This mode displays the state of the navigation.
SCC / LKAS		This mode displays the state of the Smart Cruise Control (SCC) and Lane Keeping Assist System (LKAS).
A / V		This mode displays the state of the A / V (Audio / Video) system.
Information	 or  or 	This mode displays the service interval (mileage or days) and warning messages related to the Blind Spot Detection system, etc.
User Settings		In this mode, you can change settings of the doors, lamps, etc.

### Type B

Modes	Symbol	Explanation
Trip Computer		This mode displays driving information such as the tripmeter, fuel economy, etc.
Turn By Turn (TBT)		This mode displays the state of the navigation.
Assist		<ul style="list-style-type: none"> <li>• This mode displays the state of the Smart Cruise Control (SCC) and Lane Keeping Assist System (LKAS).</li> <li>• This mode displays information related to Tire Pressure.</li> </ul>
User Settings		In this mode, you can change settings of the doors, lamps, etc.
Warning		This mode displays warning messages related to the Blind Spot Detection system, etc.

## CLIMATE CONTROL

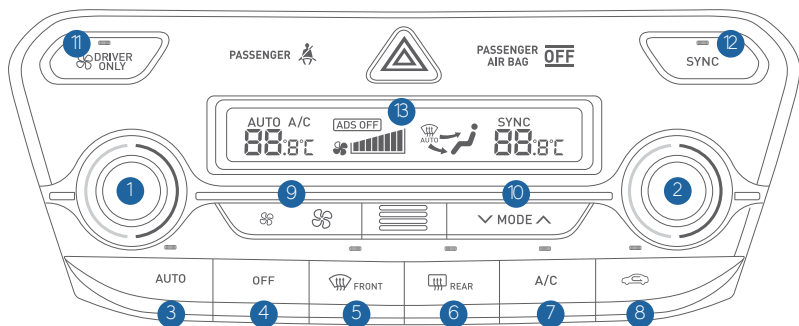

- |  |                                      |
|--|--------------------------------------|
| ① Driver's temperature control knob    | ⑧ Air intake control button          |
| ② Passenger's temperature control knob | ⑨ Fan speed control button           |
| ③ AUTO (automatic control) button      | ⑩ Mode selection button              |
| ④ OFF button                           | ⑪ Driver only button                 |
| ⑤ Front windshield defrost button      | ⑫ SYNC button                        |
| ⑥ Rear window defrost button           | ⑬ Climate control information screen |
| ⑦ Air conditioning button              |                                      |

### DEFOGGING / DEFROSTING



1. Press the front windshield defrost control button.



2. Set the temperature control to the warmest setting.

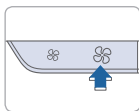

3. Set the fan speed to the highest setting.

**NOTE:** To reduce the tendency of the glass fogging and also to improve visibility, keep the interior surface of the windshield clean by wiping it with a clean cloth and glass cleaner. In addition, select air intake control to the outside (fresh) air position whenever possible while operating the vehicle.

### AUTOMATIC HEATING / AIR CONDITIONING

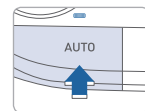

1. Press the AUTO button.

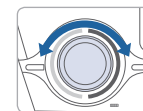

2. Set the temperature control to the desired setting.

Controls the modes, fan speeds, air intake and air-conditioning automatically.

### SYSTEM OFF

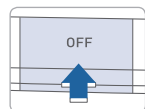

Pressing the OFF button will place the system in the OFF mode.

- Blower will turn off.
- Outside (fresh) air position will be selected.
- Vented air will be at last set temperature.

### MODE SELECTION

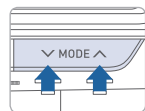

Changes the direction of the air flow as follow.



### AIR INTAKE CONTROL

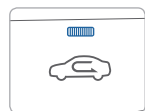

Recirculated air position



Outside (fresh) air position

### SYNC BUTTON

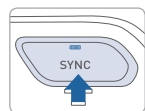

Press the SYNC button to adjust the driver and passenger side temperature and air flow direction equally.

### DRIVER ONLY

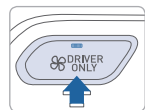

Only the driver's vent will operate if enabled (LED on).

### REAR WINDOW DEFROSTER

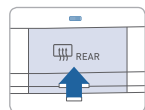

Press to activate/deactivate the rear window defroster.

## RADIO MODE

### Display Audio

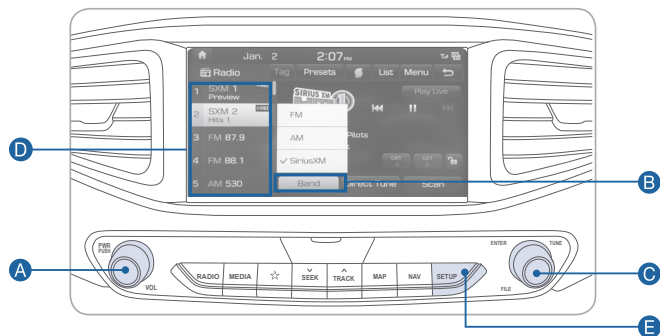

Press POWER button **A** to turn radio on.

#### TUNING/LISTENING TO CHANNELS

1. Press BAND button **B** on screen to select FM/AM/SiriusXM®.
2. ROTATE TUNE knob **C** to desired channel.

**NOTE** A clear view of the southern sky helps ensure SiriusXM® radio reception.

#### SETTING PRESET MEMORY BUTTONS

Press and hold any preset button **D** on the screen until an audible beep is heard to store current channel.

#### ADJUSTING THE SOUND CONTROL

1. Press the SETUP button **E** and press the SOUND button on screen to display the Sound Settings screen.
2. Touch on-screen arrows to adjust desired setting.



### Navigation

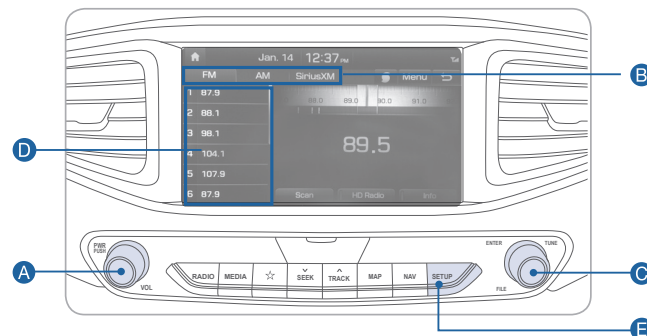

Press POWER button **A** to turn radio on.

#### TUNING/LISTENING TO CHANNELS

1. Press BAND button **B** on screen to select FM/AM/SiriusXM®.
2. ROTATE TUNE knob **C** to desired channel.

**NOTE** A clear view of the southern sky helps ensure SiriusXM® radio reception.

#### SETTING PRESET MEMORY BUTTONS

Press and hold any preset button **D** on the screen until an audible beep is heard to store current channel.

#### ADJUSTING THE SOUND CONTROL

1. Press the SETUP button **E** and press the SOUND button on screen to display the Sound Settings screen.
2. Touch on-screen arrows to adjust desired setting.

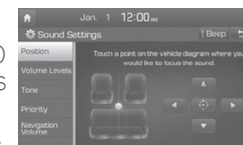

## NAVIGATION

### Basic features on map screen

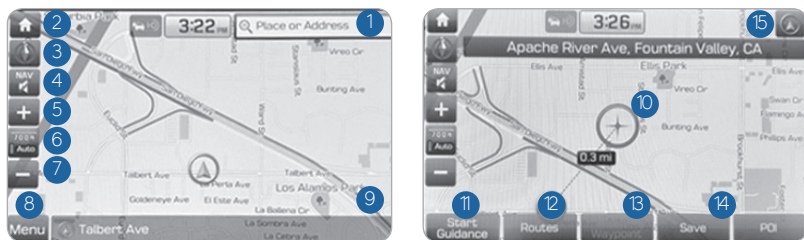

- 1 Place button : Move to the Place menu.
- 2 Home button : Go to the Home screen.
- 3 Map button : Change the map view mode.
- 4 NAV volume button : Adjusts the volume.
- 5 Zoom in button : Zoom in the map.
- 6 Map scale display : Set the zoom level automatically according to the guidance.
- 7 Zoom out button : Zoom out the map.
- 8 Quick menu button : Quick Menu for destination selection and options.
- 9 Map scroll mark : Touch to scroll the map.
- 10 Guidance button : Start the preferred navigation route to selected location.
- 11 Route button : Choose the preferred navigation route to selected location.
- 12 Waypoint button : Set a waypoint to the current route.
- 13 Save button : Save frequently used address to address book.
- 14 POI button : Find a POI(Point Of Interest) around the current position.
- 15 Vehicle position mark : View the vehicle's current position on the map screen.

### Destination search screen



Press [NAV] on the map screen and, finds a destination by using the [Destination] menu.

- 1 Address : Set destination by address search.
- 2 Previous destinations : Select from previously inputted addresses and POIs.
- 3 Local search : Uses Google Local Search via the vehicle's connected services system.
- 4 POI categories : Select the desired item in the sub-categories.
- 5 Charging stations : Select the desired destinations among the searched charging stations.
- 6 Restaurants : Lists available restaurants within a predefined radius of the current vehicle position.
- 7 Emergency : Select the desired destination among the searched emergency facilities.
- 8 Address Book : Search the destination with the address book.
- 9 Coordinates : You can find a destination by entering the coordinates of latitude and longitude.

## AUX, USB AND iPod® PORT

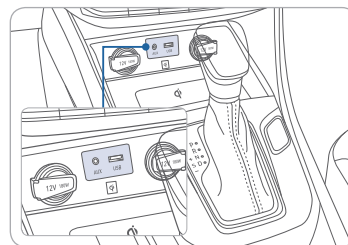

Use the input jack to connect an external audio device and listen to it through the audio system in your vehicle.

iPod® is a trademark of Apple, Inc.

## CLOCK ADJUSTMENT

### With Audio

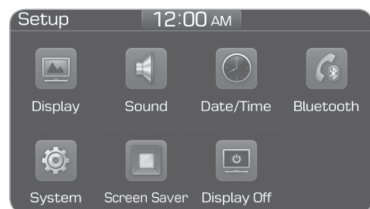
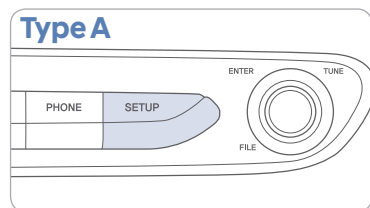

1. Press the SETUP button on the audio head unit.
2. Select Date/Time.

#### Set Time

Set the time displayed on the audio screen.

#### Time Format

Choose between 12-hour and 24-hour time formats.

#### Set Date

Set the date displayed on the audio screen.

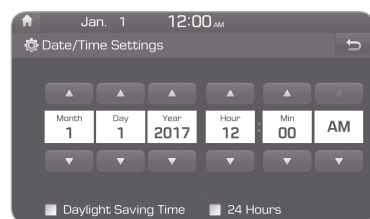
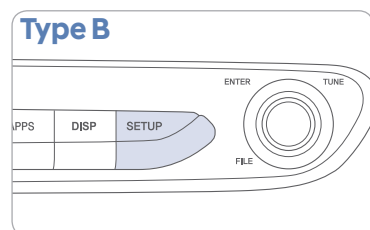

1. Press the SETUP button on the audio head unit.
2. Select Date/Time.
3. Select the desired items.

#### Date/Time

If you tap any value, you can directly enter the number in the screen.

#### 24 Hours

The time display is set in 24-hour format.

#### Daylight Saving Time

The daylight saving time(DST) is applied.

### With Navigation

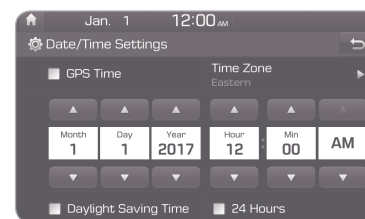
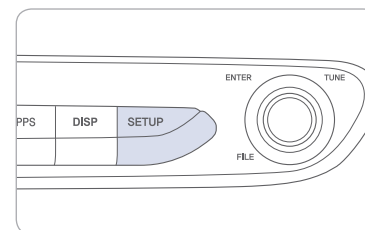

1. Press the SETUP button on the navigation head unit.
2. Select Date/Time.
3. Select the desired items.

#### Date/Time

Using the arrow buttons, you can change the values. If you tap any value, you can directly enter the number in the screen.

#### GPS time

Displays time according to the received GNSS(Global Navigation Satellite System) time.

#### Daylight Saving Time

The daylight saving time(DST) is applied.

#### 24 Hours

The time display is set in 24-hour format.

## DUAL CLUTCH TRANSMISSION

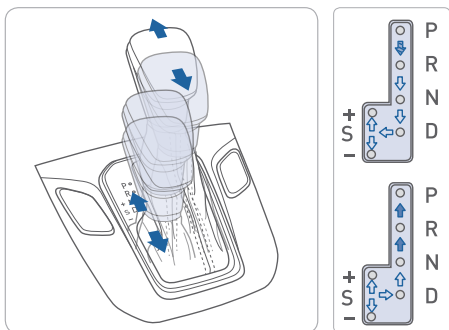

(↕): Depress the brake pedal and press the shift button while moving the shift lever.

(↕): Press the shift button while moving the shift lever.

(→): The shift lever can freely operate.

### Manual shift mode

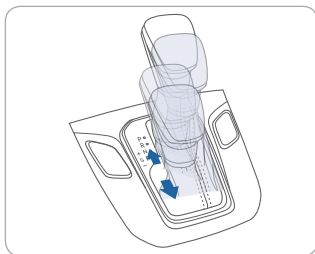

Shift the lever from D into the manual gate to activate manual shift mode. Manual shift mode is a recalibrated automatic mode that will hold gears longer and downshift at higher RPM for a more dynamic driving style. Gasoline engine will be engaged more frequently.

### NOTE: Dual Clutch Transmission characteristics

The new technology of the Dual Clutch Transmission is different from a traditional automatic or manual transmission:

- The Dual Clutch Transmission is an automatically shifting manual transmission.
- Dual Clutch Transmission utilizes two clutches connected to a computer-controlled manual gearbox. It provides the convenience of a transmission that shifts automatically, with the efficiency of a manual transmission.
- When you turn the engine on and off, you may hear clicking sounds as the system goes through a self test. This is a normal sound for the Dual Clutch Transmission.

- When you stop on a hill, if you remove your foot from the brake pedal, the vehicle will remain stationary for approximately two seconds to prevent the vehicle from rolling backwards. If you depress the accelerator pedal during the two second interval, the vehicle will accelerate.

If you wait more than two seconds, the vehicle will enter creep mode and may roll backwards if the hill is steep.

### Caution

- You should always use the foot brake to hold the car on a hill until you are ready to drive. Using creep mode to hold the car on a hill may damage the clutch.
- If the clutch becomes overheated by excessive use of the clutch to hold on a hill, you may notice a shudder feeling and a blinking display on the instrument cluster. When this occurs, the clutch is disabled until the clutch cools to normal temperatures. If this occurs, pull over to a safe location, shift into P (Park) and apply the foot brake for a few minutes.

### ECO/SPORT mode

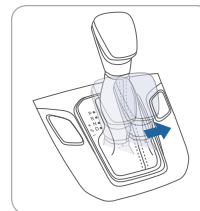

#### ECO mode

If you drive the vehicle with the shift lever in D (Drive), the vehicle will automatically change to ECO mode. The ECO indicator will illuminate on the instrument cluster. When driving in ECO mode, the vehicle improves fuel efficiency for eco-friendly driving.

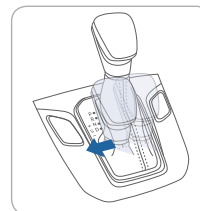

#### SPORT mode

If you drive the vehicle with the shift lever in S (Sport), the vehicle will automatically change to SPORT mode. The SPORT indicator will illuminate on the instrument cluster. When driving in SPORT mode, the vehicle provides more responsive powertrain performance, sporty but firm handling, and the fuel efficiency may decrease.



## PADDLE SHIFTER

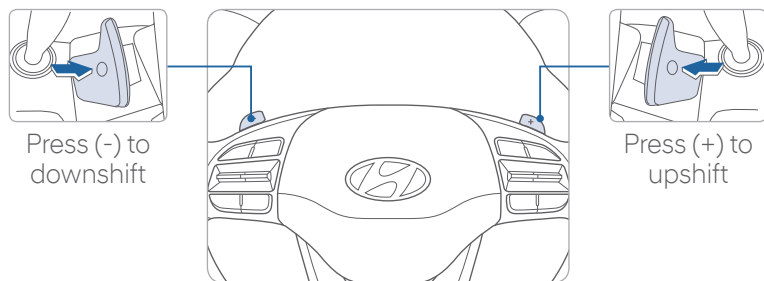

The paddle shifter is available when the shift lever is in the D (Drive) or S (Sport) position, or the manual shift mode. It will operate when the vehicle speed is more than 3mph. Pull the [+] or [-] paddle shifter once to shift up or down one gear.

## COASTING GUIDE

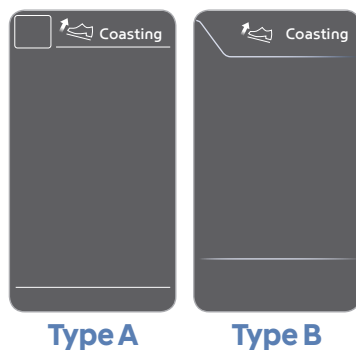

Vehicle with factory installed navigation system:

After an address is inputted and navigation is in progress, the coasting guide informs the driver when to take the foot off from the accelerator by anticipating a decelerating event based on the analysis of driving routes and road conditions of the navigation. This helps increase fuel efficiency by allowing coasting down the road with EV motor only.

To activate the system, select "User Settings → Driving Assist → Coasting Guide". The driving speed should be between 25 mph and 100 mph.

## CRUISE CONTROL / SMART CRUISE CONTROL

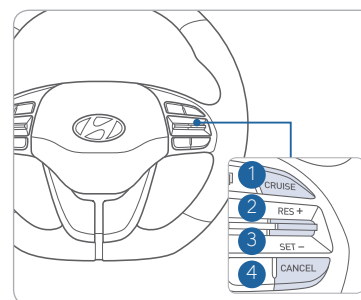

The Cruise Control system allows you to program the vehicle to maintain a constant speed without depressing the accelerator pedal.

- 1 To turn On/Off cruise control.
- 2 Toggle switch UP to Resume or Increase the cruise control speed.
- 3 Toggle switch DOWN to Set or Decrease the cruise control speed.
- 4 To Cancel the Cruise Control.

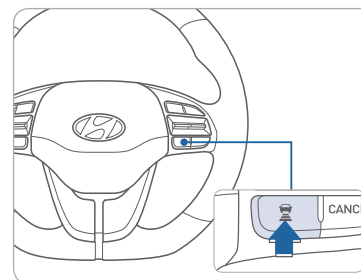

### Setting Vehicle Distance (Smart Cruise Control only)

Press the button to set and maintain the vehicle-to-vehicle distance without pressing the accelerator or brake pedal. The vehicle-to-vehicle distance 1 will automatically activate when you set the cruise speed 2. Each time the button is pressed, the vehicle-to-vehicle distance changes as follows:

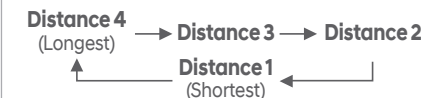
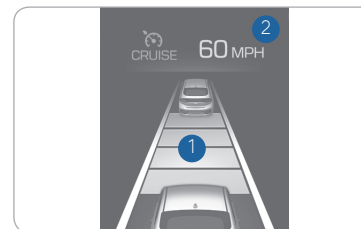

### Setting Cruise Control

1. Press the "CRUISE" button 1 to turn on Cruise Control. The icon will illuminate in the instrument cluster.
2. Toggle "-SET" switch (3) DOWN to set cruising speed.

### Adjusting the vehicle speed

1. Toggle "+RES" switch 2 UP to increase cruising speed.
2. Toggle "-SET" switch 3 DOWN to decrease cruising speed.

**Note** Quick toggle up/down will change speed by 1 mph. Holding switch up/down will change speed by 10 mph.

### To Cancel Cruise Control

Press the "CANCEL" button 4 or depress the brake pedal.

### IONIQ CUSTOMER DELIVERY CHECKLIST

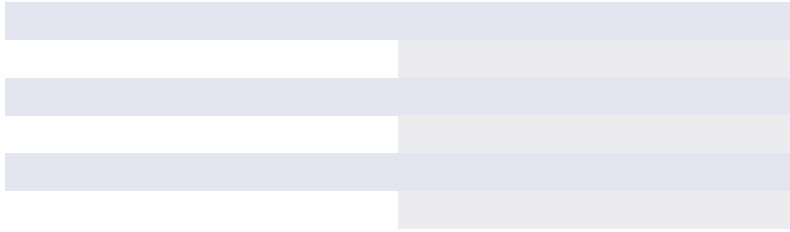

#### BEFORE DELIVERY

- SET TIRE PRESSURE LF\_\_\_RF\_\_\_RR\_\_\_LR\_\_\_
- VERIFY VEHICLE IS CLEAN, IN GOOD CONDITION, FREE OF CHIPS AND SCRATCHES · CLEAN WINDSHIELD AND BACK WINDOW
- ENSURE FLOOR MATS ARE SNAPPED INTO PLACE

#### WALK THE CUSTOMER THROUGH EACH OF THE FOLLOWING KEY DELIVERY FEATURES

- REVIEW QUICK REFERENCE GUIDE
- PAIR CUSTOMER'S PHONE TO THE BLUETOOTH SYSTEM
- OPERATION OF THE NAVIAGATION SYSTEM
- REVIEW AND TEAR OFF VOICE COMMAND / QUICK TIP CARD
- OPERATION OF THE AUDIO SYSTEM



#### CONNECTING YOUR PHONE

- On the radio:
1. Push the **SETUP** button.
  2. Select **Bluetooth**.
  3. Select **Bluetooth Connection**.
  4. Select **Add New**.
- In your phone's **Bluetooth** settings:
5. Select the <Vehicle Name> on your phone.
  6. Enter the passkey from the radio or accept the authorization pop-up on your phone.

#### SWITCHING BETWEEN PAIRED PHONES

Using Voice Command: "Change Bluetooth device"

- On the radio:
1. Push the **SETUP** button.
  2. Select **Bluetooth**.
  3. Select **Bluetooth Connection**.
  4. Select **Connect** next to the desired phone.

For more information, visit [HyundaiBluetooth.com](http://HyundaiBluetooth.com)