

VOICE RECOGNITION TIPS (If equipped)

BLUETOOTH®
Command **Example**
 Dial <Phone #> — “Dial 7-1-4-9-6-5-3-0-0-0”
 Call <Name> — “Call John Smith”

Improving how you store your contacts can optimize your Bluetooth® Voice Recognition performance:
 • Use full names instead of short or single-syllable names (“John or Dad”)
 • Avoid using special characters/emojis or abbreviations (“Dr.”) when saving contacts

NAVIGATION
Command **Example**
 Find Address — “1-2-3-4-5 1st Street, <House #, Street, City, State>
 Find <POI Name> — “Find McDonald’s”

Located on Rearview Mirror
GOOGLE™ LOCAL SEARCH
Command **Example**
 Find <POI Name> — “Find Lowe’s® near me”
 <POI Name> — “Starbucks®”

MANUAL / AUTOMATIC CLIMATE CONTROL – pages 20

- Explain different air modes to a customer.

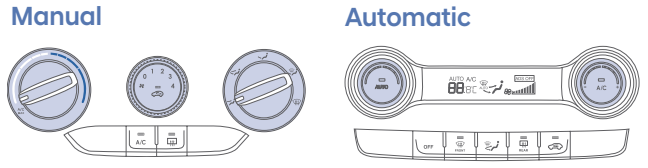

DEFROST – page 20

- 1 Press the front defrost button.
- 2 Set to warmest temperature setting.
- 3 Set to medium fan speed.

TIRE PRESSURE MONITORING SYSTEM (TPMS) – page 44

Explain TPMS function to customer.

- When illuminated, one or more tires are under-inflated.
- Blinks for approximately one minute then remains illuminated when there is a malfunction with the TPMS.
- You can also check the individual tire pressures in the Information Display mode in the LCD cluster. Tire pressures are displayed in the cluster after a few minutes of driving.



VEHICLE SETTINGS – page 14

- Demonstrate vehicle settings in instrument cluster
- Demonstrate navigation use, enter dealer address
- Show radio presets

BLUETOOTH – page 24

- Demonstrate phone pairing
 Refer to www.hyundaiusa.com/bluetooth
- Demonstrate QR code



INTRODUCTION AND LOCATION OF THE SERVICE DEPARTMENT

SET FIRST SERVICE APPOINTMENT

REVIEW FACTORY RECOMMENDED MAINTENANCE SCHEDULE

WAS THE CONDITION OF YOUR VEHICLE (AT DELIVERY) TO YOUR SATISFACTION?

Sales Consultant _____	Date _____	Sales Manager _____	Date _____
Customer _____	Date _____		
Email _____			

MAINTENANCE

Unit: mile

Scheduled Maintenance (Normal Usage)		2.0 MPI		1.6 Turbo-GDI
Engine Oil & Filter	Replace	7,500 or 12 mos	Replace	6,000 or 12 mos.
Fuel Additives	Add	7,500 or 12 mos	Add	6,000 or 12 mos.
Battery Condition				
Brake Lines, Hoses & Connections				
Front Brake Disc/Pads, Calipers				
Rear Brake Disc/Pads				
Steering Gear Box, Linkage & Boots, Lower Arm Ball Joint, Upper Arm Ball Joint				
Drive Shafts & Boots	Inspect	7,500 or 12 mos	Inspect	6,000 or 12 mos
Suspension Mounting Bolts				
Air Conditioning Refrigerant				
Air Conditioning Compressor				
Propeller Shaft (AWD)				
Exhaust Pipe & Muffler				
Air Cleaner Filter	Inspect	7,500 or 12 mos	Inspect	6,000 or 12 mos
	Replace	30,000 or 48 mos.	Replace	24,000 or 48 mos.
Vacuum Hose	Inspect	7,500 or 12 mos	Inspect	6,000 or 12 mos.
Climate Control Air Filter (For Evaporator and Blower Unit)	Replace	15,000 or 12 mos	Replace	12,000 or 12 mos.
Tire Rotation	Perform	7,500	Perform	6,000
Vapor Hose, Fuel Tank Cap, Fuel Tank				
Fuel Tank Air Filter	Inspect	15,000 or 24 mos.	Inspect	12,000 or 24 mos.
Fuel Filter				
Parking Brake				
Brake Fluid	Inspect	15,000 or 24 mos.	Inspect	12,000 or 24 mos.
Fuel Lines, Fuel Hoses & Connections	Inspect	30,000 or 48 mos.	Inspect	24,000 or 48 mos.
Rear Axle Oil (AWD)				
Transfer Case Oil (AWD)	Inspect	30,000 or 48 mos.	Inspect	24,000 or 48 mos.
Drive Belts	Inspect	First 60,000 or 72 mos. Subsequent, every 15,000 or 24 mos.	Inspect	First 60,000 or 72 mos. Subsequent, every 12,000 or 24 mos.
Spark Plugs	Replace	97,500	Inspect	42,000
Engine Coolant	Replace	First 120,000 or 120 mos. Subsequent, every 30,000 or 24 mos.	Replace	First 120,000 or 120 mos. Subsequent, every 30,000 or 24 mos.
Valve Clearance (Only 1.6 T-GDI)	Inspect	-	Inspect	75,000
Intercooler, in/out hose, air intake hose (Only 1.6 T-GDI)	Inspect	-	Inspect	6,000 or 12 mos.
EcoShift Dual Clutch Transmission Fluid (Only 1.6 T-GDI)		-	Inspect	6,000 or 12 mos.
Automatic Transmission Fluid (Only 2.0)		No check or services required for Normal Usage driving.		-

*See Owner's Manual for details.

Looking for more detailed information? This Quick Reference Guide does not replace your vehicle Owner's Manual. If you require additional information or are unsure of a specific issue, you should always refer to the vehicle Owner's Manual or contact your authorized Hyundai dealer.

The information contained in this Quick Reference Guide was correct at the time of printing; however, specifications and equipment can change without notice. No warranty or guarantee is being extended in this Quick Reference Guide, and Hyundai reserves the right to change product specifications and equipment at any time without incurring obligations. Some vehicles are shown with optional equipment. Specifications apply to U.S. vehicles only. Please contact your Hyundai dealer for current vehicle specifications.

NP150-K2018
 (Rev 01/24/18)
 Printing 01/27/18

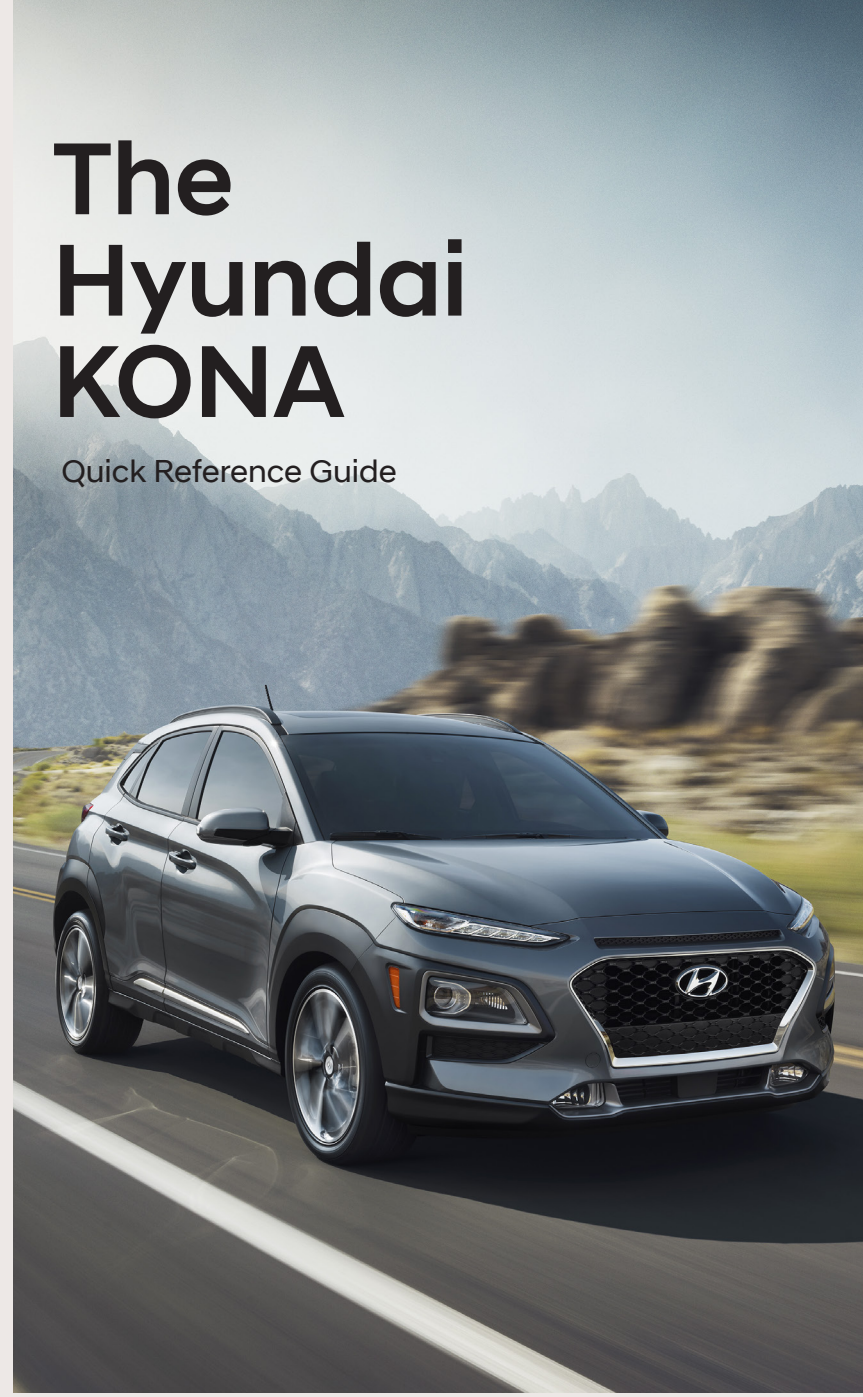

The Hyundai KONA

Quick Reference Guide

Roadside Assistance: 1-800-243-7766
Consumer Affairs: 1-800-633-5151
Sirius XM® Radio: 1-800-967-2346
Blue Link: 1-855-2BLUELINK
 (1-855-225-8354)



HYUNDAI VEHICLE OWNER PRIVACY POLICY

Your Hyundai vehicle may be equipped with technologies and services that use information collected, generated, recorded or stored by the vehicle. Hyundai has created a Vehicle Owner Privacy Policy to explain how these technologies and services collect, use, and share this information.

You may read our Vehicle Owner Privacy Policy on the Hyundaiusa.com website at <https://www.hyundaiusa.com/owner-privacy-policy.aspx>. If you would like to receive a hard copy of our Vehicle Owner Privacy Policy, please contact our Customer Connect Center at:

Hyundai Motor America
Hyundai Customer Connect Center
P.O. Box 83835
Phoenix, AZ 85071-3835
800-633-5151
consumeraffairs@hmasusa.com

Hyundai's Customer Connect Center representatives are available Monday through Friday, between the hours of 5:00 AM and 7:00 PM PST and Saturday and Sunday between 6:30 AM and 3:00 PM PST (English). For Customer Connect Center assistance in Spanish or Korean, representatives are available Monday through Friday between 6:30 AM and 3:00 PM PST.

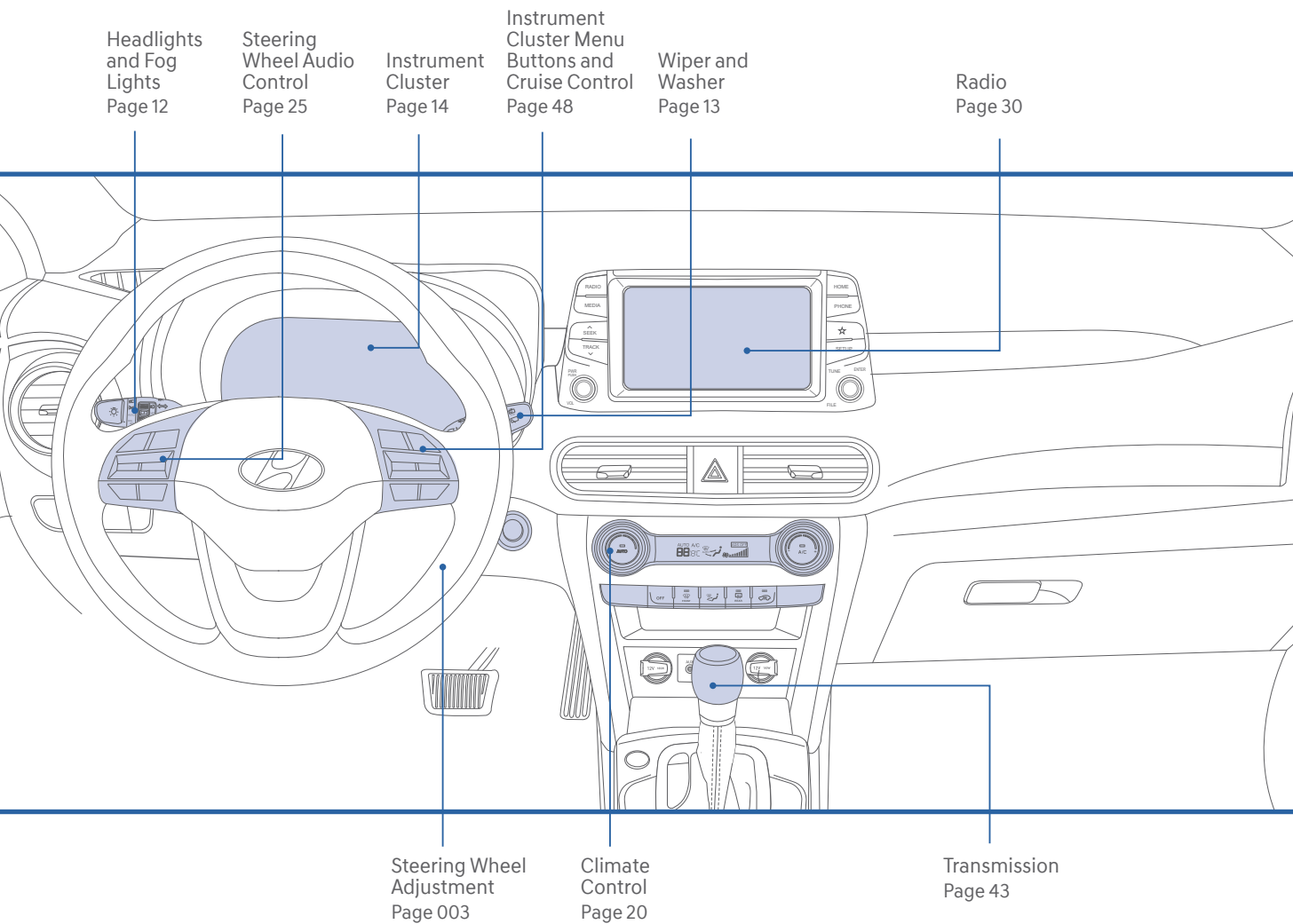

FEATURES AND CONTROLS

Child-Protector Rear Door Lock	07
Climate Control	20
Driver's Main Controls	07
Engine Start / Stop Button	03
Fuel Filler Door	08
Headlights and Fog Lights	12
Head-Up Display	18
Homelink Wireless Control System	09
Instrument Cluster	14
Instrument Panel Illumination	17
Interior Lights	10
LCD Display Control	16
LCD Display Modes	16
Sunroof	11
Liftgate Operation	08
Seat-Headrest Adjustment	05
Seat-Front Seat Adjustment	04
Seat-Rear Seat Folding	06
Seat-Seat Belt Adjustment	05
Seat-Seat Warmer	06
Smart Key	02
Steering Wheel Adjustment	03
Warnings and Indicators	17
Wiper and Washer	13

MULTIMEDIA

Android Auto™	34
Apple Carplay™	36
AUX and USB Port	40
Blue Link Telematic System	27
Bluetooth Operational Tips	25
Bluetooth Phone Pairing	24
Navigation Multimedia System	32
Radio Mode	30
Steering Wheel Audio Control	25
Voice Recognition	26
Wireless Cellular Phone Charging System	40

DRIVING

AWD Lock	47
Blind Spot Collision Warning (BCW)	46
Cruise Control	48
Downhill Brake Control (DBC)	45
Drive Mode Integrated Control System	47
Dual Clutch Transmission	41
Electronic Stability Control (ESC)	45
Forward Collision-Avoidance Assist (FCA)	48
Lane Keeping Assist (LKA)	46
Rear Parking Assist System	49
Rear View Monitor	49
Tire Pressure Monitoring System (TPMS)	44
Transmission	43





WARNING!
 To reduce the risk of serious injury to yourself and others, read and understand the important SAFETY INFORMATION in your Owner's Manual.

Use this Quick Reference Guide to learn about the features that will enhance your enjoyment of your Hyundai. More detailed information about these features are available in your Owner's Manual.

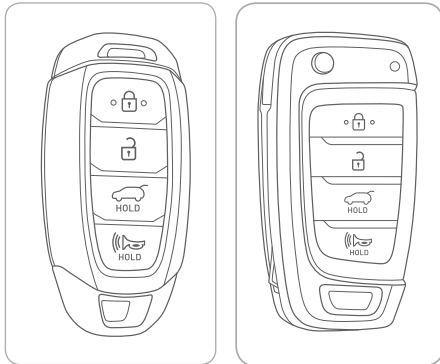
* Some vehicles may not be equipped with all the listed features.

SMART KEY



-  Lock
-  Unlock
-  Liftgate Unlock
(Press and Hold.)
-  Panic

NOTE :
For the User Selectable Option, please refer to your Owner's Manual for further information.

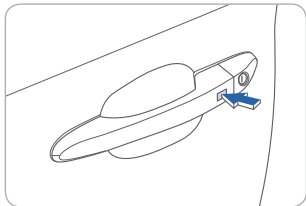

Driver's Door Lock / Unlock
Smart key must be within 28~40in. from the outside door handle.

Press : Once - Unlock driver door
Twice - Unlock all doors
Third - Lock all doors

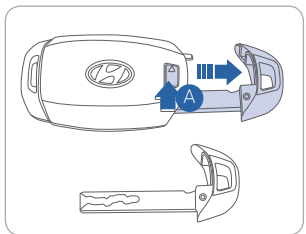

Removing the Mechanical Key
Press and hold the release **A** button and remove the key.

ENGINE START / STOP BUTTON

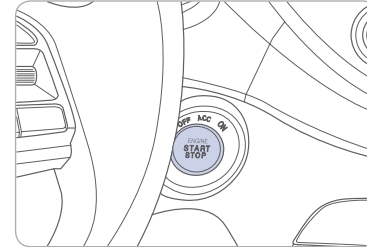

With the ignition OFF and foot OFF of the brake pedal, press the Engine Start / Stop button.

- Once for ACC (Accessory) mode.
- Twice for ON mode.
- Third for OFF.

To start the engine in any mode (including OFF), press the Engine Start / Stop button while pressing down on the brake pedal. To shut the engine OFF, place the shift lever in P (Park) and press the Engine Start / Stop button again.

Emergency Situations

To Turn the Engine Off in an Emergency

- Press and Hold the engine Start / Stop button for 2 seconds or more or 3 times consecutively within 3 seconds.

Restarting the Engine while Driving

- If the engine shuts off while still moving, the engine can be restarted. Press the engine Start/Stop button with the shift lever in N (Neutral).

STEERING WHEEL ADJUSTMENT

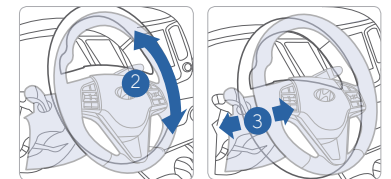
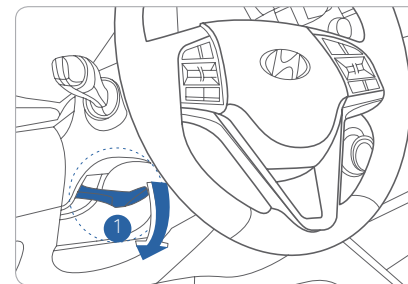

NOTE : Do not adjust while driving.

1. Pull the **1** lever down.
2. Set the **2** angle and **3** distance.
3. Pull the **1** lever up to lock position.

FRONT SEAT ADJUSTMENT (manual)

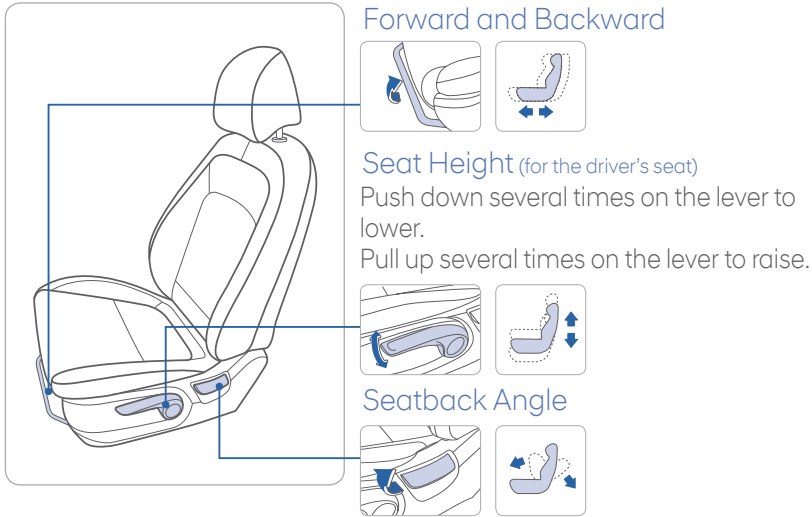

FRONT SEAT ADJUSTMENT (power)

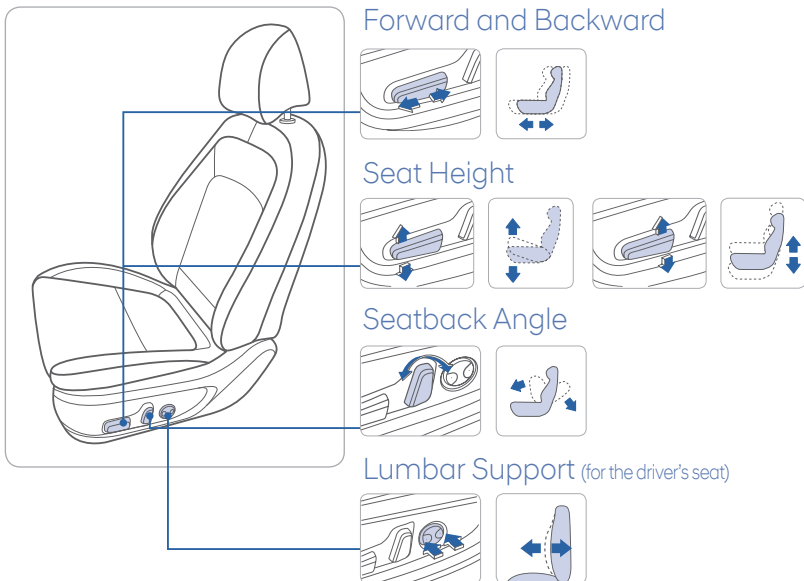

HEADREST ADJUSTMENT

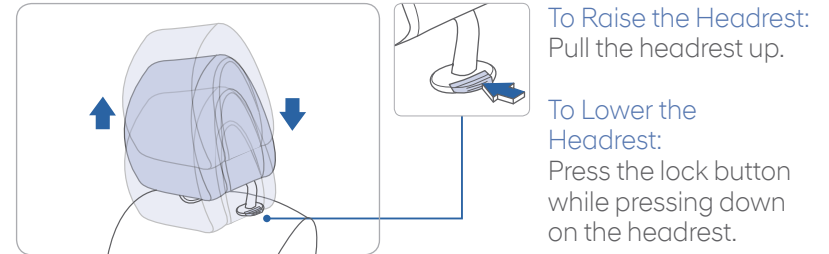

SEAT BELT ADJUSTMENT (front seat)

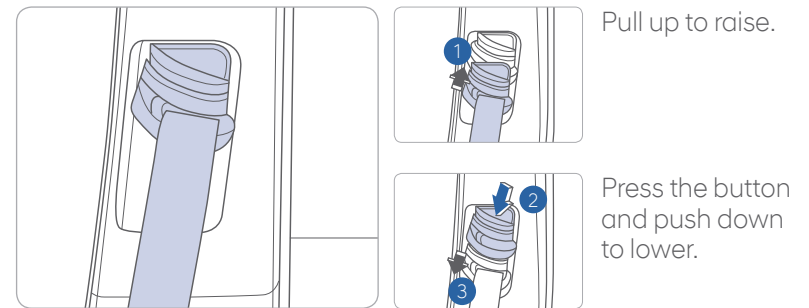

REAR SEAT FOLDING

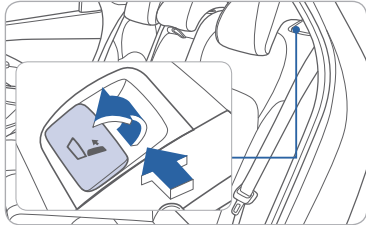

1. Pull up on the seat back release lever.

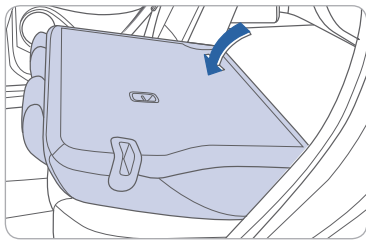

2. Fold seat back down.

SEAT WARMER (front seats)

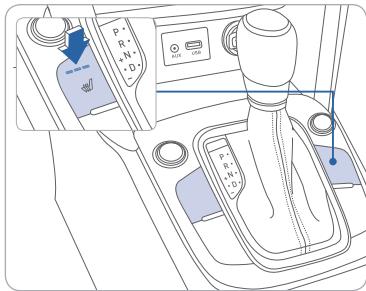

Each time you press the button, the setting is changed as follows:

OFF → **HIGH** → **MEDIUM** → **LOW**

↑

CHILD-PROTECTOR REAR DOOR LOCK

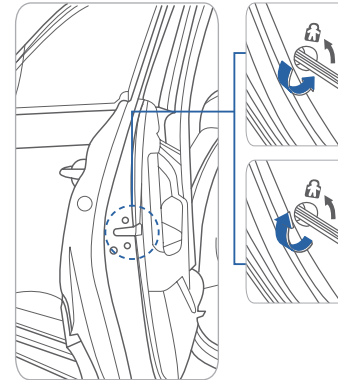

Lock

Insert a key into the hole and turn it to the lock position.

Unlock

Insert a key into the hole and turn clockwise to the unlock position.

DRIVER'S MAIN CONTROLS

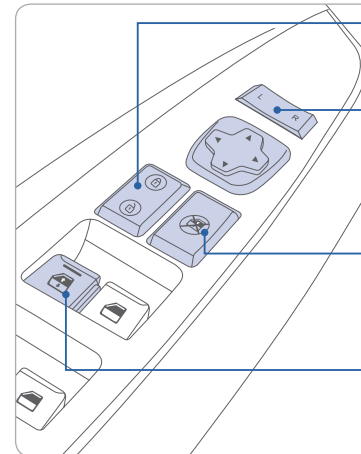

Door Lock

Locks / unlocks all doors and liftgate.

Outside Rearview Mirrors

Press L (left) or R (right) on the switch. Adjust the mirror by using the mirror adjustment control switch.

Power Window Lock Switch

Disables the power window switches on the rear passenger doors.

Window Auto Up / Down (if equipped)

Press past the detent to fully open / close the window.

FUEL FILLER DOOR

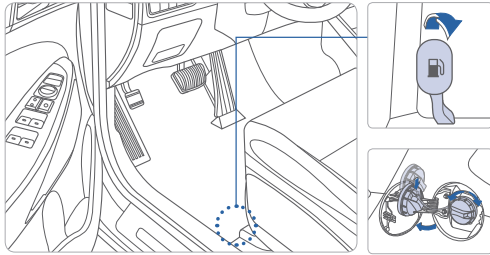

Tighten the gas cap until one click is heard.

LIFTGATE OPERATION

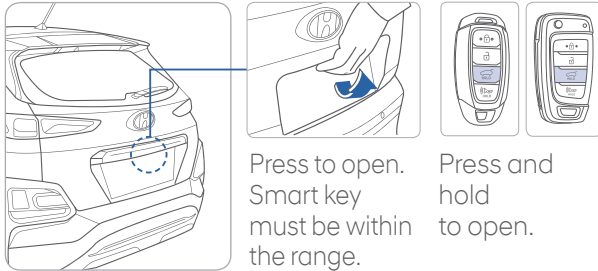

Press to open. Smart key must be within the range.

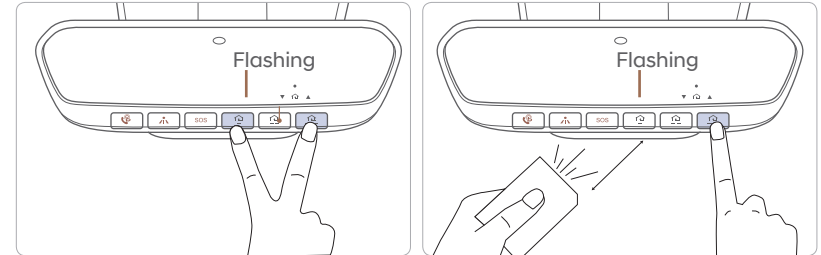

Press and hold to open.

HOMELINK WIRELESS CONTROL SYSTEM



Standard Programming

To train most devices, follow these instructions:

1. For first-time programming, press and hold the two outside buttons. ( , ), HomeLink® Channel 1 and Channel 3, until the indicator light begins to flash (after 10 seconds). Release both buttons. Do not hold the buttons for longer than 20 seconds.
2. Position the end of your hand-held transmitter 1-3 inches (2-8 cm) away from the homeLink® button you wish to program while keeping the indicator light in view.
3. Simultaneously press and hold both the HomeLink® and hand-held transmitter buttons until the HomeLink® indicator light changes from a slow to a rapid blinking light. Now you may release both the HomeLink® and hand-held transmitter buttons.

INTERIOR LIGHTS

Without Sunroof

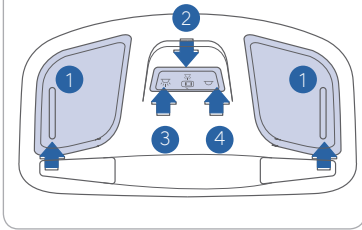

- 1 **Map Light**
Press the lens to turn map lights ON or OFF.
- 2 **Door position**
Cabin light ON when door(s) and/or tailgate are open.
- 3 **Cabin Light ON position**
Press the switch to the left to turn on cabin light.
- 4 **Cabin Light OFF position**
Press the switch to the right to leave cabin light off.

With Sunroof

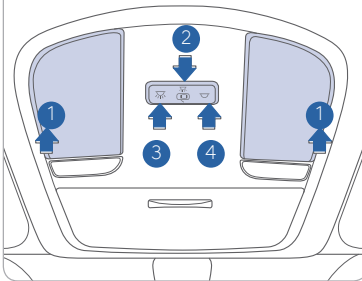

SUNROOF

Sunshade

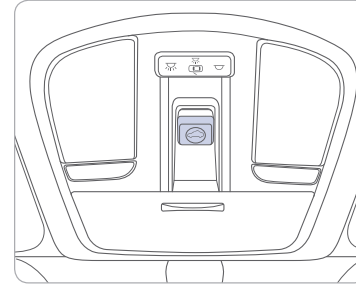

The sunshade will open automatically with the sunroof when the glass panel moves. If you want it closed, move the sunshade manually.

Sliding the Sunroof

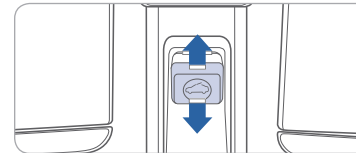
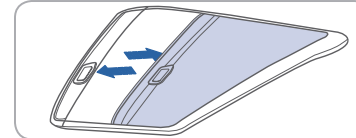

Pressing the sunroof control lever backward or forward momentarily to the second detent position completely opens or closes the sunroof even when the switch is released. To stop the sunroof at the desired position while the sunroof is in operation, press the sunroof control lever backward or forward and release the switch.

Tilting the Sunroof

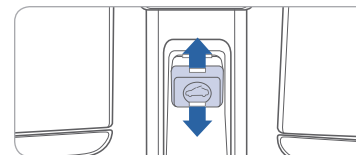
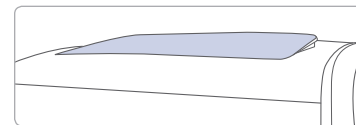

Open
Push the sunroof control switch upward to tilt the sunroof.

Close
Push and hold the sunroof control switch forward to close the sunroof.

HEADLIGHTS AND FOG LIGHTS

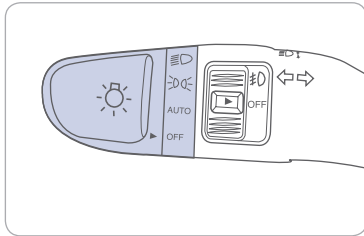

- ▶ | Headlights
- ▶ | Parking Lights
- ▶ | **AUTO** Auto Lights
- ▶ | **OFF** All Lights Off

Headlights Delay

Headlights may stay on for 15 seconds after exiting and locking up the vehicle. Press the remote lock button twice to turn the headlights off. Please refer to your Owner's Manual for further information.

Turn Signals and Lane Change Signals

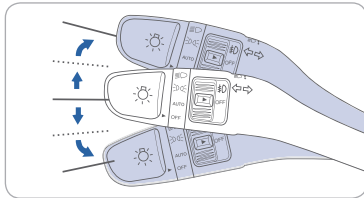

Flashing the Headlights

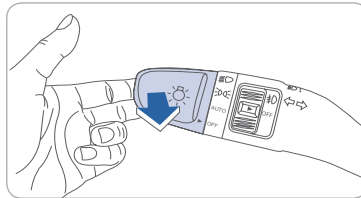

High Beam/ High Beam Assist

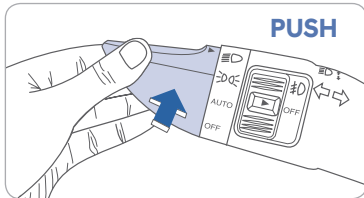

Fog Lights

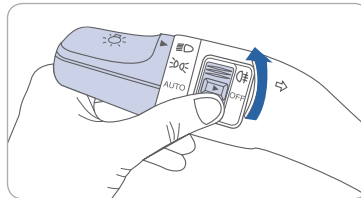

NOTE:

To turn off high beam, pull the lever towards you.

High Beam/ High Beam Assist

1. Select auto position on stalk.
2. Push lever forward to engage Auto High Beam.
3. Push lever forward again to disengage.

WIPER AND WASHER



Scan to view a video of: Windshield Wiper

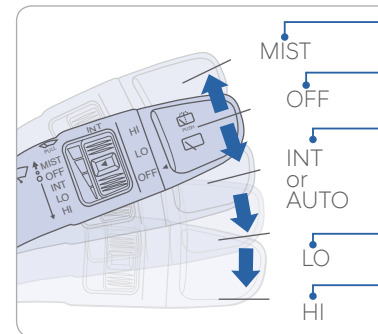

- MIST** - Single wipe
- OFF** - Off
- INT** - Intermittent wipe
- INT or AUTO** - Auto control wipe
- LO** - Low wiper speed
- HI** - High wiper speed

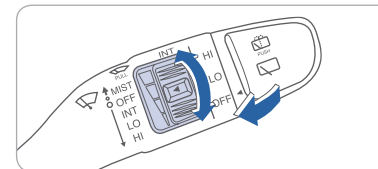

Intermittent Wipe Time Adjustment

- More frequent wipes
- Less frequent wipes

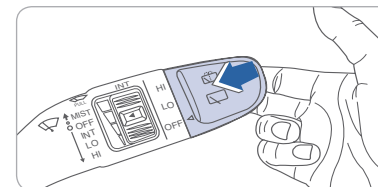

Wash with Brief Wipes

Pull the lever toward you.

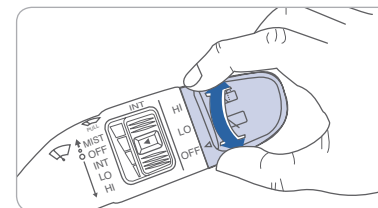

Rear Wiper / Washer Control

- HI** - High wiper speed
- LO** - Low wiper speed
- OFF** - Off
- Push away for rear wash

INSTRUMENT CLUSTER

Type A

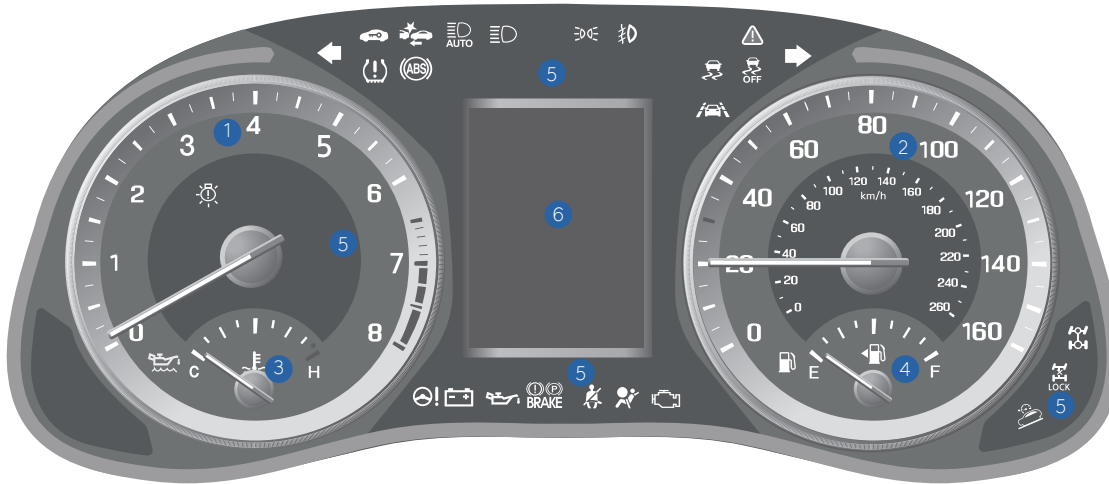

1. Tachometer
2. Speedometer
3. Engine Coolant Temperature Gauge
4. Fuel Gauge
5. Warning and Indicator Lights
6. LCD Display (Including Trip Computer)

Type B



LCD DISPLAY MODES

Modes	Symbol	Description
Trip Computer		Displays the most recent driving information including average fuel economy, trip, odometer, average speed, etc.
Turn BY Turn (TBT)		Displays turn-by-turn directions in the LCD cluster with navigation.
LKA		Displays the state of the Lane Keeping Assist (LKA).
Audio		Displays the state of the Audio System.
Information	or or	Displays the service interval and warning messages.
User Settings		Changes the settings.

LCD DISPLAY CONTROL

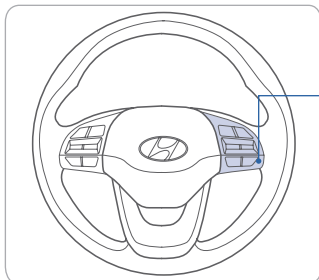

- 1 : MODE button for changing modes
- 2 : MOVE switch for changing items
- 3 : SELECT / RESET button for setting or resetting the selected item

WARNINGS AND INDICATORS

WARNINGS AND INDICATORS		
Air Bag Warning Light	Seat Belt Warning Light	Parking Brake & Brake Fluid Warning Light
ABS Warning Light	Electronic Brake Force Distribution (EBD) System Warning Light	
Electric Power Steering System Warning Light	Malfunction Indicator	Charging System Warning Light
Engine Oil Pressure Warning Light	Low Fuel Level Warning Light	Low Tire Pressure Warning Indicator / TPMS Malfunction Lamp
Automatic Emergency Braking (AEB) Warning Light	All Wheel Drive (AWD) Warning Light	Headlight Warning Light
Master Warning Light	ESC (Electronic Stability Control) Indicator	ESC (Electronic Stability Control) OFF Indicator
Immobilizer Indicator	Turn Signal Indicator	High Beam Indicator / Auto headlamps
Light ON Indicator	Front Fog Indicator Light	CRUISE Cruise Indicator
SET Cruise SET Indicator	SPORT mode Indicator	Downhill Brake Control (DBC) Indicator Light
Lane Departure Warning System (LDWS) Indicator	All Wheel Drive (AWD) LOCK Indicator Light	

INSTRUMENT PANEL ILLUMINATION

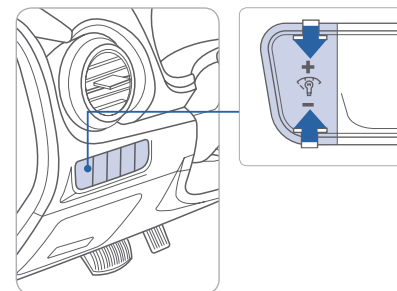

Press + or - to adjust the illumination brightness of the instrument cluster.

HEAD-UP DISPLAY

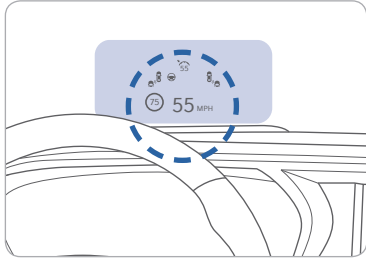

The Heads-Up display is a feature that allows the driver to view information projected onto a transparent screen while still maintaining direct view of the road ahead.

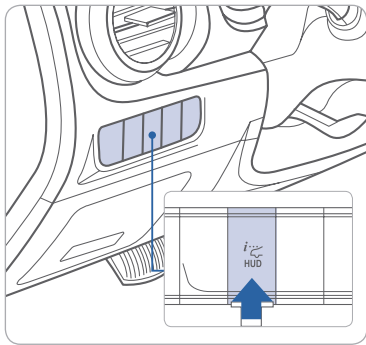

To activate the Heads-Up Display, press the HUD button on the dash panel located on the left-hand side of the driver.

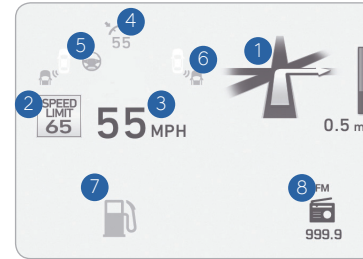

Head-Up Display information

1. Turn-by-turn (TBT) navigation information
2. Road information
3. Driving speed information
4. Cruise control system SET indicator
5. Lane Keeping Assist (LKA) information
6. Blind Spot Collision warning indicators
7. Warning lights
8. Multimedia information

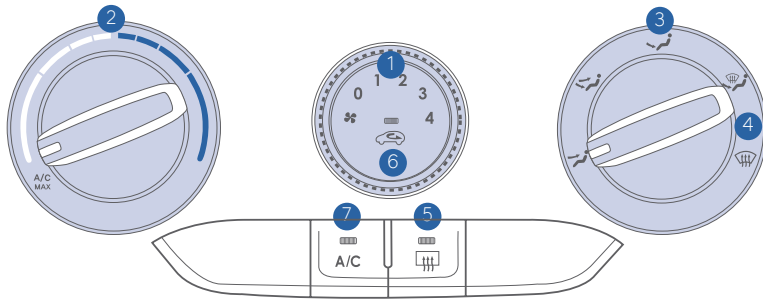

MANUAL CLIMATE CONTROL



1. Fan Speed Control Knob
2. Temperature Control Knob
3. Mode Selection Buttons
4. Front Windshield Defroster Button
5. Rear Window Defroster Button
6. Air Intake Control Button
7. A / C (Air Conditioning) Button



DEFROSTING / DEFOGGING

-  1. Set the front windshield defroster control.
-  2. Set the temperature control to the warmest setting.
-  3. Set the fan speed to the medium setting.

NOTE:

To reduce the tendency of the glass to fog up and also to improve visibility, keep the surface of the windshield clean by wiping it occasionally with glass cleaner and a clean cloth.

In addition, select air intake control to the outside (fresh) air position whenever possible while operating the vehicle.

AIR INTAKE CONTROL



Recirculated air position
(Indicator light ON)





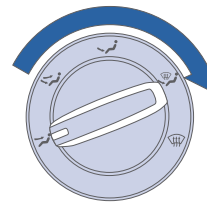

Outside (fresh) air position
(Indicator light OFF)

MODE SELECTION



Changes the direction of the air flow as following:

-  Face Level
-  Bi-Level
-  Floor Level
-  Floor / Defrost Level

REAR WINDOW DEFROSTER AND HEATED OUTSIDE MIRRORS

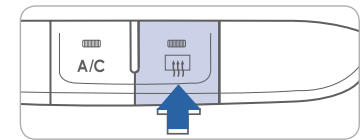

Press to activate / deactivate the rear defroster and heated outside mirrors.

MAX A/C MODE

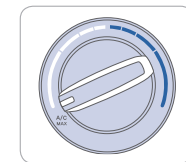

The MAX A/C automatically selects the A/C, recirculated air, and face level vents. This helps to cool the cabin down more quickly. Select normal A/C after initial cool down to resume fresh airflow and maintain efficiency.

AUTOMATIC CLIMATE CONTROL

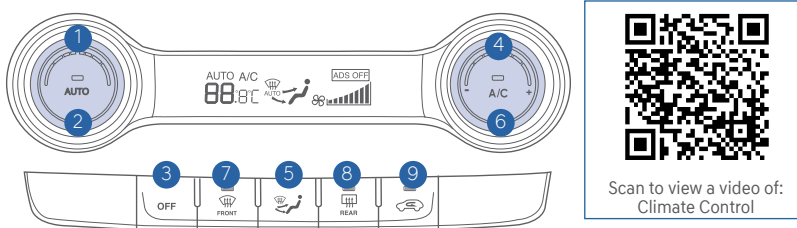

- 1 Temperature Control Knob
- 2 AUTO (Automatic Control) Button
- 3 OFF Button
- 4 Fan Speed Control Button
- 5 Mode Selection Button
- 6 Air Conditioning Button
- 7 Front Windshield Defroster Button
- 8 Rear Window Defroster Button
- 9 Air Intake Control Button

DEFROSTING / DEFOGGING

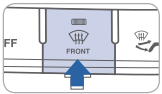

1. Press the front windshield defroster control.



2. Set the temperature control to the warmest setting.

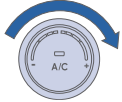

3. Set the fan speed to the medium setting.

SYSTEM OFF MODE

Pressing the OFF button will turn the automatic climate control system off.

- The fan will turn off.
- The outside (fresh) air position will be selected.
- The vented air temperature will be at the last temperature setting.

REAR WINDOW DEFROSTER AND HEATED OUTSIDE MIRRORS

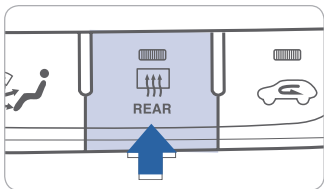

Press to activate / deactivate the rear defroster and heated outside mirrors.

NOTE:

To reduce the tendency of the glass to fog up and also to improve visibility, keep the surface of the windshield clean by wiping it occasionally with glass cleaner and a clean cloth. In addition, select air intake control to the outside (fresh) air position whenever possible while operating the vehicle.

AUTOMATIC HEATING AND COOLING



1. Press the AUTO button.



2. Set the temperature control to the desired setting.

The modes, fan speeds, air intake and air conditioning will be controlled automatically according to the temperature setting.

AIR INTAKE CONTROL

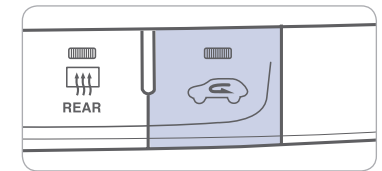

Recirculated air position (Indicator light ON)

Outside (fresh) air position (Indicator light OFF)

MODE SELECTION

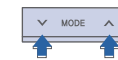

Changes the direction of the air flow as following:



BLUETOOTH PHONE PAIRING

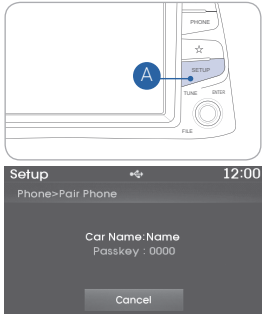

1. Press the SETUP **A** button.
2. Press the “Bluetooth” button on the screen.
3. Press “Add New” button on the screen.
4. Search for the device name as displayed on your mobile phone and connect.
5. If necessary, input the passkey displayed on the Audio screen.
6. Pairing is complete.

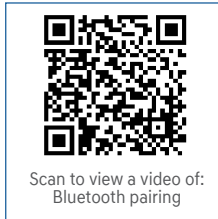

To switch between phones:

1. Push the ‘Setup’ button.
2. Select Bluetooth.
3. Select Bluetooth Connections.
4. Select Connect next to the desired phone.

NOTE : Vehicle must be parked to complete the pairing process.

STEERING WHEEL AUDIO CONTROL

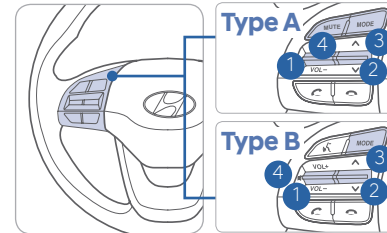

- 1 **VOLUME**
Raises or lowers the speaker volume.
- 2 **SEEK / PRESET**
Changes the station.
- 3 **MODE**
Changes the audio source.
- 4 **MUTE**
Press to Mute.

BLUETOOTH OPERATIONAL TIPS

In the following situations you or the other party may have difficulty hearing each other:

1. Keep the Bluetooth volume low. High level volume may result in distortion and echo.
2. When driving on a rough road, high speeds and/or with the window open.
3. When the air conditioning vents are facing the microphone located at the headliner and/or when the air conditioning fan is at the max speed.

Steering wheel bluetooth control

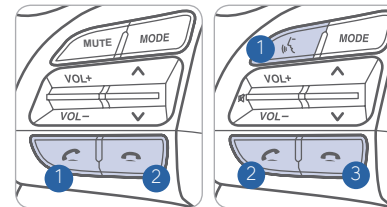

- 1 **TALK**
Activates the voice recognition.
- 2 **CALL**
Places and transfers calls.
- 3 **END**
Ends calls or cancels functions.

To Answer a Call:

- Press the button on the steering wheel.

To Reject a Call:

- Press the button on the steering wheel.

To Adjust Ring Volume:

- Use the VOLUME buttons on the steering wheel.

To Transfer a Call to the handset (private mode):

- Press and hold the button on the steering wheel until the audio system transfers a call to the phone.

To Finish a Call:

- Press the button on the steering wheel.

VOICE RECOGNITION

Making a call using voice recognition: 

The menu tree identifies available voice recognition Bluetooth® functions.

Calling by Name:

1. Press the  button.
2. Say the following command:
 - “Call <John>”: Connects the call to John.
 - “Call <John> <on Mobile / at Work / at Home >”: Connects the call to John’s Mobile, Home, or at Work phone number.

Dialing by Number:

1. Press the  button.
2. Say “Dial Number”.
3. Say the desired phone number.

For the complete list of commands, please refer to your Owner’s Manual.

Voice Recognition Tips

Your vehicle may be equipped with a Voice Recognition technology which allows drivers to operate their phones without having to take their eyes off of the road to minimize distractions.

Voice recognition performance may be affected if driving with windows and sunroof open; when the heating-cooling system is on; when passing in a tunnel or when driving on rugged and uneven roads.

Quick reference on using voice commands:

To start a voice command, press the  button, the following commands are available:

Command	Function
More Help	Provides guidance on commands that can be used anywhere in the system.
Help	Provides guidance on commands that can be used within the current mode.
Calls <Name>	Calls <Name> saved in Contacts. Ex) Call “John”
Dial <Number>	Call can be made by dialing the spoken numbers. Ex) Call “123”
Phone	Provides guidance on Phone related commands. After saying this command, say “Call History”, “Contacts” to execute the corresponding functions.
Contacts (Call by Name)	Displays the Contacts screen. After saying this command, say the name of a contact saved in the Contacts to automatically connect a call.
Dial Number	Displays the Dial number screen. After saying this command, you can say the number which you want to call.
Navigation Find address in <state> < house #, Street name, City>.	Example: “1-0-5-5-0 Talbert Avenue, Fountain Valley
Find <POI Name>	Find Starbucks

BLUE LINK TELEMATICS SYSTEM

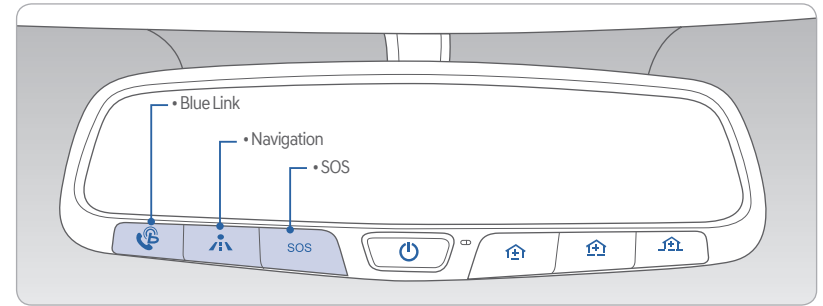

Press the  button for access to the voice-response menu of services.

You can say:

- "Service Link" to schedule a service appointment.
- "Roadside Assistance" for roadside services.
- "Blue Link Account Services" for help with your Blue Link subscription.
- Press the  button for Destination Search.
 - Command: Find <POI Name>.
 - Example: “Find Starbucks”.
- Press the **SOS** button for SOS Emergency Assistance.
- Refer to your Blue Link User’s Manual for detailed information on system operation.
- For immediate assistance with subscription services, please call 1-855-2BLUELINK (1-855-225-8354).

Remote Start



You can download the Blue Link mobile app to your compatible smart phone from the following sites:

- iPhone® — Apple® App Store
- Android® — Google Play

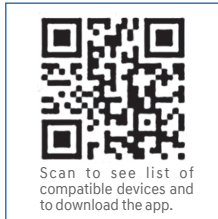

Remote Start enables you to remotely start your vehicle from virtually anywhere. For navigation vehicles, you can also enable climate control remotely and turn on the rear-window defroster, ensuring a warm or cool car is ready to go when you are.

- To use this feature, you must have a Blue Link Personal Identification Number (PIN). To create or change your PIN, log on to www.MyHyundai.com.

Remember:

- Remote Start with Climate Control will automatically shut off after 10 minutes or after selected engine timer runs out in navigation vehicles.
- While this feature is active, the parking lights will blink until vehicle is turned off or when vehicle is in operation.
- To continue operation of the vehicle, the proximity key must be inside the vehicle with the driver prior to pressing the brake and being able to move the gearshift from the P (Park) position.

Preconditions:

- Ignition is OFF
- Alarm is armed (i.e., vehicle locked by key fob Remote Door Lock)
- Gearshift level is in the P (Park) position
- Brake pedal is not depressed
- Engine hood is securely closed
- All the doors are closed and locked
- The tailgate or trunk lid is closed
- The security/panic system is not activated
- The proximity key is not inside the vehicle
- The battery power is not low
- Vehicle is located in an open area
- It has been less than 4 days since last vehicle ignition off
- Vehicle located in area with good cell reception

Remote Start will terminate:

- After 10 minutes or after selected engine timer runs out in navigation vehicles
- Brake is pressed without proximity key inside vehicle
- Alarm is triggered without proximity key inside vehicle
- Door/trunk is opened from inside the vehicle

Notice: Laws in some communities may restrict the use of the features that remotely start the engine. For example, some laws may require a person using the remote start feature to have the vehicle in view when doing so or limit the length of time a vehicle engine may idle. Please check local and state regulations for any requirements and restrictions on remote starting of vehicles and engine idling time.

WARNING!

Do not remote start vehicle in an enclosed environment (i.e., closed garage). Prolonged operation of a motor vehicle in an enclosed environment can cause a harmful build-up of carbon monoxide. Carbon monoxide is harmful to your health. Exposure to high levels of carbon monoxide can cause headaches, dizziness or in extreme cases unconsciousness and/or death. Do not leave children or animals unattended in a vehicle while using the remote start function.

CAUTION!

If the vehicle's windshield wipers are left on when the vehicle was last driven, then the wipers will turn on if the remote start function is activated. To avoid damage to the wiper blades (i.e., due to heavy ice or snow accumulated on the windshield), please always turn the vehicle's windshield wipers off when parking the vehicle.

RADIO MODE

Display Audio

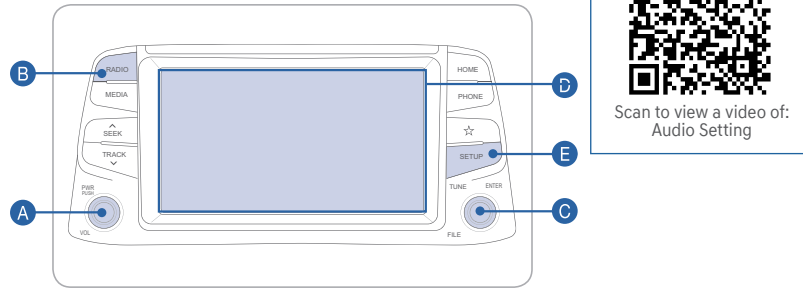

Press POWER button **A** to turn radio on.

• TUNING/LISTENING TO CHANNELS

1. Press BAND button **B** on screen to select FM/AM/SiriusXM®*.
2. ROTATE TUNE knob **C** to desired channel.

NOTE: A clear view of the southern sky helps ensure SiriusXM®* radio reception.

• SETTING PRESET MEMORY BUTTONS

Press and hold any preset button **D** on the screen until an audible beep is heard to store current channel.

• ADJUSTING THE SOUND CONTROL

1. Press the SETUP button **E** and press the SOUND button on screen to display the Sound Settings screen.
2. Touch on-screen arrows to adjust desired setting.



*SiriusXM® is only available on Display Audio Light and Navigation

Navigation

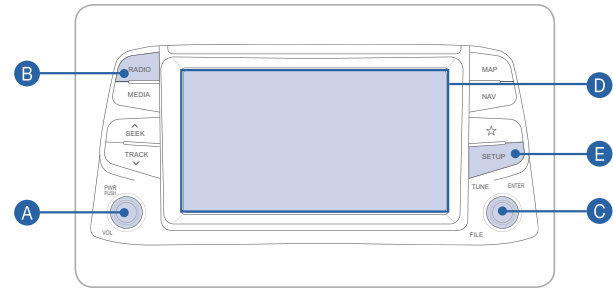

Press POWER button **A** to turn radio on.

• TUNING/LISTENING TO CHANNELS

1. Press RADIO button **B**.
2. Rotate TUNE knob **C** to desired channel.

NOTE :

A clear view of the southern sky helps to ensure SiriusXM®* radio reception.

• SETTING PRESET MEMORY BUTTONS (FM/AM/SiriusXM®*)

Press and hold any preset button (1-6) **D** until audible beep is heard to store current channel.

• ADJUSTING THE SOUND CONTROL

1. Press SETUP button **E** and press the sound button on the display.
2. To adjust the Fader/Balance, select the on-screen tab. Touch the on-screen arrows to adjust the desired setting for front, rear, left, or right balance.
3. To adjust the Bass/Midrange/Treble, select the on-screen tab. Touch the on-screen arrows to adjust the tonal sound settings to the desired level.

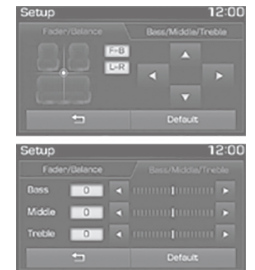

*SiriusXM® is only available on Display Audio Light and Navigation

NAVIGATION MULTIMEDIA SYSTEM

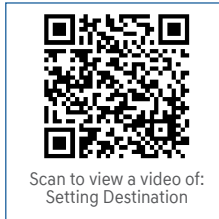

Basic features on the map screen

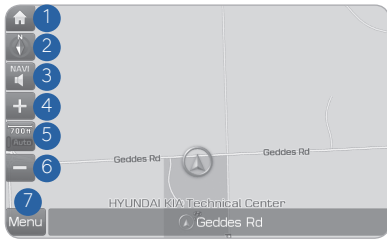

- 1 Move to the Home Screen.
- 2 Change the map view mode.
- 3 Voice Guidance On / Off.
- 4 Zoom in on the map.
- 5 Set the zoom level automatically according to the guidance.
- 6 Zoom out on the map.
- 7 Quick and easy selection of a destination and options.

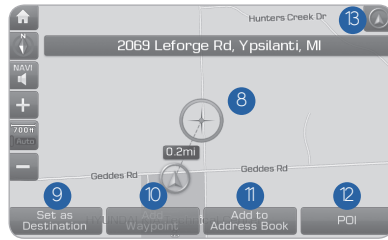

- 8 Touch to scroll around the map.
- 9 Quick and easy selection of a destination from the map screen.
- 10 Set a waypoint to the current route.
- 11 Save a frequently used address to the address book.
- 12 Find a POI (Point Of Interest) around the current position.
- 13 View the vehicle's current position on the map screen.

Basic features on the map screen

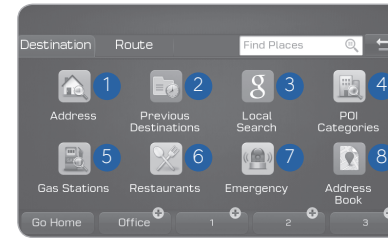

- 1 Set the destination by inputting the address directly.
- 2 Select from the previously input addresses and POIs.
- 3 Search for a location using Google Local Search.
- 4 Select the desired item in POI Categories.
- 5 Search and select the desired item in the Gas Station category.
- 6 Search and select the desired item in the Restaurant category.

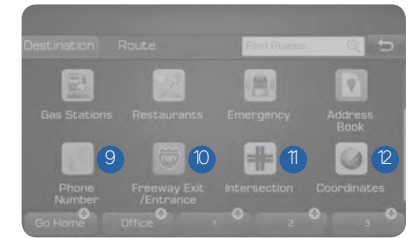

- 7 Select the desired destination among the searched emergency facilities
- 8 Search the destination with the address book.
- 9 Search the destination by phone number.
- 10 Type the freeway name and exit / entrance to search.
- 11 Type the 1st Street name, the State, the 2nd Street name to search.
- 12 Type the coordinates to search.

ANDROID AUTO™

REQUIREMENTS:

- Micro USB cable
- OS Android™ 5.0 or higher
- Compatible Android Phone
- Data and wireless plan for applicable features

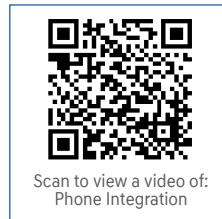

BEFORE YOU BEGIN:

- Android Auto features may operate differently on your phone from what is described below.
- Message and data charges may apply when using Android Auto.
- Android Auto relies on the performance of your phone. If you experience performance issues:
 - Close all apps and then restart them or
 - Disconnect and then reconnect your phone
- Using the micro USB cable that was provided with your phone is recommended.
- When Android Auto is active, your in-vehicle voice recognition system is disabled and you will be using talk to Google™ to make your requests.

ANDROID AUTO SUPPORT



<https://support.google.com/androidauto/>

PHONE SETUP

Turn on Bluetooth® on your phone and connect the micro USB cable to your phone and the USB port on the vehicle.

Phone will prompt you to download the Android Auto app and update other needed apps (i.e. Google Maps™, Google Play Music™, Google Now™).

NOTE Vehicle must be parked.

- Location mode setting should be set to High accuracy.
- Car and phone setup should be completed in one sitting. If phone setup needs to be resumed, recommend to Force Stop the Android Auto app on the Phone then reopen the app and accept the Disclaimer notifications.

CAR SETUP

1. Press the SETUP button on the radio.
2. Touch the “Connectivity” icon on screen.
3. Select “On” for Android Auto.
4. Connect your Android phone to the vehicle USB port. Agree to the notification and disclaimers on your phone then the “Android Auto” icon will appear confirming the setup.

For more detailed information on how to operate Android Auto, please refer to your navigation manual.

For additional Android Auto support, please refer to the Android Auto Support Website
<https://support.google.com/androidauto/>

Android Auto, Google Play, Android, and other marks are trademarks of Google Inc.

APPLE CARPLAY™

REQUIREMENTS

- Apple Lightning® cable
- Latest iOS
- iPhone® 5 or above
- Data and wireless plan for applicable features

BEFORE YOU BEGIN

- Apple® CarPlay features may operate differently on your phone from what is described below.
- Message and data charges may apply when using Apple CarPlay.
- Apple CarPlay relies on the performance of your phone. If you experience performance issues:
 - Close all apps and then restart them or
 - Disconnect and then reconnect your phone
- Using the Apple Lightning cable that was provided with your phone is recommended.
- When Apple CarPlay is active, your voice recognition system is disabled and you will be using Siri® to make your requests.

PHONE SETUP

On your phone, go to Settings > General > Restrictions > CarPlay to allow CarPlay access.

On your phone, go to Settings > General > Siri and ensure Siri is turned ON.

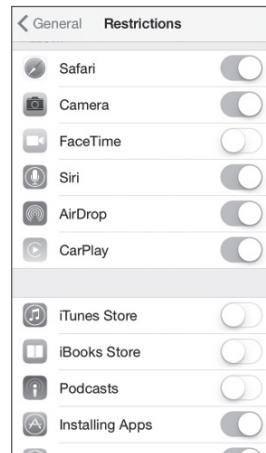

CAR SETUP

1. Press the SETUP button.
2. Touch the "Connectivity" icon on the screen.
3. Touch "iOS" on the Connectivity Settings screen then touch "On" to enable Apple CarPlay.
4. Connect your Apple iPhone to the vehicle USB port then touch 'OK' when the pop-up message appears. The Apple CarPlay icon will now appear on the vehicle Home screen confirming the setup.

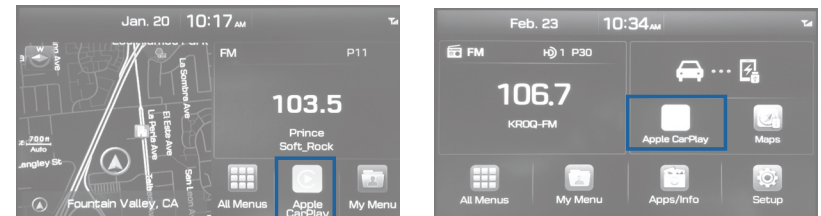

Apple CarPlay, Apple, and other marks are trademarks of Apple Inc.

CarPlay Home Screen

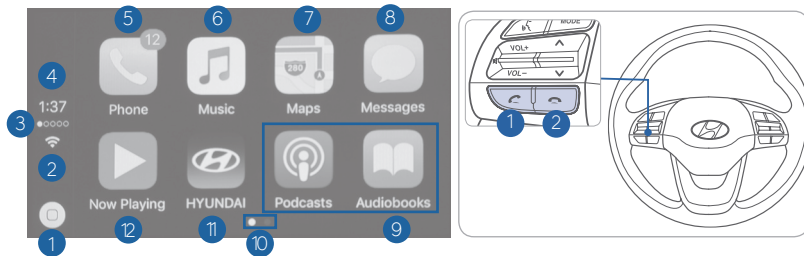

- | | |
|-------------------------|----------------------------------|
| 1 HOME ICON | 7 APPLE MAPS |
| 2 WIRELESS CONNECTIVITY | 8 MESSAGES |
| 3 CELLULAR SIGNAL | 9 3RD PARTY APPS |
| 4 PHONE TIME | 10 SCREEN PAGE INDICATOR |
| 5 PHONE | 11 EXIT TO HYUNDAI |
| 6 APPLE MUSIC™ | 12 CURRENT CARPLAY AUDIO PLAYING |

SIRI

Apple CarPlay uses Siri to perform many actions like sending messages, placing calls, and looking up/setting POI/Destinations. A Siri session can be initiated on any screen by:

1. Touch and holding the HOME icon 1 on the CarPlay screen or
2. Press the steering wheel VOICE RECOGNITION 13 button.

NOTE Ensure Siri feature is set to ON in your phone (Go to Settings > General > Siri).

3. Say any of the following commands;
 - “Text <John Smith> ‘Call you later’” to send a text message.
 - “Read text messages” to read available text message.
 - “Call <John Smith>” to make a phone call.
 - “Find <POI/Destination>” to locate a POI/Destination.

PHONE

Touch the PHONE 5 icon to access the Phone screen. Siri will automatically asks ‘Who you would like to call’ when the PHONE 5 icon is selected.

NOTE: Phone call sound quality is dependent on the wired connection. Using the Lightning cable that came with the phone is recommended.

APPLE MUSIC

Touch the APPLE MUSIC 6 icon to access the Apple Music screen.

APPLE MAPS

Touch the APPLE MAPS 7 icon to access the Apple Map screen.

MESSAGES

Touch the MESSAGES 8 icon to access the Message screen. Siri will automatically asks ‘To hear unread messages or create a new one’ when the MESSAGE icon is selected.

3rd PARTY APPS

Supported CarPlay apps that are downloaded on your phone will appear on the CarPlay screen. Touch the apps icons to access those supported apps.

NOTE A list of the supported CarPlay supported apps can be found at <http://www.apple.com/ios/carplay/>

Ensure phone has latest version of the 3rd Party Apps.

AUX AND USB PORT

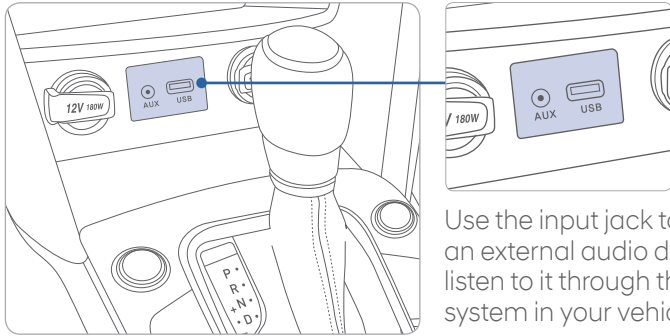

Use the input jack to connect an external audio device and listen to it through the audio system in your vehicle.

WIRELESS CELLULAR PHONE CHARGING SYSTEM

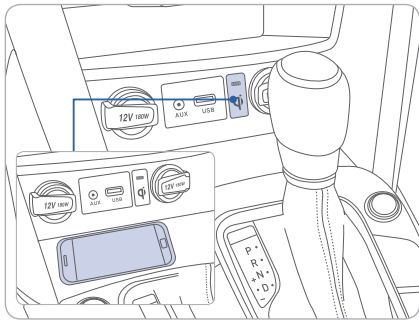

There is a wireless cellular phone charging system inside the front console. The system operates with all doors closed, and the ignition switch is in the ACC/ON position.

NOTE:

The wireless cellular phone charging system supports only the Qi-enabled cellular phones (☑).

NOTE: Do not place any metallic items such as coins, keys on the charger. Avoid putting credit cards, etc. on the charger as they might get damaged by the magnetic field.

DUAL CLUTCH TRANSMISSION

The purpose for the dual clutch transmission in your vehicle is to allow for better acceleration performance and increased fuel efficiency. This type of transmission can be thought of as an automatically-shifting manual transmission. It differs from a conventional automatic in how the engine is connected to the transmission. There's no torque converter. This creates more of a direct-drive feel, with the transition from one gear to the next managed by clutch slip, especially at lower speeds. As a result, shifts are sometimes more noticeable, and a light vibration can be felt as the transmission speed is matched with the engine speed. This is a normal condition of the dual clutch transmission.

DCT – Helpful Tips While Driving

Follow the helpful guidelines below to enhance your driving experience with your vehicle.

- When holding your vehicle on a hill or driving slowly up a hill, apply the brakes rather than trying to hold the vehicle by keeping your foot on the accelerator pedal.
- Try to avoid spending too much time inching or creeping forward, especially when moving slowly up an incline. This generates heat in the transmission quickly.
- When traffic is slowly creeping forward, let a gap form in front of you, then start to move forward. This will allow the clutch to engage and minimize the amount of slip.

ANTICIPATING HOW YOUR VEHICLE RESPONDS

The dual clutch transmission is designed to anticipate and select the next available gear when accelerating or decelerating. In most instances, this allows for quicker shifts and improved fuel economy because energy loss is minimized between the engine and the transmission. If, however, you attempt to accelerate rapidly when your vehicle is slowing down, (for example, when approaching a red light and then the light turns green), you may experience a delay because it takes longer for the transmission to re-select and shift into the proper gear.

What is the Transmission High Temperature Warning Message?

- Under certain driving conditions such as stop-and-go driving or driving slowly up a hill, the clutches tend to have more slip. This condition tends to heat up the transmission.
- If the transmission temperature gets too high, a chime will sound and a warning message will appear in the instrument cluster LCD display.

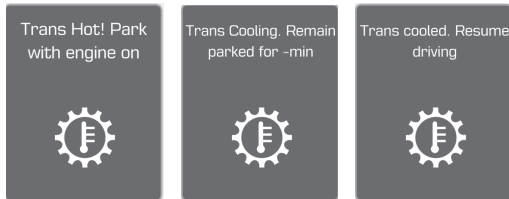

- If this occurs, stop the vehicle as soon as safely possible and allow the transmission to cool with the engine running. After the transmission cools, the vehicle may be driven normally.

What if I'm Driving in Stop-and-Go Traffic?

- Whenever possible, come to a complete stop with your vehicle and allow a gap to form in front of you. Then accelerate and move forward.

Refer to your Owner's Manual for additional info on the DCT.

TRANSMISSION

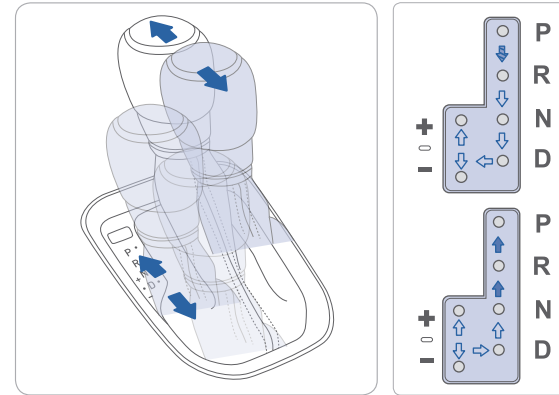

(➡): Press the shift button, then move the shift lever.

(⏏): Depress the brake pedal, press the shift button, and then move the shift lever.

(➡): Move the shift lever.

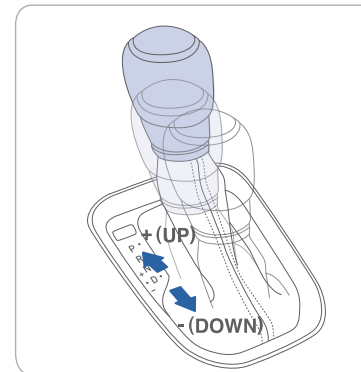

Sport mode

Move the shift lever from D (Drive) into the manual gate to select. Move the shift lever forward (+) to upshift or rearward (-) to downshift.

TIRE PRESSURE MONITORING SYSTEM (TPMS)



Low Tire Pressure Indicator / TPMS Malfunction Indicator

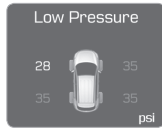

Low Tire Pressure Monitor with Location Indicator (Shown on the LCD display)

LOW TIRE PRESSURE INDICATOR

Illuminates if one or more of your tires are significantly under-inflated.

TPMS MALFUNCTION INDICATOR

Blinks for approximately one minute, then remains illuminated when there is a malfunction with the TPMS. Inspect all tires and adjust the tire pressure to specification. If the lamp remains illuminated, have the system checked by an authorized Hyundai dealer as soon as possible.

LOW TIRE PRESSURE LOCATION INDICATOR AND TIRE PRESSURE INDICATOR (LCD DISPLAY)

Tire pressures will be displayed after driving a short distance. If a tire pressure drops lower than predetermined specification, the Low Tire Pressure Indicator (🚗) will illuminate and the LCD 📺 display will indicate the tire(s) requiring air.

ELECTRONIC STABILITY CONTROL (ESC)

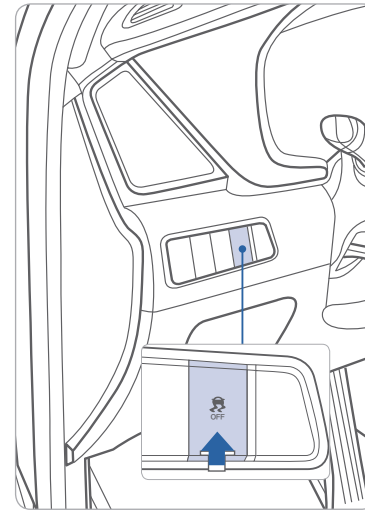

The ESC system is an electronic system designed to help the driver maintain vehicle control under adverse conditions.

The ESC automatically selects the ON position when the engine is started.

- To turn off the Traction Control, press the ESC OFF button shortly.
- To turn off the Traction and the Stability Control, press the ESC OFF button for over 3 seconds.

DOWNHILL BRAKE CONTROL (DBC)

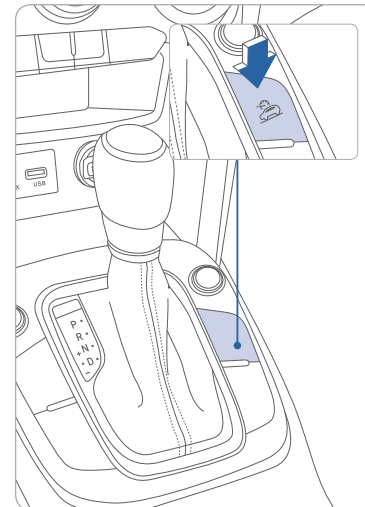

The Downhill Brake Control (DBC) helps the driver maintain a slow speed on a steep downhill without depressing the brake pedal.

The system automatically applies the brakes to keep the vehicle speed under 5 mph.

NOTE:

When activated, the speed of the vehicle will be reduced. Please refer to your Owner's Manual for further information.

LANE KEEPING ASSIST (LKA)

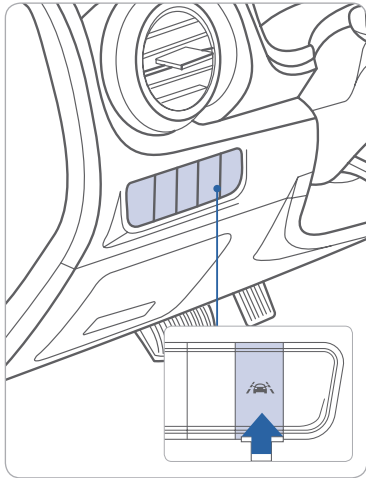

The Lane Keeping Assist (LKA) detects the lane on the road and warns the driver if the vehicle leaves the lane when the vehicle speed is over 40mph.

- To turn on the LDWS, press the LDWS button.
- To turn off the LDWS, press the LDWS button again.

BLIND SPOT COLLISION WARNING (BCW)

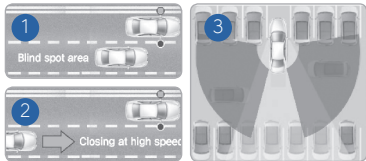

The BCW (Blind-Spot Collision Warning) system uses a radar sensor to alert the driver while driving.

The system monitors the rear area of the vehicle and provides information to the driver. The system incorporates the following functions:

- 1 Blind-Spot Collision Warning (BCW)
- 2 Lane Change Assist (LCA)
- 3 Rear Cross-Traffic Collision Warning (RCCW)- in reverse gear under 6 mph

- To turn on the BCW, press the BCW button(indicator illuminated).
- To turn off the BCW, press the BCW button again.

The BCW and LCA systems will activate once the vehicle speed exceeds 20 mph. The RCCW system activates in reverse gear under 6 mph.

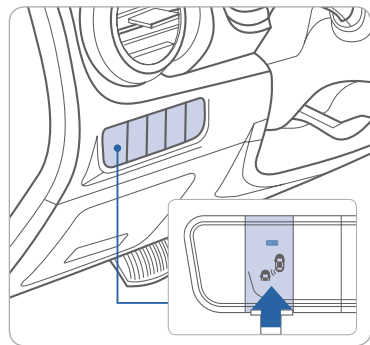

DRIVE MODE INTEGRATED CONTROL SYSTEM

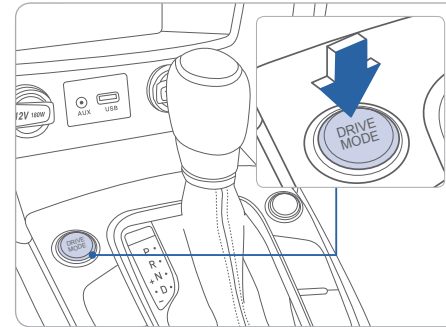

You can select the DRIVE mode according to your preference or the road condition. The system defaults to NORMAL mode each time you start your vehicle.

Each time you press the button, the drive mode changes as follows :

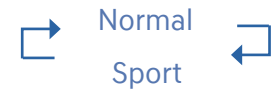

NORMAL mode

NORMAL mode is not displayed on the instrument cluster.

Sport mode

Sport mode focuses on dynamic driving by controlling the steering wheel effort, and engine / transmission performance.

AWD LOCK

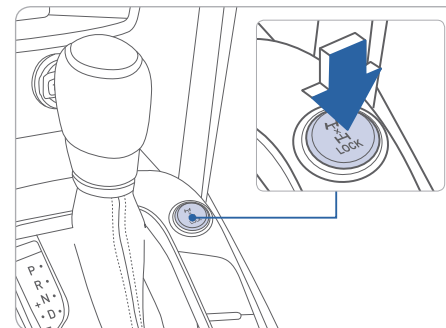

During off-road or inclement weather conditions, press the AWD LOCK switch to drive in full-time AWD. This will divide the power between the front and rear wheels (only when the vehicle speed is under 19 mph). The AWD LOCK indicator light on the instrument cluster will illuminate.

FORWARD COLLISION-AVOIDANCE ASSIST (FCA)

Forward Collision...

↩ Back

Late

Normal

Early

The Forward Collision-Avoidance Assist (FCA) system is designed to detect and monitor the vehicle ahead or detect a pedestrian in the roadway and warn the driver if a collision is imminent.

To operate the system, select the FCA (Forward Collision Avoidance Assist) sub menu in the LCD cluster display under User Settings. Please refer to your Owner's Manual for further information.

CRUISE CONTROL

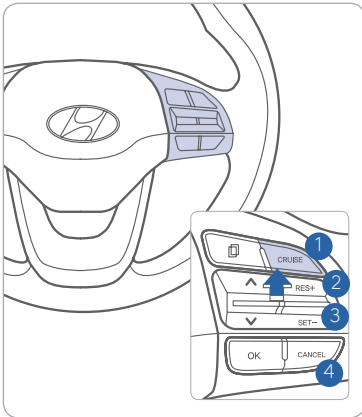

The cruise control system allows you to program the vehicle to maintain a constant speed without holding the accelerator pedal.

- 1 To turn ON / OFF the cruise control.
- 2 To Resume or Increase the cruise control speed.
- 3 To Set or Decrease the cruise control speed.
- 4 To Cancel the cruise control.

REAR VIEW MONITOR

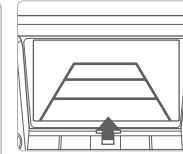
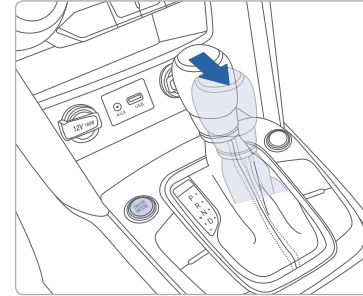

Scan to view a video of:
Backup Camera

When the transmission is shifted into the R (Reverse), the rearview camera displays the area behind the vehicle.

REAR PARKING ASSIST SYSTEM

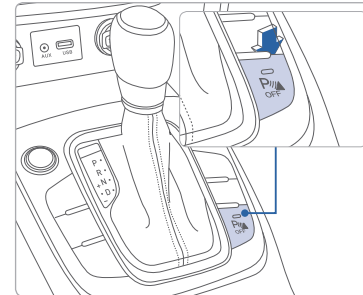

The rear parking assist system assists the driver during the reverse movement of the vehicle by chiming if any object is sensed within a distance of 47 inches behind the vehicle.

Push the button to turn off the rear parking assist system. The indicator light on the button will turn on.

KONA CUSTOMER DELIVERY CHECKLIST

HYUNDAI OWNER	DEALERSHIP NAME
SALES CONSULTANT	DATE
VIN	PREVIOUS VEHICLE

BEFORE DELIVERY

- SET TIRE PRESSURE LF___RF___RR___LR___
- VERIFY VEHICLE IS CLEAN, IN GOOD CONDITION, FREE OF CHIPS AND SCRATCHES · CLEAN WINDSHIELD AND BACK WINDOW
- ENSURE FLOORMATS ARE SNAPPED INTO PLACE

WALK THE CUSTOMER THROUGH EACH OF THE FOLLOWING KEY DELIVERY FEATURES

- REVIEW QUICK REFERENCE GUIDE
- PAIR CUSTOMER'S PHONE TO THE BLUETOOTH SYSTEM (if equipped) - page 24
- OPERATION OF THE NAVIAGATION SYSTEM (if equipped) - page 32
- REVIEW AND TEAR OFF VOICE COMMAND / QUICK TIP CARD
- OPERATION OF THE AUDIO SYSTEM - page 30

- BLUE LINK – pages 27
 - Assist with creating MyHyundai.com account
 - Assist with Blue Link enrollment
 - Show Blue Link Users Manual
 - Encourage customer to download the MyHyundai by Blue Link app

- VOICE RECOGNITION – page 26
 - Review Voice Recognition tips
 - Show Voice Recognition tear off card and have owner place in convenient location



CONNECTING YOUR PHONE

- On the radio:**
1. Push the **SETUP** button.
 2. Select **Bluetooth**.
 3. Select **Bluetooth Connection**.
 4. Select **Add New**.

- In your phone's Bluetooth settings:**
5. Select the <Vehicle Name> on your phone.
 6. Enter the passkey from the radio or accept the authorization pop-up on your phone.

SWITCHING BETWEEN PAIRED PHONES

Using Voice Command:
 "Change Bluetooth device"

- On the radio:**
1. Push the **SETUP** button.
 2. Select **Bluetooth**.
 3. Select **Bluetooth Connection**.
 4. Select **Connect** next to the desired phone.

For more information, visit HyundaiBluetooth.com