

WALK THE CUSTOMER THROUGH EACH OF THE FOLLOWING KEY DELIVERY FEATURES

How to Defrost - page 22

- 1 Press the front defrost button.
- 2 Set to warmest temperature setting.
- 3 Set to highest fan speed.

Tire Pressure Monitoring System (TPMS) - page 36



LOW TIRE PRESSURE INDICATOR /
TPMS MALFUNCTION INDICATOR

NOTE: Tire pressure may vary in colder temperatures causing the low tire pressure indicator  to illuminate. Inflate tires according to the Tire Pressure Label located on the driver's side door pillar.

Windshield Wiper / Washer - page 13

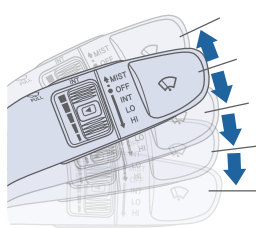

- MIST** • To activate wipers, move the switch down to one of the three positions (INT, LO, HI).
- OFF**
- INT** • To adjust "INT" speed, move switch.
- LO** • To spray washer fluid, pull lever toward you.
- HI** • Push lever up for a single wiper pass.

Unlocking vehicle - page 02

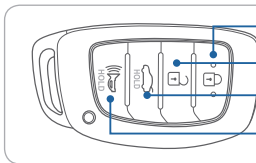

- LOCK
- UNLOCK
- LIFTGATE UNLOCK
- PANIC

BLUE LINK - pages 29

- Assist with creating MyHyundai.com account
- Assist with Blue Link enrollment
- Show Blue Link Users Manual
- Encourage customer to download the MyHyundai with Blue Link app

MAINTENANCE

Scheduled Maintenance	Normal Usage		Severe Usage*	
Engine Oil and Filter*	Replace	7,500 or 12 mos.	Replace	3,750 or 6 mos.
Fuel Additive	Add	7,500 or 12 mos.	Add	Same as Normal
Tire Rotation	Perform	7,500	Perform	Same as Normal
Air Cleaner Filter	Inspect Replace	7,500 30,000	Inspect Replace	Same As Normal More Frequently
Vacuum Hose	Inspect	7,500	Inspect	Same As Normal
Climate Control Air Filter (for Evaporator and Blower Unit)	Replace	15,000	Replace	More Frequently
Air Conditioning Refrigerant	Inspect	15,000	Inspect	Same As Normal
Brake Hoses & Lines	Inspect	15,000	Inspect	Same As Normal
Drive Shafts & Boots	Inspect	15,000	Inspect	7,500
Exhaust Pipe & Muffler	Inspect	15,000	Inspect	Same As Normal
Front Disc Brake/Pads, Calipers & Rotors	Inspect	15,000	Inspect	More Frequently
Rear Brake Disc/Pads	Inspect	15,000	Inspect	More Frequently
Steering Gear Box, Linkage & Boots/ Lower Arm Ball Joint, Upper Arm Ball Joint	Inspect	15,000	Inspect	More Frequently
Suspension Mounting Bolts	Inspect	15,000	Inspect	Same As Normal
Brake Fluid	Inspect	30,000	Inspect	Same As Normal
Engine Clutch Actuator Fluid	Replace	22,500	Replace	Same As Normal
Crankcase Ventilation Hose	Inspect	30,000	Inspect	Same As Normal
Fuel Filter	Inspect	30,000	Inspect	Same As Normal
Fuel Lines, Fuel Hoses and Connections	Inspect	30,000	Inspect	Same As Normal
Fuel Tank Air Filter	Inspect	30,000	Inspect	Same As Normal
Parking Brake	Inspect	30,000	Replace	More Frequently
Vapor Hose, Fuel Tank & Fuel Filler Cap	Inspect	30,000	Replace	Same As Normal
Spark Plugs	Replace	105,000	Replace	More Frequently
HSG Belt	Inspect Replace	7,500 or 12 mos. 60,000 or 48 mos.	Inspect Replace	3,750 or 6 mos. 30,000 or 24 mos.
Coolant		1st Replace 120,000 or 120 mos. Add'l Replace 30,000 or 24 mos.	Replace	Same As Normal
Dual Clutch Transmission Fluid	Inspect	37,500	Replace	75,000

*Check the engine oil regularly between recommended oil change. Hyundai recommends Quaker State oil.

*See Owner's Manual for details.

Looking For more detailed information? This Quick Reference Guide does not replace your vehicle's Owner's Manual. If you require additional information or are unsure of a specific issue, we recommend that you always refer to the vehicle's Owner's Manual or contact your authorized Hyundai dealer. The information contained in this Quick Reference Guide is correct at the time of printing; however, specifications and equipment can change without notice. No warranty or guarantee is being extended in this Quick Reference Guide, and Hyundai reserves the right to change product specifications and equipment at any time without incurring obligations. Some vehicles are shown with optional equipment.



HYUNDAI IONIQ HYBRID

Quick Reference Guide

Roadside Assistance: 1-800-243-7766

Consumer Affairs: 1-800-633-5151

Sirius XM® Radio: 1-800-967-2346

Blue Link: 1-855-2BLUELINK
(1-855-225-8354)



HYUNDAI VEHICLE OWNER PRIVACY POLICY

Your Hyundai vehicle may be equipped with technologies and services that use information collected, generated, recorded or stored by the vehicle. Hyundai has created a Vehicle Owner Privacy Policy to explain how these technologies and services collect, use, and share this information.

You may read our Vehicle Owner Privacy Policy on the Hyundaiusa.com website at <https://www.hyundaiusa.com/owner-privacy-policy.aspx>. If you would like to receive a hard copy of our Vehicle Owner Privacy Policy, please contact our Customer Connect Center at:

Hyundai Motor America
Hyundai Customer Connect Center
P.O. Box 20850
Fountain Valley, CA 92728-0850
800-633-5151 consumeraffairs@hmmausa.com

Hyundai's Customer Connect Center representatives are available Monday through Friday, between the hours of 5:00 AM and 7:00 PM PST and Saturday and Sunday between 6:30 AM and 3:00 PM PST (English). For Customer Connect Center assistance in Spanish or Korean, representatives are available Monday through Friday between 6:30 AM and 3:00 PM PST.

Driver position
memory system
Page06

Instrument
panel
illumination
Page20

Instrument
cluster
Page17

Wiper and
washer
Page13

Navigation
Page33

Cruise control/
Smart cruise
control
Page42

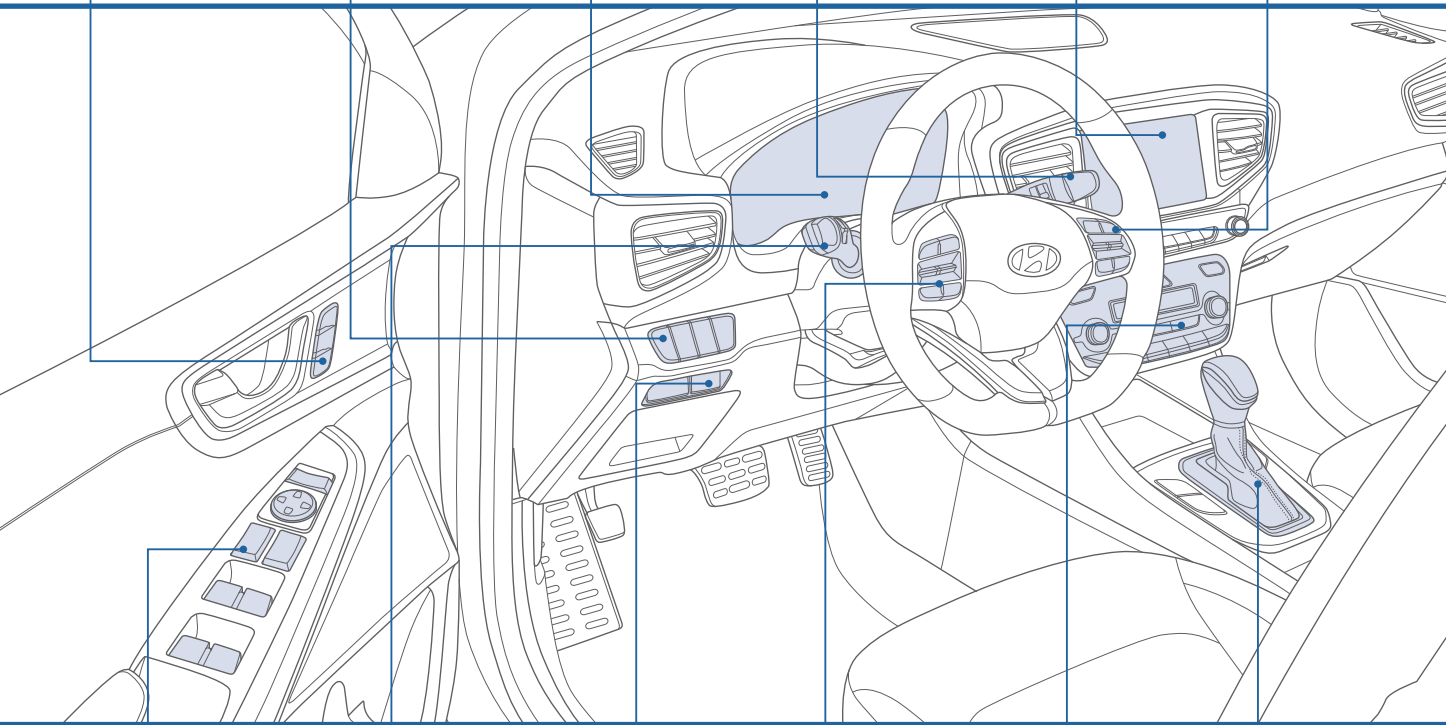

Driver's main
controls
Page07

Headlights
Page12

12V Battery
Reset Switch
Page14

Steering wheel
audio control
Page26

Climate
control
Page22

Dual clutch
transmission
Page37

FEATURES AND CONTROLS

12 volt battery reset switch	14
Automatic climate control	22
Child-protector rear door lock	08
Driver position memory system	06
Driver's main controls	07
Dynamic bending light (DBL)	13
Engine start/stop button	03
Fuel filler door	08
Headlights	12
High voltage battery cooling duct	15
Homelink wireless control system	10
Hybrid battery SOC(State Of Charge) gauge	19
Instrument cluster	17
Instrument panel illumination	20
Interior lights	11
LCD display control	20
LCD display modes	21
Liftgate opening	09
Power gauge	19
Seat-Front seat adjustment (manual)	04
Seat-Front seat adjustment (power)	04
Seat-Headrest adjustment	05
Seat-Rear seat folding	05
Seat-Seat belt adjustment (front seat)	05
Seat-Seat warmer (front seats)	06
Smart key	02
Steering wheel adjustments	03
Sunroof	11
Warning and indicators	18
Wireless cellular phone charging system	07
Wiper and washer	13

MULTIMEDIA

AUX, USB and iPod® port	33
Clock adjustment	34
Blue Link Telematics System	29
Bluetooth® phone call operational tips	26
Bluetooth® phone pairing	24
Navigation	33
Radio mode	36
Steering wheel audio control	26
Voice recognition tips	28

DRIVING

Autonomous emergency braking (AEB)	41
Blind spot detection system (BSD)	40
Cruise control/smart cruise control	42
Dual clutch transmission	37
Electronic stability control (ESC)	39
Hybrid driving tips	43
Lane departure warning system (LDWS)	40
Rear view camera	16
Tire pressure monitoring system (TPMS)	41
Virtual engine sound system (VESS)	39

WARNING!

To reduce the risk of serious injury to yourself and others, read and understand the important SAFETY INFORMATION in your Owner's Manual.

Use this Quick Reference Guide to learn about the features that will enhance your enjoyment of your Hyundai. More detailed information about these features are available in your Owner's Manual.

* Some vehicles may not be equipped with all the listed features.

SMART KEY

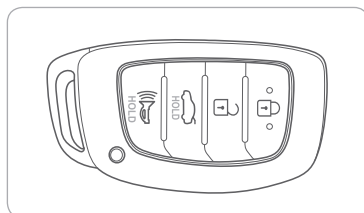

- Lock
- Unlock
- Liftgate Unlock
- Panic

NOTE:

User selectable option : see the Owner's Manual for more details.

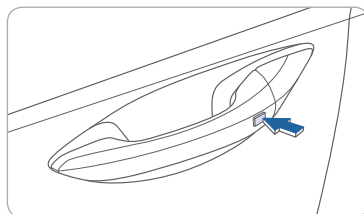

Driver's door Lock / Unlock
Smart key must be within 28~40in. from the outside door handle.

Press: Once - Unlock driver door
Twice - Unlock all doors
Third - Lock all doors

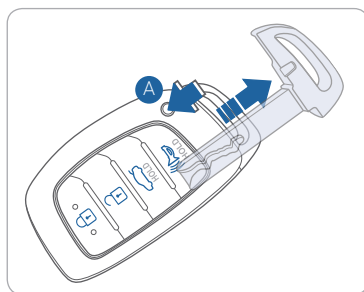

Removing the mechanical key
Press and hold the release button **A** to remove the mechanical key.

ENGINE START / STOP BUTTON

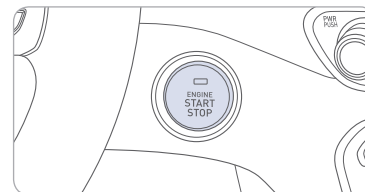

With the ignition OFF and foot OFF of brake pedal, press the Engine Start / Stop button.

- Once for ACC (Accessory) mode.
- Twice for ON mode.
- Third for OFF.

To start the vehicle in any mode (including OFF), press the Engine Start / Stop button while pressing down on the brake pedal.

To turn off the vehicle, place the shift lever in P (Park) and press the Engine Start / Stop button.

NOTE: If the START/STOP button is not lit and not responding, see the 12V Battery Reset Switch section in the Owner's Manual.

Emergency Situations

To turn the vehicle off while moving

Press the Engine Start / Stop button for more than 2 seconds or 3 times consecutively within 3 seconds.

To restart the vehicle while moving

Press the Engine Start / Stop button with the shift lever in N (Neutral).

STEERING WHEEL ADJUSTMENTS

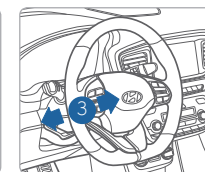
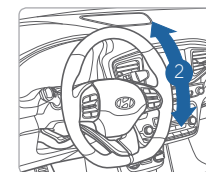
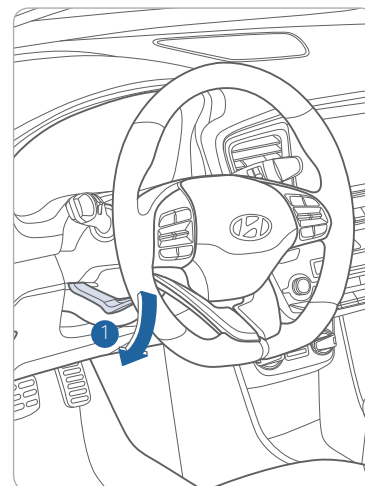

NOTE: Do not adjust while driving.

1. Pull the lever **1** down.
2. Set the angle **2** and distance **3**.
3. Pull the lever **1** up to lock position.

FRONT SEAT ADJUSTMENT (Manual)

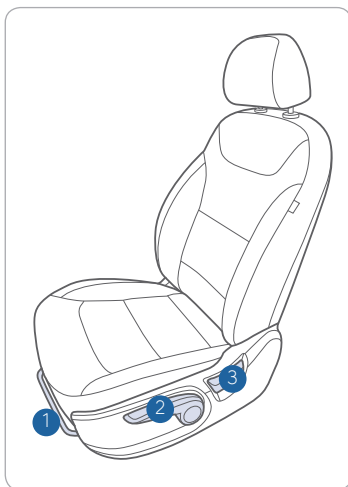

Forward and backward ①



Seat cushion height ②



Seatback angle ③



FRONT SEAT ADJUSTMENT (Power)



Forward and backward ①



Seat cushion height ①



Seatback angle ②



Lumbar support ③



HEADREST ADJUSTMENT

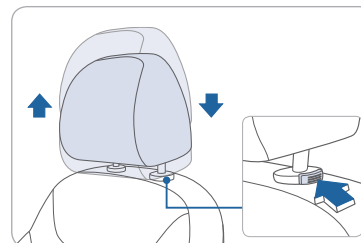

To Raise the Headrest:
Pull headrest up.

To Lower the Headrest:
Press lock button while pressing down on headrest.

SEAT BELT ADJUSTMENT (Front seat)

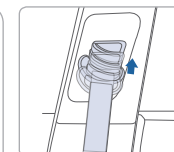
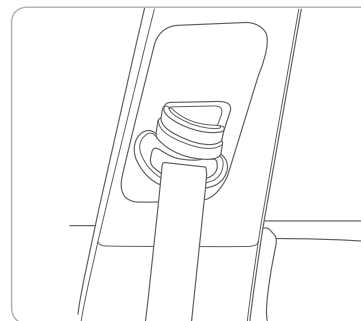

Pull up to raise.

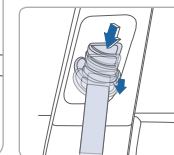

Press button and push down to lower.

REAR SEAT FOLDING

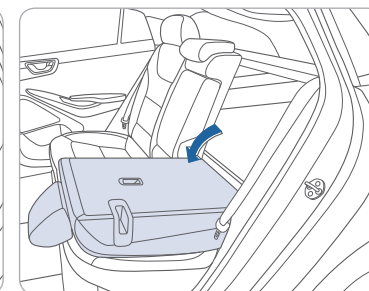
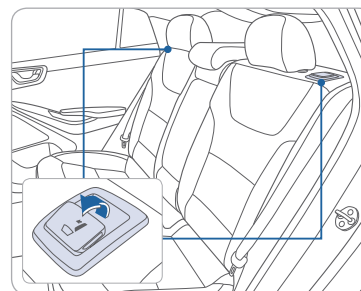

SEAT WARMER (Front seat)

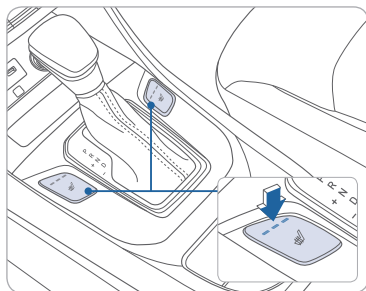

Each time you push the button, the setting is changed as follows:

OFF → HIGH → MIDDLE → LOW

If you want to turn it off immediately, press and hold the button.

DRIVER POSITION MEMORY SYSTEM

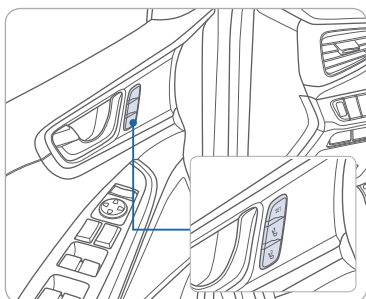

Storing

1. Adjust the driver's seat position, outside rearview mirror position and instrument panel illumination intensity.
2. Press the SET button. The system will beep once.
3. Press one of the memory buttons (1 or 2) within 4 seconds. The system will beep twice.

NOTE: The shift lever must be in P (Park).

Recalling

Press the desired memory button (1 or 2). The system will beep once.

DRIVER'S MAIN CONTROLS

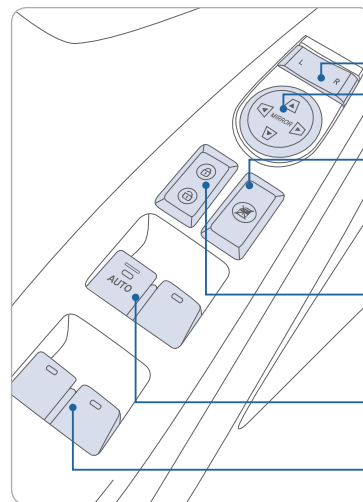

Side view mirror

- Press the L or R button.
- Adjust the mirror by using the directional switch.

Power window lock button

Disables the power window switches on the rear passenger doors.

Door lock

Locks/unlocks all doors.

Window switches

- Front doors power window switches.
- Rear doors power window switches.

WIRELESS CELLULAR PHONE CHARGING SYSTEM

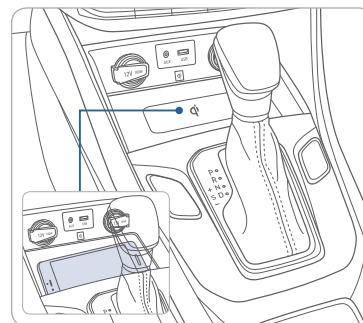

There is a wireless cellular phone charging system inside the front console. The system operates with all doors closed, and the Engine Start/Stop button in the ACC/ON/START position.

NOTE:

The wireless cellular phone charging system supports only the Qi-enabled cellular phones (Qi).

NOTE: Do not place any metallic items such as coins, keys on the charger. Avoid placing credit cards on the charger as they may be damaged by the magnetic field. The charging area may be warm while using wireless charging.

CHILD-PROTECTOR REAR DOOR LOCK

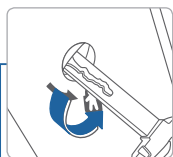
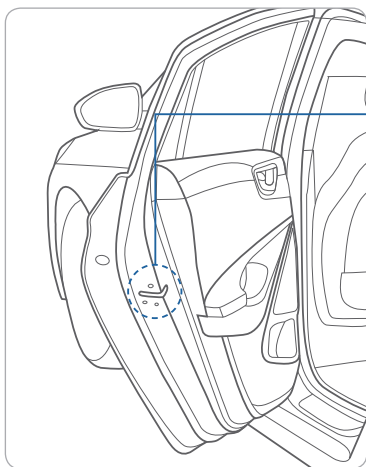

Lock
Insert a key into the hole and turn it to the lock position.

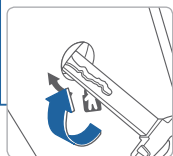

Unlock
Insert a key into the hole and turn it clockwise to the unlock position.

LIFTGATE OPENING

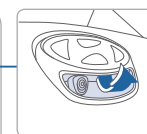
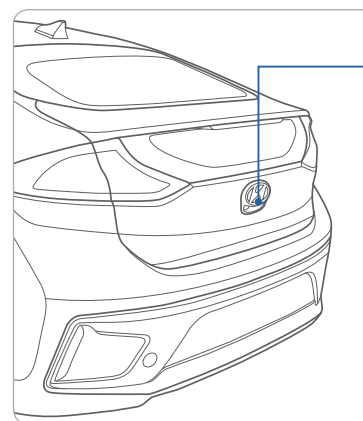

Press to open.
Smart key needs to be within the range.

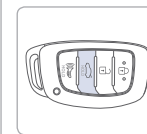

Press and hold to unlock tailgate.

FUEL FILLER DOOR

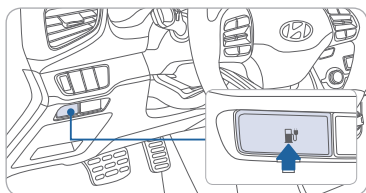

1. Push the fuel filler door opener button.

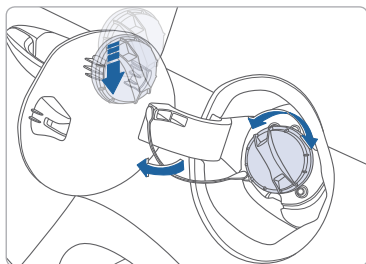

2. Remove the fuel tank cap.

NOTE:
Tighten the fuel filler cap until one click is heard.

HOMELINK WIRELESS CONTROL SYSTEM

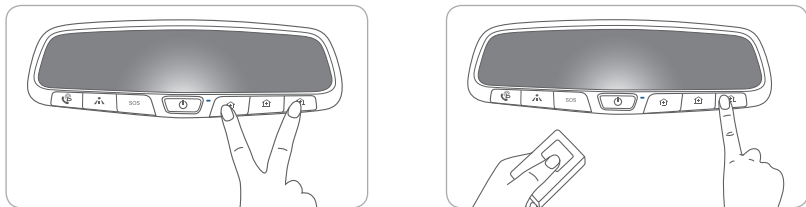

Standard Programming

To train most devices, follow these instructions:

1. For the first-time programming, press and hold the two outside buttons, HomeLink® Channel 1 and Channel 3 buttons, until the indicator light begins to flash (after 10 seconds). Release both buttons. Do not hold the buttons for over 20 seconds.
2. Position the end of your hand-held transmitter 1-3in. (2-8cm) away from the HomeLink® buttons while keeping the indicator light in view.
3. Simultaneously press and hold both the HomeLink® and the hand-held transmitter button. DO NOT release the buttons until step 4 has been completed.
4. While continuing to hold the buttons, the red indicator Status LED will flash slowly and then rapidly after HomeLink® successfully trains to the frequency signal from the hand-held transmitter. Release both buttons.

For more detailed information, please refer to your Owner's Manual, or visit www.homelink.com or call (800) 355-3515.

SUNROOF

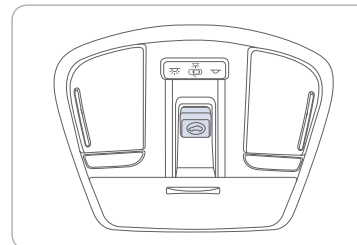

Sunshade

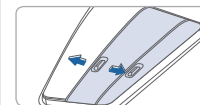

The sunshade will open automatically with the sunroof when the glass panel moves.

Sliding the Sunroof

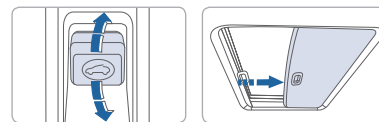

To open

Press the switch backward past the detent to open completely.

To close

Press the switch forward past the detent to close completely.

Tilting the Sunroof

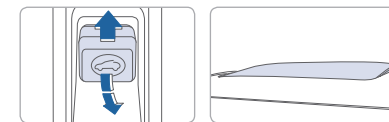

To tilt

Press the switch up.

To close

Pull the switch forward.

INTERIOR LIGHTS

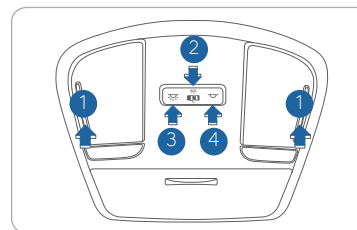

Front map lamp ①

Push the switch to turn the map lamp on or off.

Front door lamp (☾) ②

Lights will turn on when any door is open.

Front door lamp (☾) ③

Push the switch to turn the room lamp on.

Front room lamp (☾) ④

Push the switch to turn the room lamp off.

HEADLIGHTS

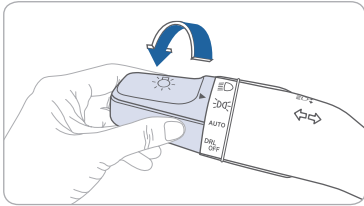

- ▶ | Headlights
- ▶ | Parking lights
- ▶ | **AUTO** Auto headlights
- ▶ | **DRL OFF** All lights OFF

Headlight Delay

Headlights may stay on for 15 seconds after exiting and locking vehicle. Press the lock button on the smart key twice to turn the headlights off.

Turn signals and lane change signals

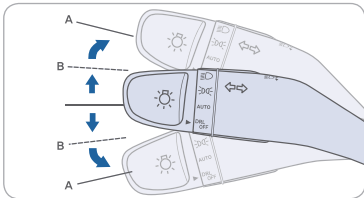

High beams

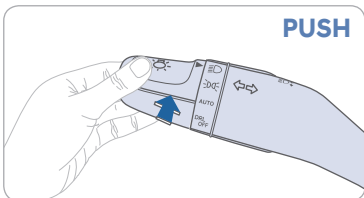

NOTE: To turn off the high beam, pull the lever towards you.

Flashing headlights

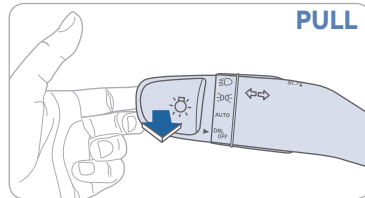

DYNAMIC BENDING LIGHT (DBL)

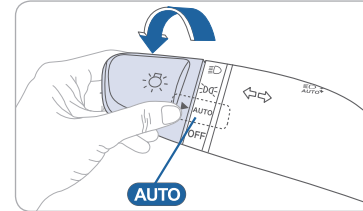

DBL uses the steering angle and vehicle speed to help keep your field of vision wide by swiveling and leveling the headlamp.

- To turn DBL on, turn the knob to the AUTO position when the vehicle is in the ready (🚗) mode.
- To turn DBL off, turn the knob back to the former position.

WIPERS AND WASHER

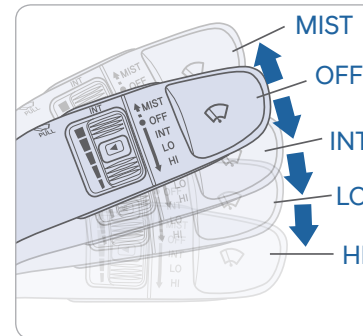

MIST - Single wipe

OFF - Off

INT - Intermittent wipe

LO - Low wiper speed

HI - High wiper speed

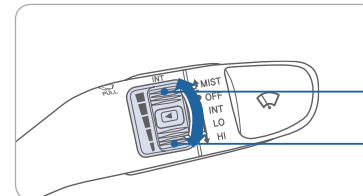

Intermittent wipe time adjustment
Move the speed control switch

Fastest wiper speed

Slowest wiper speed

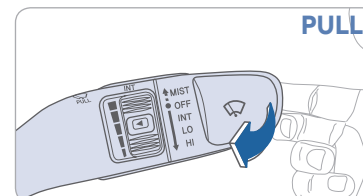

Windshield Washer

Pull the lever gently towards you to spray washer fluid on the windshield and to run the wipers 1-3 cycles.

12 VOLT BATTERY RESET SWITCH

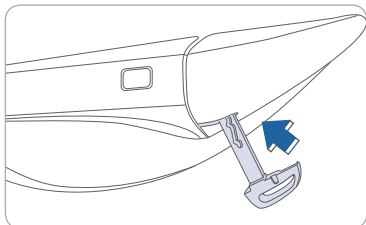

If the door is locked you will need to use the manual key to enter the vehicle after removing the lock access cover.

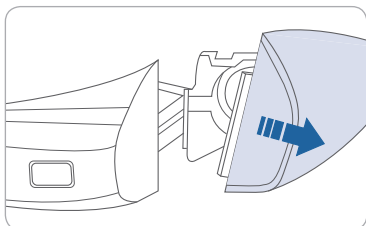

a) Use the manual key from the FOB to push up the under the driver's side handle as shown. Make sure the tab stays up. If it does not you will need to keep it pressed up while performing the next step.

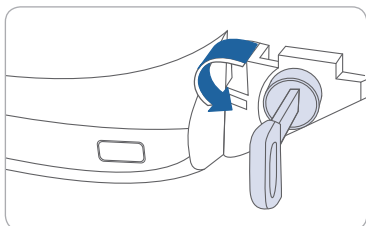

b) While holding the handle out, pull off the access cover to expose the manual lock cylinder.

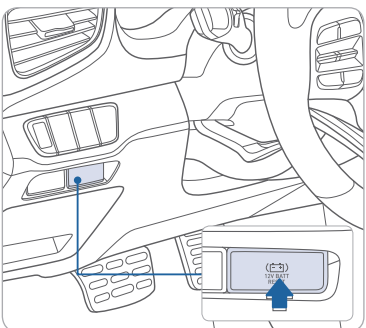

This vehicle does not have a replaceable 12V flooded lead acid battery. The 12V battery is integrated into the lithium high voltage battery assembly. Is it automatically protected against vehicle current draw when a minimum level of 12.8V 10% SOC level is reached. The 12V Battery Reset Switch has to be activated in order to start the vehicle. This should negate the need to jump start the car.

If the vehicle Start/Stop button does not respond (it has no indicator light) and the dash does not illuminate, the vehicle may be operated after the 12V Battery Reset Switch is activated per the instructions below.

1. Press the 12V Battery Reset switch to reconnect the 12V battery.
2. Start the vehicle within 15 seconds of pressing the 12V Battery Reset switch.
3. After starting vehicle (indicator on), operate the vehicle safely outdoors stopped and/or drive it for 30 minutes total to charge the 12V battery fully.

If the reset does not work due to over discharge of the 12V battery, try to jump-start the vehicle. For more detailed information, please refer to your Owner's Manual.

HIGH VOLTAGE BATTERY COOLING DUCT

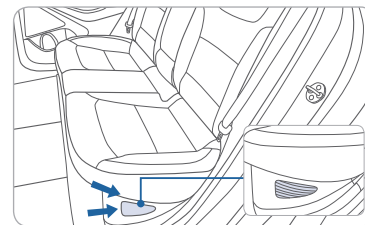

The high voltage battery cooling duct is located on the left side of the rear seats.

NOTE:

Do not obstruct the air intake with any other objects.

INSTRUMENT CLUSTER

Type A

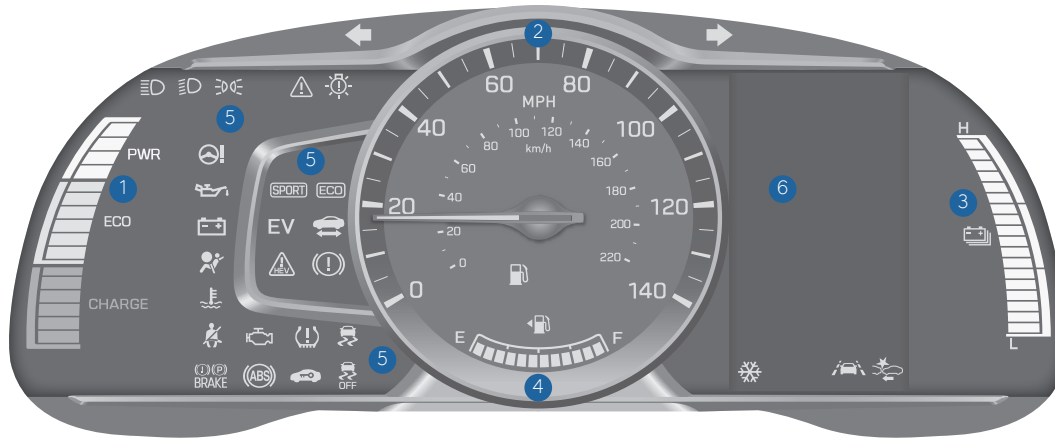

- ① Power gauge
- ② Speedometer
- ③ Battery SOC (State of Charge) gauge
- ④ Fuel gauge
- ⑤ Warning and indicator lights
- ⑥ LCD display (including Trip computer)

Type B



WARNINGS AND INDICATORS

Ready indicator	Service warning light	EV EV mode indicator
Air bag warning light	Seat belt warning light	Regenerative brake warning light
Anti-lock Brake System (ABS) warning light	Electronic Brake force Distribution (EBD) System warning light	Electric Power Steering (EPS) warning light
Malfunction Indicator Lamp (MIL)	Charging system warning light	Engine oil pressure warning light
Low fuel level warning light	Engine coolant temperature warning light	TPMS Malfunction / Low tire pressure warning light
Master warning light	Electronic Stability Control (ESC) Indicator Light	Electronic Stability Control (ESC) OFF indicator light
Immobilizer indicator	Turn signal indicator light	High beam indicator light
Light ON indicator light	Exterior light warning light	Cruise indicator
Cruise SET indicator	SPORT mode indicator	ECO mode indicator
Autonomous Emergency Braking (AEB) warning light	Lane Keep Assist System (LKAS) indicator	

Main indicators in cluster for Hybrid Vehicle

Ready indicator
When the vehicle is ready to be driven, this indicator is illuminated.
When the ready indicator goes off or blinks, we recommend the vehicle be checked by an authorized HYUNDAI dealer.

EV mode indicator
This indicator illuminates when the vehicle is driven by the electric motor.

Service warning light
If a problem with the hybrid vehicle control system occurs, the service warning light will illuminate.
We recommend the vehicle be checked by an authorized HYUNDAI dealer.

POWER GAUGE

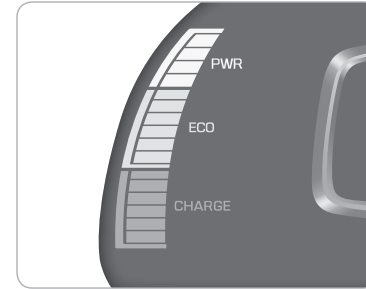

The power gauge indicates whether the current driving condition is fuel efficient or not.

CHARGE
Shows that the energy made by the vehicle is being converted to electrical energy. (Regenerated energy)

ECO
Shows that the vehicle is being driven in an Eco-friendly manner.

POWER
Shows that the vehicle is exceeding the Eco-friendly range.

HYBRID BATTERY SOC (STATE OF CHARGE) GAUGE

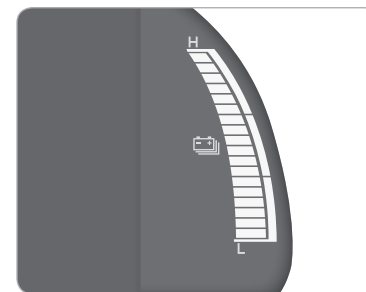

This gauge indicates the remaining hybrid battery power. If the SOC is near the "L (Low)" level, the vehicle automatically operates the engine to charge the battery.

INSTRUMENT PANEL ILLUMINATION

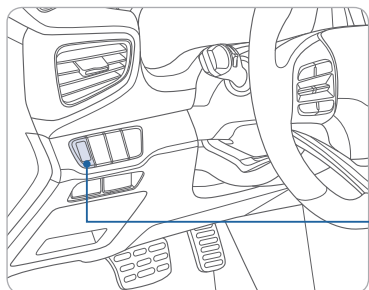

Press the illumination control button to adjust the instrument cluster illumination brightness.

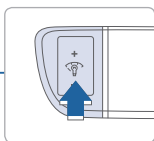

LCD DISPLAY CONTROL

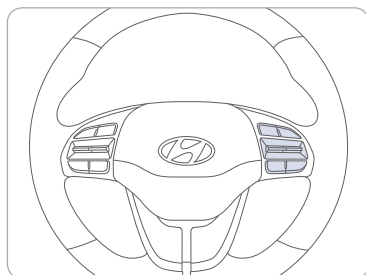

- 1 : MODE button for changing modes
- 2 : MOVE switch for changing items
- 3 **OK** : SELECT / RESET button for setting or resetting the selected item

Type A

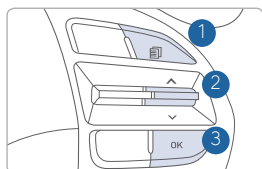

Type B

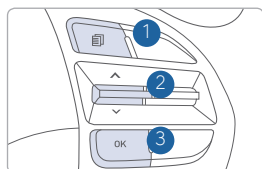

Type C

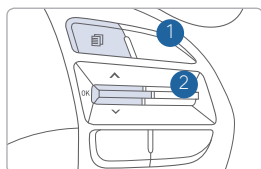

LCD DISPLAY MODES

Type A

Modes	Symbol	Description
Trip Computer		This mode displays driving information like the tripmeter, fuel economy, etc.
Turn By Turn (TBT)		This mode displays the state of the navigation.
SCC / LKAS		This mode displays the state of the Smart Cruise Control (SCC) and Lane Keep Assist System (LKAS).
A / V		This mode displays the state of the A / V (Audio / Video) system.
Information	or or	This mode displays the service interval (mileage or days) and warning messages related to the Blind Spot Detection system, etc.
User Settings		In this mode, you can change settings of the doors, lamps, etc.

Type B

Modes	Symbol	Explanation
Trip Computer		This mode displays driving information such as the tripmeter, fuel economy, etc.
Turn By Turn (TBT) (if equipped)		This mode displays the state of the navigation.
Assist		<ul style="list-style-type: none"> • This mode displays the state of the Smart Cruise Control (SCC) and Lane Departure Warning System (LDWS). • This mode displays information related to Tire Pressure.
User Settings		In this mode, you can change settings of the doors, lamps, etc.
Warning		This mode displays warning messages related to the Blind Spot Detection system, etc.

AUTOMATIC CLIMATE CONTROL

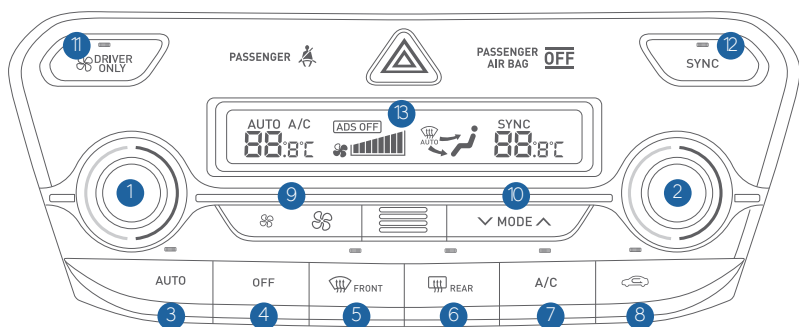

- | | |
|--|---------------------------------------|
| 1 Driver's temperature control knob | 8 Air intake control button |
| 2 Passenger's temperature control knob | 9 Fan speed control button |
| 3 AUTO (automatic control) button | 10 Mode selection button |
| 4 OFF button | 11 Driver only button |
| 5 Front windshield defrost button | 12 SYNC button |
| 6 Rear window defrost button | 13 Climate control information screen |
| 7 Air conditioning button | |

DEFOGGING/DEFROSTING



1. Press the front windshield defrost control button.



2. Set the temperature control to the warmest setting.

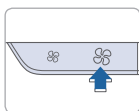

3. Set the fan speed to the highest setting.

NOTE: To reduce the tendency of the glass fogging and also to improve visibility, keep the interior surface of the windshield clean by wiping it with a clean cloth and glass cleaner. In addition, select air intake control to the outside (fresh) air position whenever possible while operating the vehicle.

AUTOMATIC HEATING / AIR CONDITIONING

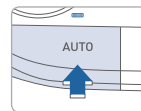

1. Press the AUTO button.



2. Set the temperature control to the desired setting.

Controls the modes, fan speeds, air intake and air-conditioning automatically.

SYSTEM OFF

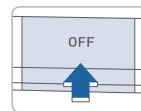

Pressing the OFF button will place the system in the OFF mode.

- Blower will turn off.
- Outside (fresh) air position will be selected.
- Vented air will be at last set temperature.

MODE SELECTION

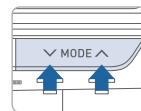

Changes the direction of the air flow as follow.



AIR INTAKE CONTROL

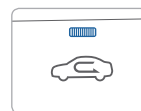

Recirculated air position



Outside (fresh) air position

SYNC BUTTON

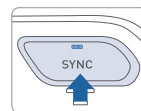

Press the SYNC button to adjust the driver and passenger side temperature and air flow direction equally.

DRIVER ONLY

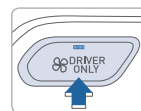

If you press the DRIVER ONLY button, cold air mostly blows in the direction of the driver's seat.

REAR WINDOW DEFROSTER

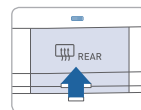

Press to activate/deactivate the rear window defroster.

BLUETOOTH® PHONE PAIRING

Phone setup (pairing phone) with Audio

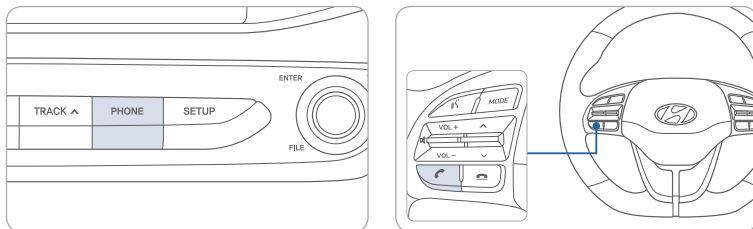

1. Press the PHONE button in the head unit or CALL button in the steering wheel remote control.

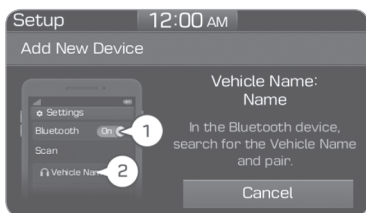

2. Search for the device name as displayed on your mobile phone and pair.

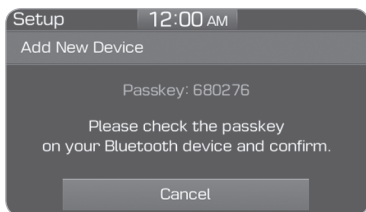

3. Confirm the 6-digit passkey displayed on the audio screen and the Bluetooth device are identical.

4. Press OK in your Bluetooth device.
5. Pairing is complete.

NOTE: Vehicle must be parked to complete pairing process.

Phone setup (pairing phone) with Navigation

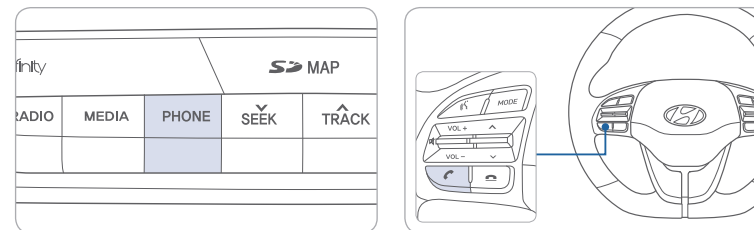

1. Press the PHONE button in the head unit or CALL button in the steering wheel remote control.
2. Pair your car after your mobile phone detects the Bluetooth device.
3. Enter the passkey or accept the authorization popup.
4. Connect Bluetooth.

NOTE: Vehicle must be parked to complete pairing process.

STEERING WHEEL AUDIO CONTROL

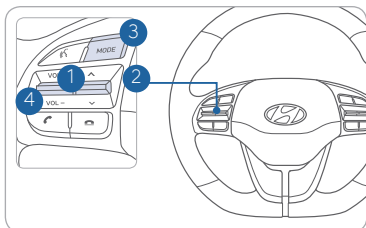

- 1 **VOLUME (VOL + / -)**
Increases or decreases the volume.
- 2 **SEEK / PRESET (▲ / ▼)**
Changes station.
- 3 **MODE**
Changes the audio source.
- 4 **MUTE (🔇)**
Mute the sound.

Bluetooth® PHONE CALL OPERATIONAL TIPS

In the following situations you or the other party may have difficulty hearing each other:

1. High level volume may result in distortion and echo. Keep the Bluetooth volume to a low level.
2. When driving on a rough road, high speeds and/or with the window open.
3. When the air conditioning vents are facing the microphone and/or when the air conditioning fan is at the max speed.

Steering wheel bluetooth® control

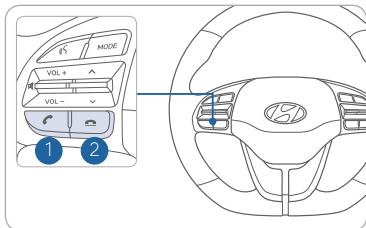

- 1 **CALL**
Places and transfers calls.
- 2 **END**
Ends calls or cancels functions.

To Answer a Call:

- Press the button on the steering wheel.

To Reject a Call:

- Press the button on the steering wheel.

To Adjust Ring Volume:

- Use the VOLUME buttons on the steering wheel.

To Transfer a Call to the Phone (Private call on handset – do not use while driving):

- Press and hold the button on the steering wheel until the audio system transfers a call to the phone.

To Finish a Call:

- Press the button on the steering wheel.

Making a call using voice recognition:

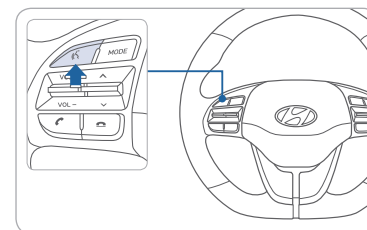

Press button on the steering wheel control to activate voice recognition.

Press and hold button to end voice recognition.

Calling by Name:

1. Press the button.
2. Say the following command:
 - “Call <John Smith>”: Connects the call to John.
 - “Call <John Smith> <on Mobile / at Work / at Home / on Other>”: Connects the call to John’s Mobile, Work, Home, or Other phone number.

Dialing by Number:

1. Press the button.
2. Say “Dial Number.”
3. Say desired phone number. For complete list of commands, refer to your Owner’s Manual.

NOTE: Android Auto and Apple CarPlay are also available.

VOICE RECOGNITION TIPS

Your vehicle is equipped with Voice Recognition technology which allows drivers to operate their phones without having to take their eyes off the road to minimize distractions.

Voice recognition performance may be affected if driving with windows and sun roof open; when the heating-cooling system is on; when passing in a tunnel or when driving on rugged and uneven roads.

Quick reference on using voice commands

To start voice command, press the  key, the following commands are available:

Command	Function
Call	Displays downloaded Contacts.
Call <Name>	Calls <Name> saved in Contacts.
Dial Number	Displays a screen where you can say a phone number to dial.
Dial <Phone #>	You can directly say the number to call. ex) Dial 1115551234
Redial	Directly calls at the number that you last dialed.

BLUE LINK TELEMATICS SYSTEM

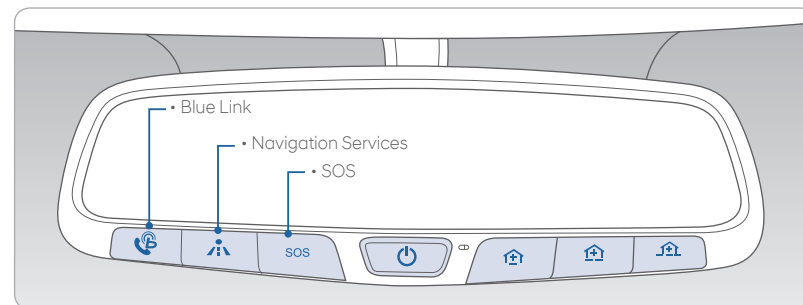

Blue Link subscription is required. To enroll, please visit your dealership or MyHyundai.com.

Press the  button to access the voice-response menu of services.

- You can say:

- Service Link
- Roadside Assistance
- Blue Link Account Services
- Help
- Cancel

For vehicles equipped with factory-installed navigation, press the  button for Destination Voice Search Powered by Google™.

Press the **SOS** button for SOS Emergency Assistance.

Visit HyundaiBlueLink.com for more information or refer to your Blue Link User's Manual for detailed information on system operation.

For immediate assistance with subscription services, please call 1-855-2BLUELINK (1-855-225-8354).

Google™ is a registered trademark of Google, Inc.

MyHyundai with Blue Link App



You can download the MyHyundai with Blue Link app to your compatible smart phone from the following sites:

- iPhone® — Apple® App Store
- Android™ — Google Play™

Visit HyundaiBlueLink.com FAQs to see a list of compatible devices.



Scan to see list of compatible devices and to download the app.

Remote Start with Climate Control

Remote Start with Climate Control* enables you to remotely enable climate control and turn on the front window defroster, ensuring a warm or cool car is ready to go when you are.

- To use this feature, you must have a Blue Link Personal Identification Number (PIN). To create or change your PIN, log in to www.MyHyundai.com.

Remember:

- Remote Start will automatically shut off after 10 minutes or after selected engine timer runs out.
- To continue to operate the vehicle, the proximity key must be inside the vehicle with the driver, prior to pressing the brake and being able to move the gearshift from the P (Park) position.

NOTE: Remote Start with Climate Control is not available on all models. Remote Start with Climate Control is only available for Push Start equipped vehicle with an Automatic Transmission. Remote Start with Climate Control additionally requires Fully Automatic Temperature Control.

Preconditions:

- Ignition is OFF
- Alarm is armed (i.e., vehicle locked by key fob Remote Door Lock)
- Gearshift level is in the P (Park) position
- Brake pedal is not depressed
- Engine hood is securely closed
- All the doors are closed and locked
- The tailgate or trunk lid is closed
- The security / panic system is not activated
- The proximity key is not inside the vehicle
- The battery power is not low
- Vehicle is located in an open area
- It has been less than 4 days since last vehicle ignition off
- Vehicle located in area with good cell reception

Remote Start with Climate Control will terminate:

- After 10 minutes or after selected engine timer runs out
- Brake is pressed without the proximity key inside the vehicle
- Alarm is triggered without the proximity key inside the vehicle
- Door / trunk is opened from inside the vehicle

Notice: Laws in some communities may restrict the use of the features that remotely start the engine. For example, some laws may require a person using the remote start feature to have the vehicle in view when doing so, or limit the length of time a vehicle engine may idle. Please check local and state regulations for any requirements and restrictions on remote starting of vehicles and engine idling time.

WARNING!

Do not remote start vehicle in an enclosed environment (i.e., closed garage). Prolonged operation of a motor vehicle in an enclosed environment can cause a harmful build-up of carbon monoxide. Carbon monoxide is harmful to your health. Exposure to high levels of carbon monoxide can cause headaches, dizziness or in extreme cases unconsciousness and/or death. Do not leave children or animals unattended in a vehicle while using the remote start function.

CAUTION!

If the vehicle's windshield wipers are left on when the vehicle was last driven, then the wipers will turn on if the remote start function is activated. To avoid damage to the wiper blades (i.e., due to heavy ice or snow accumulated on the windshield), please always turn the vehicle's windshield wipers off when parking the vehicle.

CLOCK ADJUSTMENT

With Audio

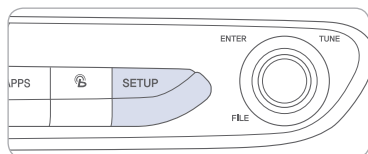

1. Press the SETUP button on the audio head unit.
2. Select Date/Time.
3. Select the desired items.

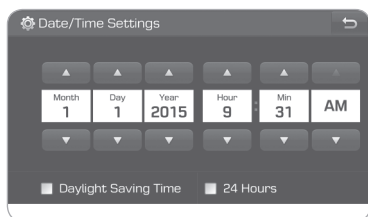

Date/Time

Tap the up/down arrows to increase/decrease the values in the screen.

24 Hours

The time display is set in 24-hour format.

Daylight Saving Time

The daylight saving time(DST) is applied.

With Navigation

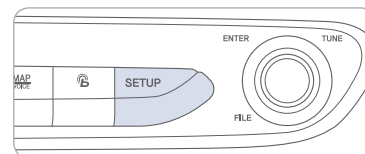

1. Press the SETUP button on the navigation head unit.
2. Select Clock.
3. Select the desired items.

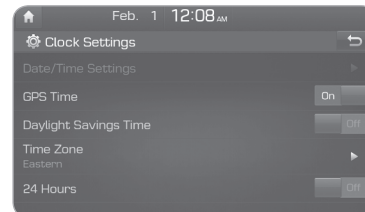

GPS time

Displays time according to the received GNSS(Global Navigation Satellite System) time.

Daylight Saving Time

The daylight saving time(DST) is applied.

24 Hours

The time display is set in 24-hour format.

RADIO MODE

Display Audio

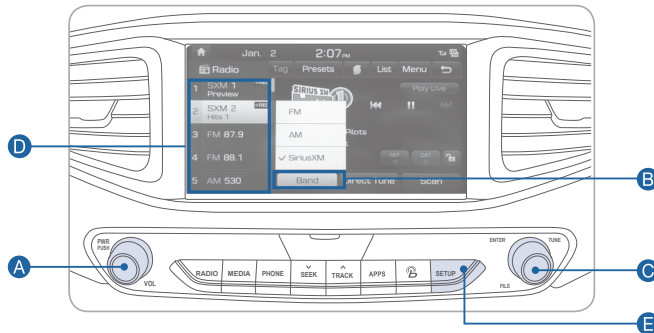

Press POWER button **A** to turn radio on.

- TUNING/LISTENING TO CHANNELS

1. Press BAND button **B** on screen to select FM/AM/SiriusXM®.
2. ROTATE TUNE knob **C** to desired channel.

NOTE A clear view of the southern sky helps ensure SiriusXM® radio reception.

- SETTING PRESET MEMORY BUTTONS

Press and hold any preset button **D** on the screen until an audible beep is heard to store current channel.

- ADJUSTING THE SOUND CONTROL

1. Press the SETUP button **E** and press the SOUND button on screen to display the Sound Settings screen.
2. Touch on-screen arrows to adjust desired setting.



Navigation

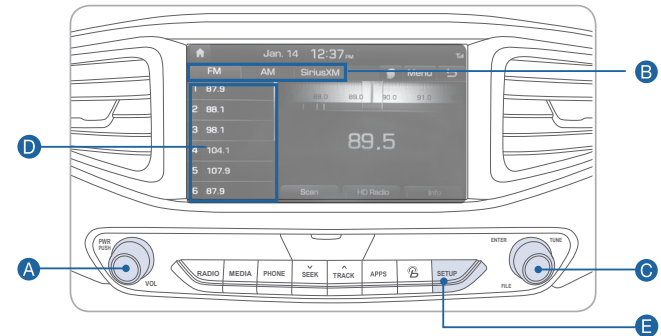

Press POWER button **A** to turn radio on.

- TUNING/LISTENING TO CHANNELS

1. Press BAND button **B** on screen to select FM/AM/SiriusXM®.
2. ROTATE TUNE knob **C** to desired channel.

NOTE A clear view of the southern sky helps ensure SiriusXM® radio reception.

- SETTING PRESET MEMORY BUTTONS

Press and hold any preset button **D** on the screen until an audible beep is heard to store current channel.

- ADJUSTING THE SOUND CONTROL

1. Press the SETUP button **E** and press the SOUND button on screen to display the Sound Settings screen.
2. Touch on-screen arrows to adjust desired setting.



NAVIGATION

Basic features on map screen



- 1 Place button : Go to the Place menu.
- 2 Home button : Go to the Home screen.
- 3 Map button : Change the map view mode.
- 4 NAV volume button : Adjusts the volume.
- 5 Zoom in button : Zoom the map view screen in.
- 6 Map scale display : Set the zoom level automatically according to the guidance.
- 7 Zoom out button : Zoom the map view screen out.
- 8 Quick menu button : Quick and easy selection of a destination and options.
- 9 NAV button : Enter the navigation menu screen.
- 10 Map scroll mark : Touch to scroll the map.
- 11 Destination button : Quick and easy selection of a destination from the map screen.
- 12 Waypoint button : Set a waypoint to the current route.
- 13 Save button : Save frequently used address to address book.
- 14 POI button : Find a POI(Point Of Interest) around the current position.
- 15 Vehicle position mark : View the vehicle's current position on the map screen.

Destination search screen



Press [NAV] on the map screen and, finds a destination by using the [Destination] menu.

- 1 Address : Set destination by address search.
- 2 Previous destinations : Select from previously inputted addresses and POIs.
- 3 Local search : Runs Google Local Search.
- 4 POI categories : Select the desired item in the sub-categories.
- 5 Charging stations : Select the desired destinations among the searched charging stations.
- 6 Restaurants : Select the desired destination among the searched restaurants.
- 7 Emergency : Select the desired destination among the searched emergency facilities.
- 8 Address Book : Search the destination with the address book.
- 9 Phone Number : Search the destination by phone number.
- 10 Freeway Exit/Entrance : Type freeway name and exit/entrance to search by freeway exit/entrance.
- 11 Intersection : Type 1st Street name, the State, 2nd Street name.
- 12 Coordinates : You can find a destination by entering the coordinates of latitude and longitude.

AUX, USB AND iPod® PORT

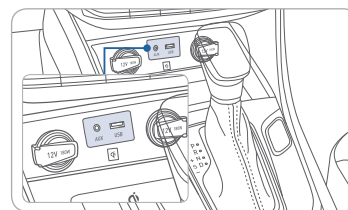

Use the input jack to connect an external audio device and listen to it through the audio system in your vehicle.

iPod® is a trademark of Apple, Inc.

TIRE PRESSURE MONITORING SYSTEM (TPMS)

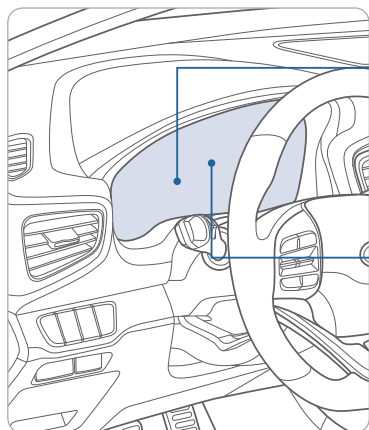

Low Tire Pressure Indicator / TPMS Malfunction Indicator



Low Tire Pressure / Tire Pressure Monitor / TPMS Malfunction Display (shown on the cluster LCD display)

LOW TIRE PRESSURE INDICATOR

Illuminates if one or more tires are significantly under-inflated.

TPMS MALFUNCTION INDICATOR

Blinks for approximately one minute, then remains illuminated when there is a malfunction with the TPMS. Inspect all tires and adjust the tire pressure to specification. If the lamp remains illuminated, we recommend the vehicle be checked by an authorized HYUNDAI dealer.

LOW TIRE PRESSURE / TIRE PRESSURE MONITOR / TPMS MALFUNCTION DISPLAY(LCD DISPLAY)

Tire pressures will display after driving a short distance. If a tire pressure drops lower than predetermined specification, the Low Tire Pressure Indicator (🚗) will illuminate and the LCD display will indicate Tire(s) requiring air.

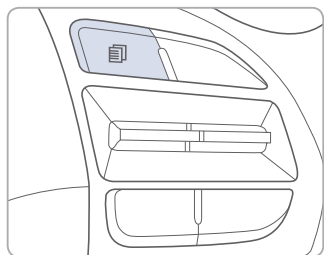

- * To check the tire pressure
- 1. Press the Mode button on the steering wheel.
- 2. Go to the 'Information' mode (cluster type A) or 'Assist' mode (cluster type B) on the LCD display.
- 3. The tire pressure will be displayed after the vehicle is driven for 3 to 5 minutes.

DUAL CLUTCH TRANSMISSION

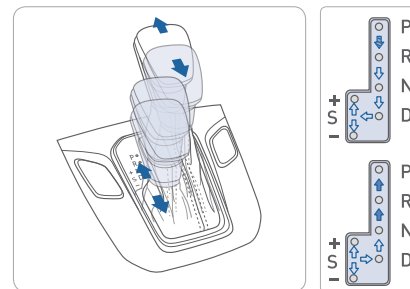

(🚗) : Depress the brake pedal and press the shift button while moving the shift lever.

(➡) : Press the shift button while moving the shift lever.

(👉) : The shift lever can freely operate.

Manual shift mode

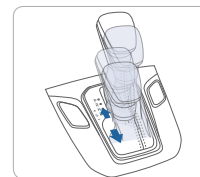

Shift the lever from D into the manual gate to activate manual shift mode. Manual shift mode is a recalibrated automatic mode that will hold gears longer and downshift at higher RPM for a more dynamic driving style.

ECO/SPORT mode

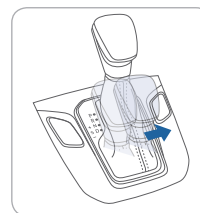

ECO mode

If you drive the vehicle with the shift lever in D (Drive), the vehicle will automatically change to ECO mode. The ECO indicator will illuminate on the instrument cluster. When driving in ECO mode, the vehicle improves fuel efficiency for eco-friendly driving.

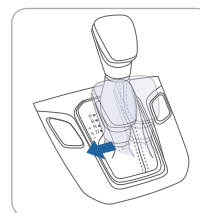

SPORT mode

If you drive the vehicle with the shift lever in S (Sport), the vehicle will automatically change to SPORT mode. The SPORT indicator will illuminate on the instrument cluster. Sport mode provides a sporty feel and may have heavier steering effort. In Sport mode, the fuel efficiency may decrease.

NOTE: Dual Clutch Transmission characteristics

The new technology of the Dual Clutch Transmission is different from a traditional automatic or manual transmission:

- The Dual Clutch Transmission is an automatically shifting manual transmission.
- Dual Clutch Transmission utilizes two clutches connected to a computer-controlled manual gearbox. It provides the convenience of a transmission that shifts automatically, with the efficiency of a manual transmission.
- When you turn the engine on and off, you may hear clicking sounds as the system goes through a self test. This is a normal sound for the Dual Clutch Transmission.
- When you stop on a hill, if you remove your foot from the brake pedal, the vehicle will remain stationary for approximately two seconds to help prevent the vehicle from rolling backwards. If you depress the accelerator pedal during the two second interval, the vehicle will accelerate. If you wait more than two seconds, the vehicle will enter creep mode and may roll backwards if the hill is steep.

Caution

- You should always use the foot brake to hold the car on a hill until you are ready to drive. Using creep mode to hold the car on a hill may damage the clutch.
- If the clutch becomes overheated by excessive use of the clutch to hold on a hill, you may notice a shudder feeling and a blinking display on the instrument cluster. When this occurs, the clutch is disabled until the clutch cools to normal temperatures. If this occurs, pull over to a safe location, shift into P (Park) and apply the foot brake for a few minutes.

PADDLE SHIFTER

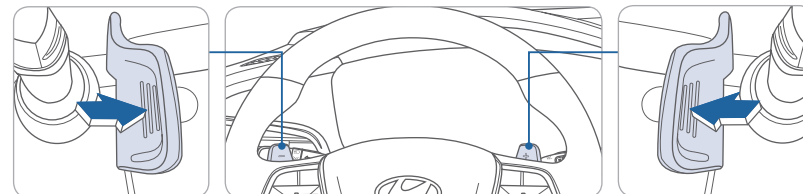

Press (-) to downshift

The Paddle shifter is available when the shift lever is in the D (Drive) position or Shiftronic mode.

Press (+) to upshift

Press the [+] or [-] paddle shifter once to shift up or down one gear.

VIRTUAL ENGINE SOUND SYSTEM (VESS)

The Virtual Engine Sound System generates engine sound for pedestrians to hear vehicle sound because there is limited sound while motor power is used.

ELECTRONIC STABILITY CONTROL (ESC)

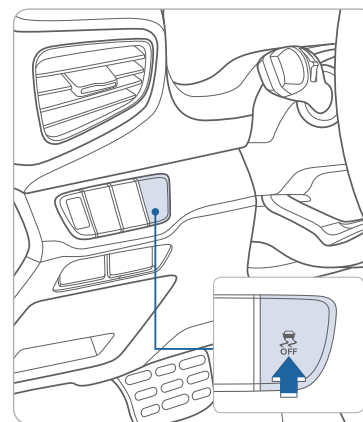

The ESC system is an electronic system designed to help the driver maintain vehicle control under adverse conditions.

ESC automatically selects the ON position when the engine is started.

To turn off Traction Control
Press the ESC OFF button shortly.

To turn off Traction & Stability Control
Press the ESC OFF button for more than 3 seconds.

LANE KEEPING ASSIST SYSTEM (LKAS)

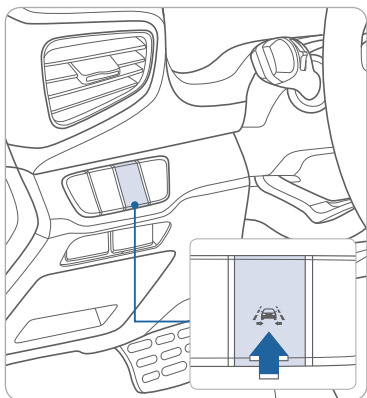

The Lane Keeping Assist System detects lane markers on the road with a camera and assists the driver's steering to help keep the vehicle between lanes. The system operates when the vehicle speed is between 40 mph and 110 mph

- To turn on the LKAS, press the LKAS switch
- To turn off the LKAS, press the switch again.

NOTE: In some circumstances, LKAS may not activate as intended. ex: blurred lane condition, backlight, heavy fog, reflection of light due to water on the road, sharp bend in the road, etc. Please refer to the Owner's Manual for more information.

BLIND SPOT DETECTION SYSTEM (BSD)

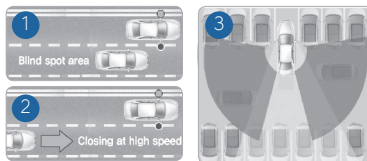

The BSD (Blind Spot Detection) system uses a radar sensor to alert the driver while driving. It monitors the rear area of the vehicle and provides information to the driver.

- 1 Blind Spot Detection
 - 2 Lane Change Assist
 - 3 Rear Cross Traffic Alert
- To turn on the BSD, press the BSD button (indicator illuminated).
 - To turn off the BSD, press the BSD button again.

The system will activate if vehicle speed exceeds 20 mph.

Rear Cross Traffic Alert

When the vehicle is in R (Reverse), the system provides an alert if a vehicle is approaching from the sides.

REAR VIEW CAMERA

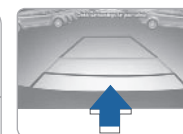
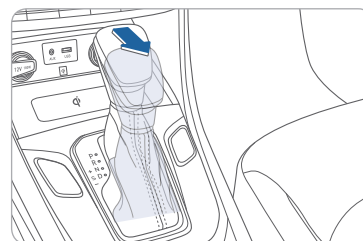

When the shift lever is moved to R(Reverse), the rear view camera displays the area behind the vehicle.

AUTONOMOUS EMERGENCY BRAKING (AEB)

Type A

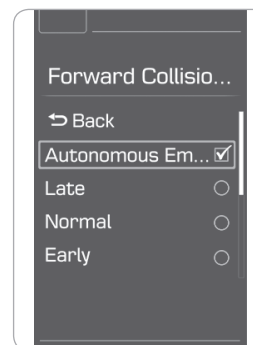

The Autonomous Emergency Braking (AEB) system is designed to detect and monitor the vehicle ahead or detect a pedestrian in the roadway through radar signals and camera recognition to warn the driver that a collision is imminent, and if necessary, apply emergency braking.

To activate the system,

Cluster type A

Select "User Settings → Driving Assist → Forward Collision Warning → Autonomous Emergency Braking"

Type B

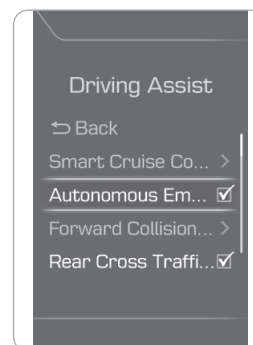

Cluster type B

Select "User Settings → Driving Assist → Autonomous Emergency Braking" The system deactivates, when the system setting is cancelled.

CRUISE CONTROL / SMART CRUISE CONTROL

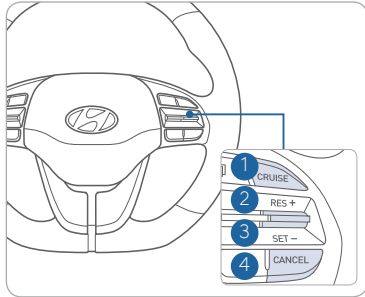

The Cruise Control system allows you to program the vehicle to maintain a constant speed without depressing the accelerator pedal.

- 1 To turn On/Off cruise control.
- 2 Toggle switch UP to Resume or Increase the cruise control speed.
- 3 Toggle switch DOWN to Set or Decrease the cruise control speed.
- 4 To Cancel the Cruise Control.

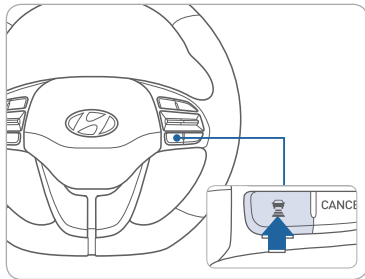

Setting Vehicle Distance (Smart Cruise Control only)

Press the button to set and maintain the vehicle-to-vehicle distance without pressing the accelerator or brake pedal. The vehicle-to-vehicle distance will automatically activate when you set the cruise speed. Each time the button is pressed, the vehicle-to-vehicle distance changes as follows:

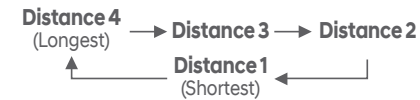
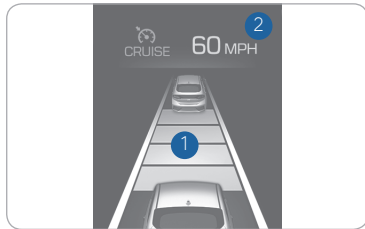

Setting Cruise Control

1. Press the “CRUISE” button 1 to turn on Cruise Control. The icon will illuminate in the instrument cluster.
2. Toggle “-SET” switch (3) DOWN to set cruising speed.

Adjusting the vehicle speed

1. Toggle “+RES” switch 2 UP to increase cruising speed.
2. Toggle “-SET” switch 3 DOWN to decrease cruising speed.

Note Quick toggle up/down will change speed by 1 mph. Holding switch up/down will change speed by 10 mph.

To Cancel Cruise Control

Press the “CANCEL” button 4 or depress the brake pedal.

HYBRID DRIVING TIPS

The following tips may help benefit you to maximizing fuel economy and experience Hybrid vehicle driving.

Common practice:

- Maintain tire pressure
- Roll windows up when driving
- Properly maintain your vehicle
- Turn A/C off



Set headlight switch to AUTO or OFF when not in use. This will help preserve vehicle battery charge.



Use the DRIVER ONLY button with no front passenger. This will help reduce energy consumption.



Try to drive in an eco-friendly manner and maintain EV Mode indicator to illuminate as much as possible.

Driving suggestions to improve fuel economy:

- Drive smoothly.
- Accelerate at a moderate rate.
- Try to maintain your speed with traffic to prevent unnecessary speed adjustments.
- Always maintain a safe driving distance from the vehicle in front of you so you can avoid unnecessary braking.

IONIQ CUSTOMER DELIVERY CHECKLIST

CUSTOMER NAME	DEALERSHIP NAME
SALES CONSULTANT	DATE
VIN	

BEFORE DELIVERY

- SET TIRE PRESSURE LF__RF__RR__LR__
- VERIFY VEHICLE IS CLEAN, IN GOOD CONDITION, FREE OF CHIPS AND SCRATCHES · CLEAN WINDSHIELD AND BACK WINDOW
- ENSURE FLOOR MATS ARE SNAPPED INTO PLACE

Sales Consultant _____ Date _____ Sales Manager _____ Date _____

Customer _____ Date _____

Email _____