

WALK THE CUSTOMER THROUGH EACH OF THE FOLLOWING KEY DELIVERY FEATURES

How to Defrost - page 22- 24

- 1 Press the front defrost button.
- 2 Set to warmest temperature setting.
- 3 Set to highest fan speed.

Tire Pressure Monitoring system (TPMS) - page 41



LOW TIRE PRESSURE INDICATOR / TPMS MALFUNCTION INDICATOR

NOTE: Tire pressure may vary in colder temperatures causing the low tire pressure indicator to illuminate. Inflate tires according to the Tire Pressure Label located on the driver's side door pillar.

Windshield Wiper / Washer - page 09

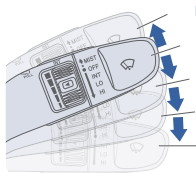

- MIST** • To activate wipers move the switch down to one of the three positions (INT, LO, HI)
- OFF** • To adjust "INT" speed move switch
- INT** • To adjust "INT" speed move switch
- LO** • To spray washer fluid pull lever toward you
- HI** • Push lever up for a single wiper pass

Unlocking vehicle - page 02

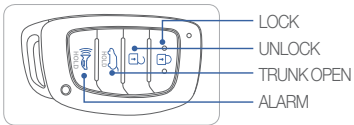

BLUE LINK – page 28-30

- Assist with creating MyHyundai.com account
- Assist with Blue Link enrollment
- Show Blue Link Users Manual & tear out Voice Commands/Quick Tip Card
- Encourage customers to press the Blue link button

MAINTENANCE

Scheduled Maintenance	Normal Usage	Severe Usage*
Engine Oil and Filter	Replace 7,500 or 12 mos.	Replace 3,750 or 6 mos.
Fuel Additive	Add 7,500 or 12 mos.	Inspect Same as Normal
Tire Rotation	Perform 7,500	Perform 7,500
Air Cleaner Filter	Inspect 7,500 Replace 30,000	Inspect Same As Normal Replace More Frequently
Vacuum Hose	Inspect 7,500	Inspect Same As Normal
Climate Control Air Filter (for Evaporator and Blower Unit)	Replace 15,000	Replace More Frequently
Air Conditioning Refrigerant	Inspect 15,000	Inspect Same As Normal
Brake Hoses & Lines	Inspect 15,000	Inspect Same As Normal
Drive Shafts & Boots	Inspect 15,000	Inspect 7,500
Exhaust Pipe & Muffler	Inspect 15,000	Inspect Same As Normal
Front Disc Brake/Pads, Callipers & Rotors	Inspect 15,000	Inspect More Frequently
Steering Gear Box, Linkage & Boots/ Lower Arm Ball Joint, Upper Arm Ball Joint	Inspect 15,000	Inspect More Frequently
Suspension Mounting Bolts	Inspect 15,000	Inspect Same As Normal
Brake fluid	Inspect 30,000	Inspect Same As Normal
Crankcase Ventilation Hose	Inspect 30,000	Inspect Same As Normal
Fuel Filter	Inspect 30,000	Inspect Same As Normal
Fuel Lines, Fuel Hoses and Connections	Inspect 30,000	Inspect Same As Normal
Fuel Tank Air Filter	Inspect 30,000	Inspect Same As Normal
Rear Disc Brake/Pads, Parking Brake	Inspect 30,000	Replace More Frequently
Vapor Hose, Fuel Tank & Fuel Filler Cap	Inspect 30,000	Replace Same As Normal
Valve Clearance	Inspect 60,000	Inspect Same As Normal
Spark Plugs	Replace 105,000	Replace More Frequently
Coolant	1st Replace 120,000 or 120 mos. Add'l Replace 30,000 or 24 mos.	Replace Same As Normal
Automatic Transmission Fluid	No check, No service required	Replace 60,000

*See Owner's Manual for details.

Looking For more detailed information? This Quick Reference Guide does not replace your vehicle's Owner's Manual. If you require additional information or are unsure of a specific issue, We recommend that you always refer to the vehicle's Owner's Manual or contact your authorized Hyundai dealer. The information contained in this Quick Reference Guide is correct at the time of printing; however, specifications and equipment can change without notice. No warranty or guarantee is being extended in this Quick Reference Guide, and Hyundai reserves the right to change product specifications and equipment at any time without incurring obligations. Some vehicles are shown with optional equipment.

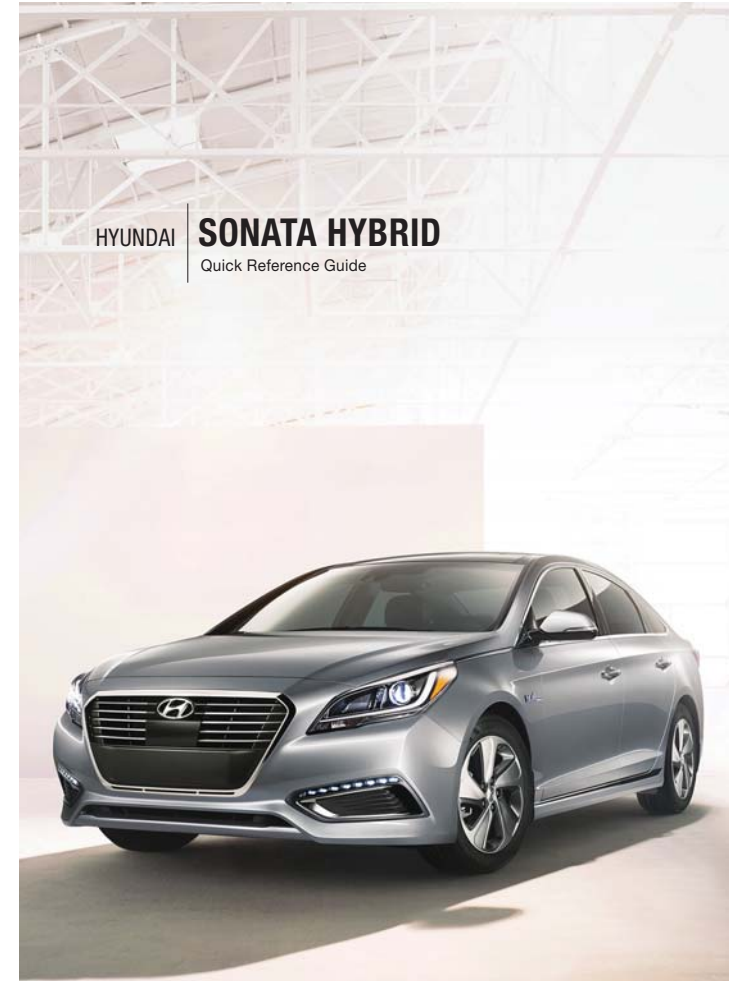

HYUNDAI | **SONATA HYBRID**
Quick Reference Guide

www.hyundai.com

HYUNDAI
NEW THINKING.
NEW POSSIBILITIES.

Roadside Assistance: **1-800-243-7766**
Consumer Affairs: **1-800-633-5151**
SiriusXM® Radio: **1-800-967-2346**
Blue Link: **1-855-2BLUELINK**
(1-855-225-8354)

NP150-S2017
(Rev 07/29/16)
Printing 08/01/16

Table of contents

GETTING STARTED

Driver position memory system	05
Engine start / stop button	05
Front seat adjustment	03
Headrest adjustment	04
Seat belt adjustment	04
Smart key	02

FEATURES AND CONTROLS

Air ventilation seats	14
Child - protector rear door lock	12
Climate control	22-23
Clock Adjustment	15
Driver's main controls	07
Fuel filler lid	07
Headlights	08
Heated steering wheel	06
Homelink wireless control system	13
Hybrid system modes	21
Instrument cluster	16-17
Instrument panel illumination	19-20
Interior lights	10
Rearview camera	15
Rear parking assist system	15
Rear seat folding	12
Seat warmer /cooling	14
Smart trunk	11
Steering wheel adjustment	06
Sunroof	10
Trunk opening	11
Wipers and washer	09

MULTIMEDIA

Blue Link Telematics system	27-29
Bluetooth operational tips	24
Bluetooth phone operation	26
Bluetooth phone pairing	26
Navigation	31-33
Steering wheel audio control	24

DRIVING

Android Auto	34-35
Apple carplay™	36-39
AUX, USB and iPod port	33
Auto Hold	40
Automatic transmission	42
Blind Spot Detection (BSD) system	43
Cruise control	45
Drive mode integrated control system	44
Electric Parking Brake [EPB]	40
Electronic Stability Control (ESC)	42
Hybrid driving tips	46
Lane Departure Warning System (LDWS)	43
Tire Pressure Monitoring System (TPMS)	41

* Some vehicles may not be equipped with all the listed features.

Frequently Asked Questions

- Pair phone to your vehicle. Refer to page 26.



Driver position memory system
Page05

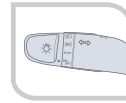

Head lights
Page08



Instrument cluster
Page16-17

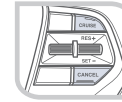

Cruise control
Page45



Engine start/stop button
Page05



Navigation
Page31-32

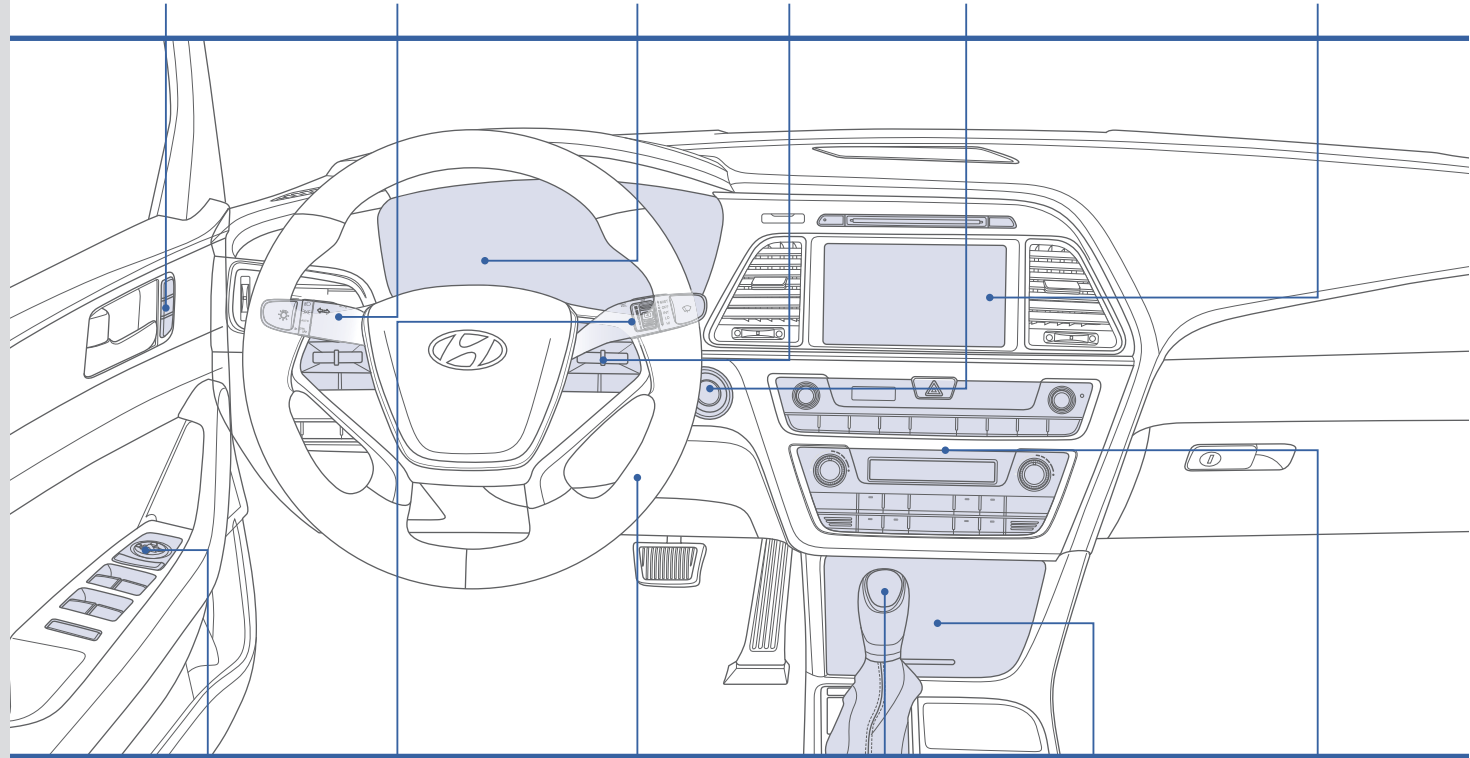

Driver's main controls
Page07



Wiper and washer
Page09



Steering wheel adjustment
Page06



Transmission
Page42



AUX,USB and iPod
Page33



Climate control
Page22-24

Use this Quick Reference Guide to learn about the features that will enhance your enjoyment of your Hyundai. More detailed information about these features are available in your Owner's Manual.

WARNING!

To reduce the risk of serious injury to yourself and others, read and understand the important SAFETY INFORMATION in your Owner's Manual.

GETTING STARTED

SMART KEY

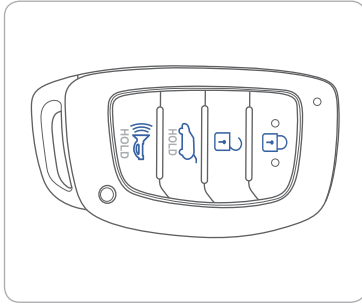

- Lock
- Unlock
- Trunk open
- Panic

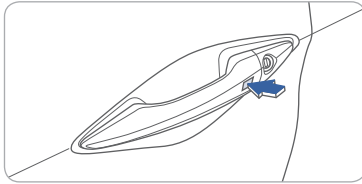

Driver's door Lock / Unlock
 Smart key must be within 28~40 in. from the outside door handle.
Press: Once – Unlock driver door
 Twice – Unlock all doors
 Third – Lock all doors

NOTE:
 Driver's door lock/unlock settings can be changed through the User Settings mode in the instrument cluster display. See Owner's Manual for more detail.

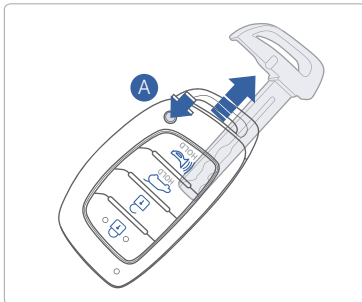

Remove mechanical key.
 Press and hold the release button **A** to remove the mechanical key

FRONT SEAT ADJUSTMENT (Manual)



Forward and backward **1**



Seat cushion height **2**

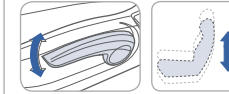

Seatback angle **3**



FRONT SEAT ADJUSTMENT (Power)

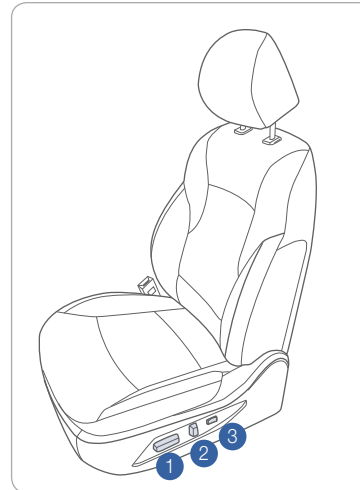

Forward and backward **1**

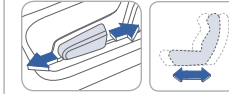

Seat cushion height

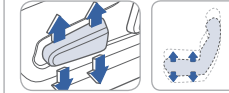

Seatback angle **2**

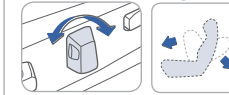

Lumbar support (for driver's seat) **3**

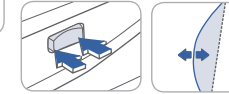

HEADREST ADJUSTMENT

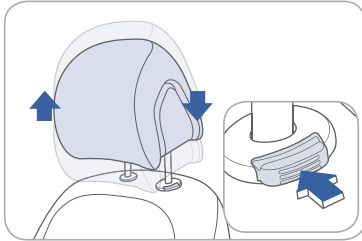

To Raise Headrest:
Pull headrest up.

To Lower Headrest:
Press lock button while pressing down on headrest.

ENGINE START/STOP BUTTON

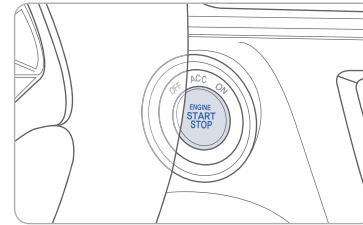

With the ignition OFF and foot OFF of brake pedal, press the Engine Start/Stop button.

- Once for ACC (Accessory) mode.
- Twice for ON mode.
- Three times for OFF.

To start the engine in any mode (including OFF), press the Engine Start/Stop button while pressing the brake pedal.

To shut the engine OFF, place shift lever in P (Park) and press the Engine Start/Stop button again.

Emergency situations

Shut off engine while driving

Press engine start/stop button for more than 2 seconds or 3 times consecutively within 3 seconds.

Restart engine while driving

Press engine start/stop button with shift lever in N (Neutral).

SEAT BELT ADJUSTMENT (Front seat)

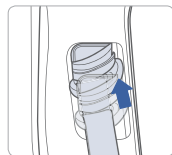
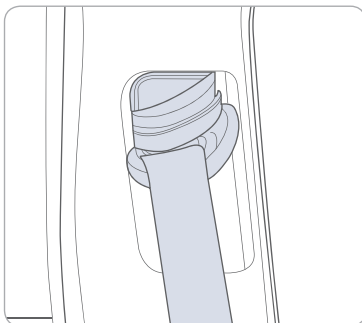

Pull up to raise.

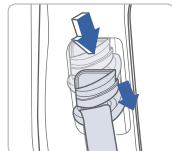

Press button and push down to lower.

DRIVER POSITION MEMORY SYSTEM

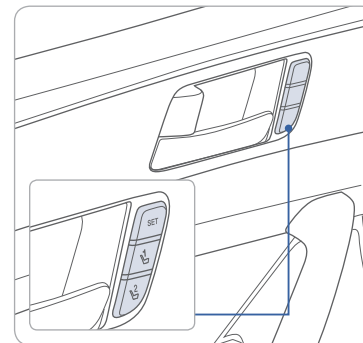

Storing

1. Adjust the driver's seat position, outside rearview mirror position and instrument panel illumination intensity.
2. Press the SET button. The system will beep once.
3. Press one of the memory buttons (1 or 2) within 5 seconds. The system will beep twice.

NOTE: Transmission must be in P (Park).

Recalling

Press the desired memory button (1 or 2). The system will beep once.

STEERING WHEEL ADJUSTMENTS

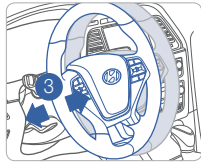
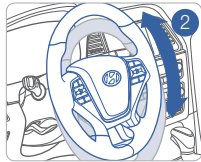
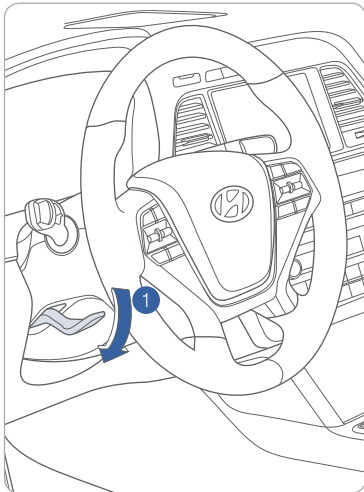

NOTE: Do not adjust while driving.

1. Pull the lever ① down.
2. Set the angle ② and distance ③.
3. Pull the lever ① up to lock position.

HEATED STEERING WHEEL

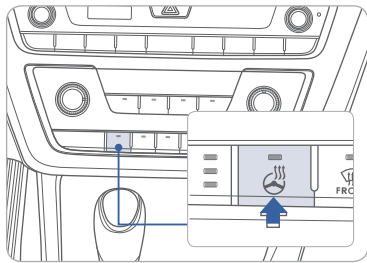

Pressing the heated steering wheel button warms the steering wheel. The indicator on the button is illuminated.

Press the button again to turn it off.

FUEL FILLER LID

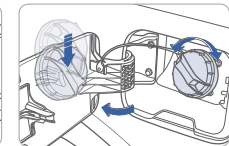
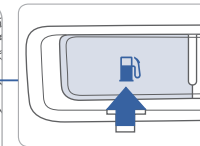
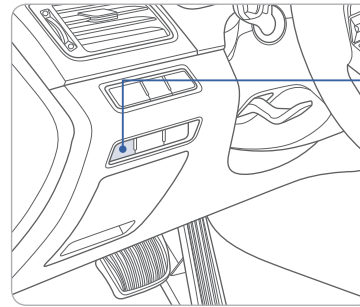

NOTE:

Tighten the fuel filler cap until one click is heard.

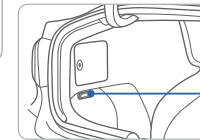

Emergency fuel filler door release

Pull the handle of the release located on the left side of the luggage compartment

Check the engine oil regularly between recommended oil changes.

DRIVER'S MAIN CONTROLS

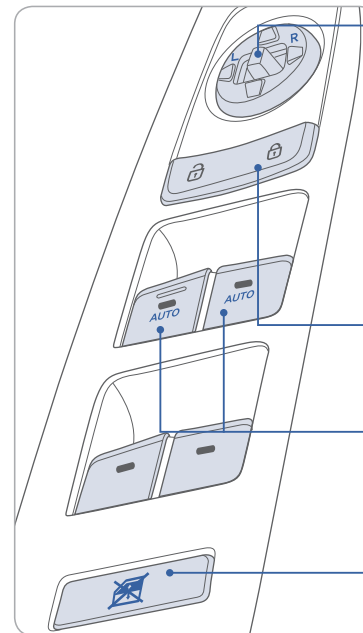

Outside Rearview Mirror

- Move the lever towards L (left) or R (right) on the switch. Then adjust the mirror by using the mirror adjustment control switch.

NOTE:

When in reverse, the Outside Rearview Mirrors will automatically fold down when the levers are in the L or R position.

Door Lock

Locks/unlocks all doors.

Window Auto down/up (if equipped)

Press past detent to fully open/close window.

Power window lock button

Disables the power window switches on the rear passenger doors.

FEATURES AND CONTROLS

HEADLIGHTS

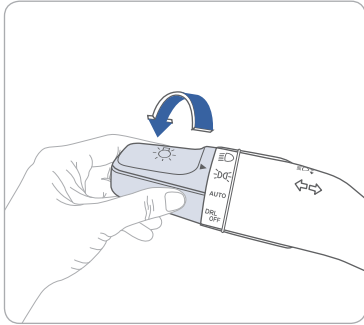

- Headlight position
- Parking light position
- Auto light position
- DRL OFF position



Headlight Delay

Headlights may stay on for 15 seconds after exiting and locking vehicle. Press remote lock button twice to turn headlights off.

NOTE: Headlight Delay settings can be changed through User Settings mode in the instrument cluster display. See Owner's Manual for more detail.

Turn signals and lane change signals

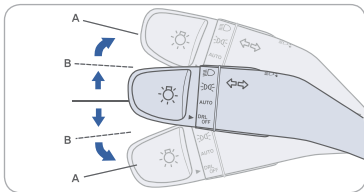

Flashing headlights

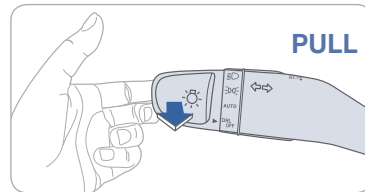

High beam

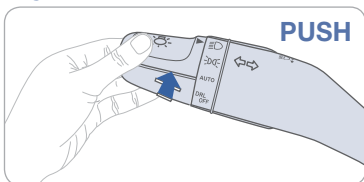

Smart high beam

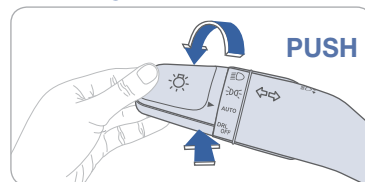

NOTE:

To turn off high beam, pull the lever towards you.

Smart High Beam Function

1. Select auto position on stalk.
 2. Push lever forward to engage Auto High beam.
 3. Push lever forward again to disengage.
- See Owner's Manual for more details.

WIPERS AND WASHER

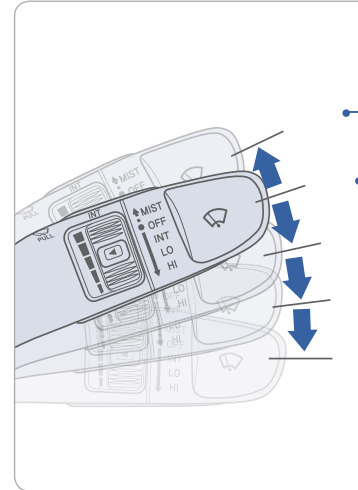

- MIST - Single wipe
- OFF
- INT - Intermittent wipe
- LO - Low wiper speed
- HI - High wiper speed



Intermittent Wipe Time Adjustment

Move the control switch.

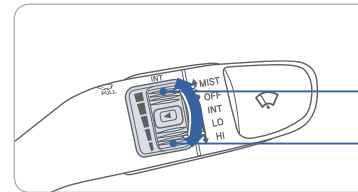

- Fast wiper speed
- Slow wiper speed

Windshield Washer

Pull the lever gently toward you to spray washer fluid on the windshield and to run the wipers 1-3 cycles.

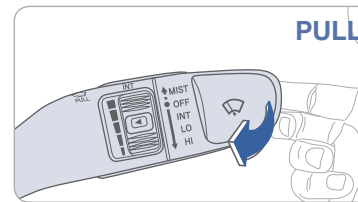

SUNROOF

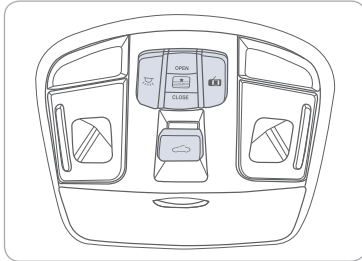

Sunshade



Press Rear Button to open Sunshade. Press Forward Button to close Sunshade (This operation will also close Sunroof if open or vented position.)

Sliding the sunroof

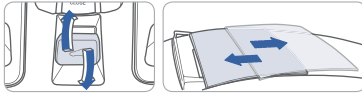

Slide the Sunroof Button rearward to open sunroof. (This operation will also open the Sunshade, if it is not in the open position.) Slide the Sunroof Button forward to close the Sunroof.

Tilting the sunroof

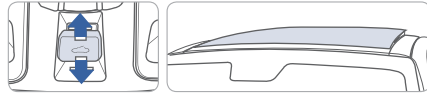

Press the Sunroof Button to tilt the Sunroof to the vented position. (This operation will also open the Sunshade, if it is not in the open position.) Pull the Sunroof Button downward to close the Sunroof.

INTERIOR LIGHTS

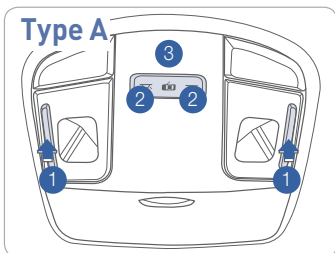

Front Map Lamp ①

Push the switch to turn the map lamp on or off.

Front Room Lamp (☀️) ② (Type A)

Push the switch to turn the room lamp (overhead lamp) on or off.

Front Room Lamp (☀️) ② (Type B)

Push the switch to turn the room lamp (overhead lamp) on or off.

Front Door Lamp (🚪) ③

Lights will turn on when any door is open.

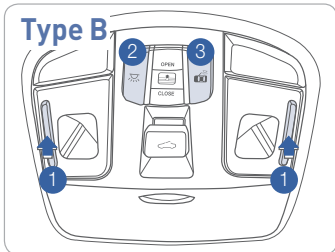

TRUNK OPENING

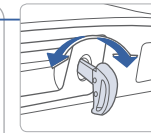
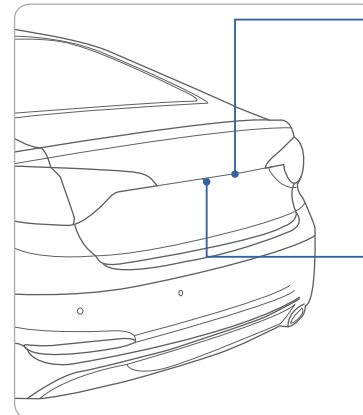

Use the mechanical key.

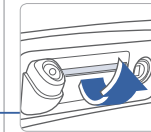

Press to open. Smart key needs to be within range.

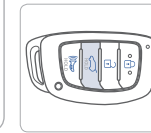

Press and hold.

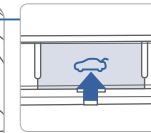
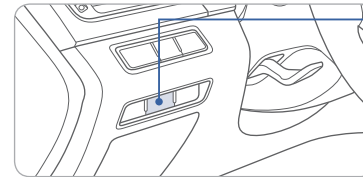

Press the release button in the vehicle.

SMART TRUNK

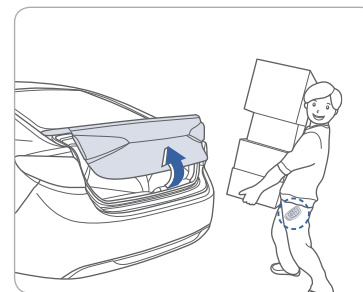

Smart Trunk

Trunk will open automatically when detecting smart key within range near the trunk for more than 3 seconds.

To disable Smart Trunk function:

- Vehicle must be in P (Park) to adjust settings in the User Setting mode.
1. Select "Door/Trunk" in the User Settings in the instrument cluster.
 2. Uncheck "Smart Trunk".

NOTE:

Function is active after 15 seconds when all doors are closed and locked. The vehicle will also provide an audible and visual alarm while activating. For more details, refer to Owner's Manual.

CHILD-PROTECTOR REAR DOOR LOCK

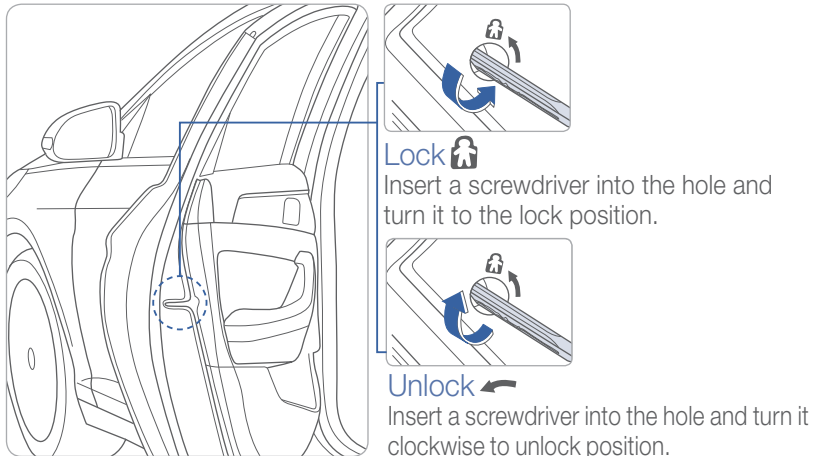

REAR SEAT FOLDING

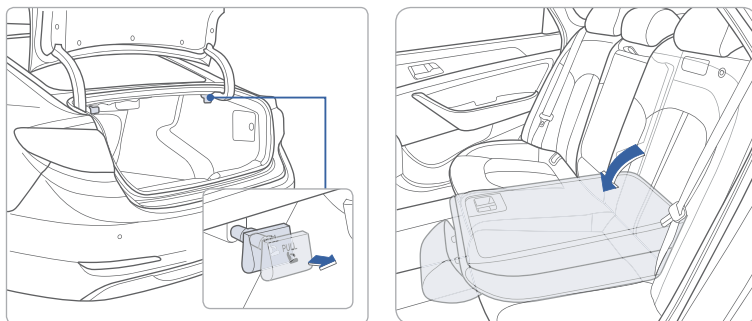

HOMELINK WIRELESS CONTROL SYSTEM

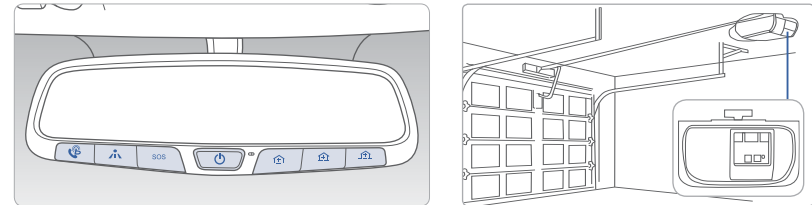

Standard Programming

To train most devices, follow these instructions:

1. For first-time programming, press and hold the two outside buttons, HomeLink[®] Channel 1 and Channel 3 Buttons, until the indicator light begins to flash (after 10 seconds). Release both buttons. Do not hold the buttons for longer than 20 seconds.
2. Position the end of your hand-held transmitter 1-3 inches (2-8 cm) away from the HomeLink[®] buttons while keeping the indicator light in view.
3. Simultaneously press and hold both the HomeLink[®] and hand-held transmitter button. DO NOT release the buttons until step 4 has been completed.
4. While continuing to hold the buttons the red indicator Status LED will flash slowly and then rapidly after HomeLink[®] successfully trains to the frequency signal from the hand-held transmitter. Release both buttons.

For detail instructions, refer to your Owner's Manual or visit www.homelink.com or call (800) 355-3515.

FEATURES AND CONTROLS

SEAT WARMER (front seats)

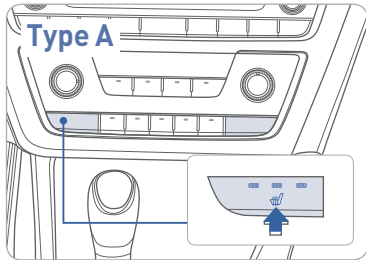

Each time you push the button, the setting is changed as follows:

OFF → HIGH → MIDDLE → LOW

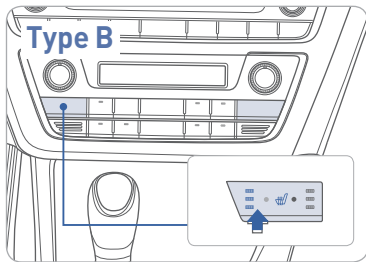

AIR VENTILATION SEATS (front seats)

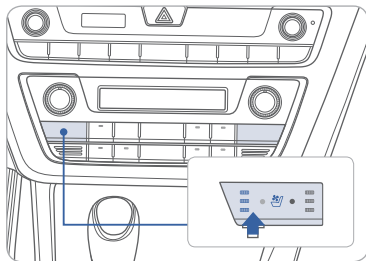

Each time you push the button, the setting is changed as follows:

OFF → HIGH → MIDDLE → LOW



REARVIEW CAMERA

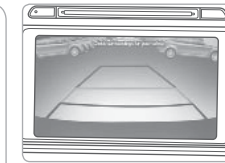
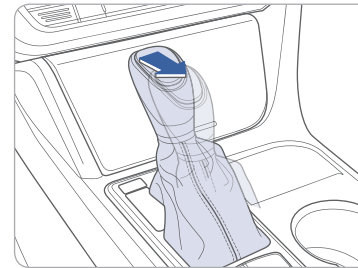

When transmission is shifted into R (Reverse), rearview camera displays the area behind the vehicle.

REAR PARKING ASSIST SYSTEM

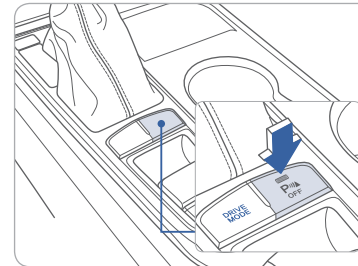

The rear parking assist system assists the driver during reverse movement of the vehicle by chiming if any object is sensed within the distance of 47 inch behind the vehicle.

Push the button to turn off the rear parking assist system. The indicator light on the button will turn on.

CLOCK ADJUSTMENT

With Standard Radio



1. Hour

Press the ① button to adjust the Hour.

2. Minute

Press the ② button to adjust the Minute.

NOTE: Press and hold ① and ② to switch between 12 or 24 hours.

With Navigation

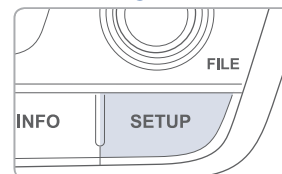

1. Press the SETUP button.

2. Touch the "Clock" button on screen.

3. Select GPS Time to On.

INSTRUMENT CLUSTER

Type A

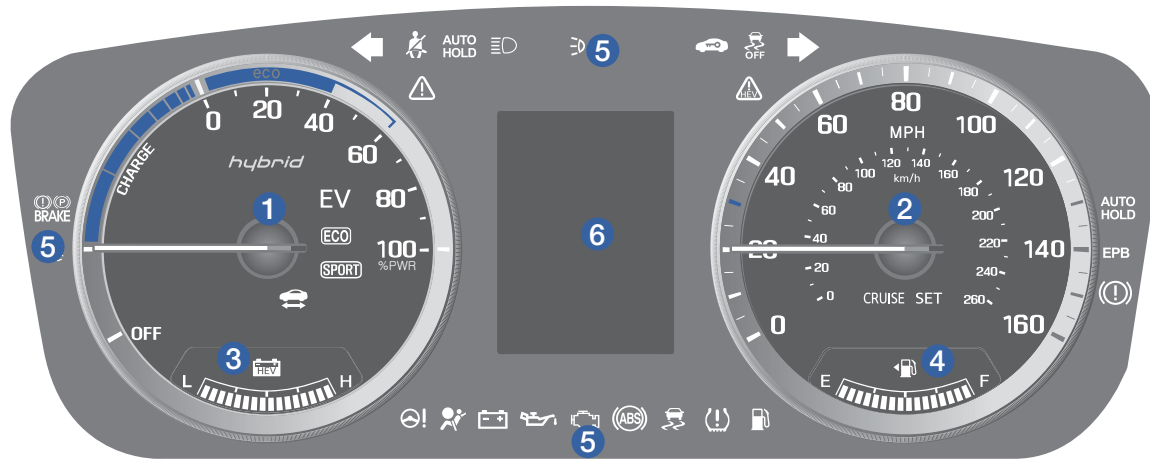

- ① Hybrid system gauge
- ② Speedometer
- ③ Hybrid battery SOC (State of Charge) gauge
- ④ Fuel gauge
- ⑤ Warning and indicator lights
- ⑥ LCD display (including Trip computer)

Type B

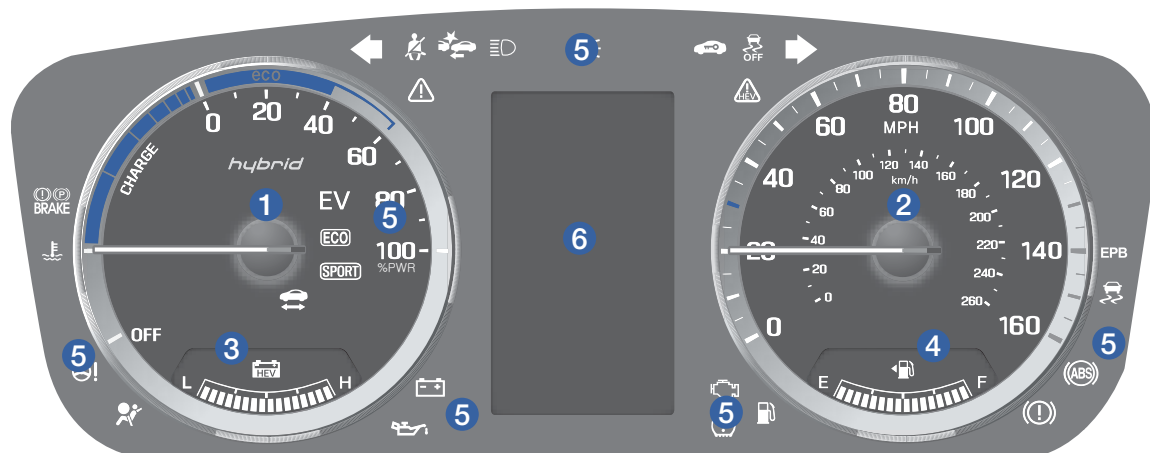

FEATURE AND CONTROLS

LCD DISPLAY MODES

Modes	Symbol	Explanation
Trip Computer		This mode displays driving information like the tripmeter, fuel economy, and so on.
Turn By Turn (TBT) (if equipped)		This mode displays the state of the navigation.
SCC/LDWS (if equipped)		This mode displays the state of the Smart Cruise Control (SCC) and Lane Departure Warning System (LDWS).
AV		This mode displays the state of the A/V (Audio Visual) system.
Information	or or	Displays service interval and warning messages.
User Settings		Changes settings.

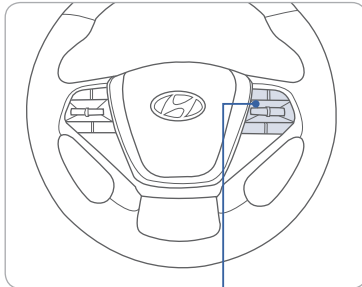

- 1 : MODE button for changing modes
- 2 : MOVE switch for changing items
- 3 OK : SELECT/RESET button for setting or resetting the selected item

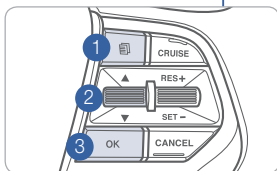

WARNINGS AND INDICATORS

Ready indicator	Service warning light	EV EV Mode indicator
Air bag warning light	Seat belt warning light	Parking brake & Brake fluid warning light
Regenerative Brake warning light	Anti-lock Brake System (ABS) warning light	Electronic Brake Force Distribution (EBD) system warning light
EPB Electric Parking Brake (EPB) warning light	Malfunction Indicator Lamp (MIL)	Charging system warning light
Engine oil pressure warning light	Low fuel level warning light	Low tire pressure warning indicator/TPMS malfunction lamp
Master warning light	Electronic Stability Control (ESC) indicator	Electronic Stability Control (ESC) OFF indicator
Electric Power Steering (EPS) warning light	Immobilizer indicator	Turn signal indicator
High beam indicator	Light ON indicator	CRUISE Cruise indicator
SET Cruise SET indicator	AUTO HOLD AUTO HOLD indicator	SPORT SPORT mode indicator
ECO ECO mode indicator	Forward Collision Warning System (FCWS) warning light	Lane Departure Warning System (LDWS) indicator

INSTRUMENT PANEL ILLUMINATION

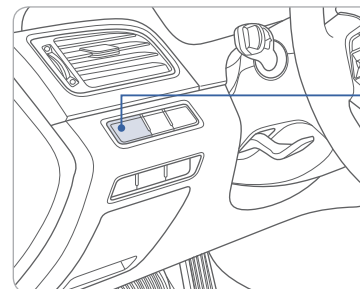

Press - or + to adjust the instrument cluster illumination brightness.

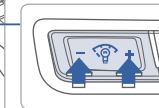



FEATURE AND CONTROLS



Vehicle On

When the vehicle is turned on, the VEHICLE ON indicator is illuminated. Even if the gasoline engine is not running, you can drive the vehicle.

EV

EV Mode

This is an indicator to let the drivers know that the vehicle is operating fully in EV Mode (Electric Vehicle Mode).

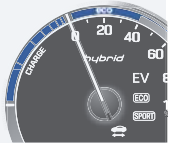

Eco Guide

This is an indicator gauge to display ECO driving status.



Hybrid Service Indicator

If a problem with the Hybrid System occurs, the service indicator light will illuminate. Have an authorized Hyundai dealer correct the condition as soon as possible.

HYBRID SYSTEM MODES

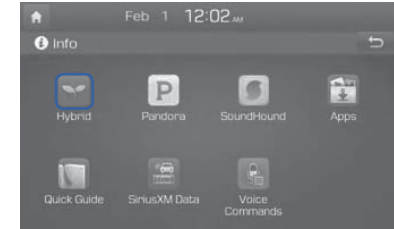
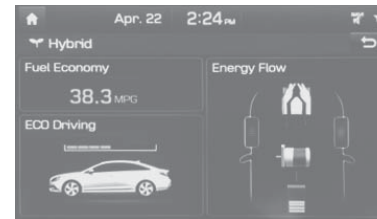

Press the INFO button in the head unit.
Press the Hybrid button to select one of the screens.



ECO Driving

This screen displays if the vehicle is driven economically. The display will change according to the ECO Level bars. The level increases as your driving becomes more economical.



Energy Flow Mode

This screen displays the energy flow from the engine and battery.



Fuel Economy Mode

This screen displays average fuel economy. The graph shows fuel economy for the last 30 minutes and it is updated every 2 minutes and 30 seconds.

CLIMATE CONTROL

Type A

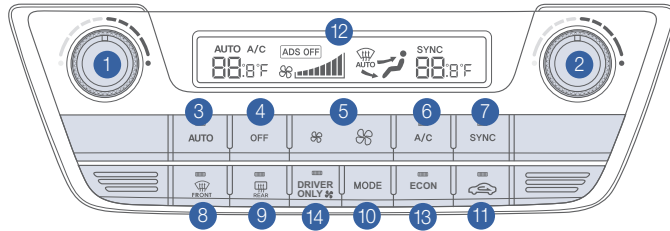

- | | |
|--|---------------------------------------|
| 1 Driver's temperature control knob | 8 Front windshield defroster button |
| 2 Passenger's temperature control knob | 9 Rear window defroster button |
| 3 AUTO (automatic control) button | 10 Mode selection button |
| 4 OFF button | 11 Air intake control button |
| 5 Fan speed control button | 12 Climate control information screen |
| 6 Air conditioning button | 13 ECON button |
| 7 SYNC button | 14 Driver Only button |

DEFOGGING/DEFROSTING

1. Press the defrost button.
2. Select warmest temperature.
3. Set the fan speed to the highest speed.

SYSTEM OFF

Pressing the OFF button will place the system in the OFF mode.

- Climate control fan will turn off.
- Outside (fresh) air position will be selected.
- Vented air will be at last set temperature.

NOTE:

To reduce tendency of the glass fogging and also to improve visibility, keep the interior surface of the windshield clean by wiping it with a clean cloth and glass cleaner. In addition, select air intake control to the outside (fresh) air position whenever possible while operating the vehicle.

Type B

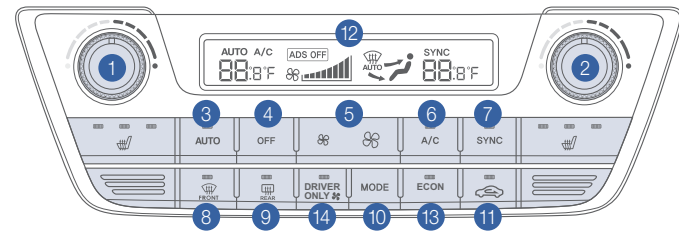

Type C

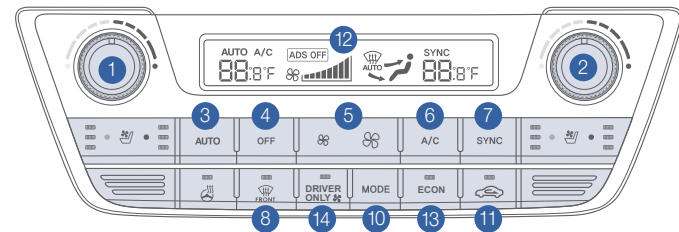

AIR INTAKE CONTROL

- Recirculated air position
- Outside (fresh) air position (Type A)
- Outside (fresh) air position (Type B)
- Only the vents facing the driver are active
- Improved efficiency of the A/C but at a slightly reduced performance

AUTOMATIC HEATING / AIR CONDITIONING

Controlling the modes, fan speeds, air intake and air-conditioning automatically.

MAX A/C MODE

MAX A/C Mode automatically engages Recirculated air position. To prevent frost, blower will automatically blow air toward floor vent for 8 seconds after ignition.

MODE SELECTION

- Changing the direction of the air flow as follow.
-

STEERING WHEEL AUDIO CONTROL

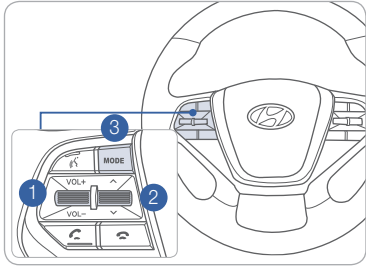

- 1 **VOLUME**
Raises or lowers speaker volume.
- 2 **SEEK/PRESET**
Change station.
- 3 **MODE**
Change the audio source.

BLUETOOTH® OPERATIONAL TIPS

In the following situations you or the other party may have difficulty hearing each other:

1. Keep the Bluetooth® volume to a low level. High level volume may result in distortion and echo.
2. When driving on a rough road, high speeds and/or with the window open.
3. When the air conditioning vents are facing the microphone and/or when the air conditioning fan is at the max speed.

Steering wheel bluetooth® control

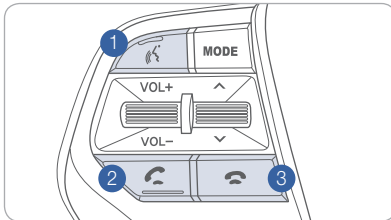

- 1 **TALK**
Activates voice recognition.
- 2 **CALL**
Places and transfers calls.
- 3 **END**
Ends calls or cancels functions.

To Answer a Call:

- Press button on the steering wheel.

To Reject a Call:

- Press button on the steering wheel.

To Adjust Ring Volume:

- Use the VOLUME buttons on the steering wheel.

To Transfer a Call to the Phone

(Private call on handset – do not use while driving):

- Press and hold button on the steering wheel until the audio system transfers a call to the phone.

To End a Call:

- Press button on the steering wheel.

Making a call using voice recognition:

The menu tree identifies available voice recognition Bluetooth® functions.

Calling by Name:

1. Press button.
2. Say the following command:
 - “Call <John Smith>”: Connects the call to John.
 - “Call <John Smith> on <on Mobile/in Office/at Home>”: Connects the call to John’s Mobile, Home, or Office phone number.

Dialing by Number:

1. Press button.
2. Say “Dial Number”.
3. Say desired phone number. For complete list of commands, refer to your Owner’s Manual.

VOICE RECOGNITION TIPS

Your vehicle is equipped with Voice Recognition technology which allows drivers to operate their phones without having to take their eyes off the road to minimize distractions.

Voice recognition performance may be affected if driving with windows and sun roof open; when the heating-cooling system is on; when passing in a tunnel or when driving on rugged and uneven roads.

Quick reference on using voice commands

To start voice command. Press the key, the following commands are available:

Command	Function
Call	Displays downloaded Contacts.
Call <Name>	Calls <Name> saved in Contacts.
Dial Number	Displays a screen where you can say a phone number to dial.
Dial <Phone #>	You can directly say the number to call. ex) Dial 111 555 1234
Redial	Directly calls at the number that you last dialed.
Call History	Displays your Call History.

BLUETOOTH PHONE PAIRING

Phone setup (pairing phone) with Audio

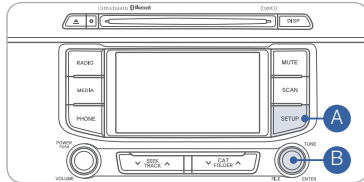

NOTE: Vehicle must be parked to complete the pairing process.

1. Press the SETUP **A** button.
2. Select "Phone" by turning and pressing the TUNE / ENTER **B** knob.
3. Select "Pair Phone" by turning and pressing the TUNE / ENTER knob.
4. Search for the device name as displayed on your mobile phone and connect.
5. Input the passkey displayed on the Audio screen.
6. Pairing is complete.

Phone setup (pairing phone) with Navigation

1. Press the PHONE button in the head unit or the button in the steering wheel remote control.

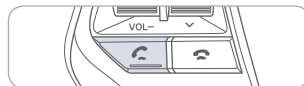
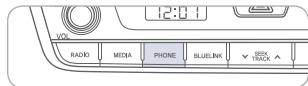

2. Press <YES> to search for Bluetooth phones.
3. Pair your car after your mobile phone detects the Bluetooth device.
4. Enter the passkey or accept the authorization popup. (The default passkey is 0000).
5. Connect Bluetooth.



NOTE: Vehicle must be parked to complete the pairing process.

BLUE LINK TELEMATICS SYSTEM

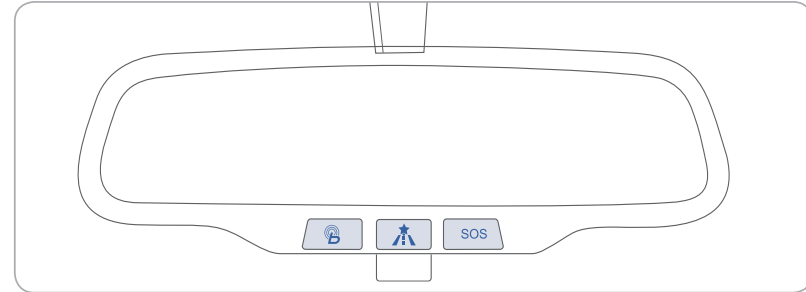

Blue Link subscription is required. To enroll, please visit your dealership or MyHyundai.com.

Press the button for access to the voice-response menu of services.

- You can say:

- Service Link
- Roadside Assistance
- Blue Link Account Services
- Help
- Cancel

Press the button for Destination Search Powered by Google™.

- For vehicle equipped with factory-installed navigation systems.

- For non-navigation, this button functions with Android Auto or Apple Carplay.

Press the **SOS** button for SOS Emergency Assistance.

Visit HyundaiBlueLink.com for more information or refer to your Blue Link User's Manual for detailed information on system operation.

For immediate assistance with subscription services, please call 1-855-2BLUELINK (1-855-225-8354).

Google™ is a registered trademark of Google, Inc.

Blue Link Mobile App



You can download the Blue Link mobile app to your compatible smart phone from the following sites:

- iPhone® — Apple® App Store
- Android™ — Google Play™

Visit HyundaiBlueLink.com FAQs to see a list of compatible devices.



Scan to see list of compatible devices and to download the app.

Remote Start

Remote Start enables you to remotely start your vehicle from virtually anywhere. For vehicles equipped with full-automatic temperature control, you can also enable climate control remotely and turn on the front window defroster, ensuring a warm or cool car is ready to go when you are.

- To use this feature, you must have a Blue Link Personal Identification Number (PIN). To create or change your PIN, log on to www.MyHyundai.com.

Remember:

- Remote Start will automatically shut off after 10 minutes or after selected engine timer runs out in navigation vehicles.
- While this feature is active, the parking lights will blink until vehicle is turned off or when vehicle is in operation.
- To continue operation of the vehicle, the proximity key must be inside the vehicle with the driver prior to pressing the brake and being able to move the gearshift from the P (Park) position.

NOTE: Remote Start is not available on all models. Remote Start is only available for Push Start equipped vehicle with an Automatic Transmission or Dual Clutch Transmission (DCT). Remote Start with Climate Control additionally requires Fully Automatic Temperature Control.

Preconditions:

- Ignition is OFF
- Alarm is armed (i.e., vehicle locked by key fob Remote Door Lock)
- Gearshift level is in the P (Park) position
- Brake pedal is not depressed
- Engine hood is securely closed
- All the doors are closed and locked
- The tailgate or trunk lid is closed
- The security/panic system is not activated
- The proximity key is not inside the vehicle
- The battery power is not low
- Vehicle is located in an open area
- It has been less than 4 days since last vehicle ignition off
- Vehicle located in area with good cell reception

Remote Start will terminate:

- After 10 minutes or after selected engine timer runs out in navigation vehicles
- Brake is pressed without proximity key inside vehicle
- Alarm is triggered without proximity key inside vehicle
- Door/trunk is opened from inside the vehicle

Notice: Laws in some communities may restrict the use of the features that remotely start the engine. For example, some laws may require a person using the remote start feature to have the vehicle in view when doing so or limit the length of time a vehicle engine may idle. Please check local and state regulations for any requirements and restrictions on remote starting of vehicles and engine idling time.

WARNING!

Do not remote start vehicle in an enclosed environment (i.e., closed garage). Prolonged operation of a motor vehicle in an enclosed environment can cause a harmful build-up of carbon monoxide. Carbon monoxide is harmful to your health. Exposure to high levels of carbon monoxide can cause headaches, dizziness or in extreme cases unconsciousness and/or death. Do not leave children or animals unattended in a vehicle while using the remote start function.

CAUTION!

If the vehicle's windshield wipers are left on when the vehicle was last driven, then the wipers will turn on if the remote start function is activated. To avoid damage to the wiper blades (i.e., due to heavy ice or snow accumulated on the windshield), please always turn the vehicle's windshield wipers off when parking the vehicle.



MULTIMEDIA

STANDARD AUDIO

Audio mode

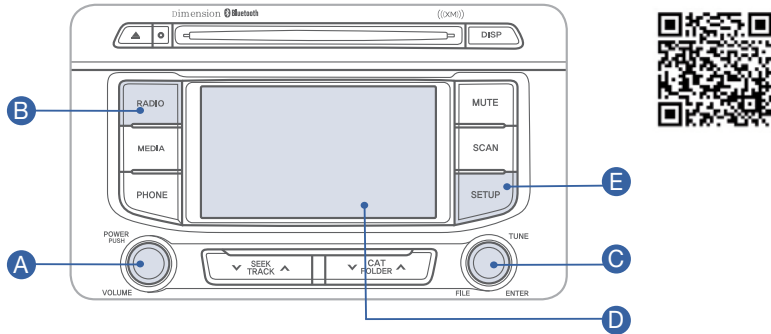

Press **POWER** button **A** to turn radio on.

- **TUNING/LISTENING TO CHANNELS**

1. Press **RADIO** button **B** to select FM/AM/XM.
2. Rotate **TUNE** knob **C** to desired channel.

NOTE:

A clear view of the southern sky is recommended to ensure XM[®] radio reception.

- **SETTING PRESET MEMORY BUTTONS (FM/AM/XM[®])**

Press and hold any preset button **D** on screen.

- **ADJUSTING THE SOUND CONTROL**

1. Press the **SETUP** button **E**.
2. Press the “Sound” button on the screen.
3. Press “Sound Setting” button on the screen.

Please refer to your Owner's Manual for more detailed information on how to use your audio system.
Complimentary XM subscription ends three months following the vehicle date of sale. Please contact XM Radio at 1-800-XM-RADIO (1-800-967-2346) to renew your XM subscription.



NAVIGATION

Audio mode

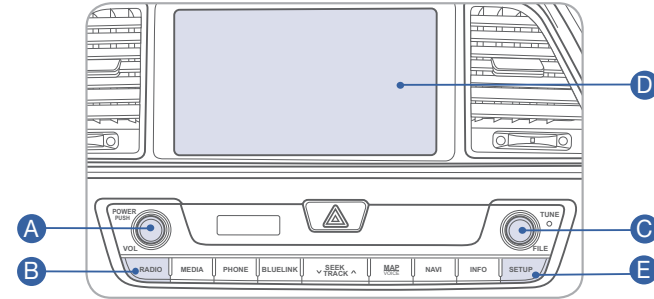

Press **POWER** button **A** to turn radio on.

- **TUNING/LISTENING TO CHANNELS**

1. Press **RADIO** button **B**.
2. Rotate **TUNE** knob **C** to desired channel.

NOTE:

A clear view of the southern sky is recommended to ensure XM[®] radio reception.

- **SETTING PRESET MEMORY BUTTONS (FM/AM/XM[®])**

Press and hold any preset button **D** until an audible beep is heard to store current channel.

- **ADJUSTING THE SOUND CONTROL**

1. Press **SETUP** button **E**.
2. Select **Sound** button on screen.
3. Touch on-screen arrows to adjust desired setting.



Basic features on the map screen

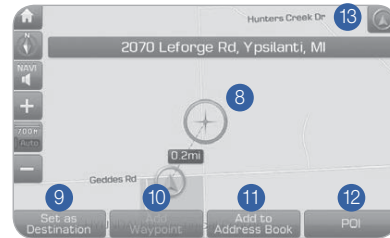
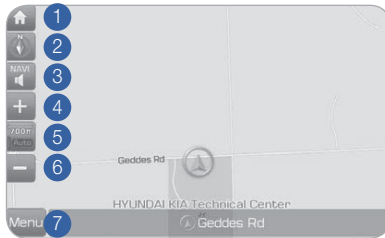

- 1 Move to the Home Screen
- 2 Change the map view mode
- 3 Voice Guidance On/Off
- 4 Zoom in the map
- 5 Set the zoom level automatically according to the guidance
- 6 Zoom out the map
- 7 Quick and easy selection of a destination and options
- 8 Touch to scroll the map
- 9 Quick and easy selection of a destination from the map screen
- 10 Set a waypoint to the current route
- 11 Save frequently used address to address book
- 12 Find a POI (Point Of Interest) around the current position
- 13 View the vehicle's current position on the map screen

Basic features on the map screen

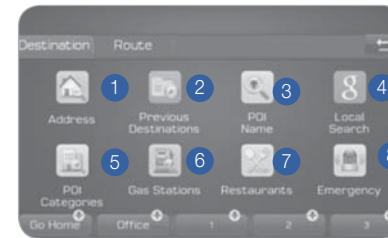

- 1 Set destination by address search.
- 2 Select from previously inputted addresses and POI's.
- 3 Search POI Name to search the destination.
- 4 Runs Google Local Search.
- 5 Select the desired item in the sub-categories.
- 6 Search and select the desired destination among the searched items.
- 7 Search and select the desired destination among the searched items.
- 8 Search and select the desired destination among the searched items.
- 9 Search the destination with the address book.
- 10 Search destination by phone number.
- 11 Type freeway name and exit/entrance to search.
- 12 Type the Street name, the State, and city name to search.
- 13 Type coordinates to search.

AUX, USB AND iPod PORT

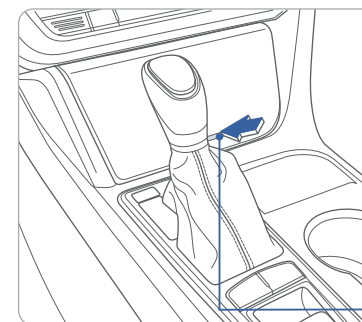

Use the input jack to connect an external audio device and listen to it through the audio system in your vehicle.



ANDROID AUTO™

REQUIREMENTS:

- Micro USB cable
- OS Android™ 5.0 or higher
- Compatible Android Phone
- Data and wireless plan for applicable features

BEFORE YOU BEGIN:

- Android Auto features may operate differently than on your phone.
- Message and data charges may apply when using Android Auto.
- Android Auto relies on the performance of your phone. If you experience performance issues:
 - Close all apps and then restart them or
 - Disconnect and then reconnect your phone
- Using the micro USB cable that was provided with your phone is recommended.
- When Android Auto is active, your in-vehicle voice recognition system is disabled and you will be using talk to Google™ to make your requests.

ANDROID AUTO SUPPORT



<https://support.google.com/androidauto/>

PHONE SETUP

Turn on the Bluetooth® on your phone and connect the micro USB cable to your phone and the USB port on the vehicle.

Phone will prompt you to download the Android Auto app and update other needed apps (i.e. Google Maps™, Google Play Music™, Google Now™).

NOTE: Vehicle must be parked.

- Location mode setting should be set to High accuracy.
- Vehicle and phone setup should be completed in one sitting. If phone setup needs to be resumed, we recommend to Force Stop the Android Auto app on the Phone then reopen the app and accept the Disclaimer notifications.

CAR SETUP

1. Press the SETUP button.
2. Touch the “Connectivity” icon on the screen.
3. Select “On” for Android Auto.
4. Connect your Android phone to the vehicle USB port. Agree to the notification and disclaimers on your phone then the “Android Auto” icon will appear confirming the setup.

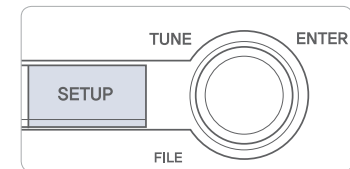

For more detailed information on how to operate Android Auto, please refer to your navigation manual.

For additional Android Auto support, please refer to the Android Auto Support Website
<https://support.google.com/androidauto/>

Android Auto, Google Play, Android, and other marks are trademarks of Google Inc.

APPLE CARPLAY™

REQUIREMENTS

- Apple Lightning® cable
- Latest iOS
- iPhone® 5 or above
- Data and wireless plan for applicable features

BEFORE YOU BEGIN

- Apple® CarPlay features may operate differently than on our phone.
- Message and data charges may apply when using Apple CarPlay.
- Apple CarPlay relies on the performance of your phone. If you experience performance issues:
 - Close all apps and then restart them or
 - Disconnect and then reconnect your phone
- Using the Apple Lightning cable that was provided with your phone is recommended.
- When Apple CarPlay is active, your voice recognition system is disabled and you will be using Siri® to make your requests.

PHONE SETUP

On your phone, go to Settings > General > Restrictions > CarPlay to allow CarPlay access.

On your phone, go to Settings > General > Siri and ensure Siri is turned ON.

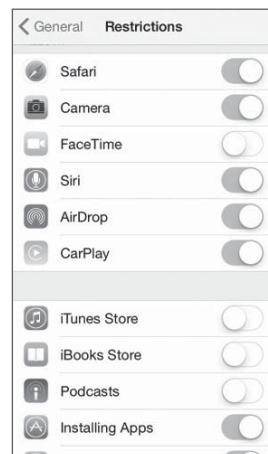

CAR SETUP

1. Press the SETUP button.
2. Touch the “Connectivity” icon on the screen.
3. Touch “iOS” on the Connectivity Settings screen then touch “On” to enable Apple CarPlay.
4. Connect your Apple iPhone to the vehicle USB port then touch ‘OK’ when the pop-up message appears. The Apple CarPlay icon will now appear on the vehicle Home screen confirming the setup.

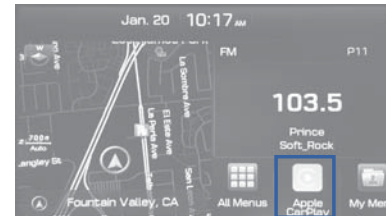

Apple CarPlay, Apple, and other marks are trademarks of Apple Inc.

CarPlay Home Screen

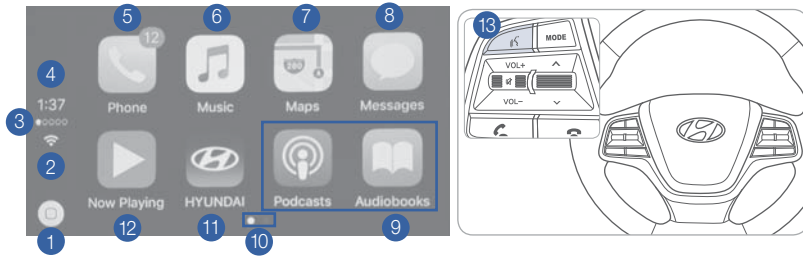

- | | |
|-------------------------|----------------------------------|
| 1 HOME ICON | 7 APPLE MAPS |
| 2 WIRELESS CONNECTIVITY | 8 MESSAGES |
| 3 CELLULAR SIGNAL | 9 3RD PARTY APPS |
| 4 PHONE TIME | 10 SCREEN PAGE INDICATOR |
| 5 PHONE | 11 EXIT TO HYUNDAI |
| 6 APPLE MUSIC™ | 12 CURRENT CARPLAY AUDIO PLAYING |

SIRI

Apple CarPlay uses Siri to perform many actions like sending messages, placing calls, and looking up/setting POI/Destinations. A Siri session can be initiated on any screen by:

1. Touch and holding the HOME icon **1** on the CarPlay screen or
2. Press the steering wheel VOICE RECOGNITION **13** button.

Note: Ensure Siri feature is set to ON in your phone (Go to Settings > General > Siri).

3. Say any of the following commands;
 - “Text <John Smith> ‘Call you later’” to send a text message.
 - “Read text messages” to read available text message.
 - “Call <John Smith>” to make a phone call.
 - “Find <POI/Destination>” to locate a POI/Destination.

PHONE

Touch the PHONE **5** icon to access the Phone screen. Siri will automatically asks ‘Who you would like to call’ when the PHONE **5** icon is selected.

NOTE: Phone call sound quality is dependent on the wired connection. Using the Lightning cable that came with the phone is recommended.

APPLE MUSIC

Touch the APPLE MUSIC **6** icon to access the Apple Music screen.

APPLE MAPS

Touch the APPLE MAPS **7** icon to access the Apple Map screen.

MESSAGES

Touch the MESSAGES **8** icon to access the Message screen. Siri will automatically asks ‘To hear unread messages or create a new one’ when the MESSAGE icon is selected.

3rd PARTY APPS

Supported CarPlay apps that are downloaded on your phone will appear on the CarPlay screen. Touch the apps icons to access those supported apps.

NOTE: A list of the supported CarPlay supported apps can be found at <http://www.apple.com/ios/carplay/>

Ensure phone has latest version of the 3rd Party Apps.

ELECTRIC PARKING BRAKE (EPB)

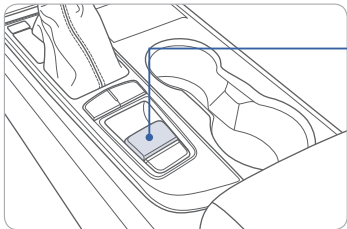
Applying

Stop the vehicle then pull up the EPB switch.

Releasing

Move shift lever from P to R or D while depressing the brake pedal.
or

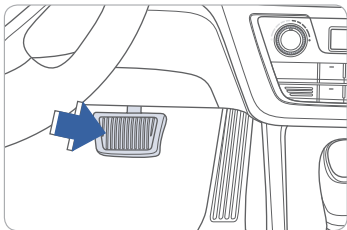

Press the EPB switch while depressing the brake pedal.

NOTE:

If necessary, emergency braking is possible by pulling and holding the EPB switch.

AUTO HOLD

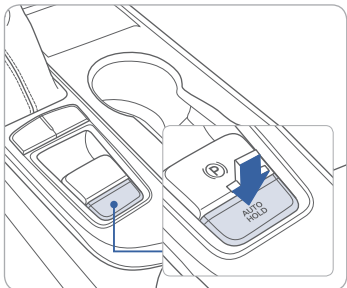

When the vehicle reaches a stop, Auto Hold keeps the vehicle stopped even when the brake pedal is released. The brakes are released automatically when the accelerator pedal is pressed.

**WHITE
AUTO
HOLD**

1. Press the AUTO HOLD switch.

**GREEN
AUTO
HOLD**

2. Stop the vehicle by pressing the brake pedal. The brake will remain engaged even if the brake pedal is released.

**WHITE
AUTO
HOLD**

3. The brake pedal will release when the accelerator pedal is pressed with transmission in D, R or manual mode.

To cancel the AUTO HOLD operation, press the AUTO HOLD switch again.

TIRE PRESSURE MONITORING SYSTEM (TPMS)

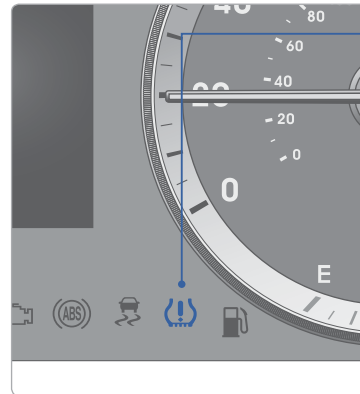

Low Tire Pressure Indicator /
TPMS Malfunction Indicator



Low Tire Pressure Position Indicator and
Tire Pressure Indicator
(Shown on the LCD display)

LOW TIRE PRESSURE INDICATOR

Illuminates if one or more of your tires is significantly under-inflated.

TPMS MALFUNCTION INDICATOR

Blinks for approximately one minute, then remains illuminated when there is a malfunction with the TPMS. Inspect all tires and adjust tire pressure to specification. If the lamp remains illuminated, have the system checked by an authorized Hyundai dealer as soon as possible.

LOW TIRE PRESSURE POSITION INDICATOR AND TIRE PRESSURE INDICATOR (LCD DISPLAY)

Tire pressures will display after driving a short distance. If a tire pressure drops lower than predetermined specification, the Low Tire Pressure Indicator (⚠️) will illuminate and the LCD (📊) display will indicate tire(s) requiring air.

AUTOMATIC TRANSMISSION

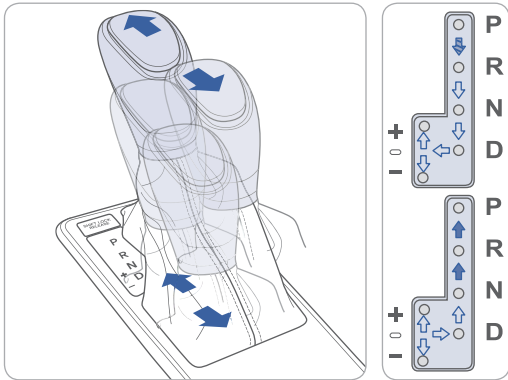

- (➡): Press the shift button, then move shift lever.
- (⚡➡): Depress the brake pedal, press the shift button, and then move shift lever.
- (➡): Move shift lever.

Sport mode

Move the shift lever from D (Drive) into the manual gate to select.
Move the shift lever forward (+) to up shift or rearward (-) to downshift.

ELECTRONIC STABILITY CONTROL (ESC)

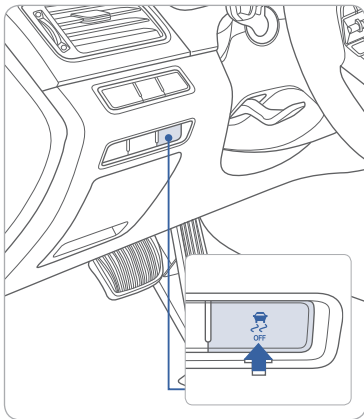

The ESC system is an electronic system designed to help the driver maintain vehicle control under adverse conditions.

ESC automatically selects the ON position when the engine is started.

To turn off Engine Control
press the ESC OFF button shortly.

To turn off Engine and Traction Control
press the ESC OFF button for more than 3 seconds.

LANE DEPARTURE WARNING SYSTEM (LDWS)

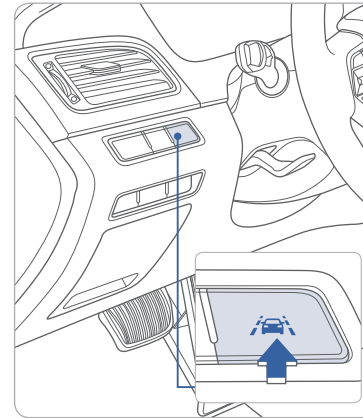

The Lane Departure Warning System detects the lane on the road and warns the driver if the vehicle leaves the lane when the vehicle speed is over 37mph.

- To turn LDWS on, press the LDWS switch
- To turn LDWS off, press the switch again.

BLIND SPOT DETECTION SYSTEM (BSD)

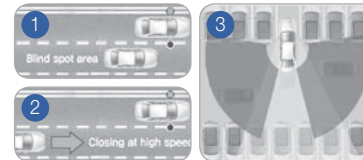

The BSD (Blind Spot Detection) system uses a radar sensor to alert the driver while driving. It senses the rear side territory of the vehicle and provides information to the driver.

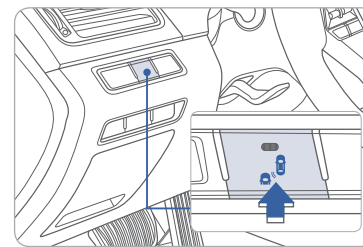

- ① Blind Spot Detection
- ② Lane Change Assist
- ③ Rear Cross Traffic Alert
- To turn the BSD on, press the BSD button. (indicator illuminated)
- To turn the BSD off, press the BSD button again.

The system will activate if vehicle speed exceeds 20 mph.

Rear Cross Traffic Alert

When the transmission is put in R (Reverse), the system provides an alert if a vehicle is approaching from the sides.

DRIVE MODE INTEGRATED CONTROL SYSTEM

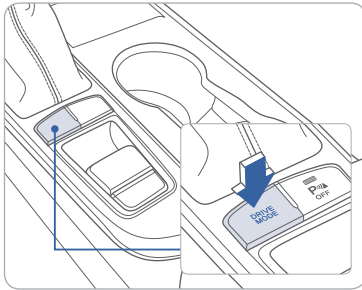

You can select the drive mode according to your preference or the road condition. The system initializes to the ECO mode after the engine has been turned off and on.

Each time you press the button, the drive mode is changed as follows :

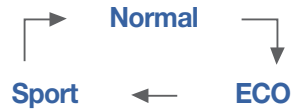

Normal mode is not displayed on the instrument cluster.

ECO mode

Eco mode system helps to improve fuel efficiency. When the Eco mode system is activated, the vehicle acceleration, gear shift points and air conditioning performance will be reduced to conserve the fuel consumption.

Sport mode

Sport mode focuses on engaging driving dynamics by adjusting the steering feel along with the responsiveness of the engine and transmission.

CRUISE CONTROL/SMART CRUISE CONTROL

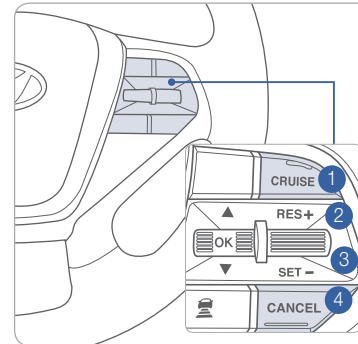

The Cruise Control system allows you to program the vehicle to maintain a constant speed without holding the accelerator pedal.

- 1 To On/Off the Cruise Control.
- 2 To Resume or Increase the Cruise Control speed.
- 3 To Set or Decrease the Cruise Control speed.
- 4 To Cancel the Cruise Control.

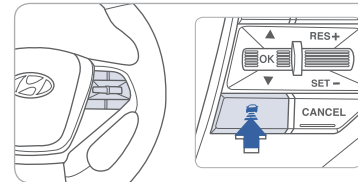

Setting Vehicle Distance (Advanced Smart Cruise Control only)

This system assist you in setting the distance from the vehicle ahead and will maintain the selected distance without you depressing the accelerator or the brake pedal.

The vehicle to vehicle distance 1 will automatically activate when you set the cruise speed 2.

Each time the vehicle distance set button is pressed, the vehicle to vehicle distance changes as follows:

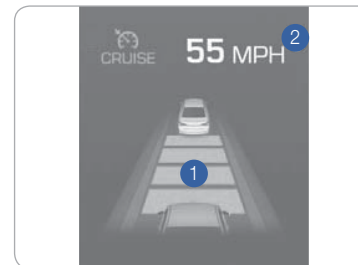

If your vehicle is equipped with Advanced Smart Cruise Control and you wish to eliminate the vehicle distance function, you can change cruise control setting to a standard setting.

Press the Cruise Control button on the steering wheel to turn on Cruise Control. Then press and hold the vehicle distance button for more than 2 seconds to toggle between Smart Cruise Control (SCC) and Cruise Control (CC) mode.

Please refer to your Owner's Manual for more information.

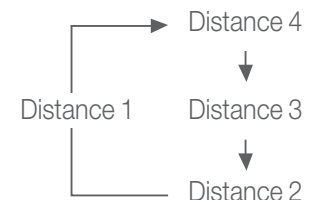

HYBRID DRIVING TIPS

The following tips may help benefit you to maximizing fuel economy and experience Hybrid driving.

Common practice:

- Check tire pressure
- Roll windows up when driving
- Properly maintain your vehicle
- Turn the climate control system off during cold start.



Set headlight switch to AUTO or OFF when not in use. This will help preserve Hybrid battery charge.

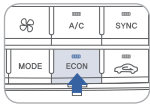

Set climate control to ECON mode.

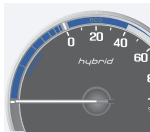

Try to drive in the ECO zone and maintain EV Mode indicator to illuminate as much as possible.

Driving suggestions to improve fuel economy:

- Drive smoothly.
- Accelerate at moderate speed.
- Try to maintain your speed with traffic to prevent unnecessary speed adjustments.
- Always maintain a safe driving distance from the vehicle in front of you so you can avoid unnecessary braking.

Horizontal lines for writing a memo.

HYUNDAI VEHICLE OWNER PRIVACY POLICY

Your Hyundai vehicle may be equipped with technologies and services that use information collected, generated, recorded or stored by the vehicle. Hyundai has created a Vehicle Owner Privacy Policy to explain how these technologies and services collect, use, and share this information.

You may read our Vehicle Owner Privacy Policy on the Hyundaiusa.com website at <https://www.hyundaiusa.com/owner-privacy-policy.aspx> If you would like to receive a hard copy of our Vehicle Owner Privacy Policy, please contact our Customer Connect Center at:

Hyundai Motor America
Hyundai Customer Connect Center
P.O. Box 20850
Fountain Valley, CA 92728-0850
800-633-5151 consumeraffairs@hmausa.com

Hyundai's Customer Connect Center representatives are available Monday through Friday, between the hours of 5:00 AM and 7:00 PM PST and Saturday and Sunday between 6:30 AM and 3:00 PM PST (English). For Customer Connect Center assistance in Spanish or Korean, representatives are available Monday through Friday between 6:30 AM and 3:00 PM PST.

SONATA HYBRID CUSTOMER DELIVERY CHECK LIST

Table with 2 columns: Field Name, Value. Fields include HYUNDAI OWNER, SALES CONSULTANT, VIN, DEALERSHIP NAME, DATE, PREVIOUS VEHICLE.

BEFORE DELIVERY

- SET TIRE PRESURE LF ___ RF ___ RR ___ LR ___
VERIFY VEHICLE IS CLEAN, IN GOOD CONDITION, FREE OF CHIPS AND SCRATCHES · CLEAN WINDSHIELD AND BACK WINDOW
ENSURE FLOORMATS ARE SNAPPED INTO PLACE

Signature lines for Sales Consultant, Date, Sales Manager, Date, Customer, Date, and Email.