

WALK THE CUSTOMER THROUGH EACH OF THE FOLLOWING KEY DELIVERY FEATURES

☐ DefRoSt- page 14-17

- 1 press the front defrost button.
- 2 Set to warmest temperature setting.
- 3 Set to highest fan speed.

Manual climate control

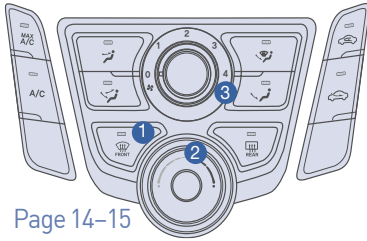

Page 14-15

Automatic climate control

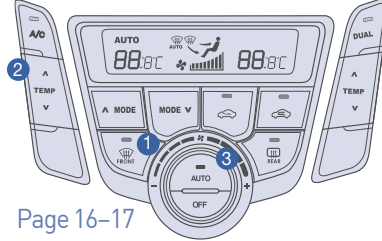

Page 16-17

☐ bluetooth – page 20-21

- Show phone compatibility website: www.hyundaiusa.com/bluetooth
- Make a test call using customer's paired phone
- Demonstrate Voice Recognition (VR)

☐ blue lINK – pages 24-25 (if applicable)

- Assist with creating MyHyundai.com account
- Assist with Blue Link enrollment
- Show Blue Link Users Manual & tear out Voice Commands/Quick Tip Card
- Encourage customers to press the Blue link button 

☐ wINDShleID wIpeR/waSheR – page 09

- explain wiper function (int speed, front & rear wipers) and how it may differ from customer's previous vehicle

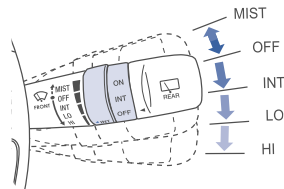

☐ CloCK – page 30

- Demonstrate how to set clock (including daylight savings setting for Navigation equipped vehicles)

☐ uNlOCKING VehICle – page 02

- Demonstrate dual state unlock with key and remote keyless entry

MAINTENANCE

Scheduled Maintenance	Normal Usage		Severe Usage*	
Engine Oil And Filter*	Replace	7,500 or 12 mos.	Replace	3,750 or 6 mos.
Fuel Additives	Add	Every 7,500 or 12 mos.		
Tire Rotation	Perform	7,500	Perform	7,500
Air Cleaner Filter	Inspect Replace	7,500 30,000	Inspect Replace	Same As Normal More Frequently
Battery Condition	Inspect	7,500	Inspect	Same As Normal
Vacuum Hose	Inspect	7,500	Inspect	Same As Normal
Climate Control Air Filter (For Evaporator And Blower Unit)	Replace	15,000	Replace	More Frequently
Air Conditioning Refrigerant	Inspect	15,000	Inspect	Same As Normal
Brake Hoses & Lines	Inspect	15,000	Inspect	Same As Normal
Drive Shafts & Boots	Inspect	15,000	Inspect	7,500 or 6 mos.
Electronic Throttle Control	Inspect	15,000	Inspect	Same As Normal
Exhaust Pipe & Muffler	Inspect	15,000	Inspect	Same As Normal
Front Brake Disc / Pads, Calipers	Inspect	15,000	Inspect	More Frequently
Rear Brake Drums / Linings Rear Brake Disc / Pads	Inspect	15,000	Inspect	More Frequently
Steering Gear Box, Linkage & Boots/ Lower Arm Ball Joint, Upper Arm Ball Joint	Inspect	15,000	Inspect	More Frequently
Suspension Mounting Bolts	Inspect	15,000	Inspect	Same As Normal
Brake/Clutch Fluid	Inspect	30,000	Inspect	Same As Normal
Fuel Filter	Inspect	30,000	Inspect	Same As Normal
Fuel Lines, Fuel Hoses And Connections	Inspect	30,000	Inspect	Same As Normal
Fuel Tank Air Filter	Inspect	30,000	Inspect	Same As Normal
Parking Brake	Inspect	30,000	Inspect	More Frequently
Vapor Hose, Fuel Tank & Fuel Filler Cap	Inspect	30,000	Inspect	Same As Normal
Manual Transmission Fluid	Inspect	37,500	Replace	75,000
Drive Belt (Alt, A/C)	1st Inspect 60,000 or 72mos. Add. Inspect 15,000 or 24mos.		Inspect	Same As Normal
Spark Plugs (Iridium Coated)	Replace	100,000 or 10yrs.	Replace	More Frequently
Coolant	1st Replace 120,000 or 10yrs. Add Replace 30,000 or 24mos.		Replace	Same As Normal
Automatic Transmission Fluid	No check, No service required		Replace	60,000

*Check the engine oil regularly between recommended oil change. Hyundai recommends Quaker State oil.

*See Owner's Manual for details.

Looking For more detailed information? This Quick Reference Guide does not replace your vehicle's Owner's Manual. If you require additional information or are unsure of a specific issue, you should always refer to the vehicle's Owner's Manual or contact your authorized Hyundai dealer.

The information contained in this Quick Reference Guide was correct at the time of printing, however, specifications and equipment can change without notice. No warranty or guarantee is being extended in this Quick Reference Guide, and Hyundai reserves the right to change product specifications and equipment at any time without incurring obligations. Some vehicles are shown with optional equipment. Specifications apply to U.S. vehicles only. Please contact your Hyundai dealer for current vehicle specifications.

NP150-82014-D
(Rev 12/11/14)
Printing 12/14/14

HYUNDAI

ELANTRA GT

Quick Reference Guide

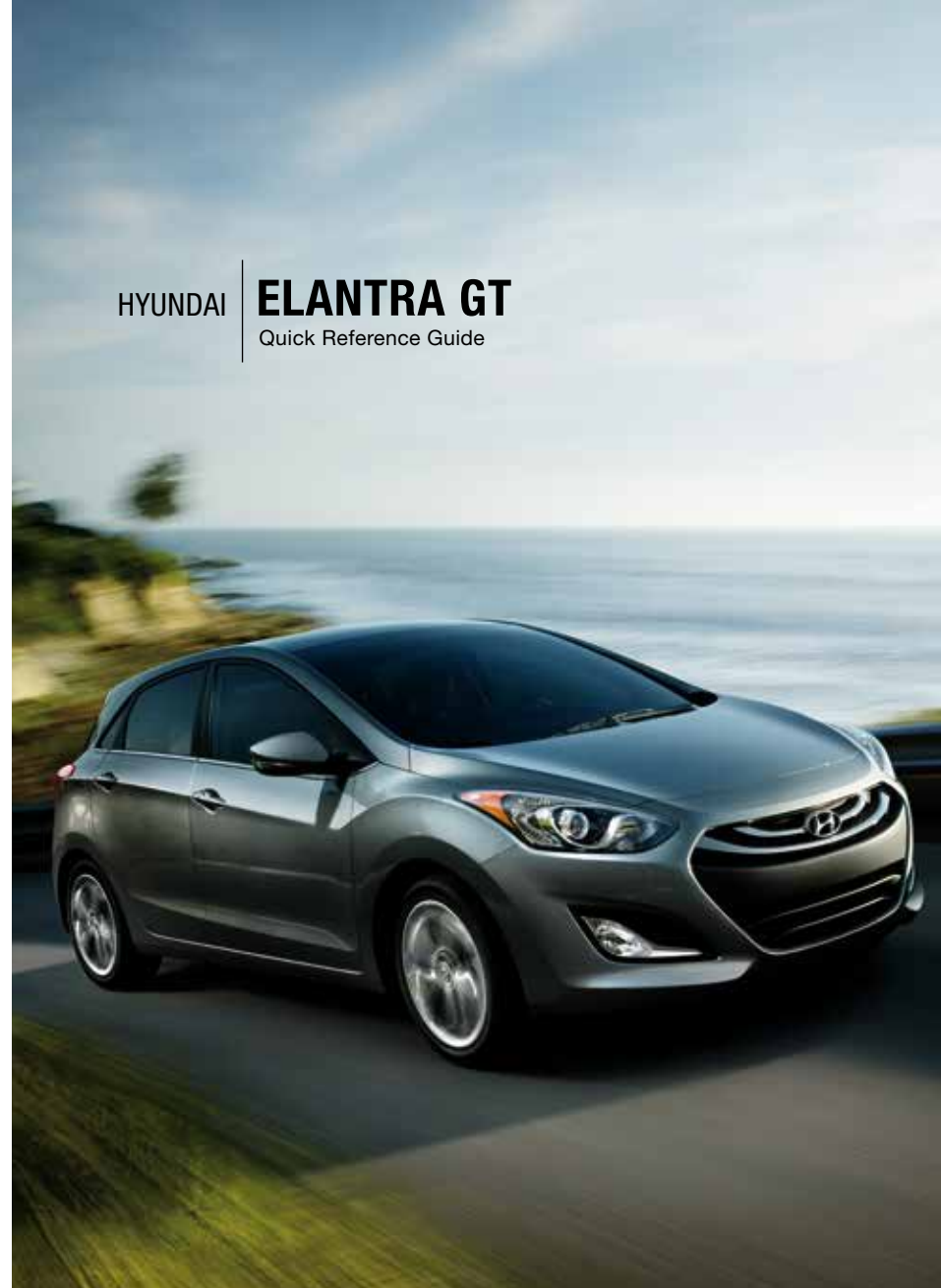

www.hyundai.com

 **HYUNDAI**
NEW THINKING.
NEW POSSIBILITIES.

Roadside Assistance: **1-800-243-7766**
Consumer Affairs: **1-800-633-5151**
XM® Radio: **1-800-967-2346**
Blue Link: **1-855-2BLUELINK**
(1-855-225-8354)

Table of contents

GETTING STARTED

Engine start/stop button	03
Front seat adjustment	04
Fuel filler lid	06
Headrest adjustment	05
Rear seat folding	05
Remote keyless entry	02
Seat belt adjustments	06
Steering wheel adjustments	06

FEATURES AND CONTROLS

Active ECO system	35
Central door lock switch	07
Child-protector rear door lock	31
Climate control—manual	14-15
Climate control—automatic	16-17
Cruise control system	18
Driver selectable steering mode	19
Driver's main controls	07
Electronic Stability Control (ESC)	34
Headlights and fog lights	08
Instrument cluster	12-13
Instrument panel illumination	13
Interior lights	11
Rearview camera	36
Seat warmer	31
Steering wheel controls	18-19
Sunroof	10
Tire pressure monitoring system (TPMS)	34
Transmission	32-33
Trip computer	13
Wiper and washer	09

MULTIMEDIA

AUX, USB, and iPod® Port	30
Blue Link Telematics System	24-25
Bluetooth operational tips	20
Bluetooth phone pairing	22
Clock adjustment	30
Navigation	27-29
Standard Radio	26

*Some vehicles may not be equipped with all the listed features.

How to:

Pair phone to your vehicle. Refer to page 22.

Headlights and Fog lights Page 08

Instrument Cluster Page 12-13

Driver Selectable Steering mode Page 19

Wiper and Washer Page 09

Audio/Navigation Page 26-29

Headlights

Fog lights

Standard Audio

Navigation Audio

Driver's main controls Page 07

Steering Wheel adjustment Page 06

Trip Computer Page 13

Transmission Page 32-33

Climate Control Page 14-17

Manual

Automatic

Use this Quick Reference Guide to learn about the features that will enhance your enjoyment of your Hyundai. More detailed information about these features are available in your Owner's Manual.



WARNING!

To reduce the risk of serious injury to yourself and others, read and understand the important SAFETY INFORMATION in your Owner's Manual.



GETTING STARTED

Download QR Code Reader

You can download a QR reader app to your smart phone to take advantage of the QR codes throughout this Quick Reference Guide.





iPhone® - Apple® App Store

Android® - Google Play

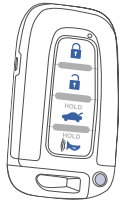
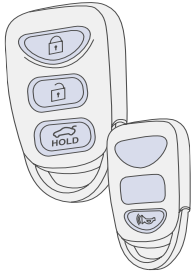
BlackBerry® - BlackBerry® App World

REMOTE KEYLESS ENTRY



-  Lock
-  Unlock
-  Trunk unlock
-  Panic

Keyless Entry



Smart Key

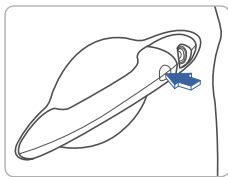

Driver's door Lock/Unlock

Smart key must be within range.

Press:

- Once - Unlock driver door
- Twice - Unlock all doors
- Third - Lock all doors

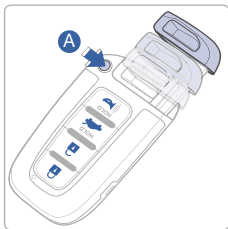

Remove mechanical key

Press and hold the release **A** button and remove the key.

Reinstall mechanical key

Put the key into the hole and push it until a click sound is heard.

ENGINE START/STOP BUTTON



To start the engine, depress the brake pedal and press start/stop button. To shut engine OFF, stop the vehicle, shift to P (Park) and press the start/stop button.

With the engine OFF, press the engine start/stop button without depressing the brake pedal:

- Once for ACC (Accessory) mode.
- Twice for ON mode.
- Three times for OFF.

Emergency situations

Shut off engine while driving:

- Press engine start/stop button for more than 2 seconds or press it 3 times consecutively within 3 seconds.

Restart engine while driving:

- Press engine start/stop button with shift lever in N (Neutral).

GETTING STARTED

FRONT SEAT ADJUSTMENT (MANUAL)

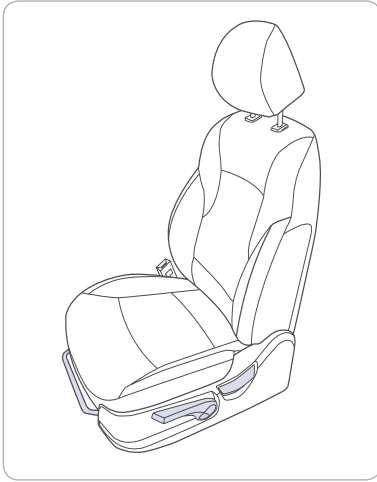

Forward and backward



Seat cushion height (for driver's seat)



Seatback angle



FRONT SEAT ADJUSTMENT (POWER)

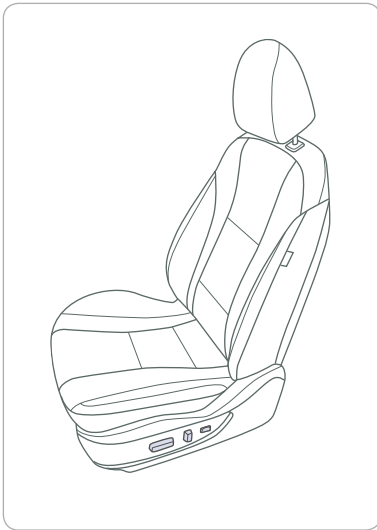

Forward and backward

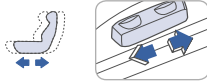

Seat cushion height (for driver's seat)

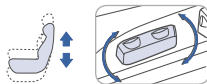

Seatback angle



Lumbar support



REAR SEAT FOLDING

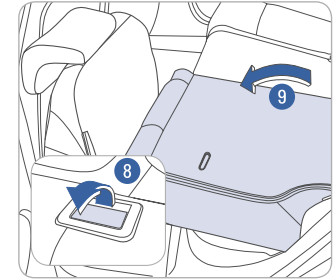
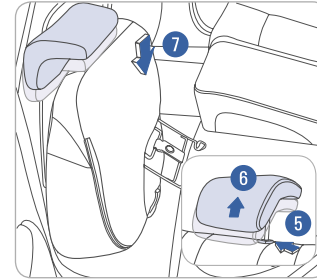
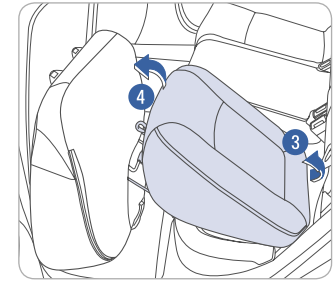
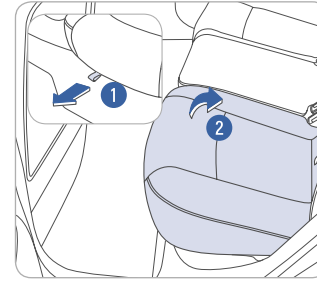

WARNING!

When folding the rear seat, never allow the rear seat components to contact the front passenger seat as this may affect the proper operation of the SRS Occupant Classification System (see Owner's Manual for additional details).

HEADREST ADJUSTMENT

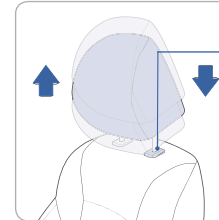

Height adjustment

Lock knob

To raise headrest height, pull up on headrest.
To lower headrest, press lock knob while pushing down on headrest.

SEAT BELT ADJUSTMENT (Front seat)

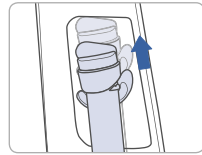
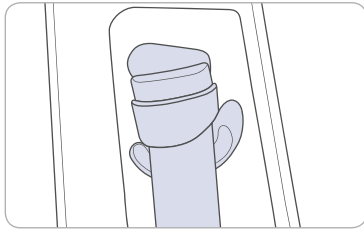

Pull up to raise.

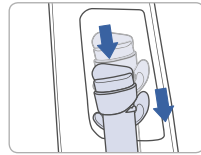

Press button and push down to lower.

STEERING WHEEL ADJUSTMENTS

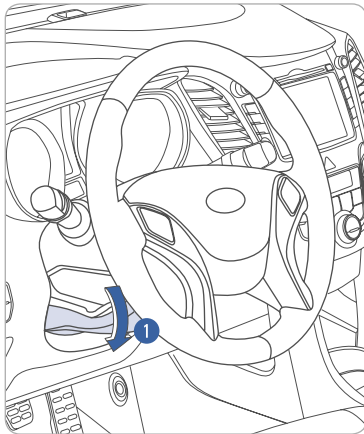

Tilt



Telescopic

1. Pull the lever ① down .
2. Set the angle ② and distance ③ .
3. Pull the lever ① up.



FUEL FILLER LID

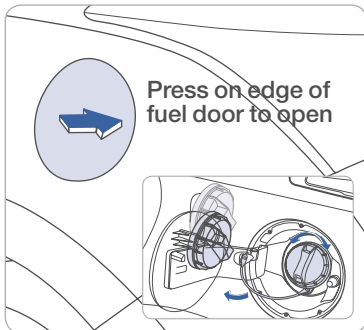

Press on edge of fuel door to open

NOTE

* After adding fuel, always reinstall the fuel cap onto the filler neck by rotating it clockwise until it clicks one time. Failure to do this may result in the Check Engine Light illuminating.

* The fuel filler lid will open and close only when the driver's door is unlocked while the Two Turn Unlock function activates or all doors are unlocked while the Two Turn Unlock function deactivates.

* Check the engine oil regularly between recommended oil changes.

DRIVER'S MAIN CONTROLS

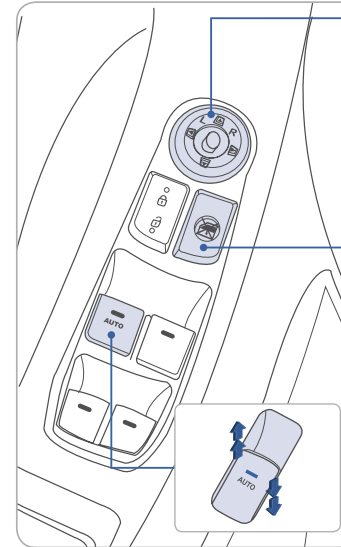

Outside Rearview Mirrors

Press L (left) or R (right) on the switch. Then adjust the mirror by using the directional switch.



Power Window Lock Switch

Disables the power window switches on the passenger doors.

Window Auto down/up (driver's side only)

Press past detent to fully open/close window.



CENTRAL DOOR LOCK SWITCH

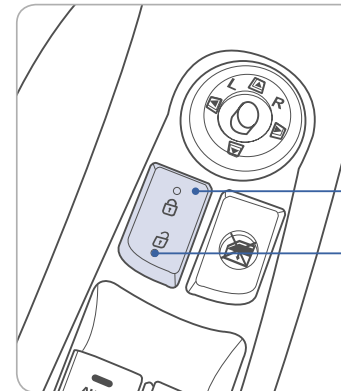

All doors will lock.

All doors will unlock.

FEATURES AND CONTROLS

HEADLIGHTS AND FOG LIGHTS

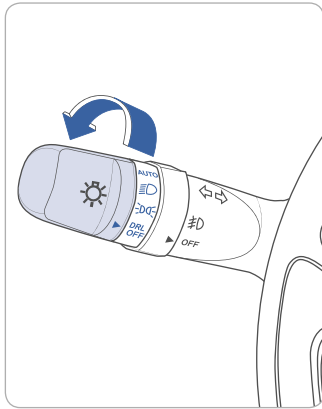

AUTO Auto light position

Headlight position

Parking light position

DRL OFF OFF position (DRL OFF position)

Headlights



Turn Signals



Fog Lights



Escort Function

Headlights may stay on for 15 seconds after exiting and locking vehicle. Press remote lock button twice to turn headlight off. See Owner's Manual for more detail.

Turn signals and lane change signals

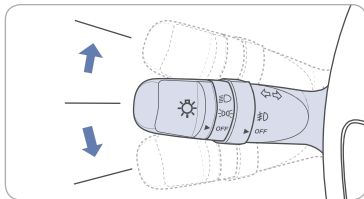

Flashing headlights

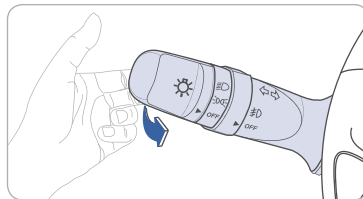

High beam

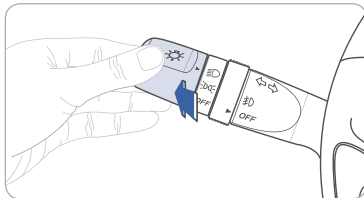

Fog light

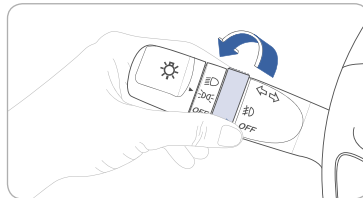

WIPER AND WASHER

Front Wiper and Washer

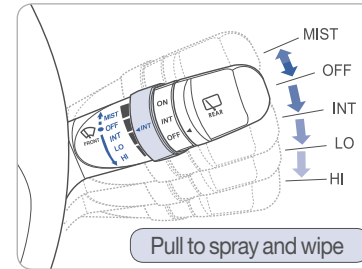

MIST - Single wipe

OFF - Off

INT - Intermittent wipe

LO - Normal wiper speed

HI - Fast wiper speed



front Intermittent wipe time adjustment

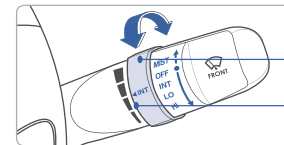

Fast wiper speed

Slow wiper speed

Rear wiper and washer

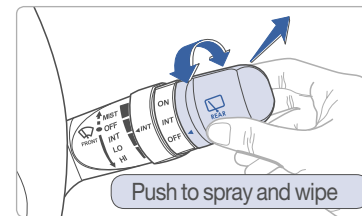

ON - Normal wiper operation

INT - Intermittent wiper operation

OFF - Wiper off

SUNROOF

Sliding the sunroof

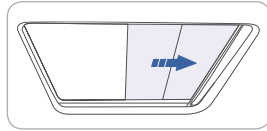
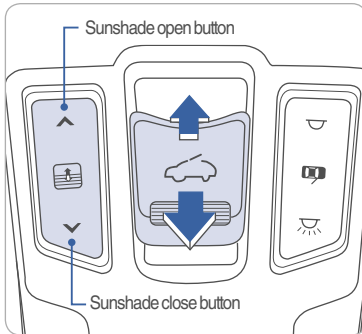

To Open

Press switch rearward.
Press switch rearward past the detent to open completely.

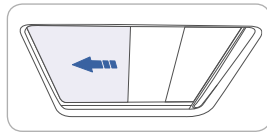

To Close

Press switch forward past the detent to close completely.

NOTE

To slide the sunshade, press open or close button.

Tilting the sunroof

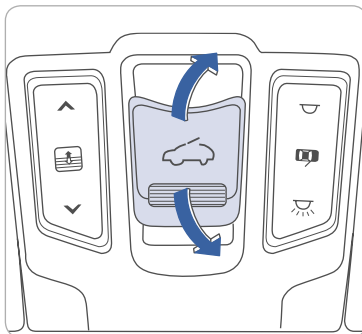

To Tilt

Press the switch up.

To close

Push the switch forward or pull the switch down.

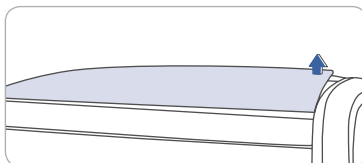

INTERIOR LIGHTS

Map lamp

Non sunroof

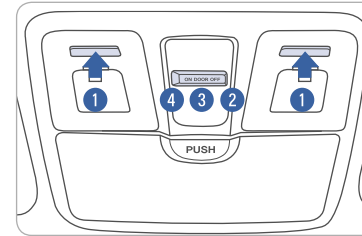

Push the lens ① to turn the map lamp on or off.

/OFF ②
The lights stay off at all times, except when individually turned on.

/DOOR ③
Map lamp and room lamp will turn on when any door is open except trunk.

/ON ④
Map lamp and room lamp will turn on.

With sunroof

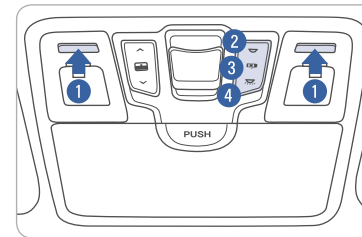

Room lamp

Non sunroof

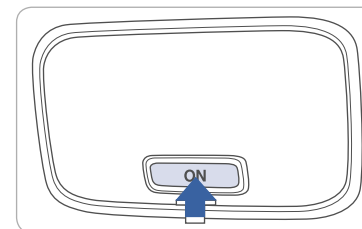

Non sunroof:

To turn the room lamp ON or OFF, push the switch.

With sunroof:

Press the switch to turn on the room lamp.

Press the switch to turn off the room lamp.

With sunroof

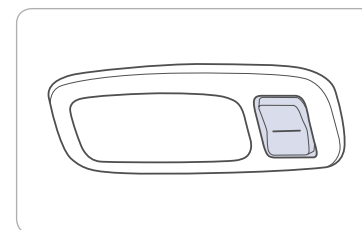



FEATURES AND CONTROLS

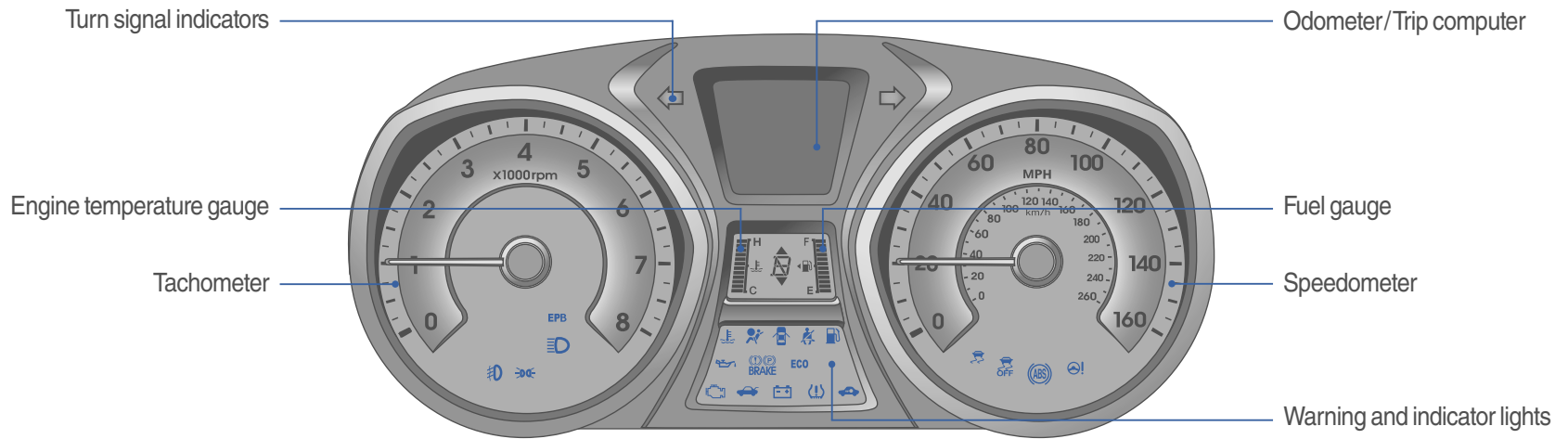

WARNINGS AND INDICATORS

Air bag warning light	Parking brake & Brake fluid warning light	ABS warning light
Seat belt warning light	Low Tire Pressure Indicator / TPMS (Tire Pressure Monitoring System) malfunction indicator	
High beam indicator	Engine oil pressure warning light	Charging system warning light
EPS Electric Power Steering system warning light	Door open warning light	Turn signal indicator
Immobilizer indicator	Automatic transmission shift indicator	Manual transmission shift indicator
Trunk open warning light	Low fuel level warning light	ESC (Electronic Stability Control) indicator
ESC (Electronic Stability Control) OFF indicator	Malfunction indicator light	Front fog light indicator
ECO indicator	Light on indicator	Engine coolant temperature warning light

INSTRUMENT PANEL ILLUMINATION

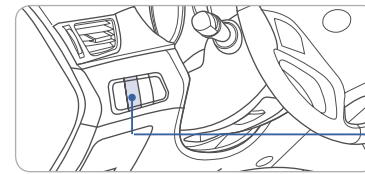

Push the control switch up or down to adjust the brightness

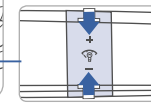

TRIP COMPUTER

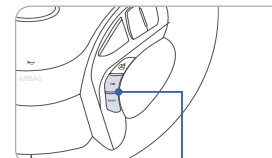

Press the TRIP button for less than 1 second to select function as follows:

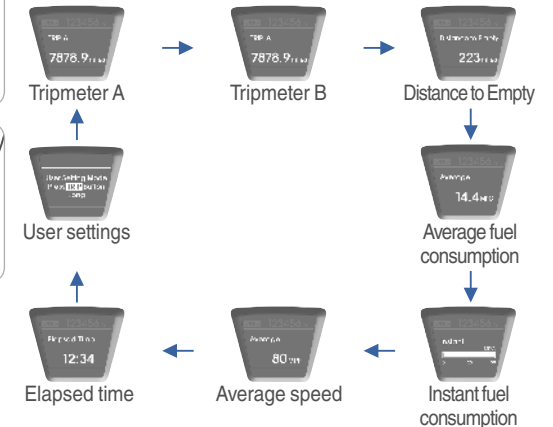
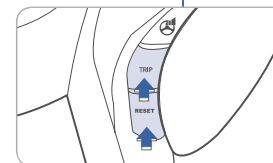

FEATURES AND CONTROLS

MANUAL CLIMATE CONTROL

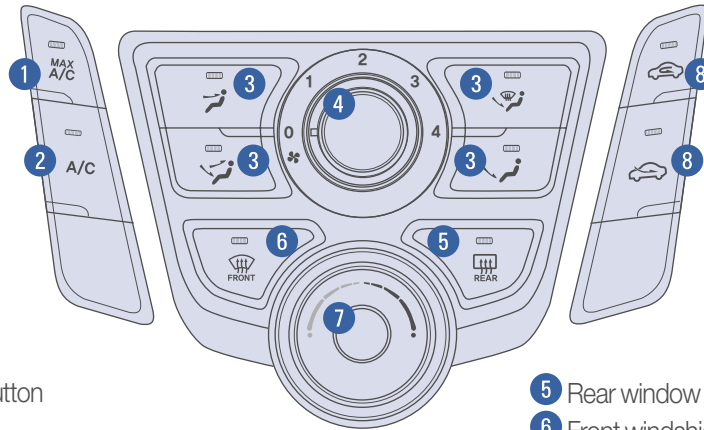

- 1 MAX A/C (Max airconditioning) button
- 2 A/C (Air conditioning) button
- 3 Mode selection buttons
- 4 Fan speed control knob

- 5 Rear window defroster button
- 6 Front windshield defrost button
- 7 Temperature control knob
- 8 Air intake control button

DEFROSTING / DEFOGGING



1. Press the front windshield defrost control.



2. Set the temperature control to the desired setting.



3. Set the fan speed to the highest setting.

NOTE

To reduce tendency of the glass fogging and also improve visibility, keep the interior surface of the windshield clean by wiping it with a clean cloth and glass cleaner.

AIR INTAKE CONTROL

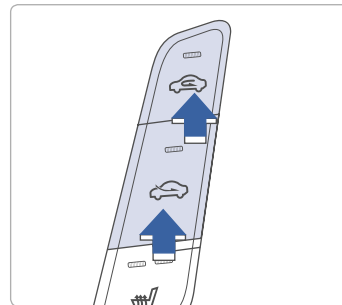

Outside (fresh) air position



Recirculated air position



MODE SELECTION

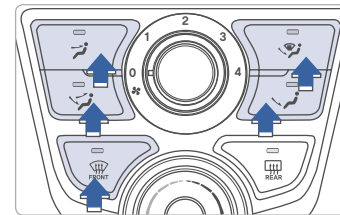

Changing the direction of the air flow as follow.



Face-Level



Bi-Level



Floor-Level



Floor/Defrost-Level



Defrost-Level

REAR WINDOW DEFROSTER

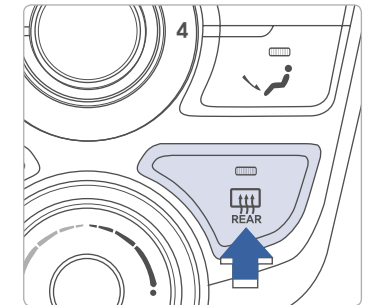

Press to activate/ deactivate the rear window defroster.

FEATURES AND CONTROLS

AUTOMATIC CLIMATE CONTROL

- 1 Air conditioning button
- 2 Driver's temperature control button
- 3 LCD display
- 4 Mode selection button
- 5 Air intake control button
- 6 Front windshield defrost button

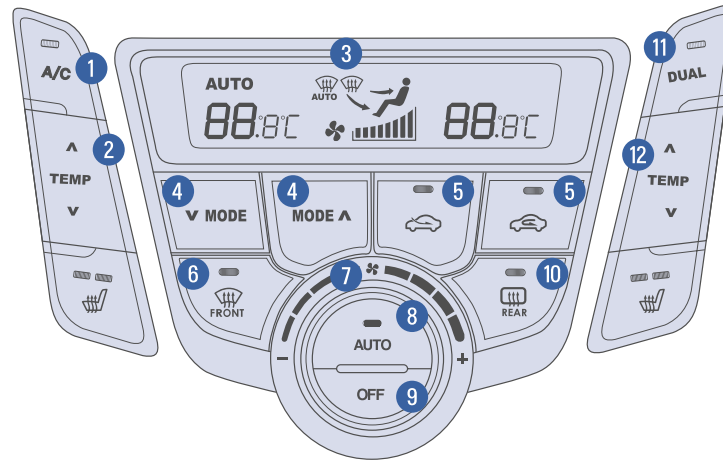

- 7 Fan speed control knob
- 8 AUTO (automatic control) button
- 9 OFF button
- 10 Rear window defrost button
- 11 Dual temperature control selection button
- 12 Passenger's temperature control button



AUTOMATIC HEATING AND COOLING

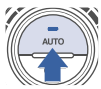

1. Press the AUTO button.

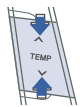

2. Set the temperature control to the desired setting.

The modes, fan speeds, air intake and air-conditioning will be controlled automatically according to the temperature setting.

SYSTEM OFF MODE

Pressing the OFF button will place the system in the off mode.

- Front blower will turn off.
- Outside (fresh) air position selected.
- Vented air at last set temperature.

AIR INTAKE CONTROL

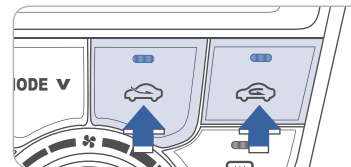

- Recirculated air position
- Outside (fresh) air position

DUAL BUTTON

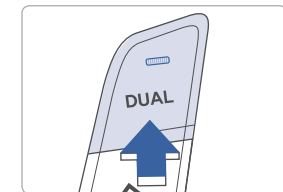

Press the DUAL button to operate the driver and passenger side temperature individually.

REAR WINDOW DEFROSTER

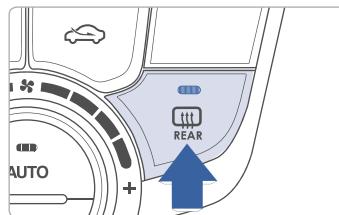

Press to activate/deactivate the rear defroster.

MODE SELECTION

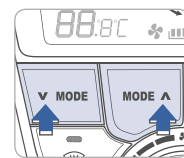

Changing the direction of the air flow as follow.

- Bi-Level
- Face Level
- Floor & Defrost
- Floor Level

DEFROSTING / DEFOGGING



1. Press the front windshield defrost control.



2. Set the temperature control to the desired setting.

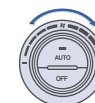

3. Set the fan speed to the highest setting.



FEATURES AND CONTROLS

STEERING WHEEL CONTROLS

Cruise control system

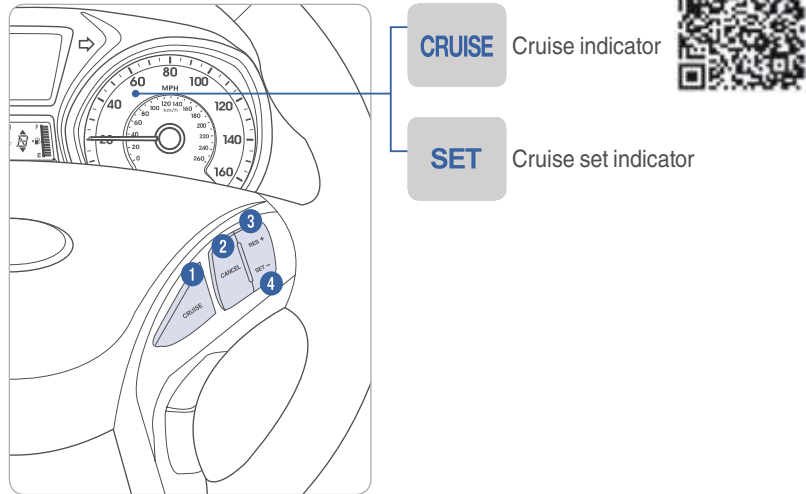

To Set a Cruising Speed

1. Press **CRUISE** button **1** and the **CRUISE** indicator will illuminate in the instrument cluster.
Accelerate to desired cruising speed (above 20 mph)
2. Press **SET -** button **4** and remove your foot from the accelerator pedal.

To Accelerate or Decelerate

- Press **RES +** button **3** up to increase set cruising speed.
Press **SET -** button **4** down to decrease set cruising speed.

To Cancel Cruising Speed

- Press **CANCEL** button **2**, depress brake pedal, or press **CRUISE** button **1**.

Audio control

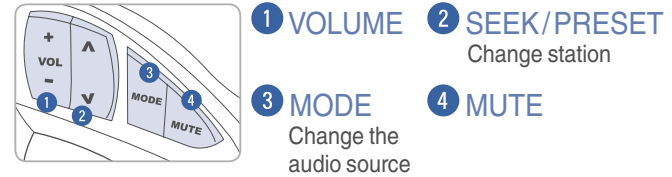

Bluetooth control

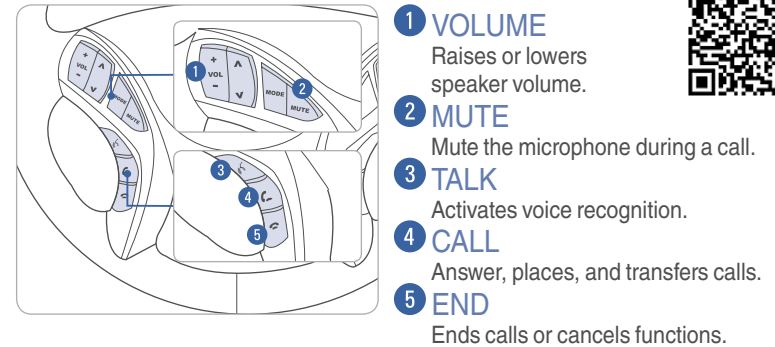

Driver selectable steering mode

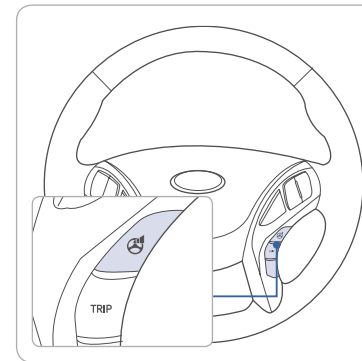

The Driver Selectable steering mode controls steering effort as driver's preference or road condition.

Pushing the button once tells you what the current mode is. Pressing the button again will scroll through the different modes.

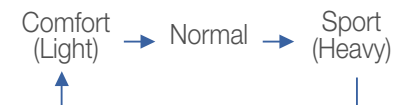

BLUETOOTH OPERATIONAL TIPS

In the following situations you or the other party may have difficulty hearing each other:

1. Keep the Bluetooth volume to a low level. High level volume may result in distortion and echo.
2. When driving on a rough road, high speeds and/or with the window open.
3. When the air conditioning vents are facing the microphone and/or when the air conditioning fan is at the max speed.

Steering wheel Bluetooth control

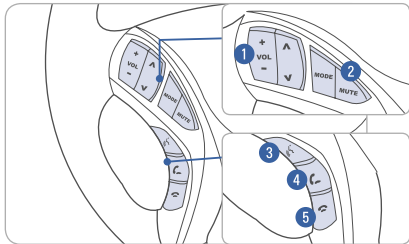

- 1 VOLUME**
Raises or lowers speaker volume.
- 2 MUTE**
Mute the microphone during a call.
- 3 TALK**
Activates voice recognition.
- 4 CALL**
Answer, places, and transfers calls.
- 5 END**
Ends calls or cancels functions.

Phone compatibility website: www.hyundaiusa.com/bluetooth

VOICE RECOGNITION TIPS

Your vehicle is equipped with Voice Recognition technology which allows drivers to operate their phones without having to take their eyes off the road to minimize distractions.

Voice recognition performance may be affected if driving with windows and sun roof open; when the heating-cooling system is on; when passing a tunnel or when driving on rugged and uneven roads.

For complete list of commands, refer to your Owner's Manual.



MULTIMEDIA



BLUETOOTH PHONE PAIRING

Pairing tutorials, phone compatibility and Operational tips can be found through the Smart QR code using the QR reader application on your Smartphone.

Standard Audio



Navigation



Vehicle must be parked to complete pairing process.

Standard Radio

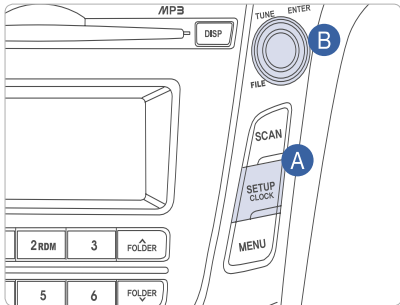

1. Press the SETUP **A** button.
2. Select "Phone" by turning and pressing the TUNE **B** knob.
3. Select "Phone Pair" by turning and pressing the TUNE **B** knob.
4. Enable Bluetooth on your phone.
5. Select "Elantra GT" from the Bluetooth® device list on your mobile phone.
Input passkey displayed on the screen when applicable.
6. After pairing is completed, transfer of the contact list to the audio system will begin (if your phone is supported).
7. If your phone prompts a phonebook access request, it is advisable to check the box "Always allow" or "Don't ask again".



Please visit www.hyundaiusa.com/Bluetooth for a list of compatible phones tested to work with Hyundai's Bluetooth® system.

Navigation Radio

1. Press the call button **1**



2. Press the "Settings" button on the PHONE screen.



3. Press the "Pairings" button on the SETTINGS screen.



4. Press the "Add to" button to pair a new mobile phone.



5. Enable Bluetooth on your phone. Select "Elantra GT" from the Bluetooth device list on your mobile phone. Input passkey displayed on the screen when applicable.





6. After pairing is completed, transfer of the contact list to the audio system will begin (if your phone is supported).
7. If your phone prompts a phonebook access request, it is advisable to check the box "Always allow" or "Don't ask again".



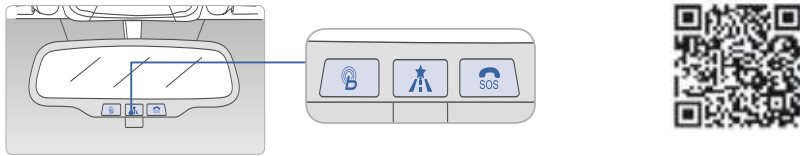

BLUE LINK TELEMATIC SYSTEM





Press the  button for access to the voice-response menu of services.

You have two options:

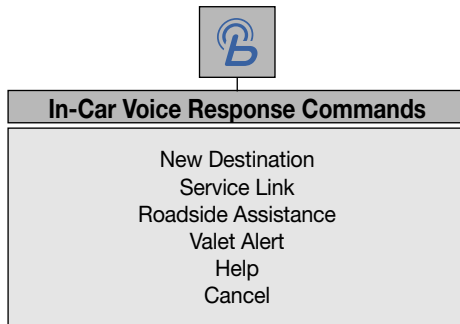
- You can say, "Main Menu" for a listing of main menu choices.
- You can directly select any of the listed menu items by saying its name.



- Press the  button for navigation-related services.
- Press the  button for SOS Emergency Assistance.
- Refer to your Blue Link User's Manual for detailed information on system operation.
- For immediate assistance with subscription services, please call 1-855-2BLUELINK (1-855-225-8354).
- Please register for Blue Link at www.MyHyundai.com.

You must be an active Blue Link subscriber or within the initial free trial period to receive Blue Link services, including emergency notification services.

Remote Door Unlock/Lock

Blue Link Mobile App



You can download the Blue Link mobile app to your compatible smart phone from the following sites:

- iPhone® — Apple® App Store
- Android® — Google Play

With this feature, you can lock or unlock your vehicle doors from virtually anywhere by using the Blue Link mobile phone app, by dialing the toll-free number, or by using the Blue Link owner's website.

- To use this feature, you must have a Blue Link Personal Identification Number (PIN). To create or change your PIN, log on to www.MyHyundai.com.

To Activate Remote Door Unlock/Lock

- By Blue Link Mobile App: Select DOOR UNLOCK or DOOR LOCK, as desired.
 - Enter your Blue Link PIN.
 - The command to lock or unlock your doors will be sent to your vehicle.
- By phone: Dial toll-free 1-855-2-BLUELINK (1-855-225-8354).
- By web site: Log on to www.MyHyundai.com, click on "My Blue Link" on the right side of the screen."
 - Select the Remote Door Unlock/Lock widget on the bottom of the page.
 - Input your Blue Link PIN.



MULTIMEDIA

STANDARD RADIO

Audio mode

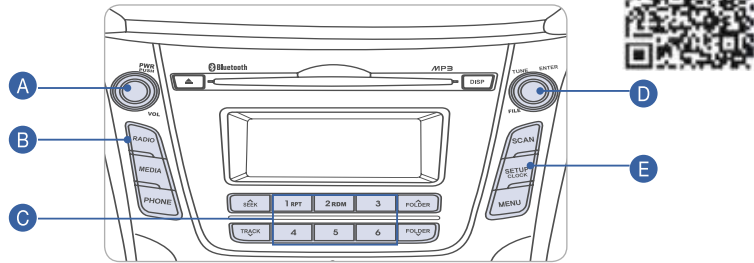

Press **POWER** button **A** to turn radio on.

• TUNING / LISTENING TO CHANNELS

1. Press the **RADIO** button **B**.
2. Turn the **TUNE/ENTER** knob **D** to select the desired channel and press the knob.

NOTE

A clear view of the southern sky is recommended to ensure XM® radio reception.

• SETTING PRESET MEMORY BUTTONS (FM/AM/XM®)

Press and hold any preset button (1-6) **C** until audible beep is heard to store current channel.

• ADJUSTING THE SOUND CONTROL

1. Press the **SETUP/CLOCK** button **E**.
2. Select "Sound Settings" by turning and pressing the **TUNE/ENTER** knob **D**.
3. Select "Bass", "Middle", "Treble", "Fader", or "Balance" by turning and pressing the **TUNE/ENTER** knob **D**.
4. Adjust the sound by turning and pressing the **TUNE/ENTER** knob **D**.

Blue Link Telematics System

Your audio display will change during Blue Link system use. Please refer to the Blue Link User's Manual for detailed information on system use.

Please refer to your Owner's Manual for more detailed information on how to use your audio system.

Complimentary XM® subscription ends three months following the vehicle date of sale. Please contact XM® Radio at 1-800-XM-RADIO (1-800-967-2346) to renew your XM® subscription.



NAVIGATION

Audio mode

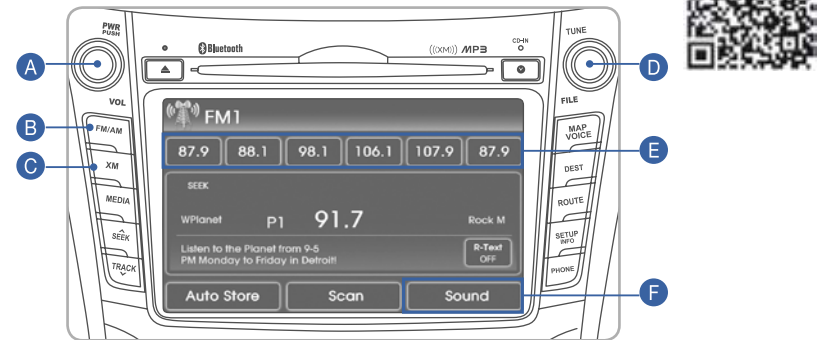

Press **POWER** button **A** to turn radio on.

• TUNING/LISTENING TO CHANNELS

1. Press **FM/AM** button **B** or **XM** button **C**.
2. Turn the **TUNE/FILE** knob **D** to desired channel.
3. If the AM or FM has been selected, press the knob.

NOTE

A clear view of the southern sky is recommended to ensure XM® radio reception.

• SETTING PRESET MEMORY BUTTONS (FM/AM/XM®)

Press and hold any preset button (1-6) **E** on the screen until audible beep is heard to store current channel.

• ADJUSTING THE SOUND CONTROL

1. Press **Sound** button **F** to enter **SETUP** menu.
2. Touch on-screen arrows to adjust desired setting.



Blue Link Telematics System

Your audio display will change during Blue Link system use. Please refer to the Blue Link User's Manual for detailed information on system use.



NAVIGATION

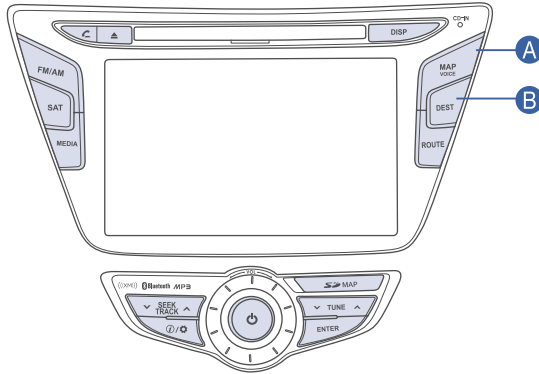

Map position

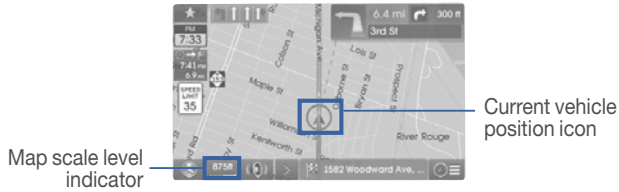

Press MAP button **A** to display map position.

Refer to Digital Navigation System User's Manual for more details.

Destination menu

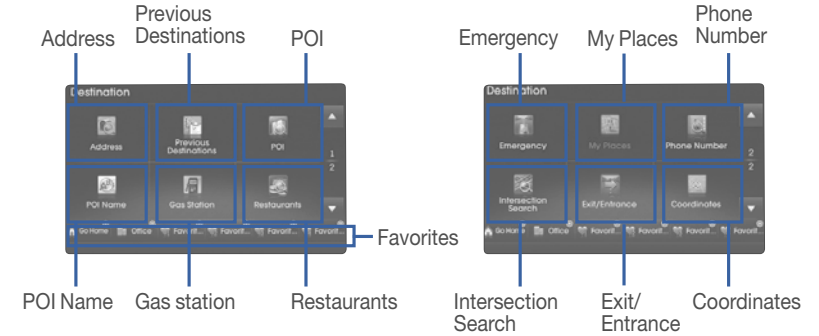

Press DEST button **B** to display destination menu.

- Previous Destinations: Search and select previous destinations.
- Address: Search destinations by selecting specific states/cities/roads.
- POI name: Search for POIs by name.
- Favorites: Store favorite places.
- POI (Point of Interest): Search for neighboring POIs near current position, scroll position, destination and city center.
- Gas Station: Search for gas station.
- Restaurants: Search for restaurants.
- Emergency: Search for emergency related facilities.
- My Places: List of saved My Places.
- Intersection Search: Search destinations by selecting street intersections.
- Phone Number: Search destinations by entering POI phone number
- Exit/Entrance: Search destinations by searching for expressway exits and entrances
- Coordinates: Search destinations by entering the latitude and longitude coordinates.

AUX, USB AND iPod® PORT

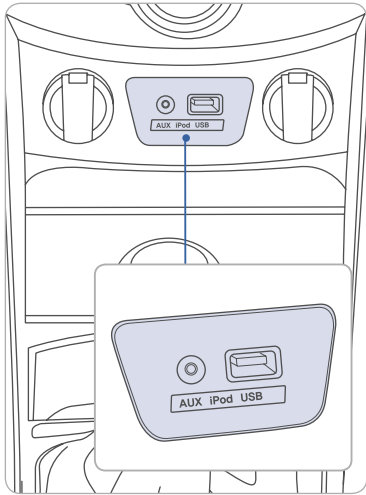

Use the jack to connect an external audio device and listen to it through the audio system speakers in your vehicle.



NOTE

To operate your iPod® through the vehicle's audio system:

Navigation:

- A Hyundai adapter cable is required. This cable can only be purchased at your local Hyundai dealer.

Standard radio:

- Connect your Apple supplied USB cable to the USB port.

iPod® is a trademark of Apple Inc.

CLOCK ADJUSTMENT

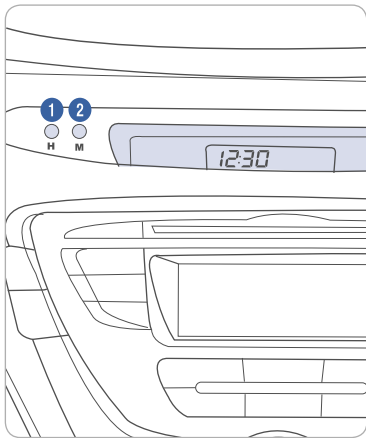

Hour 1

Pressing the H button will advance the time displayed by one hour.

Minute 2

Pressing the M button will advance the time displayed by one minute. Press the H and M buttons at the same time for more than 5 seconds to toggle between 12- and 24-hour formats.

With Navigation System

The clock automatically sets itself to the correct time.

CHILD-PROTECTOR REAR DOOR LOCK

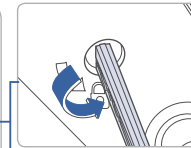
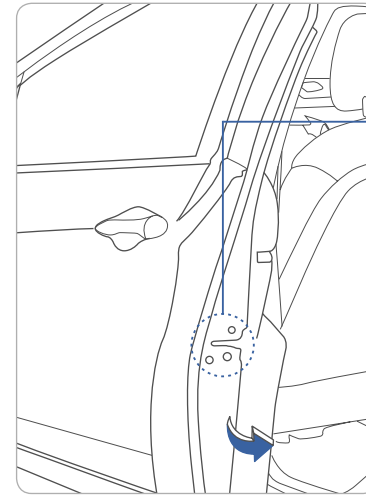

Lock (🔒)

Insert a key into the hole and turn it to the lock (🔒) position.

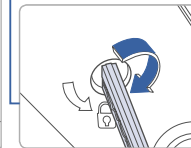

Unlock (→)

Allows opening the rear door handle from inside and outside the vehicle.



SEAT WARMER

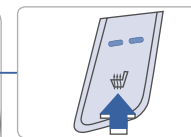
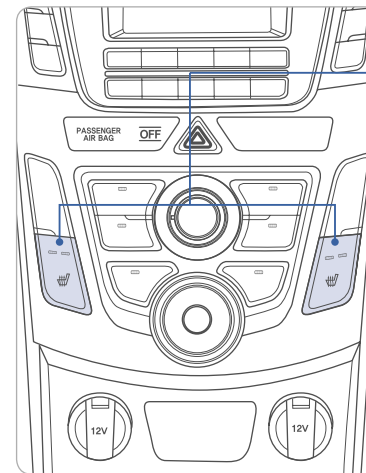

Push desired switch to warm the seat.

OFF → HIGH (■■■■) → LOW (■■■)



AUTOMATIC TRANSMISSION

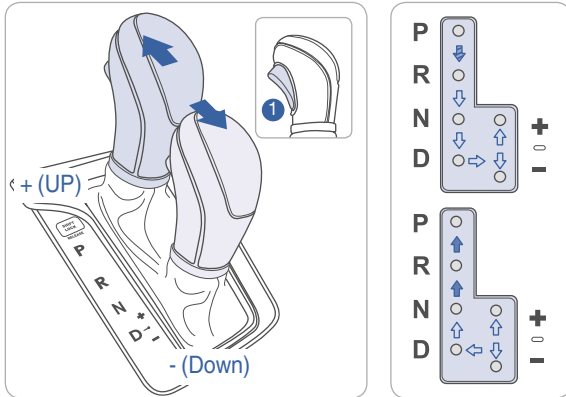

- (➡) : Depress the brake pedal and the lock release button ❶ when shifting.
- (➡) : The lock release button ❶ must be pressed while moving the shift lever.
- (➡) : The shift lever can be shifted without pressing the lock release button ❶.

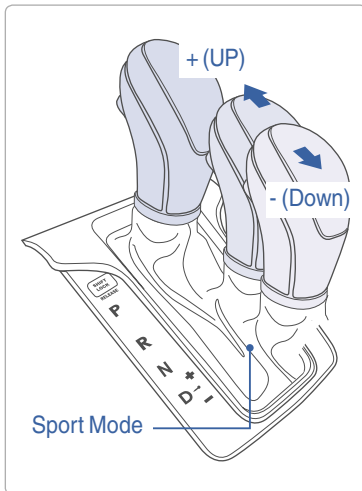

Sport mode

Move the shift lever from D (Drive) to the right gate to select.

Move the shift lever forward (+) to upshift or rearward (-) to downshift.



MANUAL TRANSMISSION

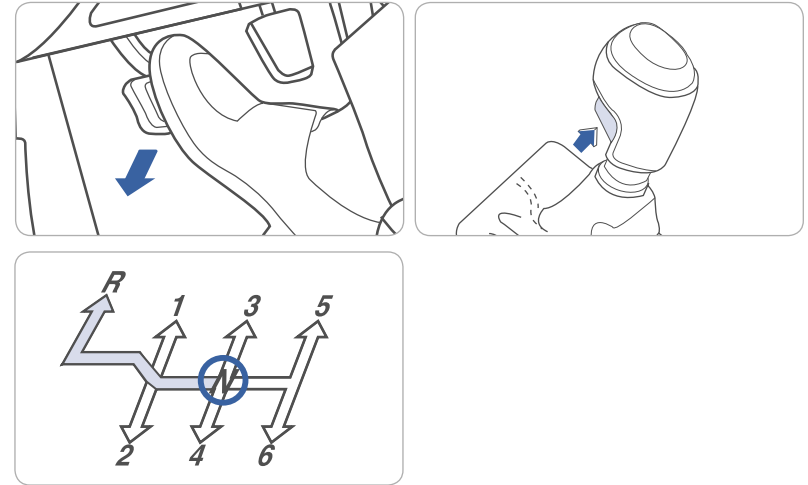

Shifting into Reverse

1. Depress the clutch pedal fully.
2. Ensure shifter is in Neutral.
3. Press the reverse lock-out button and shift left and forward to Reverse.
4. Release Clutch slowly for smooth acceleration.



TIRE PRESSURE MONITORING SYSTEM (TPMS)

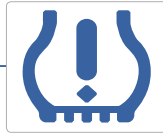
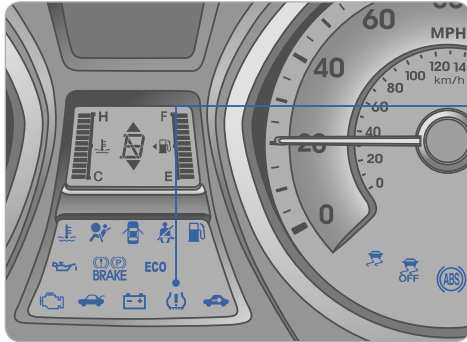

Low Tire Pressure Indicator / TPMS Malfunction Indicator

low tIRe pReSSuRe INDICAtOR

Illuminates if one or more of your tires is significantly under-inflated.

tpMS MalfuNctIoN INDICAtOR

Blinks for approximately one minute then remains illuminated when there is a malfunction with the TPMS system. Have the system checked by an authorized Hyundai dealer.

NOTE: Tire pressure may vary in colder temperatures causing the low tire pressure light (⚠) to illuminate.

ELECTRONIC STABILITY CONTROL (ESC)

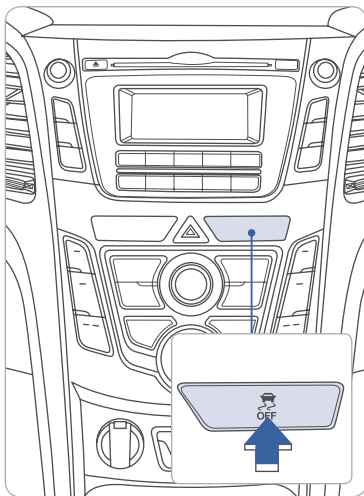

The ESC system is an electronic system designed to help the driver maintain vehicle control under adverse conditions.

to turn off engine Control
press the ESC OFF button shortly.

to turn off engine and t raction Control
press the ESC OFF button for more than 3 seconds.

ACTIVE ECO SYSTEM

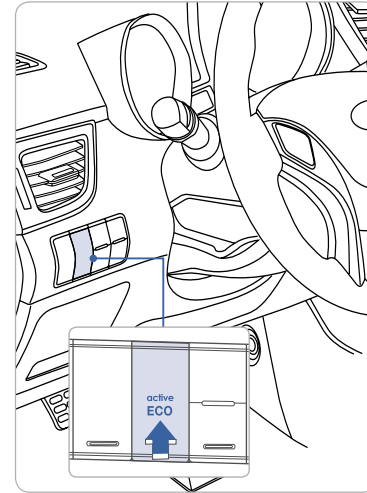

Active ECO system (automatic transmission)

Active ECO system helps to improve fuel efficiency. When the Active ECO system is activated, the vehicle acceleration, gear shift points and air conditioning performance will be reduced to conserve the fuel consumption.

Press the Active ECO button to activate. The LED on the button and the ECO indicator in the instrument cluster will illuminate.

ECO Shift (Manual Transmission)

▲ or ▼ symbol is displayed along with the current gear position, which informs you to up shift or down shift to the next recommended gear position for fuel efficiency.



to improve your fuel efficiency:

- Drive smoothly and accelerate at a moderate rate.
- Avoid heavy accelerations.
- Maintain steady cruising speed.
- Adjust the vehicle speed to the traffic condition and avoid speed changes.
- Avoid unnecessary braking.
- Keep the tires inflated to the recommended tire pressure.
- Don't idle the engine longer than necessary.



REARVIEW CAMERA

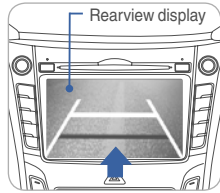

When you move the shift lever to the R(Reverse) the rearview camera cover will open and then the rearview camera will activate.

The rearview camera cover will close after 10 seconds.

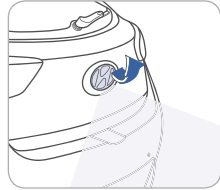

NOTICE

Closing the rearview camera cover will make a slight sound, but this condition is normal.

Key Websites

Hyundai website - www.hyundai.com

Hyundai owner website - www.myhyundai.com

Bluetooth phone compatibility - www.hyundaiusa.com/bluetooth

Blue Link - www.hyundaiusa.com/technology/bluelink

Large horizontal lines for taking notes in the MEMO section.

ELANTRA GT CUSTOMER DELIVERY CHECK LIST

hYuNDal owNeR	DealeRShlp NaMe
SaleS CoNSultaNt	Date
VIN	pReVIouS VehICle

BEFORE DELIVERY

- CoNfIRM "GooD batteRY" uSING GR8 aND Staple teSt tICkeT heRe
- Set tIRe pReSSuRe If Rf RR IR
- VeRiFY VehICle IS CleaN, IN GooD CoNDItIoN, fRee of ChIpS aND SCRatCheS · CleaN wINDShleID aND baCK wINDow
- eNSuRe flooRMaTS aRe SNAppeD INto plaCe

Sales Consultant _____ Date _____ Sales Manager _____ Date _____

Customer _____ Date _____

Email _____ @ _____